

## Warnings!



Watch out for the scratches that may be caused by the cabinet, chassis or rails.  
Be aware of electric shock when installing the servers into the cabinet in use.



PN

- DO NOT block the vents on the server during installation, especially the vents on the front and rear of the server.
- Remove the protective film from the chassis before installing servers into the rack.
- For proper ventilation, leave a minimum space of 15cm between two servers.
- For easy access of the front and rear ports and cabling, leave a minimum space of 70mm between the front side of the server and the inner side of the cabinet's front door, and 150mm between the rear side of the server and the inner side of the cabinet's rear door.
- Always keep the air baffles in place to ensure proper air flow and avoid air turbulence in the server room.
- Installation must comply with local and regional electrical regulations. To reduce the risk of personal injury, fire, or damage to the server, DO NOT overload the AC supply that provides power to the rack.
- Servers can only be deployed in dedicated cabinets with ventilation holes or specialized cooling cabinets to avoid server failure from overheating as they are high power appliances.
- In case of multiple-server deployment, always load from bottom to top and place the heavier server on the lower bay.
- DO NOT install devices beyond the cabinet's load-bearing capacity, power supply capacity and heat dissipation capacity.



15kg



For devices  $\geq 15$ kg, it requires at least 2 people.



30kg



For devices  $\geq 30$ kg, it requires at least 3 people.



50kg



For devices  $\geq 50$ kg, it requires at least 4 people.

# Rack-Mounted Server Installation Guide (Integrated Rail Kit)

## V1.0

## Rail-Kit Contents

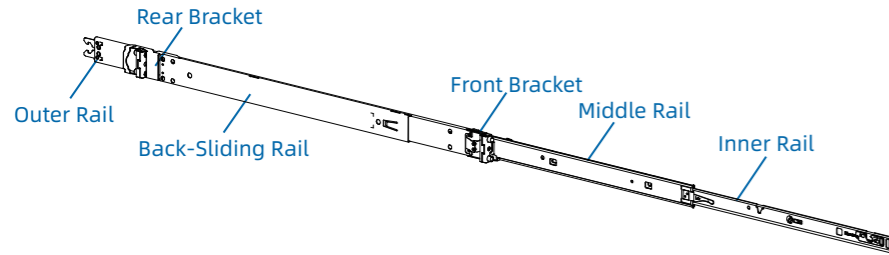

## Installing the Rails to the Server

- 1 Align the pins on the rear bracket to the desired position of the back of the rack. Press the locking latch as indicated by arrow ①, and then insert the pins as indicated by arrow ② until the pins are fully engaged.

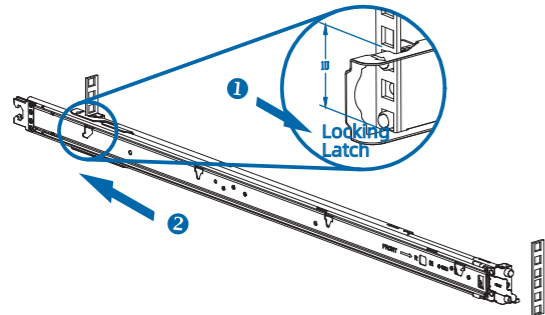

- 2 Align the pins on the front bracket to the front of the rack. Press the locking latch on the front bracket as indicated by arrow ①, and then insert the pins as indicated by arrow ② until the pins are fully engaged.

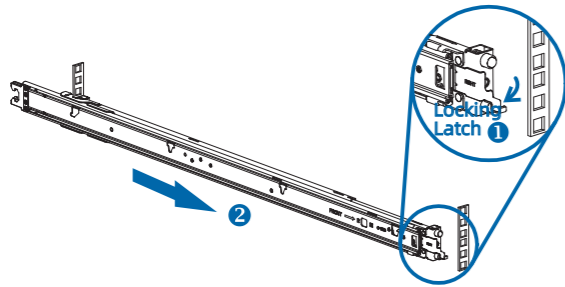

- 3 Repeat Step 1 and Step 2 for the other rail-kit.

**NOTE:** The front end and rear end of the rail, and the two rails **MUST** be installed at the same height.

- 4 Fully extend the inner rail until it clicks into a locked position. Repeat the same step to extend the other inner rail.

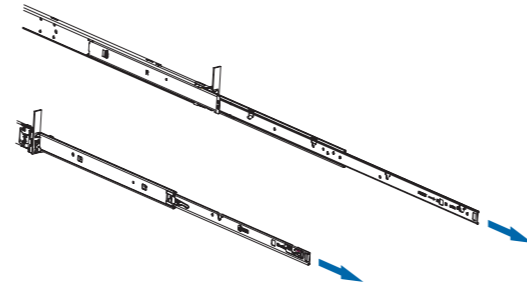

- 5 Locate the front standoffs on both sides of the server and lower them into the J-slots on the inner rails. Gently place the server downward from the rear to the front until all the standoffs are firmly seated in the J-slots.

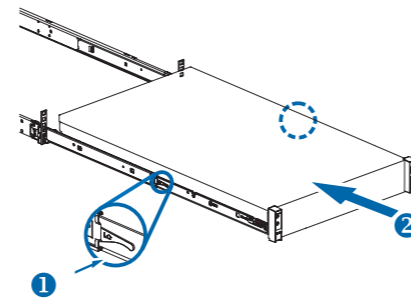
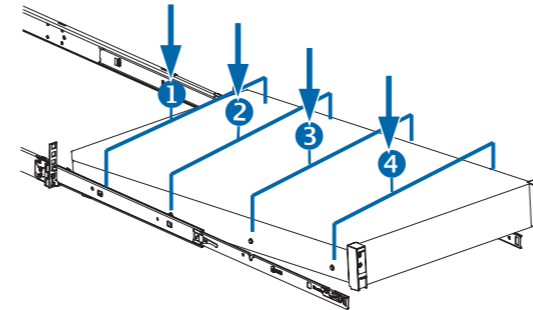

- 6 Pull up the locking tabs on both sides of the inner rails simultaneously, and then slide the server carefully all the way into the rack.

- 7 Open both handles on the front of the server, and then tighten the two thumb screws to secure the server in place.

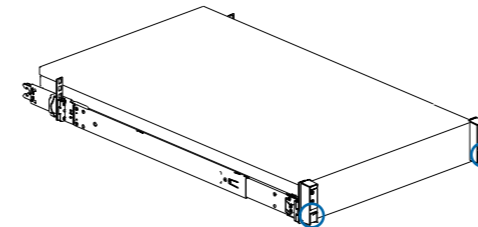

## Removing the Rails from the Server

- 1 Open both handles on the front of the server, and then loosen the two thumb screws.

- 2 Carefully slide the server out and pull the tabs forward simultaneously to release the server from the rail.

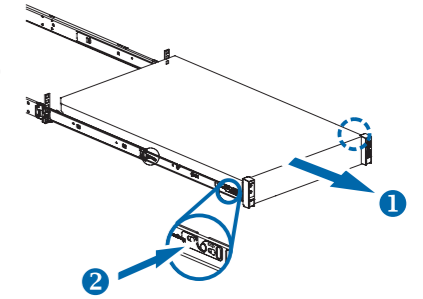

- 3 Gently lift up and remove the server from the front to the rear. Before removing the server from the rails, make sure that the eight standoffs on the server are disengaged from the J-slots.

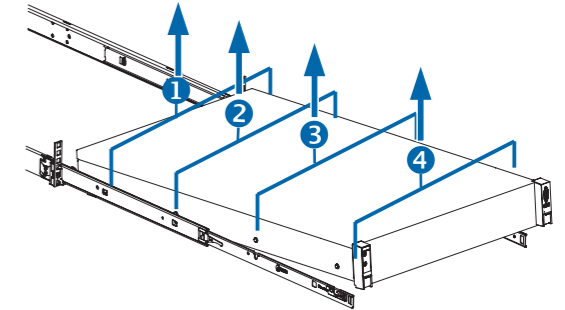

- 4 Pull up the locking tabs on both sides of the inner rails simultaneously, and then slide the rails back.

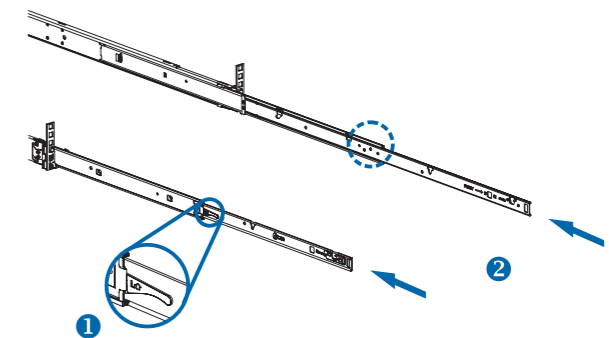

## Removing the Rails from the Rack

Follow the preceding steps to remove the rails from the rack.

## Identifying the Rail Kit Contents

Rail Kit is assembled by inner rail, middle rail and outer rail.

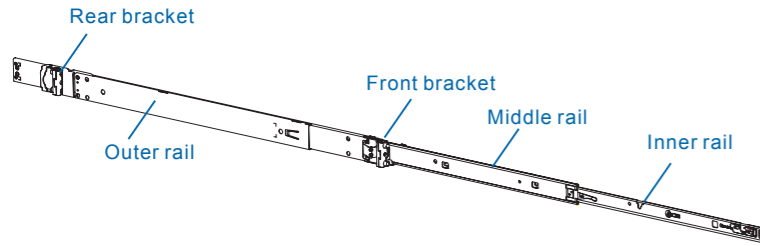

## Installing Rails

- 1 Position the rear bracket and align each pin with the rack holes. ① Pull the latch release button on the rear bracket. ② Push the rail into the rack until the square pins are fully seated on the rack holes and the latch clicks into place.

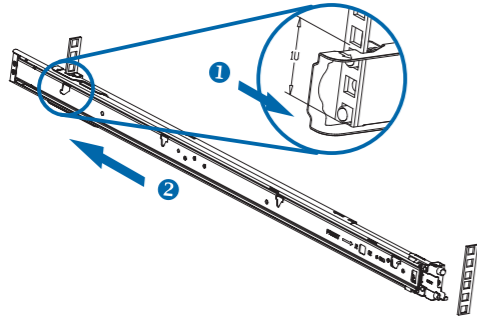

- 2 ① Pull up the latch release part on the front bracket. ② Push the rail into the rack until the square pins are fully seated on the rack holes and the latch clicks into place.

⚠ Notice: Keep the front and rear brackets on the same level.

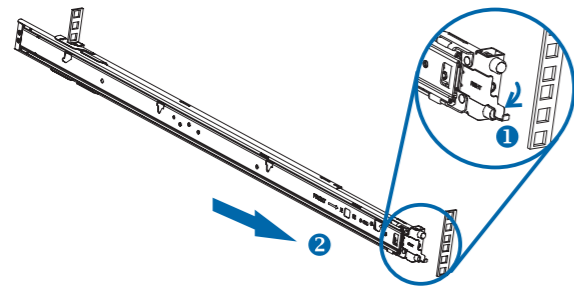

- 3 Repeat steps 1 and 2 to install the other side. And pull the inner rails out of the rack until they lock into place.

⚠ Notice: Keep the left and right rails on the same level.

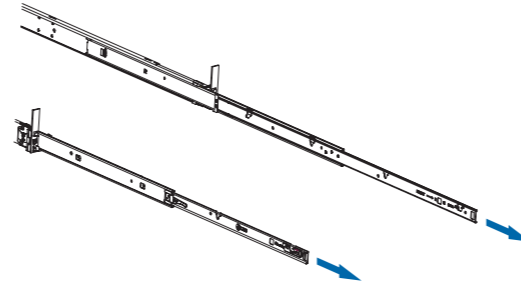

- 4 Align the rail standoffs on each side of the system and lower them into the slots on the rail. Put the system downward until all the rail standoffs are seated in the slots.

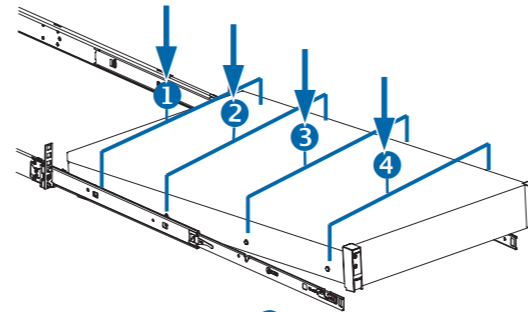

- 5 Press the side-release lock buttons on both rails and slide the system into the rack.
- 6 Locate and tighten the screws under each handle on the system.

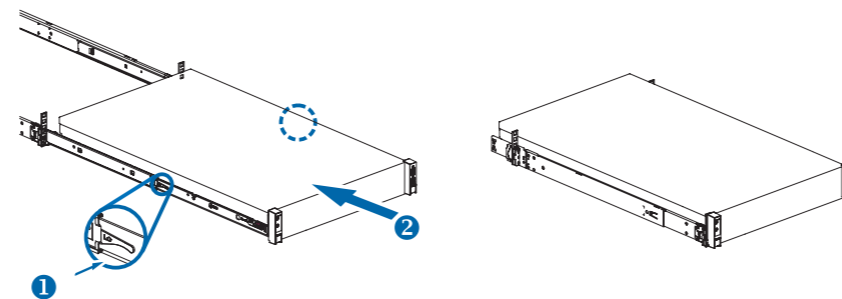

## Removing Rails

- 1 Remove the screws from the left and right handles on the system.
- 2 Pull out the system and press the side-release lock buttons on both rails, and lift the system up and away from rails.

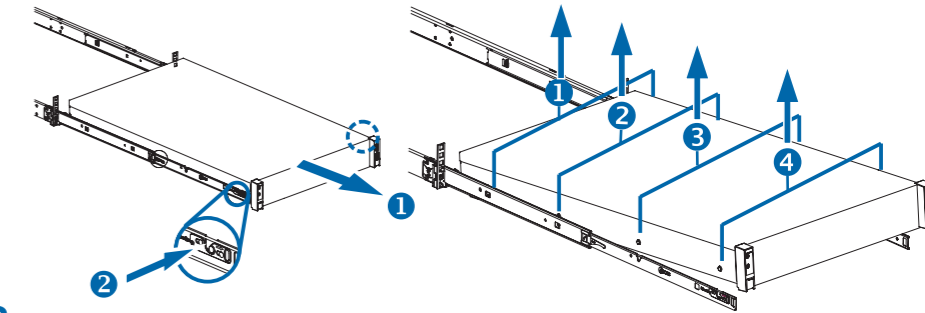

- 3 Press the side-release lock buttons on both rails and slide the rails into the rack.

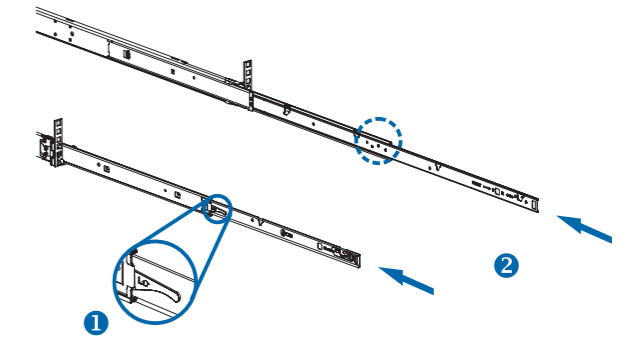

- 4 Remove the rails as the same way of installing.

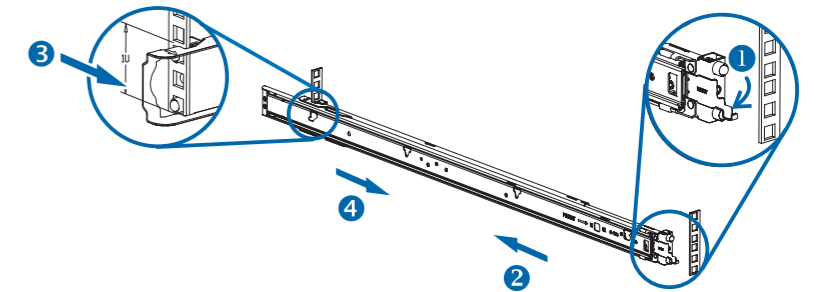

## Rail-Kit Contents

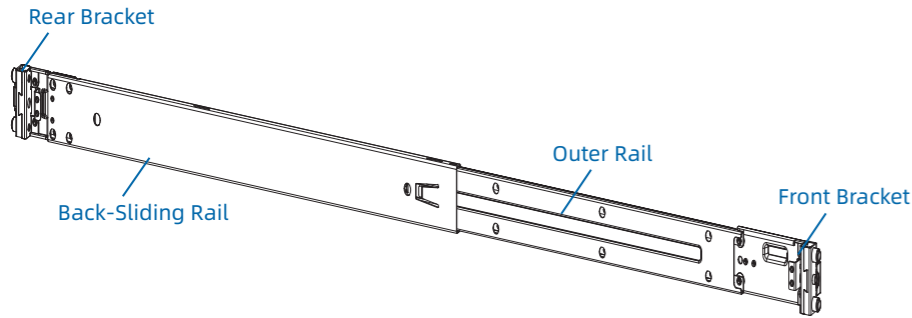

## Installing the Rails

- 1 Align the pins on the rear bracket to the desired position of the back of the rack. Press the locking latch as indicated by arrow ①, and then insert the pins as indicated by arrow ② until the pins are fully engaged.

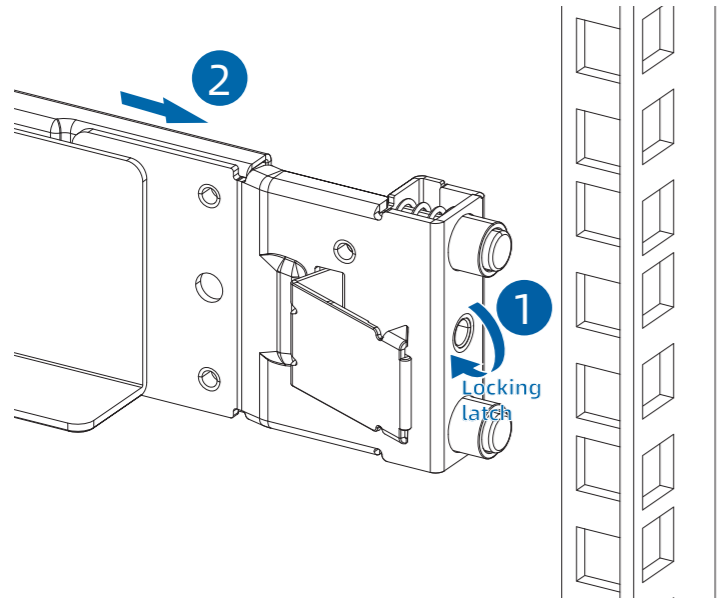

- 2 Align the pins on the front bracket to the front of the rack. Press the locking latch as indicated by arrow ①, and then insert the pins as indicated by arrow ② until the pins are fully engaged.

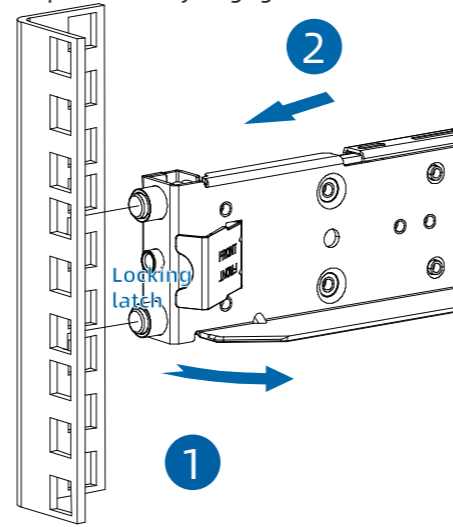

- 3 Repeat Step 1 and Step 2 for the other rail.

- ⚠ **NOTE:** The front end and the rear end of the rail, and the two rails **MUST** be installed at the same height.
- 4 Align the server with the rails, and slide the chassis all the way into the rack.

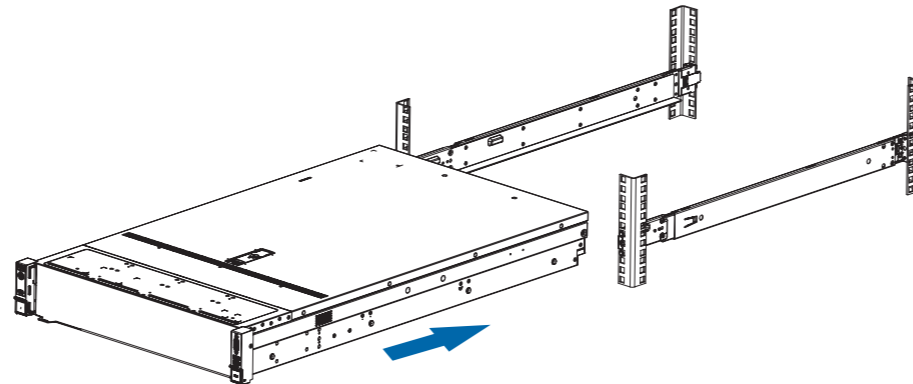

- 5 Open both handles on the front of the server, and then loosen the two thumb screws.

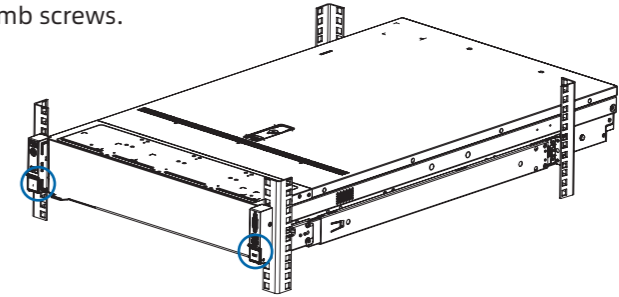

## Removing the Rails

- 1 Open both handles on the front of the server, and then tighten the two thumb screws.

- 2 Slide the server out, and then remove the server from the rack.

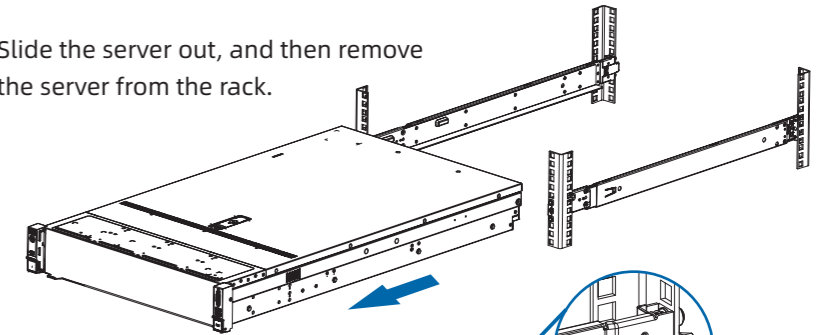

- 3 Disengage the pins from the rack.

