

## ZORBAX Rapid Resolution High Definition (RRHD) 1.8 $\mu\text{m}$

- High pressure (1200 bar) columns for optimum results with the 1290 Infinity LC or other UHPLC instruments
- 1.8  $\mu\text{m}$  particles deliver maximum resolution for the most defined separations
- Available in 12 ZORBAX phases, including Eclipse Plus C18 for superior peak shape, ZORBAX StableBond C18 for low pH stability, Bonus-RP, Eclipse PAH, Eclipse Plus Phenyl-Hexyl and Extend-C18
- Also available in HILIC Plus
- Achieve the same selectivity on 3.5 and 5  $\mu\text{m}$  ZORBAX columns with the same bonded phase for compatibility with any LC

ZORBAX Rapid Resolution High Definition (RRHD) columns are an expansion of the ZORBAX 1.8  $\mu\text{m}$  particle column line. The new RRHD columns use improved packing processes to achieve stability up to 1200 bar for use with the Agilent 1290 Infinity LC or other UHPLC instruments. RRHD 1.8  $\mu\text{m}$  columns are available in 50, 100 and 150 mm lengths for fast or high resolution – truly high definition – separations of your most complex samples.

### ZORBAX RRHD Column Specifications

Bonded Phase	Pore Size	Surface Area	pH Range	Endcapped	Temp Limit
ZORBAX Eclipse Plus C18	95Å	160 m <sup>2</sup> /g	2.0-9.0	Double	60 °C
ZORBAX Eclipse Plus C8	95Å	160 m <sup>2</sup> /g	2.0-9.0	Double	60 °C
ZORBAX Eclipse Plus Phenyl-Hexyl	95Å	160 m <sup>2</sup> /g	2.0-9.0	Double	60 °C
ZORBAX Eclipse XDB-C18	80Å	180 m <sup>2</sup> /g	2.0-9.0	Double	60 °C
ZORBAX Extend-C18	80Å	180 m <sup>2</sup> /g	2.0-11.5**	Double	60 °C
ZORBAX Bonus RP	80Å	180 m <sup>2</sup> /g	2.0-9.0	Triple	60 °C
ZORBAX StableBond SB-C18	80Å	180 m <sup>2</sup> /g	1.0-8.0*	No	80 °C
ZORBAX StableBond SB-C8	80Å	180 m <sup>2</sup> /g	1.0-8.0*	No	80 °C
ZORBAX StableBond SB-Phenyl	80Å	180 m <sup>2</sup> /g	1.0-8.0*	No	80 °C
ZORBAX StableBond SB-CN	80Å	180 m <sup>2</sup> /g	1.0-8.0*	No	80 °C
ZORBAX StableBond SB-Aq	80Å	180 m <sup>2</sup> /g	1.0-8.0*	No	80 °C
ZORBAX Eclipse PAH	95Å	160 m <sup>2</sup> /g	2.0-8.0	No	60 °C
ZORBAX HILIC Plus	95Å	160 m <sup>2</sup> /g	0.0-8.0	No	60 °C
ZORBAX StableBond 300SB-C8	300Å	45 m <sup>2</sup> /g	1.0-8.0*	No	80 °C
ZORBAX StableBond 300SB-C18	300Å	45 m <sup>2</sup> /g	1.0-8.0*	No	80 °C
ZORBAX StableBond 300SB-C3	300Å	45 m <sup>2</sup> /g	1.0-8.0*	No	80 °C
ZORBAX 300-Diphenyl	300Å	45 m <sup>2</sup> /g	1.0-8.0*	No	80 °C



\* StableBond columns are designed for optimal use at low pH. At pH >6, highest column stability for all silica based columns is obtained by operating at temperatures <40 °C and using lower buffer concentrations – 10-20 mM or organic buffers. 300SB-C18 may be used up to 90 °C. For pH 6-8, select the Eclipse Plus C18 column.

\*\* Temperature limits are 60 °C up to pH 8, 40 °C from pH 8-11.5.



ZORBAX Rapid Resolution High Definition (RRHD) 1.8  $\mu\text{m}$  Columns

Rapid Resolution HT Columns for High Pressure Use (Maximum Pressure: 600 bar, 9000 psi)

Hardware	Description	Size (mm)	Particle Size (µm)	SB-C18 USP L1	SB-C8 USP L7	SB-Phenyl USP L11	SB-CN USP L10	SB-Aq	Rx-SIL USP L3	Bonus-RP USP L60
	Rapid Resolution HT, 600 bar	4.6 x 150	1.8	829975-902	829975-906	829975-912	829975-905	829975-914		
	Rapid Resolution HT, 600 bar	4.6 x 100	1.8	828975-902	828975-906	828975-912	828975-905	828975-914	828975-901	828668-901
	Rapid Resolution HT, 600 bar	4.6 x 75	1.8		830975-906					830668-901
	Rapid Resolution HT, 600 bar	4.6 x 50	1.8	827975-902	827975-906	827975-912	827975-905	827975-914	827975-901	827668-901
	Rapid Resolution HT, 600 bar	4.6 x 30	1.8	824975-902	824975-906	824975-912	824975-905	824975-914		
	Rapid Resolution HT, 600 bar	4.6 x 20	1.8	826975-902	826975-906					
	UHPLC Guard, 600 bar, 3/pk	4.6 x 5	1.8	820750-902	820750-904					
	Solvent Saver HT, 600 bar	3.0 x 150	1.8	829975-302	829975-306	829975-312	829975-305			
	Solvent Saver HT, 600 bar	3.0 x 100	1.8	828975-302	828975-306	828975-312	828975-305	828975-314	828975-301	828668-301
	Solvent Saver HT, 600 bar	3.0 x 50	1.8	827975-302	827975-306	827975-312	827975-305	827975-314	827975-301	827668-301
	Solvent Saver HT, 600 bar	3.0 x 30	1.8	824975-302	824975-306		824975-305			
	Solvent Saver HT, 600 bar	3.0 x 20	1.8	826975-302	826975-306					
	UHPLC Guard, 1200 bar, 3/pk	3.0 x 5	1.8	823750-902	823750-904					
	Narrow Bore RRHT, 600 bar	2.1 x 150	1.8	820700-902	820700-906	820700-912	820700-905			
	Narrow Bore RRHT, 600 bar	2.1 x 100	1.8	828700-902	828700-906	828700-912	828700-905	828700-914	828700-901	828768-901
	Narrow Bore RRHT, 600 bar	2.1 x 50	1.8	827700-902	827700-906	827700-912	827700-905	827700-914	827700-901	827768-901
	Narrow Bore RRHT, 600 bar	2.1 x 30	1.8	824700-902	824700-906	824700-912	824700-905	824700-914		
	Narrow Bore RRHT, 600 bar	2.1 x 20	1.8	826700-902	826700-906					
	UHPLC Guard, 1200 bar, 3/pk	2.1 x 5	1.8	821725-902	821725-904					



## Ordering Information

Part Number	Inline Filter Assemblies
5067-1603	InfinityLab Quick Change inline filter assembly for UHPLC (incl. 5 filter discs 2.1 mm id, 0.2 µm porosity), with 90 mm flexible capillary
5067-1602	InfinityLab Quick Change inline filter assembly for HPLC (incl. 5 filter discs 4.6 mm id, 0.5 µm porosity), with 90 mm flexible capillary
5067-1606	InfinityLab Quick Change inline filter assembly with rigid capillary for HPLC (incl. 5 filter discs 4.6 mm id, 0.5 µm porosity)
5067-1607	InfinityLab Quick Change inline filter assembly with rigid capillary for UHPLC (incl. 5 filter discs 2.1 mm id, 0.2 µm porosity)
	<b>Filter Discs</b>
5067-1610	Filter discs, 2.1 mm id, 0.2 µm porosity, 5/pk
5067-1611	Filter discs, 2.1 mm id, 0.5 µm porosity, 5/pk
5067-1612	Filter discs, 4.6 mm id, 0.2 µm porosity, 5/pk
5067-1613	Filter discs, 4.6 mm id, 0.5 µm porosity, 5/pk
5067-1614	Filter discs, 4.6 mm id, 2.0 µm porosity, 5/pk
	<b>Replacement Capillaries</b>
5023-3344	Capillary, stainless steel, 0.12 mm id, 90 mm length, 2x extra-long fittings, pre-swaged on one end, non-swaged on the other end, for inline filter for UHPLC
	<b>Quick Turn Fitting</b>
5067-5966	Quick Turn Fitting
5043-0924	Ferrule for Quick Turn Fitting

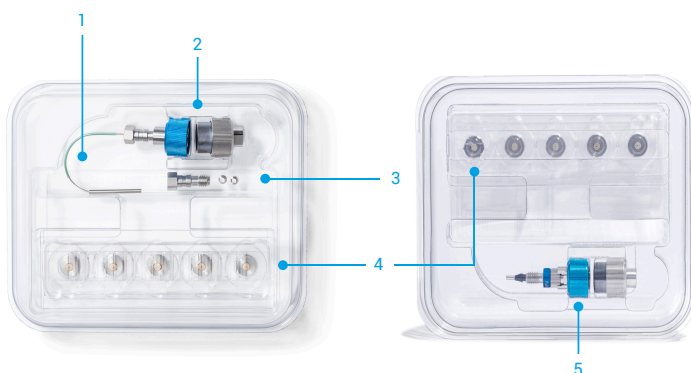

1. Capillary, SST, 90 mm length
2. Filter housing (two parts)
3. Loose fitting for non-swaged end of capillary
4. Filter discs in touchless packaging, 5/pk
5. Filter housing with Quick Turn fitting

**Figure 6.** InfinityLab Quick Change inline filter assembly (left: assembly with flexible capillary; right: assembly with rigid capillary)

Learn more at:

[explore.agilent.com/inline-filter](https://explore.agilent.com/inline-filter)

DE44222.5666087963

This information is subject to change without notice.

© Agilent Technologies, Inc. 2021, 2023  
Published in the USA, August 3, 2023  
5994-3028EN

## Maximize Efficiency for Your Liquid Chromatography Workflows

Learn more about how to improve the efficiency of your LC workflow with the following products:

- InfinityLab Poroshell 120 columns
- InfinityLab Quick Connect and Quick Turn fittings
- InfinityLab solvent bottles
- Smart InfinityLab supplies
- InfinityLab Kits
- InfinityLab Flex Bench Family

Request your Infinitylab LC supplies catalog—an easy reference putting commonly used LC supplies at your fingertips.

More information at:

[www.agilent.com/chem/infinitylab-supplies-catalog](https://www.agilent.com/chem/infinitylab-supplies-catalog)

