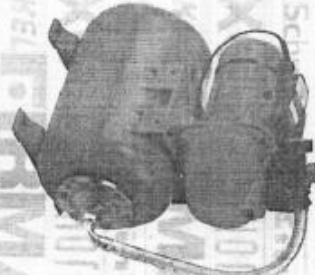

EUMOS**MAKEL****BOSCH****Einhell****Schneider Electric****FIRMAN****Kasan****WIXO****HAGEL****ZAMEL****VENTIK****IEK**

04. DEC. 2017

BOSCH
SERVICE CENTRU

NR. A 45640

CERTIFICAT DE GARANȚIE

BOSCH
SERVICE CENTRU**Regulamentul de executare a reparației conform garanției:**

1. Service Centru BOSCH acordă garanție conform legislației Republicii Moldova pe baza certificatului de garanție și a dovezii de cumpărare.
2. Drepturile conferite prin lege consumatorului nu sunt afectate prin garanția oferită. Garanția se acordă numai pentru defecte de material sau fabricație.
3. Garanția presupune o reparație gratuită sau schimbul unui detaliu (agregat) defect. Detaliile (agregatele) defecte, înlocuite, devin proprietatea unității servicii centru.
4. Reclamațiile sunt acceptate numai în cazul când produsul este predat la Unitatea Service autorizată pentru descrierea în stare nedemontată. Produsele asupra cărora se observă intervenții (modificări, dezasamblare, înlocuire de piese) de către cumpărător nu sunt acceptate pentru reparație sau înlocuire pe garanție.
5. Reparații gratuite se efectuează numai în termenul indicat în talonul de garanție. Termenul de garanție începe de la data procurării articolului.
6. Produsele ce nu pot fi reparate în cadrul termenului de garanție se înlocuiesc sau se restituie contravaloarea produsului respectiv de către vânzător în termen de maxim 14 zile și numai pe baza notei de constatare emise de unitatea Service Centru BOSCH.
7. Reparația produselor aflate în perioada de garanție se efectuează în decurs de 14 zile în cazul în care piesele de schimb sunt în stoc) de la data înregistrării reclamației scrise a consumatorului.
8. Reparația sau înlocuirea produsului pe baza garanției, nu modifică termenul de garanție indicat la procurare.
9. Garanția nu se extinde asupra accesoriilor, consumabililor normale, substanțelor casabile și în general asupra pieselor ce pot fi achiziționate separat.

Garanția nu este valabilă în următoarele cazuri:

- lipsește documentul care confirmă efectuarea cumpărării;
- documentul de cumpăratură nu se referă la produsul în cauză;
- bunul de casă a fost perfectat după efectuarea cumpărării;
- în cazul utilizării produsului în alt regim de lucru decât în cel stabilit de producător;
- în cazul utilizării produsului în alt regim de lucru decât cel casnic în activități profesionale: restaurant, cantine, servicii către populație, etc);
- în cazul defecțiunilor apărute în urma calamităților naturale, incendii, inundațiilor, alți factori comuni;
- în cazul defecțiunilor mecanice și în cazul defecțiunilor apărute în urma acțiunii mediilor agresive: pământura, insectelor și altele obiecte;
- în cazul substanțelor corozive, prafului, insectelor și altele obiecte;
- în cazul necorespunderii parametrilor/rețetelor de alimentare, telecomunicății, de cabluri cu standardele de stat, precum și de alți factori externi similari (devieri de la frecvența normală cu 0,5%, tensiune cu 10%), lipsa unei faze la rețeaua trifază;
- încălcarea regulilor de exploatare (depunere de calcar, indiferent de tipul și spațiului) acțiunea temperaturilor ridicate asupra pieselor din plastic sau din alte materiale ce nu sunt rezistente la asemenea temperaturi);
- în cazul defectelor apărute în urma transportării sau păstrării încorecte de către cumpărător;
- în urma depistării unor semne ce indică intervenții străine sau intenții de a fi reparat la un alt centru de prestări servicii decât cel autorizat și indicat de către vânzător în talonul de garanție;

Produsul

Model/Tip

Data vânzării / eliberării

Termenul de garanție

Numărul de înregistrare

Compania/locul vânzării/eliberării
(nume, prenume, semnătura și stampila operatorului)

Unitatea autorizată:

Service Centru BOSCH

str. Uzinelor 4, MD 2023 mun.

tel: /+373 22/ 944 986

fax: /+373 22/ 944-987

e-mail: boschservice@volta.md

www.volta.md



Program de lucru

Lu-Vi

8:00-18:00

Si

8:00-16:00

Lu	Mă	Mi	Ju	Vî	Sî	Du
----	----	----	----	----	----	----

Important!

- Am primit instrucțiunile de utilizare;

- Am luat cunoștință:

de condițiile de asigurare/ pierdere a garanției;

de regimul de lucru în care poate fi utilizat produsul;

de faptul că pentru orice intervenție asupra produsului indiferent de gradul de complexitate voi contacta unitatea Service Centru;

ATENȚIE! Produsele care au fost concepute și fabricate pentru a fi utilizate exclusiv pentru scopuri casnice, nu pot fi folosite pentru activități profesionale. Totodată clientul va suporta costurile oricărei solicitări nefondate a unității servicii (utilizare/transport/manipulare/depozitare necorespunzătoare, defecțiuni ale rețelei electrice, apă, gaz etc.

NUMELE ȘI SEMNĂȚURA CUMPĂRĂTORULUI

Stela Varnă-Bu

INSTRUCTION MANUAL FOR AIR COMPRESSORS

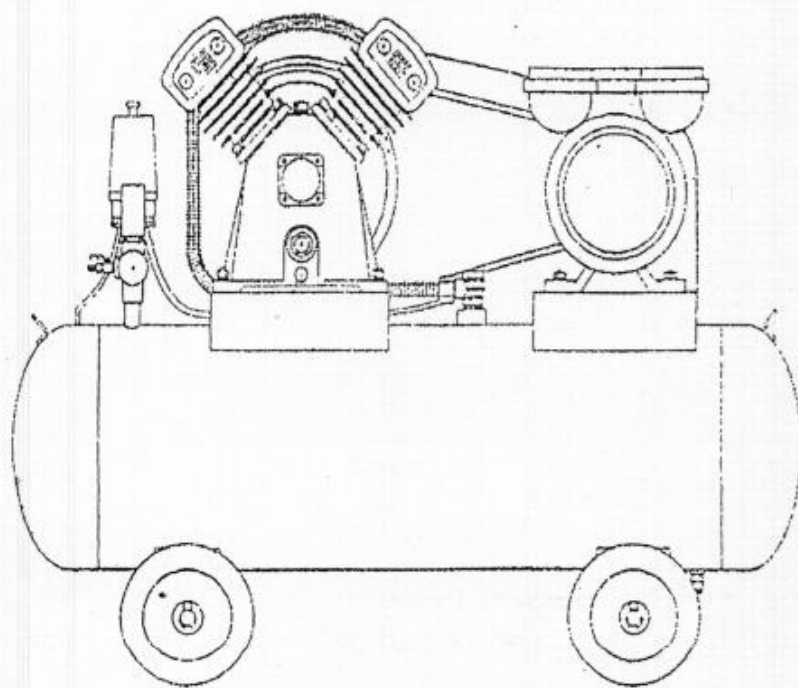

Air Compressor is very popular in every country of the world. You can find its footprints anywhere. With your care-taking, we believe, that will help you with your business ever prosperous is definitely beyond doubt.

Advantages of Air Compressor:

This serial product is the crystallization through gathering the practical, years experiences of the technologists who have engaged in making, assembling, developing, designing, and post-servicing and maintaining of the air compressors. They have got hold of the most important points of the compressor and have used modern thermodynamic theory and fluid mechanic analysis to make out this delicate offer. The serial products have made a long-time-running test. It has been proved their unique quality can be saved by using this compressor.

Structural Features of Air Compressor:

1. Using a special discharging system coupled with Sweden-made ASSAB alloy valves, the best flow-rate is designed, almost 10-30% of capacity efficiency is increased. The air ventilating area is greatly enlarged. With more smooth operation, noises are greatly decreased, while heat radiation becomes much better.
2. The crankshaft and all revolving parts are made of wrought steel through heat treatment and fine grinding. Owing to their high strength, best balance, least vibration, all parts are durable.
3. The cylinder head and the main cast parts are made of first rate cast iron (FC-25) coupled with fine processing, fastened with four screws, never has gas or oil leakage, the highest compression rate can be obtained.
4. All types of fastening and angle are designed under the best steady consideration and are kept above the oil level.

besides, the discharge muzzle of the crankcase being design-crooked can never have leakage.

5. The design of the air tank being on ASME V DIV-1, is absolutely safe and reliable.
6. The piston is specially heat-treated and processed. The piston pins have been worked with carbon treatment.
7. The compression ring and oil control ring job the piston
8. The specially designed filtering silencer, being very effective in filtering ability, is very quiet during working.
9. Will forever meet any technical demands of the customers, running on the solid ground, pursuing high quality and low price as its object, and will guarantee rapid delivery and best post service.

Viewing to the advantages of the Air Compressor mentioned above, choose Air Compressor to create biggest fortune for you will be your most wise decision!

INSTRUCTION MANUAL

CONTENTS:

1. Preface.
2. Check up the machine as you receive it.
3. Preparation and installation of Air Compressor and motor.
4. Notice taken in operation.
5. Pressure adjustment method for the auto-unloading valve and safety valve.
6. Pressure adjustment method of the auto-pressure switch.
7. Trouble and trouble-shooting.
8. Parts list of Air compressor.
9. Reference data and diagrams.

1. Preface.

Your expected Air Compressor has been delivered to you. Perhaps you have already got acquainted with it. However, for it forever does you good service, under a good condition, please spare a little time and read over the instruction manual written through years experience. If you can observe what is said on each paragraph, the Air Compressor will serve you forever and create you a big fortune.

1. Check up the machine as you received it.
2. Whether it is the right type and specification as those You have ordered.
3. Base on the stock list attached to the machine, check to See whether the accessories are complete.
3. Whether there is damage made for any screw loosen during Shipping. If there is any of the above case happened, Please contacts the seller, who will give a satisfactory solution.
3. Air Compressor & motor installation and preparation

Air Compressor installation-site selection:

1. The place which is not humid, little of dust and dirt, with clean air and good ventilation will be suitable and the life of the machine will last longer with increased efficiency.
2. The place is full of light, easy for oiling.
3. The place is easy doing for removing or checking the machine. The machine must be able to be placed as level as possible. The machine must be able to be placed as level as possible. The belt side should be on the wall side, but not too close as to affect the function of the fan. (space above 30cm should be kept).

Motor installation:

1. If you buy the motor yourself, please buy one that has the same horse power (HP) as that the compressor uses.

2. Following the main points as shown in the diagram, install the triangle belt:

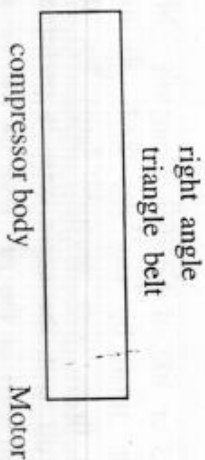

3. Adjust the tightness of the belt to a suitable condition.

The method is to press down the belt at the middle between the two wheels to 10-15mm as is shown in the following figure:

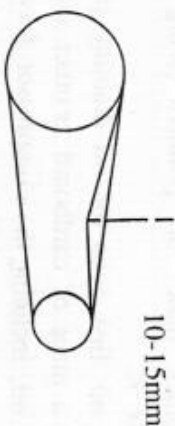

Because (1) if the belt is too tight, loading will increase, the motor jigs easily getting heated and consume more electricity, while the belt will be easily broken. (2) if the belt is too loose, it slips easily and generates high temperature which breaks the belt and makes revolving number unsteady.

Oiling

Generally speaking, the lubricants used in the compressor having high oiliness, comprising of antioxidant, not apt to be thickening or foaming, low carbon remnant and high sparkling points, would be more ideal. Their kinds are generally include:
a Kuo juang special class revolving lub oil R68, R44, & R47 of

- The operating pressure is too high-lower the pressure
 - The inlet tube is too small & too long-change a larger and shorter one
 - The air cleaner or the valve being blocked by accumulated carbon-remove it and clean up.
 - The valve assembly being broken jot incorrectly positioned send it to the technical shop for repair
 - The packing gaving leakage-change a new one
 - The unloading system being damaged out of effect-change a new one
 - The piston ring jot the cylinder being worn out-sent it to the technical shop to repair
- 2 Parts of the compressor being too hot
- The belt being too tight or the central line being out of alignment-read just it
 - The revolving speed being too high-lower the speed
 - improper lubrication-refer to instructions
 - The temperature being too high or a poor ventilation in the surroundings-move to the place with good ventilation
- 3 revolving slow
- Voltage descended-contact the power company to correct
 - The connecting wires being too fine or too long-change to bigger or shorter wires
 - The belt being too loose-adjust the belt
 - The motor being out of work-send to the electric mechanic shop to repair
4. Revolving with drastic vibration
- Discharging pressure being too high-lower the discharging pressure
 - The speed being too high-lower the speed

- The v-belt being improperly mounted or the fly pulley being loosened-readjust it
 - The crankshaft being out of shape-send to the technical shop to repair
5. Create a 'Hai-Hai' sounding during revolving
- The valve seat vein loose-lock the seat tightly
 - The piston pounding the cylinder cover-thicken the packing
 - The connecting bearing alloy being worn out-repair or change the bearing alloy
 - The flu pulley or the flu wheel key dropping off-plug tight
6. Pressure can not be raised or reached a specified pressure
- Poor function of valve plate-grinding to correct or change
 - Valve plate leakage
 - The valve seat ring out of work-change a new one
 - The valve plate stuck with carbon or varnish etc remove and clean or replace a new one
 - The safety valve or the auto-unloading valve having leakage-remove and clean or replace a new one
 - The air valve, draining valve, tube connection or screw having leakage-repair and lock tight or replace it
 - The piston ring being worn out-replace the piston ring
7. The pressure gauge being incorrect-replace it
8. The belt being slippery
- The belt being loose for extension-replace the belt
 - The operating pressure being too high-lower operating pressure
 - The belt being too old-replace it
9. The lob oil consumed too much
- Oiling too much-adjusted oil lever
 - The piston ring being worn out-replace it

- The motor being out of work-send to the electro mechanic shop to repair
 - 2. The motor grumbling without start
 - The supply wire or fuse being broken-replace a new one
 - The voltage dropping low-consult the electric power company for repair
 - The discharge valve having leakage-remove the valve and repair
 - The supply wire being wrong-replace the wire
 - The motor being out of work-send to the electro mechanic shop for repair.
 - The motors being over-loading-lower the loading
 - The crankshaft being too tight-remove and repair
 - 8. The parts list of Air Compressor
 - For the convenience and good service to customers, this Company has prepared
 - Air compressor parts list. When you need our service or replacing parts, the only thing to do is to notify this company of the Model of the Compressor, horse power, the serial number and quantity of the parts needed, you will immediately acquire a satisfactory service without delay.
 - Please refer to the Air Compressor main parts chart and write out the serial number of the parts needed.
- For example:
1. The part needed to replace is the inlet valve assembly Model SF-1 (1/4HP Semi-auto), then you can write us: SF-1-A
 2. The part needed to replace is the piston of Model SF-2P (1/2HP) ALL Auto), you can write us: SF-2P-2002.
 3. The part needed to replace is the pressure switch of Model SF-310P (10HP ALL Auto), you can write us: SF-310P-4013.

PARTS LIST		
NO.		Parts in English
1		Bolt
2		Spring washer
3		Shaft end washer
4		Fly pulley
5		Bolt
6		Bearing cover
7		bearing cover packing
8		Bearing
9		Circle for shaft
10		Bearing
11		Crankshaft
12		Circle for hoe
13		Cranky case
14		Oil draining gins
15		Oil leveler
16		Oil leveler washer
17		Connecting rod
18		Piston
19		Piston pin
20		Piston pin snap ring
21		Cylinder packing
22		Cylinder
23		Valve gasket
24		Lower valve plate
25		Valve inner gasket

- 1 Bolt
- 2 Spring washer
- 3 washer
- 4 Fly pulley
- 5 Bolt
- 6 Spring washer
- 7 Bearing cover
- 8 Oil seat
- 9 Bearing gasket
- 10 Bearing
- 11 Circllet for shaft
- 12 Bearing
- 13 Crankshaft
- 14 Cranky case
- 15 Breathing cover washer
- 16 Breathing cover
- 17 Cylinder head packing
- 18 Connecting rod
- 19 Piston
- 20 Piston pin
- 21 Piston pin snap ring
- 22 Compressor ring
- 23 Compressor ring
- 24 Oil control ring
- 25 Cylinder head
- 26 Air cleaner
- 27 Socket cap screw
- 28 Spring washer
- 29 Discharge joint
- 30 Discharge thrust washer

- 31
- 32
- 33
- 33

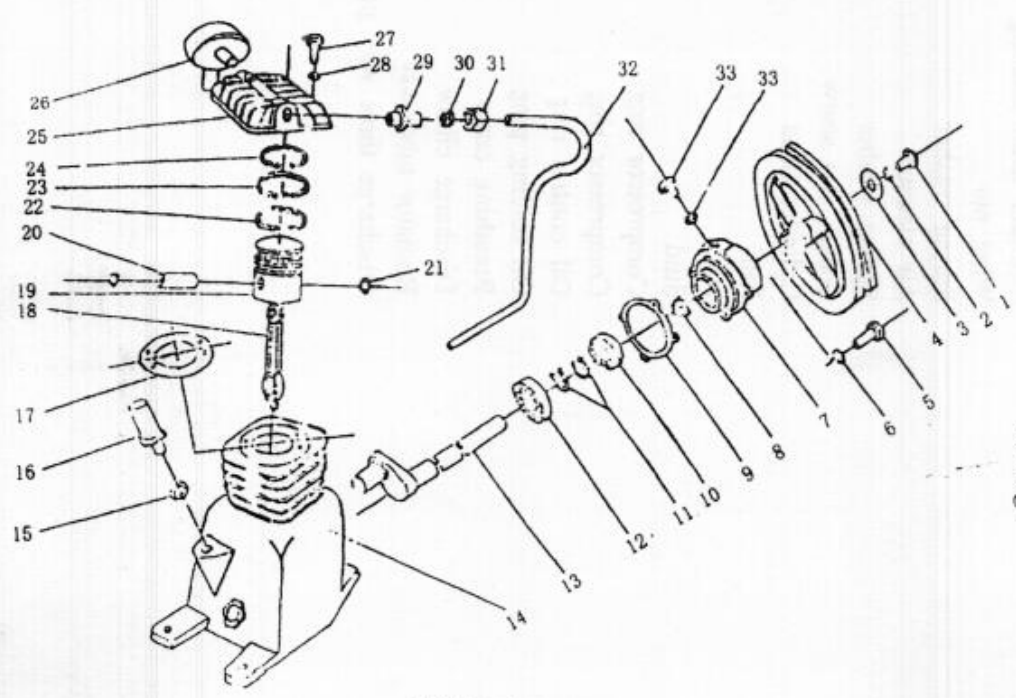

- Tube nut
- Discharge tube
- Oil folding ping
- O ring

Belt drive main compressor

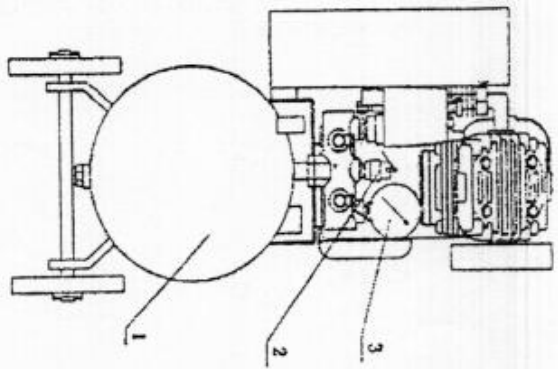

- 1. Air tank 2. Safety valve 3. pressure gauge 4. Outlet valve 5. Pressure switch
- 6. air cleaner 7. Main compressor 8. oil folling ping 9. one-way valve 10. V-belt 11. Pulley shield
- 12. Moter 13. Drain cock

belt drive air compressor

