



REGIONAL ANAESTHESIA  
Spinal & combined spinal-epidural anesthesia



Value Life

# Spinal anesthesia and lumbar puncture

A complete range

- **Large choice** of needle gauges for spinal puncture
- **Short lengths** for paediatrics
- **Extra long** needles and **long** introducer for obese patients
- Two bevels available

## • Quincke bevel



To perform an effective lumbar puncture with a rapid return of C.S.F (Cerebro Spinal Fluid).

## • Pencil Point bevel



For intrathecal injections to reduce the risk of post spinal headache. The shape, size and positioning of the eye ensure proper needle placement and excellent C.S.F response time.

# Ergonomic and safe spinal needles

- Ergonomic crystal-clear hub
  - **Visualization window** for an immediate visualization of Cerebro Spinal Fluid flashback.
  - **Ergonomic design** to ensure easy handling.



- Precision matched stylet:
  - On removal, the precision matched stylet assists aspiration of C.S.F: **Quick recognition of needle tip position.**
  - **Reduces** tissue coring risks
  - **Rapid identification of the position** of the lateral eye for Whitacre needles and the bevel position for Quincke needles thanks to the stylet's stop lug.

- Introducer with metal hub
  - The spinal needle **slides smoothly** in the introducer's hub without damaging the needle bevel.



- **introspin**: new long introducer 20G - 68mm
  - For 120 and 145 mm long spinal needles. It is graduated and echogenic to provide safe insertion.



# Combined spinal epidural anesthesia

## Easy to use set

- A Tuohy needle featuring a **back eye** at the distal end which allows the spinal needle to pass.
- A **Whitacre needle** with 25 or 27 gauge to minimize leakage of C.S.F.
- A mark indicating the **exit point of the Whitacre needle** (1) from the back eye (2) of the Tuohy needle.

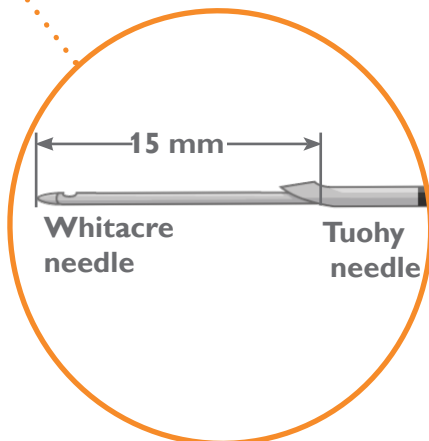
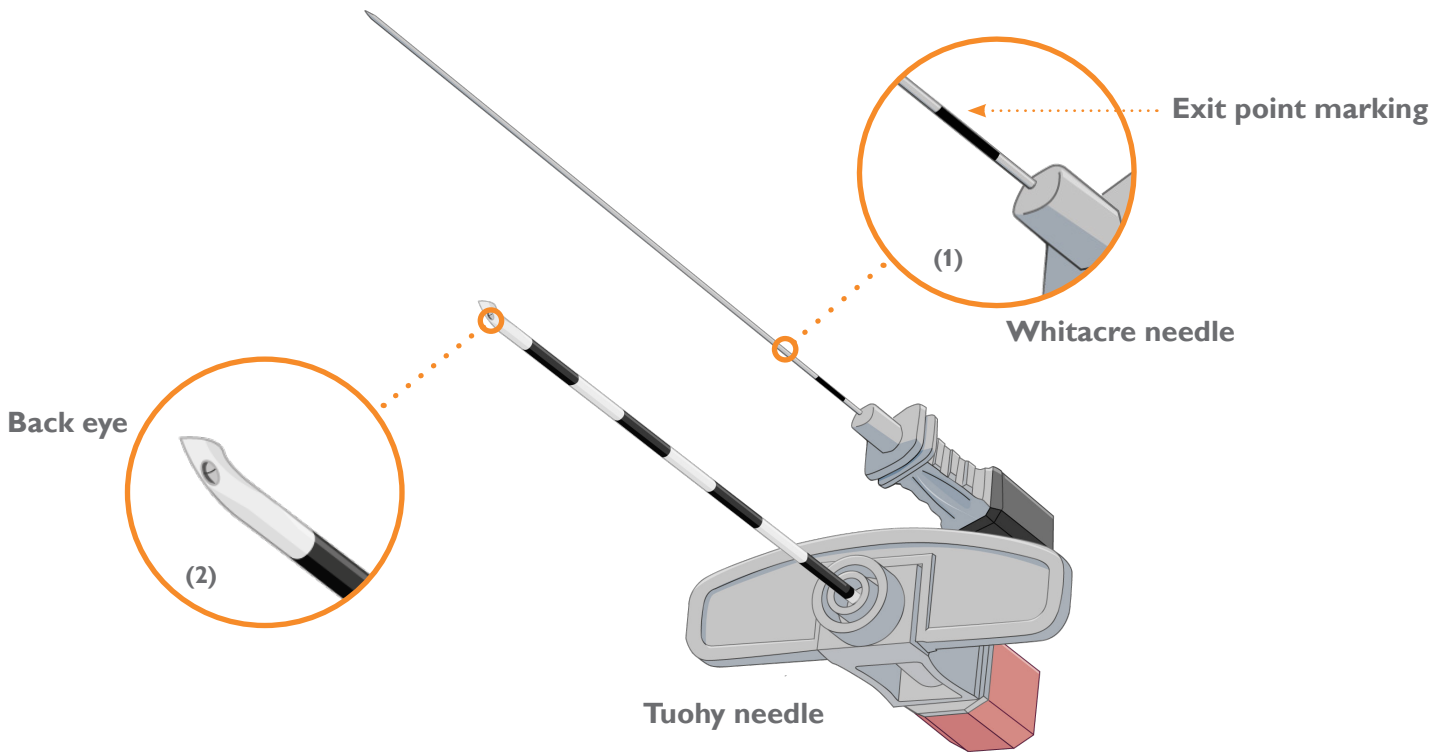

**Special length of the Whitacre needle to offer a 15 mm protrusion.**

## Set for combined spinal-epidural anesthesia

- 6186.042 and 6186.052, two standard sets

### Choice between :

- A Whitacre needle **25G**- Length **118mm** - ref. 6186.052
- or
- A Whitacre needle **27G**- Length **118mm** - ref. 6186.042
- with
- A 18G Tuohy needle with back eye - Length 80mm
- A low resistance syringe, 10 ml
- 1 20G epidural catheter with closed tip, 3 lateral eyes and **flexible distal end**.
- 1 flat filter 0.22µm

## Mini set for combined spinal-epidural anesthesia

- 192.201:
- A **27G** Whitacre needle - Length 118mm
- A 18G Tuohy needle with back eye - Length 80mm

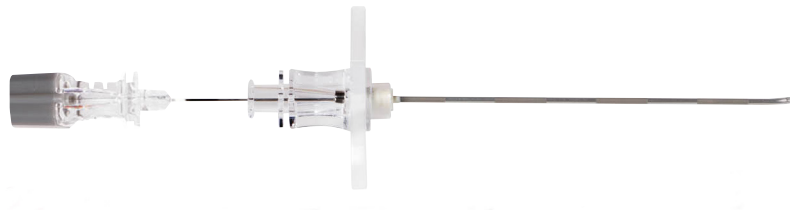

- 192.202
- A **25G** Whitacre needle - Length 118mm
- A 18G Tuohy needle with back eye - Length 80mm



## Complete set for spinal anesthesia

- 199.30:
- **1 Whitacre needle 25G-90mm with metal hub introducer 20G-38mm**
- 1 Luer-slip syringe 10 ml
- 1 Luer-slip syringe 5 ml
- 1 Luer-lock syringe 3 ml
- 2 hypodermic needles 25G-16mm and 21G-40mm
- 1 filter needle 18G
- 1 square gallipot 60ml
- 1 blue forceps
- 4 ball swabs small XRO and 2 ball swabs large XRO
- 1 fenestrated peelable drape 100x80cm
- 1 towel
- 1 transparent tray



## VYSET®

### Custom packs

#### Why choose customization?

Customization with Vyset enables you to create a pack specific to your requirements, standardizing insertion procedures and ensuring maximum barrier precautions, therefore reducing the associated risk of infection.

#### Saving time and money

- Reducing preparation time
- Improving stock management
- Reducing waste

#### Improving safety

- Reducing the risk of infection
- Reducing the risk of errors
- Improving working conditions
- Simplifying procedures which helps in emergency cases or when a practitioner works alone
- Traceability (one label + barcode)

#### The Vygon expertise

- Assembly and sterilization in our own facilities in Europe
- Selection of only high quality medical devices
- Sales Team at your disposal to provide any additional training, help and advice needed to ensure your pack is a success
- Continuous monitoring of ordering trends to ensure continuity of supply.

**VYSET®** in... operating room - vascular access - **regional anesthesia** - neonatology - homecare



#### • Trays for spinal anesthesia or lumbar puncture

In addition to the standard trays, Vygon also manufactures customized kits for your special needs. These sets can contain various items such as: drapes, gallipots, gauze dressings, needles, etc. For customized sets, please contact your Vygon representative.

## Needles references

| Quincke bevel  |        |        |        |        |            |        |
|---|--------|--------|--------|--------|------------|--------|
|   | Needle |        |        |        | Introducer |        |
| Code  | Size G | L (mm) | Ø (mm) | Colour | L (mm)     | Ø (mm) |
| 180.93  | G29    | 90     | 0.35   | ●      | 38         | 0.7    |
| 180.04  | G27    | 90     | 0.42   | ●      | 38         | 0.7    |
| 5180.04   | G27    | 90     | 0.42   | ●      | -          | -      |
| 180.74  | G26    | 75     | 0.47   | ●      | 38         | 0.9    |
| 180.94  | G26    | 90     | 0.47   | ●      | 38         | 0.9    |
| 5180.94   | G26    | 90     | 0.47   | ●      | -          | -      |
| 5180.35   | G25    | 30     | 0.53   | ●      | -          | -      |
| 180.55  | G25    | 50     | 0.53   | ●      | -          | -      |
| 180.75  | G25    | 75     | 0.53   | ●      | 38         | 0.9    |
| 5180.75   | G25    | 75     | 0.53   | ●      | -          | -      |
| 180.05  | G25    | 90     | 0.53   | ●      | 38         | 0.9    |
| 5180.05   | G25    | 90     | 0.53   | ●      | -          | -      |
| 5180.76   | G23    | 75     | 0.60   | ●      | -          | -      |
| 183.47  | G22    | 38     | 0.70   | ●      | -          | -      |
| 5183.57   | G22    | 50     | 0.70   | ●      | -          | -      |
| 5183.77   | G22    | 75     | 0.70   | ●      | -          | -      |
| 183.97  | G22    | 90     | 0.70   | ●      | -          | -      |
| 5180.27   | G22    | 120    | 0.70   | ●      | -          | -      |
| 5180.07   | G22    | 150    | 0.70   | ●      | -          | -      |
| 183.49  | G20    | 38     | 0.90   | ●      | -          | -      |
| 5183.59   | G20    | 50     | 0.90   | ●      | -          | -      |
| 5180.79   | G20    | 75     | 0.90   | ●      | -          | -      |
| 183.99  | G20    | 90     | 0.90   | ●      | -          | -      |
| 5183.51   | G19    | 50     | 1.10   | ●      | -          | -      |
| 5183.71   | G19    | 75     | 1.10   | ●      | -          | -      |
| 183.91  | G19    | 90     | 1.10   | ●      | -          | -      |
| 5183.52   | G18    | 50     | 1.20   | ●      | -          | -      |
| 5183.72   | G18    | 75     | 1.20   | ●      | -          | -      |
| 183.92  | G18    | 90     | 1.20   | ●      | -          | -      |

| Whitacre bevel  |        |        |        |        |            |        |
|---|--------|--------|--------|--------|------------|--------|
| Needle  |        |        |        |        | Introducer |        |
| Code  | Size G | L (mm) | Ø (mm) | Colour | L (mm)     | Ø (mm) |
| 181.03  | G29    | 90     | 0.35   | ●      | 38         | 0.7    |
| 5181.23   | G29    | 120    | 0.35   | ●      | -          | -      |
| 181.04  | G27    | 90     | 0.42   | ●      | 38         | 0.7    |
| 5181.24   | G27    | 120    | 0.42   | ●      | -          | -      |
| 181.34  | G27    | 135    | 0.42   | ●      | 38         | 0.7    |
| 181.44  | G27    | 145    | 0.42   | ●      | 38         | 0.7    |
| 181.94  | G26    | 90     | 0.47   | ●      | 38         | 0.9    |
| 5181.94   | G26    | 90     | 0.47   | ●      | -          | -      |
| 5181.45   | G25    | 38     | 0.53   | ●      | -          | -      |
| 181.75  | G25    | 75     | 0.53   | ●      | 38         | 0.9    |
| 181.05  | G25    | 90     | 0.53   | ●      | 38         | 0.9    |
| 5181.05   | G25    | 90     | 0.53   | ●      | -          | -      |
| 181.25  | G25    | 120    | 0.53   | ●      | 38         | 0.9    |
| 181.254   | G25    | 120    | 0.53   | ●      | 68         | 0.9    |
| 181.45  | G25    | 145    | 0.53   | ●      | 38         | 0.9    |
| 181.454   | G25    | 145    | 0.53   | ●      | 68         | 0.9    |
| 5181.185  | G25    | 185    | 0.53   | ●      | -          | -      |
| 181.95  | G24    | 90     | 0.55   | ●      | 38         | 0.9    |
| 181.07  | G22    | 90     | 0.72   | ●      | -          | -      |
| 5181.27   | G22    | 120    | 0.72   | ●      | -          | -      |

| Sequential spinal-epidural anesthesia |        |        |        |        |            |        |
|---------------------------------------|--------|--------|--------|--------|------------|--------|
|                                       |        |        |        |        | Introducer |        |
| Code                                  | Size G | L (mm) | Ø (mm) | Colour | L (mm)     | Ø (mm) |
| 5181.242                              | G27    | 118    | 0.42   | ●      | -          | -      |
| 5181.252                              | G25    | 118    | 0.53   | ●      | -          | -      |
| 5181.243*                             | G27    | 128    | 0.42   | ●      | -          | -      |
| 5181.253*                             | G25    | 128    | 0.53   | ●      | -          | -      |

\* Whitacre needle to be used with Tuohy needle ref. 184.18 (G18- 90mm) for combined spinal-epidural anesthesia set with 15mm protrusion of the spinal needle.

| Introducers |                          |        |        |
|-------------|--------------------------|--------|--------|
| Code        | Gauge                    | L (mm) | Ø (mm) |
| 179.49      | Introducer G18           | 38     | 1.2    |
| 179.45      | Introducer G20           | 38     | 0.9    |
| 179.756     | Introducer introspin G20 | 68     | 0.9    |



## Bibliography

- “Céphalées post-anesthésie”, Frédéric Aubrun, Le Praticien en anesthésie réanimation, 2004, 8, 3 ; pp. 183-191
- “Indication de la Rachianesthésie en 2001”, F. Bonnet, E. Marret, Evaluation et traitement de la douleur 2001, pp. 7-14
- “The history of spinal needles : getting to the point”, N. Calthorpe, Anesthesia, 2004, 59, pp. 1231-1241

### ANAESTHESIA EMERGENCY

**For further information, please contact: [questions@vygon.com](mailto:questions@vygon.com)**

The specifications given in this brochure are for information only and are not, under any circumstances, of a contractual nature.

---

Vygon – 5, rue Adeline • 95440 ECOUEN • FRANCE  
Reception: +33 (0)1.39.92.63.63 – Service clients France: +33 (0)1.39.92.63.81  
Export customer service: +33 (0)1.39.92.64.15  
Fax: +33 (0)1.39.92.64.44 • [www.vygon.com](http://www.vygon.com)



[www.vygon.com](http://www.vygon.com)