

■ HYRIDIA 7 LED LIGHTS - 65,000 LUX

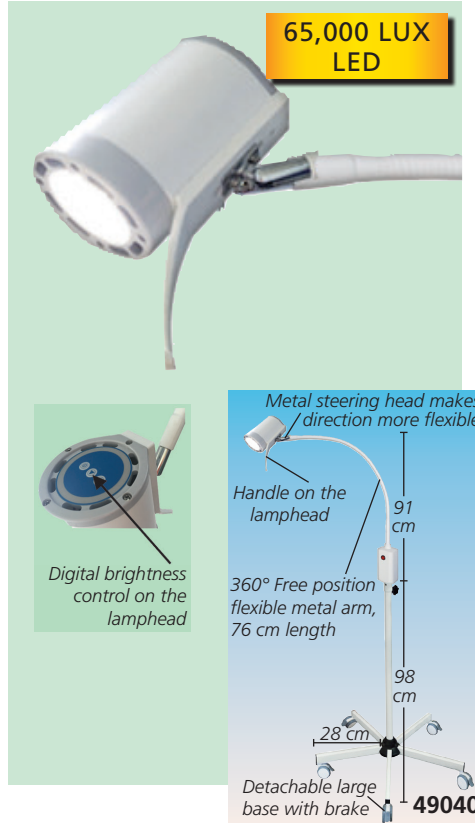

- 49040 HYRIDIA 7 LED LIGHT - flexible arm - trolley
 - 49041 HYRIDIA 7 LED LIGHT - metal spring arm - trolley
- 7 Leds 10 W medical procedure lights on trolley with flexible soft arm or metal spring arm. Digital brightness control.
Manual: GB, FR, IT, ES, PT, DE, PL, GR.

TECHNICAL SPECIFICATIONS

Consumption:	10 W	Light intensity and Light field Ø:			
Colour temperature:	4,800-5,500 °K	Illumination	Ø	Distance	
External Ø of reflector:	89 mm	78,000 lux	9 cm	30 cm	
Colour rendering index (CRI):	75 Ra	65,000 lux	12 cm	50 cm	
Operating voltage:	110-265 V, 50/60 Hz	22,000 lux	18 cm	100 cm	

■ LUMINA LED LIGHT



- 49035 LUMINA LED LIGHT - trolley
- Classic examination LED light with flexible arm.
Manual: GB, FR, IT, ES, PT, DE, PL, GR.

TECHNICAL SPECIFICATIONS

Consumption	3 W
Light intensity at 50/30 cm	37,000/89,000 lux
Colour temperature:	6,000 °K
External Ø of reflector:	75 mm
Colour rendering index (CRI):	75 Ra
Light field Ø:	4 cm at 50 cm
Operating voltage:	110-265 V, 50/60 Hz

■ RI-MAGIC® HP LED LIGHT

- 49050 RI-MAGIC® HP LED - desk
 - 49051 RI-MAGIC® HP LED - trolley
 - 49052 RI-MAGIC® HP LED - wall
- High performance medical LED light for examination and procedures.
- high performance LED, 6,000 °K
 - lifetime of the lamp up to 50,000 hours
 - significantly reduced heating and energy loss
 - focusing device at the front of the light head
 - highly flexible, long special arm can be bent in all directions
 - rheostat handle for infinitely variable regulation of light intensity.
- Manual in: GB, FR, IT, ES, DE, RU.



MADE IN GERMANY

TECHNICAL SPECIFICATIONS

Distance:	1,000 mm	800 mm	600 mm	400 mm	200 mm
Lux max:	15,000	20,000	30,000	45,000	55,000
Circle of light max Ø:	340 mm	270 mm	215 mm	155 mm	90 mm
Circle of light min Ø:	40 mm	35 mm	30 mm	25 mm	20 mm
Operating voltage:	100-240 V,	50-60 Hz			

■ LED SPOT-ADJUSTED LIGHT

- 49047 LED SPOT-ADJUSTED LIGHT - trolley
- LED Spot examination lamp with multi-optical lens and light spot adjustable by inner mini light grating.
- Additional features:
- uniform and pure light spot
 - front optical lens
 - inner light grating
 - rear dual optical lens
 - 100 cm super long 360° free position and PVC coated flexible metal arm



TECHNICAL SPECIFICATIONS

Bulbs/power:	1 LED / 5 W
Ø of lamp head:	25 mm
Illumination:	25,000 lux at 30 cm
	10,000 lux at 50 cm
Light field Ø:	max 70 mm,
	min 15 mm at 30 cm
Colour temperature:	4,800°-6,000° K
Lamphead:	Ø 25 mm, length 125 mm
Power supply:	100-260 V, 50/60 Hz
Power cord:	length 272 cm