

ATS-102 Automatic Tourniquet System(double channel)



Features:

1. The system adopts imported transducer with the function of calculating and equalizing the pressure, and high quality motor has features of low noise, pressure rising quickly.
2. Import CPU controls the pressure exactly and the display data is very clear.
3. With self-check function at start.
4. Proximal and distal air passage outlets
5. IVRA function, suitable for complex operations.
6. The electromagnetic valve can deflate automatically.
7. The automatic tourniquet system includes the main body and cuff.
8. The cuff has three standard size, each suitable for adults' lower limb, adults' upper limb and children's limbs. And customized size is available according to your need.
9. With stand and basket
10. 6 pcs of cuffs:12inch 18inch 34inch(each size 2 pcs)

Technical Parameters:

Power supply : **AC100-240V 50Hz/60Hz**

Pressure display unit: Kpa or mmHg(according to your requirement)

Input power :≤80W

Range of pressure :25-650mmHg

Precision of pressure :≤6mmHg

Maximum working time : 240 min

Maximum alarm time : 4 times

Inside Battery : Lithium-ion battery,2000mAh

Package size:

Main machine: 320*300*395mm, Gross weight: 5.6kgs

base:650*650*180mm, 4.6kg Basket: 280*280*350mm, 1.3kg

ATS103 8 inch Touch Display Automatic Tourniquet System(double channel)

Number of Ports :Dual Port

Mounting options :Table or Moving bracket

Battery Type and Duration : Lithiumlon / 4 hrs

Touchscreen User Interface

6 pcs of cuffs:12inch 18inch 34inch(each size 2 pcs)

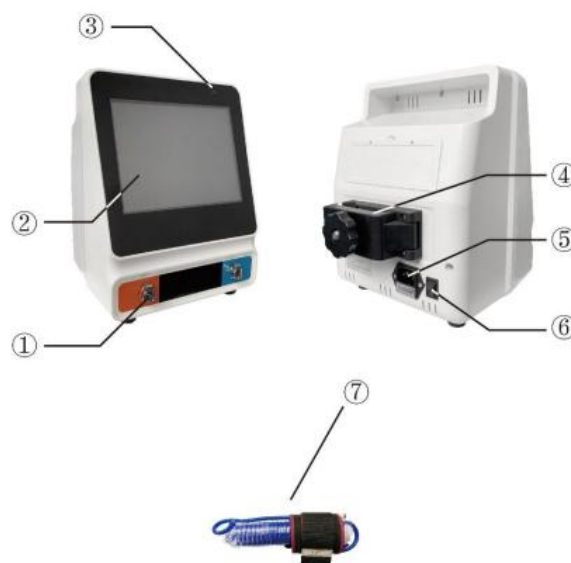

8" Color Display

Technical Features

Product Name	8 inch Touch Display Automatic Tourniquet System(double channel)
Working Conditions	a) Ambient temperature: 5 °C-40 °C
	b) Relative Humidity: ≤ 85%
	c) Atmospheric Pressure: 860hPa- 1060hpa
	d)PowerSupply : AC100-240V 50Hz/60Hz
	e)rated input power: 90VA
Performance	The pressure range of the rated output air pressure can be controlled from 30 mmHg to 650 mmHg;
	Inflation time at maximum rated air pressure (from pressure less than30 mmHg) should be ≤ 60 s
	Work noise ≤ 80dB
	The pressure is controllable, and the pressure can be stabilized at ± 10 mmHg.
Continuous	240min
Package	620*620*430mm, 13KGS

ATS100 Single channel Automatic Tourniquet System

Features:

1. Meter displays pressure, adjusting facility
2. Working pressure automatic compensation and keeping.
3. 3pcs of cuffs:12inch 18inch 34inch(each size 1 pcs)

Technical Parameters:

Power supply : **AC100-240V 50Hz/60Hz**

Maximum pressure: 90Kpa(675mmHg)

Time set : 0-99min

Pressure control precision :≤5kpa

Initial Inflate time : ≤20s (cuff in non-freedom state)

Noise: ≤55db

Power : ≤80W

Package: 320*300*395MM, G.W.: 5kgs

ATS-101 Automatic Tourniquet System(single channel)



Features:

1. The system adopts imported transducer with the function of calculating and equalizing the pressure, and high quality motor has features of low noise, pressure rising quickly.
2. Import CPU controls the pressure exactly and the display data is very clear.
3. Working pressure automatic compensation and keeping.
4. The electromagnetic valve can deflate automatically.
5. The automatic tourniquet system includes the main body and cuff.
6. The cuff has three standard size, each suitable for adults' lower limb, adults' upper limb and children's limbs(12inch 18inch 34inch(each size 1 pcs)
7. And customized size is available according to your need.

Technical Parameters:

Power supply : **AC100-240V 50Hz/60Hz**

Maximum pressure :90Kpa (675mmHg)

Time set : 0-99min

Pressure control precision :≤5kpa

Initial Inflate time : ≤20s (cuff in non-freedom state)

Noise : ≤55db

Power : ≤25W

330*310*400mm, Gross weight: 5.28kgs

base:650*650*180mm, 4.86kg

Basket: 280*280*350mm, 1.53kg



Mobile bracket for Automatic Tourniquet System



Suit to ATS101, ATS102, ATS103

Height can be adjusted to 1.1M

With basket for cuffs

TPU CUFF

1. High-strength TPU environmental protection material, anti-aging, anti-mildew
2. With anti-twist effect, the pressure distribution.
3. The pressure within the liner design with maximum pressure $\geq 120\text{Kpa}$
4. International brand requirements and interface style
5. ethylene oxide sterilization, not pasteurized, can alcohol wipe.



Specifications:

size	Length*width	application
8"	210mm * 80mm	Child Upper limb
12"	300mm * 90mm	Upper limb of children
15"	380mm*100mm	Low limb of children /adult upper limb
18"	450mm * 105mm	Low limb of children
24"	600mm * 105mm	Fat person upper limb/thin person lower limb
34"	850mm * 105mm	Adult lower limb
44"	1100mm * 105mm	Extra fat person