

PCR Tube

Cat.No. 661301-661320



Product Description:

PCR Single Tube is an individual, thin-walled PCR tube with its own integrated cap, usually 0.2 ml or 0.5 ml. PCR Tube Strips are thin-walled tubes in strip format. Cap Strips are tube lids for PCR Tube Strips and PCR plates.

Specification:

Components: PCR Tubes are made from specialized plastic that facilitates efficient heat transfer. The caps serve to prevent contamination, minimize evaporation, and retain the reaction volume during thermal cycling.

Material: Polypropylene

Volume: 0.1ml, 0.2ml, 0.5ml

Color: transparent/white/colored

RNAse, DNase and pyrogen free.

Intended use:

PCR Single Tube and PCR Tube Strips are designed for single use in PCR applications.

The products can be used for training, routine and research laboratories in the areas of life science individually, industry or chemistry. This product is intended to be used for research purposes only.

Application: PCR tubes are specialized tubes used in polymerase chain reaction (PCR) to amplify DNA.

1. PCR Single Tubes: Ideal for small-scale PCR or low-throughput experiments.
2. PCR Strip Tubes: Suitable for medium-throughput labs needing multiple reactions or replicates in a single run.

Warning:

1. Risk from hazardous substances
 - Only use undamaged tubes and plates.
 - Do not fill the tubes and plates above the permitted total volume.

PCR Tube

Cat.No. 661301-661320

- Make the necessary safety arrangements for transport or storage to prevent materials from escaping from the tube. Use stands that are suitable for the tubes.
- Do not freeze the tubes and plates with liquid nitrogen.
- Seal the tubes and plates carefully.

2. Damage to health from toxic, radioactive or aggressive chemicals as well as infectious liquids and pathogenic germs.

- Observe the national regulations for handling these substances, the biological security level of your laboratory, the material safety data sheets and the manufacturer's application notes.
- Wear personal protective equipment.

3. Risk of contamination

- Please check that the packaging is undamaged.
- Only open the packaging immediately before use.
- Only use visually perfect and undamaged items.

Caution: Contamination risk when disposing of used consumables.

- Dispose of used consumables in accordance with the substances with which they have come into contact.
- Observe the rules applicable to your lab.

Notice: Material damage from incorrect use.

- Only use the product for its intended purpose as described in the operating manual.
- Ensure adequate material resistance when using chemical substances.

Instruction For Use:

1. Closing tube strip with cap strips
 - Position the Cap Strips marked A and H on a tube strip or 96-well PCR plate.
 - Press the Cap Strips firmly onto the tubes.
 - Check that the Cap Strips are correctly positioned on the tube strip or 96-well PCR plate.
2. Removing cap strips
 - Pull the Cap Strips off upward.

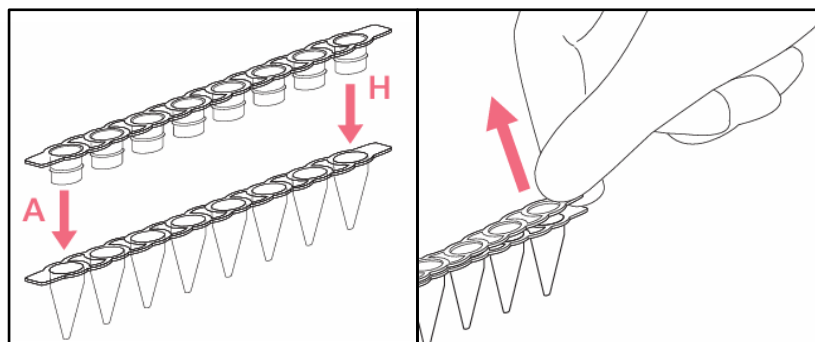

Storage:

1. Protect from direct sunlight and UV light.
2. Store dry at room temperature.

Shelf Life: 5 years

PCR Tube Sizes:

| Cat No. | Description | Package |
|---------|---|---------------------------|
| 661301 | 0.1ml PCR strip tube, 4 strips | 250strips/bag, 10bags/ctn |
| 661302 | 0.1ml PCR strip tube, 8 strips, flat cap, clear tube | 125strips/bag, 10bags/ctn |
| 661303 | 0.1ml PCR strip tube, 8 strips, flat cap, white tube | 125strips/bag, 10bags/ctn |
| 661304 | 0.1ml PCR strip tube, 8 strips, domed cap, clear tube | 125strips/bag, 10bags/ctn |
| 661305 | 0.1ml PCR strip tube, 8 strips, domed cap, white tube | 125strips/bag, 10bags/ctn |
| 661306 | 0.1ml PCR strip tube, 8 strips, attached flat cap, clear tube | 125strips/bag, 10bags/ctn |
| 661307 | 0.2ml PCR single tube, flat cap, clear tube | 1000pcs/bag, 10bags/ctn |

PCR Tube

Cat.No. 661301-661320

| | | |
|--------|--|---------------------------|
| 661308 | 0.2ml PCR single tube, domed cap, clear tube | 1000pcs/bag, 10bags/ctn |
| 661309 | 0.2ml PCR single tube, flat cap, green tube | 1000pcs/bag, 10bags/ctn |
| 661310 | 0.2ml PCR single tube, flat cap, blue tube | 1000pcs/bag, 10bags/ctn |
| 661311 | 0.2ml PCR single tube, flat cap, pink tube | 1000pcs/bag, 10bags/ctn |
| 661312 | 0.2ml PCR single tube, flat cap, yellow tube | 1000pcs/bag, 10bags/ctn |
| 661313 | 0.2ml, PCR strip tube, 8 strips, flat cap, clear tube | 125strips/bag, 10bags/ctn |
| 661314 | 0.2ml, PCR strip tube, 8 strips, domed cap, clear tube | 125strips/bag, 10bags/ctn |
| 661315 | 0.2ml, PCR strip tube, 8 strips, flat cap, white tube | 125strips/bag, 10bags/ctn |
| 661316 | 0.2ml, PCR strip tube, 8 strips, domed cap, white tube | 125strips/bag, 10bags/ctn |
| 661317 | 0.2ml, PCR strip tube, 8 strips, attached flat cap, clear tube | 125strips/bag, 10bags/ctn |
| 661318 | 0.5ml PCR single tube, flat cap, clear tube | 1000pcs/bag, 10bags/ctn |
| 661319 | 0.5ml PCR single tube, flat cap, green tube | 1000pcs/bag, 10bags/ctn |
| 661320 | 0.5ml PCR single tube, flat cap, purple tube | 1000pcs/bag, 10bags/ctn |