

Adaption SDI® 4 / BIOM® 5 to Zeiss OPMI Lumera/ Lumera T/ i/ 700

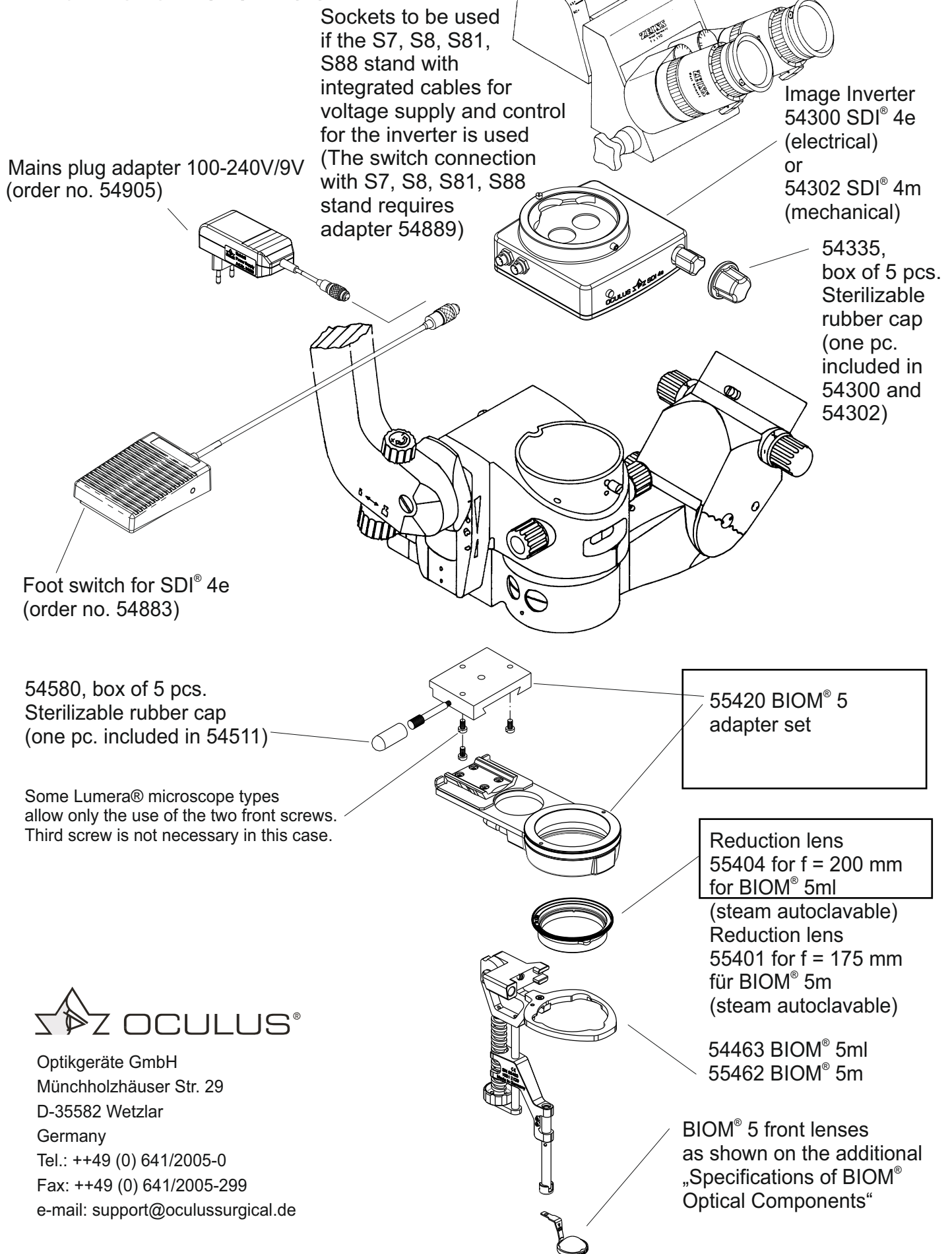

Optikgeräte GmbH
Münchholzhäuser Str. 29
D-35582 Wetzlar
Germany
Tel.: ++49 (0) 641/2005-0
Fax: ++49 (0) 641/2005-299
e-mail: support@oculussurgical.de

Adaption SDI® 4 / BIOM® 5 to Zeiss OPMI Lumera/ Lumera T/ i/ 700

Attention: All safety relevant hints are specified in the manuals of SDI® and BIOM®. It is mandatory to read the instruction manual of the BIOM® prior to mounting and use of the adapter.

54300	SDI® 4e 6 V - 15 V
or	
54302	SDI® 4m

Options, Accessories

54885	Extension cord to switch for SDI® 4e (5-pin), length 5m
54905	Mains plug adapter (100-240V/9V) for SDI® 4c/e
54898	Extension cord to mains plug adapter, length 5m
54883	Foot switch for SDI® 4e (5-pin)
54335	Sterilizable rubber cap for adjustment knob of SDI® 4 (box of 5)
54878	Dual switch adapter for SDI® 4

The above mentioned accessories are not necessary if the cable for voltage supply and control of the inverter is integrated in the S7, S8, S81, S88 stand.

54888	Cable adapter 5-pin to 2-pin
54889	Cable adapter 2-pin to 5-pin
55463	BIOM® 5ml, mechanically focused (long version) recommended for microscope objective f = 200 mm
55404	Reduction lens for f = 200 mm for BIOM® 5ml (steam autoclavable)
55462	BIOM 5m, mechanically focused (standard version) recommended for microscope objective f = 175 mm
55401	Reduction lens for f = 175 mm for BIOM® 5m (steam autoclavable)
G/536XX	BIOM® 5 front lenses as shown on the additional Specifications of BIOM® Optical Components
55423	BIOM® 5 adapter plate
54511	Dovetail for OPMI VISU 200/210, OPMI VISU 150/160, OPMI Lumera/ Lumera T/ Lumera i/ Lumera 700
54580	Sterilizable rubber cap for dovetail, (box of 5 pcs.)

The following parts are included in 55420:

55423	BIOM® 5 adapter plate
54511	Dovetail for OPMI VISU 200/210, OPMI VISU 150/160, OPMI Lumera/ Lumera T/ Lumera i/ Lumera 700

Copyright by

