

StereoBlue

HIGHLIGHTS

- Designed for professional use
- Crisp, high resolution images
- Provided with APL (Anti-bacterial Protection Layer)
- Robust and sturdy
- Dual magnifications or Zoom models
- Available with ergonomic rack & pinion, pillar, universal (single arm) and boom stand (dual arm)
- LED illumination
- Ergonomic carrying grip
- 5 years warranty

TECHNICAL SPECIFICATIONS

EYEPIECES

Pair of WF10x/21 mm secured eyepieces supplied with eyecups

HEAD

- Binocular or trinocular 45° inclined tubes
- Diopter adjustment on both eyepieces, except the models SB.1302-P/1402-P and SB.1302/1402, which have diopter adjustment on one side
- Interpupillary distance adjustable between 55 mm and 75 mm
- Trinocular head is supplied with a fixed light path beamsplitter (50:50)

All optics are anti-fungus treated and anti-reflection coated for maximum light throughput

DUAL MAGNIFICATION MODELS

- Nosepiece with dual 1x/3x or 2x/4x revolving objectives
- Magnifications 10x/30x or 20x/40x (can be enlarged to 135x)
- Field of view 21 mm/6.9 mm or 10.5 mm/5.2 mm
- Working distance 100 mm

ZOOM MODELS

- Stereo Zoom 0.7x to 4.5x parafoal objective
- Magnification from 7x to 45x
- Field of view 29.9 mm to 4.6 mm
- Working distance 100 mm

STANDS

- The rack & pinion and pillar stands of the StereoBlue are equipped with ergonomically designed flat bases, complete with two object clamps and Ø 60 mm transparent and black/white stage plate
- The coarse adjustment is equipped with tension control
- The ergonomically designed universal (single arm) and boom stand (dual arm) are ideal for looking at large samples or working under the microscope
- The stands are alloy metal casted with hardened coating



● SB.1903

| | |
|----------------------------|---|
| SB.1903 | 330 (h) x 220 (w) x 266 mm (d) 4.4 kg |
| SB.1903-P | 299 (h) x 220 (w) x 266 mm (d) 5.1 kg |
| SB.1302/SB.1402 | 330 (h) x 220 (w) x 266 mm (d) 4.0 kg |
| SB.1302-P/SB.1402-P | 299 (h) x 220 (w) x 266 mm (d) 4.7 kg |

ILLUMINATION

- With 3 W transmitted and incident LED illuminators which can be used simultaneously or adjusted separately.
- SB.3903 and SB.3903-P models come with a built-in 30 LED ring light for reflexed illuminator and 3 W transmitted illuminator
- SB.1902-U, SB.1903-U, SB.1902-B and SB.1903-B are supplied without illumination. Suitable ring illuminators are LE.1973 and LE.1974

PACKAGE CONTENT

- Supplied with power cord, dust cover, eyecups, a spare fuse, Ø 60 mm transparent and black/ white stage plates and user manual
 - All packed in a polystyrene box
- A spare fuse, Ø 60 mm transparent and black/ white stage plates are not applicable for -U and B models*



● Built-in LED ring light
SB.3903



● SB.1302



● SB.3903



● SB.3903-P



● SB.1903-P



● SB.1402-P



● SB.1902-U



● SB.1902-B

MAGNIFICATIONS

WORKING DISTANCES AND FIELD OF VIEW SPECIFICATIONS

EYEPIECES - 10X/21 MM

| Magnification additional lens | Working distance | Minimum magnification | Maximum magnification | Maximum field of view | Minimum field of view |
|-------------------------------|------------------|-----------------------|-----------------------|-----------------------|-----------------------|
| 0.5 | 170.0 | 3.5 | 22.5 | 59.9 | 9.3 |
| 0.75 | 114.0 | 5.3 | 33.8 | 40.0 | 6.2 |
| Standard | 100.0 | 7.0 | 45.0 | 30.0 | 4.6 |
| 1.5 | 48.0 | 10.5 | 67.5 | 19.9 | 3.1 |

EYEPIECES - 15X/15 MM

| Magnification additional lens | Working distance | Minimum magnification | Maximum magnification | Maximum field of view | Minimum field of view |
|-------------------------------|------------------|-----------------------|-----------------------|-----------------------|-----------------------|
| 0.5 | 170.0 | 5.3 | 33.8 | 42.9 | 6.7 |
| 0.75 | 114.0 | 7.9 | 50.6 | 28.6 | 4.4 |
| Standard | 100.0 | 10.5 | 67.5 | 21.4 | 3.3 |
| 1.5 | 48.0 | 15.8 | 101.3 | 14.3 | 2.2 |

EYEPIECES - 20X/10 MM

| Magnification additional lens | Working distance | Minimum magnification | Maximum magnification | Maximum field of view | Minimum field of view |
|-------------------------------|------------------|-----------------------|-----------------------|-----------------------|-----------------------|
| 0.5 | 170.0 | 7.0 | 45.0 | 28.6 | 4.4 |
| 0.75 | 114.0 | 10.5 | 67.5 | 19.0 | 3.0 |
| Standard | 100.0 | 14.0 | 90.0 | 14.3 | 2.2 |
| 1.5 | 48.0 | 21.0 | 135.0 | 9.5 | 1.5 |

DIMENSIONS

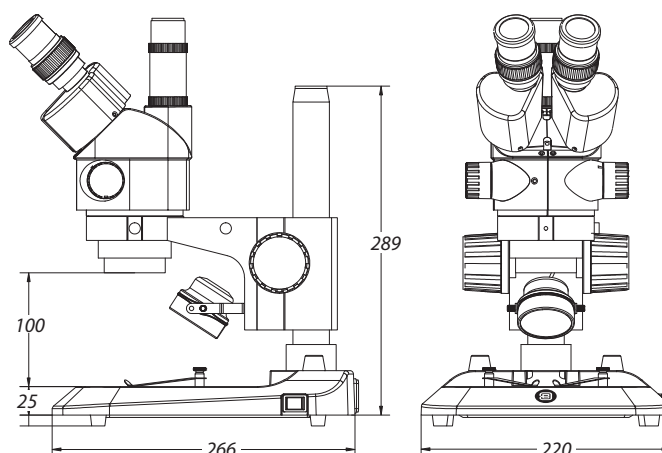

| MODELS | Binocular | Trinocular | 1x/3x objective | 2x/4x objective | 0.7 - 4.5x zoom | Rack & pinion stand 3 W LED | Pillar stand 3 W LED | Universal stand | Boom stand on heavy base plate | 30 LED right light | Weight (kg) |
|-----------|-----------|------------|-----------------|-----------------|-----------------|-----------------------------|----------------------|-----------------|--------------------------------|--------------------|-------------|
| SB.1302 | • | | • | | | • | | | | | 3.3 |
| SB.1302-P | • | | • | | | | • | | | | 4.2 |
| SB.1402 | • | | | • | | • | | | | | 3.3 |
| SB.1402-P | • | | | • | | | • | | | | 4.2 |
| SB.1902 | • | | | | • | • | | | | | 3.6 |
| SB.1902-P | • | | | | • | | • | | | | 4.4 |
| SB.1902-U | • | | | | • | | | • | | | 15.4 |
| SB.1902-B | • | | | | • | | | | • | | 21.9 |
| SB.1903 | | • | | | • | • | | | | | 3.7 |
| SB.1903-P | | • | | | • | | • | | | | 4.5 |
| SB.1903-U | | • | | | • | | | • | | | 15.5 |
| SB.1903-B | | • | | | • | | | | • | | 22.0 |
| SB.3903 | | • | | | • | • | | | | • | 3.7 |
| SB.3903-P | | • | | | • | | • | | | • | 4.5 |

ACCESSORIES AND SPARE PARTS

EYEPIECES

- SB.6210** Pair of HWF 10x/21 mm eyepieces
- SB.6210-C** WF 10X/21 mm eyepiece with cross-hair
- SB.6210-M** WF 10X/21 mm eyepiece with micrometer scale
- SB.6015** Pair of HWF 15x/15 mm eyepieces
- SB.6015-C** WF 15X/15 mm eyepiece with cross-hair
- SB.6015-M** WF 15X/15 mm eyepiece with micrometer scale
- SB.6020** Pair of HWF 20x/10 mm eyepieces
- SB.6020-C** WF 20/10 mm eyepiece with cross-hair
- SB.6020-M** WF 20/10 mm eyepiece with micrometer scale
- SB.6099** Pair of eyecups

OBJECTIVES

- SB.8903** Auxiliary 0,3x lens, only suitable for SB.1902-U, SB.1903-U, SB.1902-B and SB.1903-B models. WD 247mm
- SB.8905** Auxiliary 0,5x lens, especially suitable for SB.1902-P, SB.1903-P, SB.1902-U, SB.1903-U, SB.1902-B and SB.1903-B models. With rack-and pinion models SB.1902 and SB.1903, the maximum object height is 2 cm. WD 170mm
- SB.8907** Auxiliary 0.75x lens for zoom models WD 114 mm
- SB.8915** Auxiliary 1.5x lens, working distance 48 mm. Only for SB.1902/1903 zooms, not suitable for SB.1902-P/SB.1903-P

MISCELLANEOUS

- SB.8950** Protection glass window for StereoBlue
- SB.9020** Universal single-arm stand, without StereoBlue head holder and without illumination
- SB.9030** Universal double-arm stand without head holder and without illumination
- SB.9032** Universal double-arm stand with table clamp without StereoBlue holder(SB.9090)
- SB.9090** StereoBlue head holder
- SB.9040** Darkfield attachment for StereoBlue, only for -S and -P models
- SB.9570** Pair of object clamps for stage
- SB.9952** Stage plate transparent, Ø 60 mm
- SB.9956** Stage plate black/white, Ø 60 mm
- SB.9983-R** 3 W LED replacement unit for StereoBlue, incident illumination
- SB.9983** 3 W LED replacement unit for StereoBlue, transmitted illumination
- AE.1112** Micrometer 76 x 26 mm slide, 50 mm/50 divisions
- AE.9919** Nylon microscope bag (58 x 32 x 24 cm)
- AE.9916** Euromex dust cover extra large (50 x 68 cm)

POLARIZATION ATTACHMENTS

- SB.9520** Polarization kit for StereoBlue: 360° rotatable round stage with built-in polarization filter (SB.9524) + analyzer in mount to be screwed under the head (SB.9525)
- SB.9524** 360° rotatable round stage with built-in polarization filter
- SB.9525** 360° rotatable analyzer in mount to be screwed under the head of StereoBlue

CAMERA ACCESSORIES

- SB.9850** C-mount adapter with 0.5x lens for 1/2" cameras. Only for trinocular models
- AE.5130** Universal SLR camera adapter with 2x projection lens for 23.2 mm tubes. Need T2 adapter
- AE.5025** T2 adapter for Nikon D digital SLR cameras
- AE.5040** T2 adapter for Canon EOS digital SLR cameras

Other T2 adapters on request

DISPOSABLES

- PB.5245** Lens cleaning paper, 100 sheets per pack
- PB.5274** Isopropyl alcohol 99% (200 ml)
- PB.5275** Cleaning kit: lens cleaning fluid, lint free lens tissue, brush, air blower, cotton swabs



● AE.9916



AE.9919 ●