



### German Medical Technology (Beijing) Co, Ltd.

Building 68A, No.16, Huan Ke Zhong Lu  
Jinqiao Science & Technology Industrial Base  
Zhongguancun Science Park Tongzhou Park  
Tongzhou District, Beijing 101102, P.R. China

🌐 [www.germanmedtech.com](http://www.germanmedtech.com)

✉ [info@germanmedtech.com](mailto:info@germanmedtech.com)

☎ +86(10)56940198 - 225



# GMT Medical

## Percutaneous Biopsy Series

---

The Leading Biopsy Company In China

## GMT Soft Tissue Biopsy

GA 1	Disposable Aspiration Biopsy Needle	02
GT 20	Disposable Semi-Automatic Biopsy Needle	04
GTC	Disposable Coaxial Needle	04
GT400	Disposable Automatic Biopsy Needle	06
fu-Core	Disposable Full Core Biopsy Needle	08
MegaCore 2	Reusable Automatic Biopsy Instrument	10
MC-MGN	Disposable Biopsy Needle for MegaCore 2 Reusable Automatic Biopsy Instrument	10
Sure Anchor	Disposable Pre-operative Localization Needle	12

## GMT Bone Marrow Biopsy

GB 70	Disposable Bone Marrow Aspiration Needle	14
GB 2	Disposable Bone Marrow Biopsy Needle	16
GB 11	Disposable Bone Marrow Transplantation Needle	18

## GMT Drainage Catheter and Ureteral Stents

G-Flex	Drainage Catheter	20
Flexater	Ureteral Stents(Double Pigtail)	22

## GMT Breast Biopsy System

MammCare II	Vacuum-assisted Breast Biopsy Equipment	24
-------------	---	----

# GMT Medical

GMT was established in 2007, which is a Sino-foreign joint venture company. As a leading brand in the field of biopsy in China, we take "developing, manufacturing, and marketing high-quality medical products to bring safe, professional, and comfortable experience to medical workers and patients" as our corporate mission, and take independent research and development and technological innovation as the core competitiveness of the enterprise.

GMT has always adhered to the core values of "quality, service, integrity, innovation", and has successively launched dozens of high-quality medical products, such as percutaneous biopsy series, breast minimally invasive diagnosis and treatment series, urological stent and catheter series, polypropylene patch series, etc. Among all products, the percutaneous biopsy series is the forerunner in the Chinese medical supply industry.

# GA 1

## Disposable Aspiration Biopsy Needle

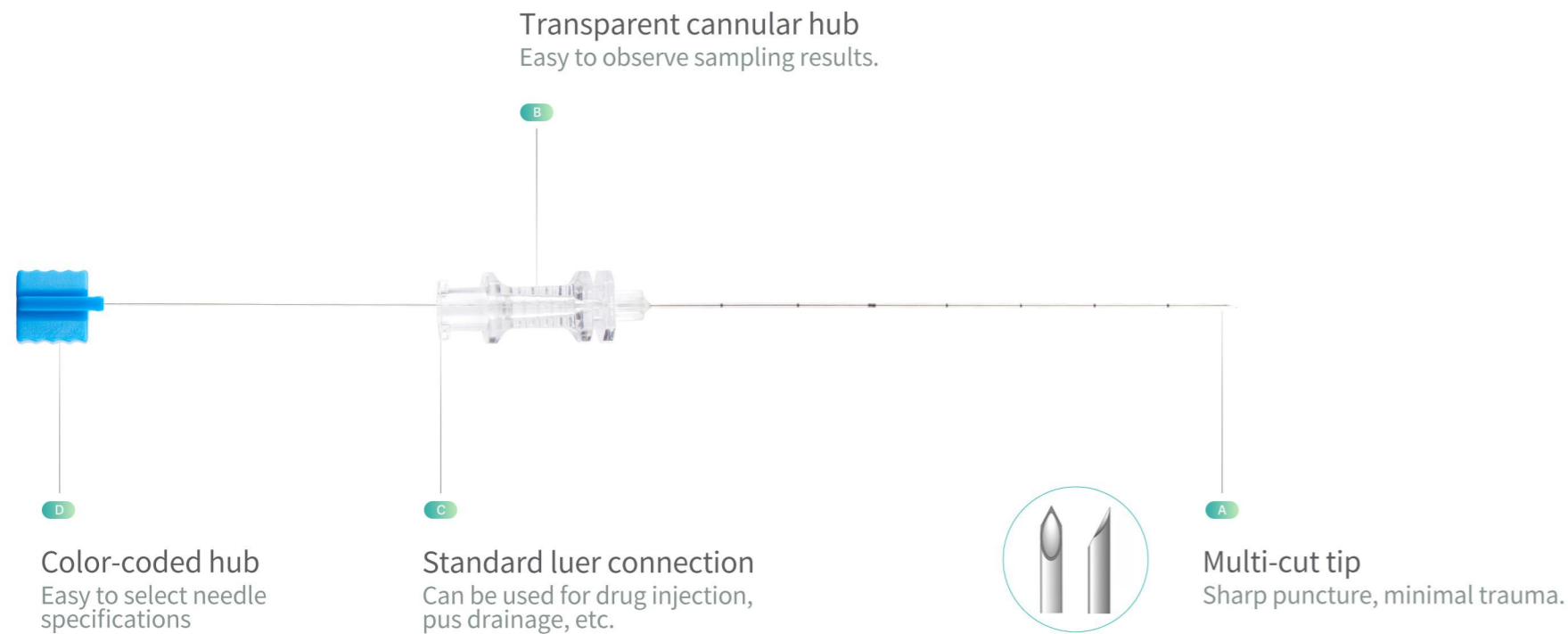

### ✓ The Clinical Advantages of GA (compared to syringe)

1. Complete product specification: We are the first in China to introduce the 25G ultra-fine needle to the domestic market. For thyroid nodules with a rich blood supply, the thinner the needle, the lower the ratio of blood components to nodule cells in the specimen, significantly reducing interference with light microscopic interpretation.
2. Multi-cut tip: Provides a sharp puncture with minimal trauma.
3. Echogenic design: Enhances visibility under ultrasound and facilitates accurate depth placement.
4. Ergonomic handle: Ensures a firm grip and good control.
5. Coaxial needle structure: Prevents other cellular components on the puncture path from entering the needle lumen before the needle reaches the target nodule, thus avoiding contamination of the following sample and ensuring the accuracy of cytological diagnosis.

### i Application Scope / Specification

Cytological aspiration biopsy, amniotic fluid/ cord blood aspiration biopsy, drug injection and sclerotherapy, cystic fluid aspiration therapy, etc.

Gauge	Length 7cm	Length 9cm	Length 11cm	Length 15cm	Length 20cm
18G <span style="color: #e91e63;">■</span>	--	B-A301809	B-A301811	B-A301815	B-A301820
20G <span style="color: #ffc107;">■</span>	--	B-A302009	B-A302011	B-A302015	B-A302020
21G <span style="color: #28a745;">■</span>	--	B-A302109	B-A302111	B-A302115	B-A302120
22G <span style="color: #000000;">■</span>	--	B-A302209	B-A302211	B-A302215	B-A302220
23G <span style="color: #007bff;">■</span>	B-A302307	B-A302309	--	--	--
25G <span style="color: #ff7f0e;">■</span>	--	B-A302509	--	--	--

# GT 20

## Disposable Semi-Automatic Biopsy Needle

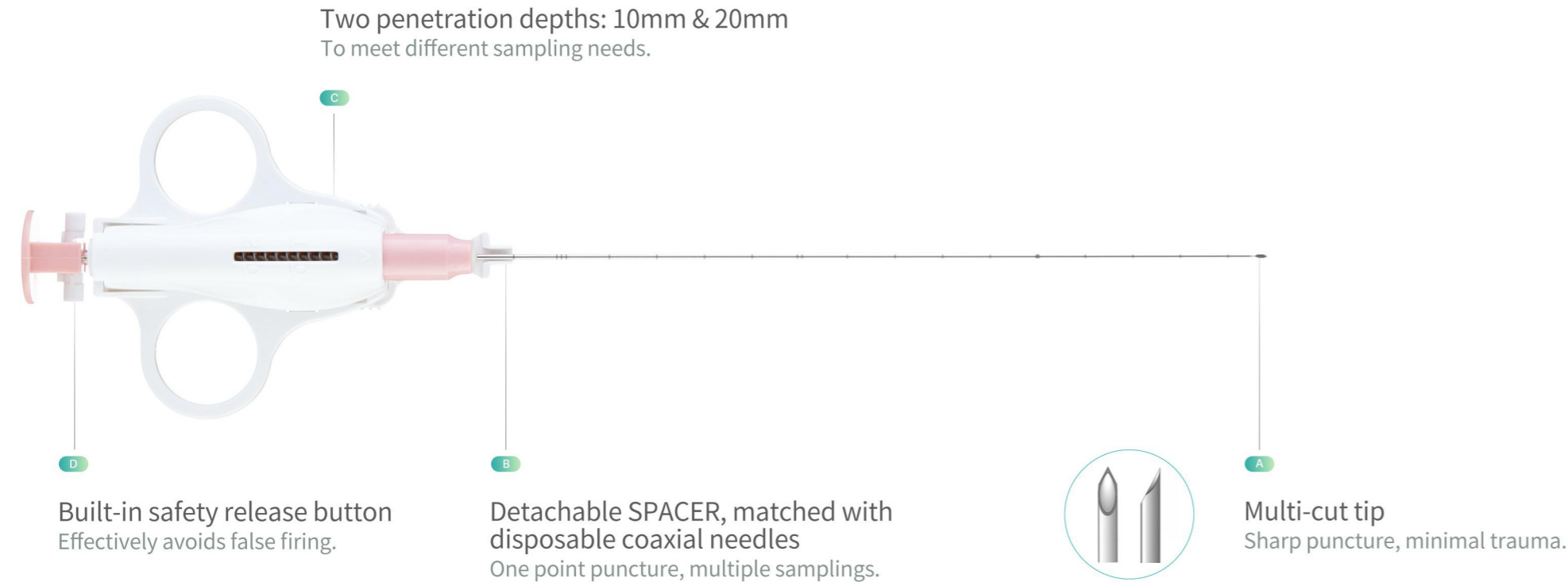

### ✔ Clinical Advantages of the GT 20 with Coaxial Needle for Puncture Biopsy

1. Lightweight needle for easy control and accurate puncture site.
2. One puncture allows for multiple samplings, reducing the risk of complications.
3. Provides access to biopsy needles, preventing tumor implantation.
4. Manages complications effectively.

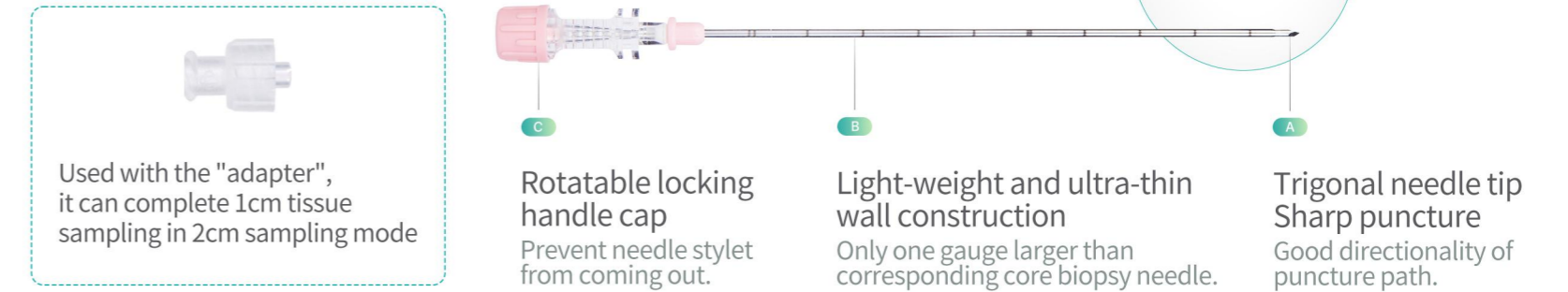

### i Application Scope / Specification

Lung biopsy, thyroid biopsy, superficial lymph nodes biopsy, liver biopsy, kidney biopsy etc.

Gauge	Specification	Cannula length	Coaxial needle specification	Cannula Length
14G ■	B-T041410	10cm	B-T121305	05cm
	B-T041416	16cm	B-T121311	11cm
16G □	B-T041610	10cm	B-T121505	05cm
	B-T041616	16cm	B-T121511	11cm
	B-T041620	20cm	B-T121515	15cm
18G ■	B-T041810	10cm	B-T121705	05cm
	B-T041816	16cm	B-T121711	11cm
	B-T041820	20cm	B-T121715	15cm
20G ■	B-T042016	16cm	B-T121911	11cm

# GT400

## Disposable Automatic Biopsy Needle

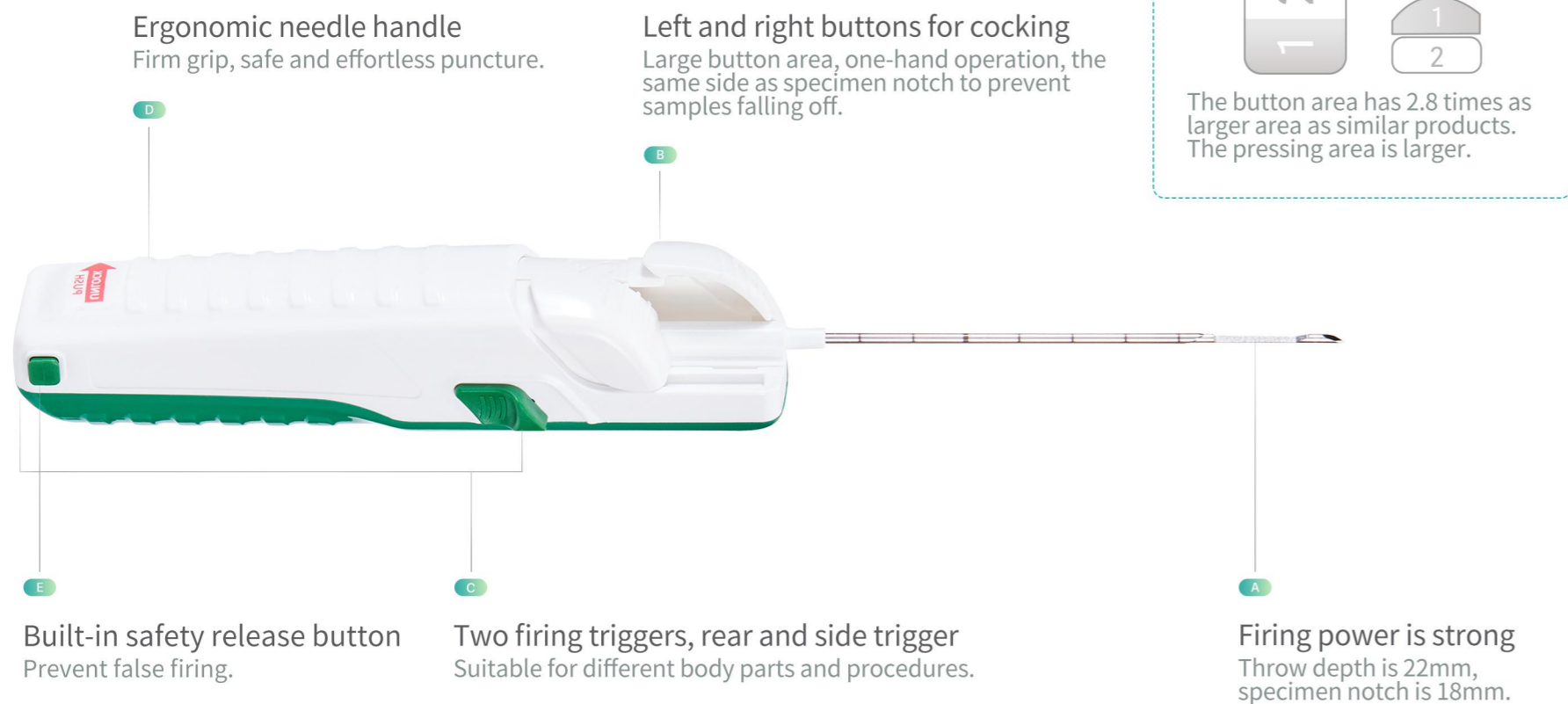

### Operational Methods of GT400 Disposable Automatic Biopsy Needle

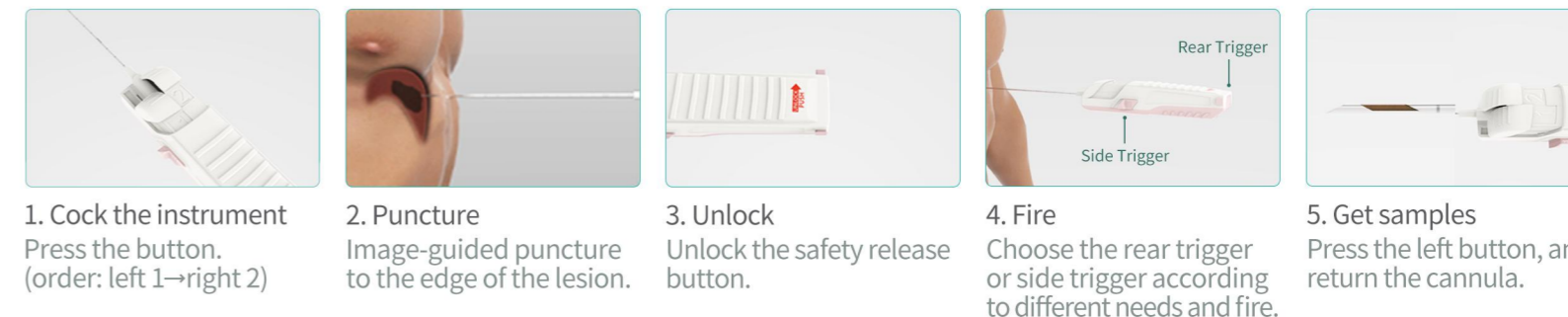

### Application Scope / Specification

Breast biopsy, prostate biopsy, kidney biopsy, lung biopsy, liver biopsy etc.

Gauge	Specification	Cannula length	Coaxial needle specification	Cannula length
14G ■	B-T211410	10cm	B-T121305	05cm
	B-T211416	16cm	B-T121311	11cm
	B-T211420	20cm	B-T121315	15cm
16G □	B-T211610	10cm	B-T121505	05cm
	B-T211616	16cm	B-T121511	11cm
	B-T211620	20cm	B-T121515	15cm
18G ■	B-T211810	10cm	B-T121705	05cm
	B-T211816	16cm	B-T121711	11cm
	B-T211820	20cm	B-T121715	15cm
	B-T211825	25cm	B-T121720	20cm
20G ■	B-T212010	10cm	B-T121905	05cm
	B-T212016	16cm	B-T121911	11cm
	B-T212020	20cm	B-T121915	15cm

# fu-Core

## Disposable Full Core Biopsy Needle

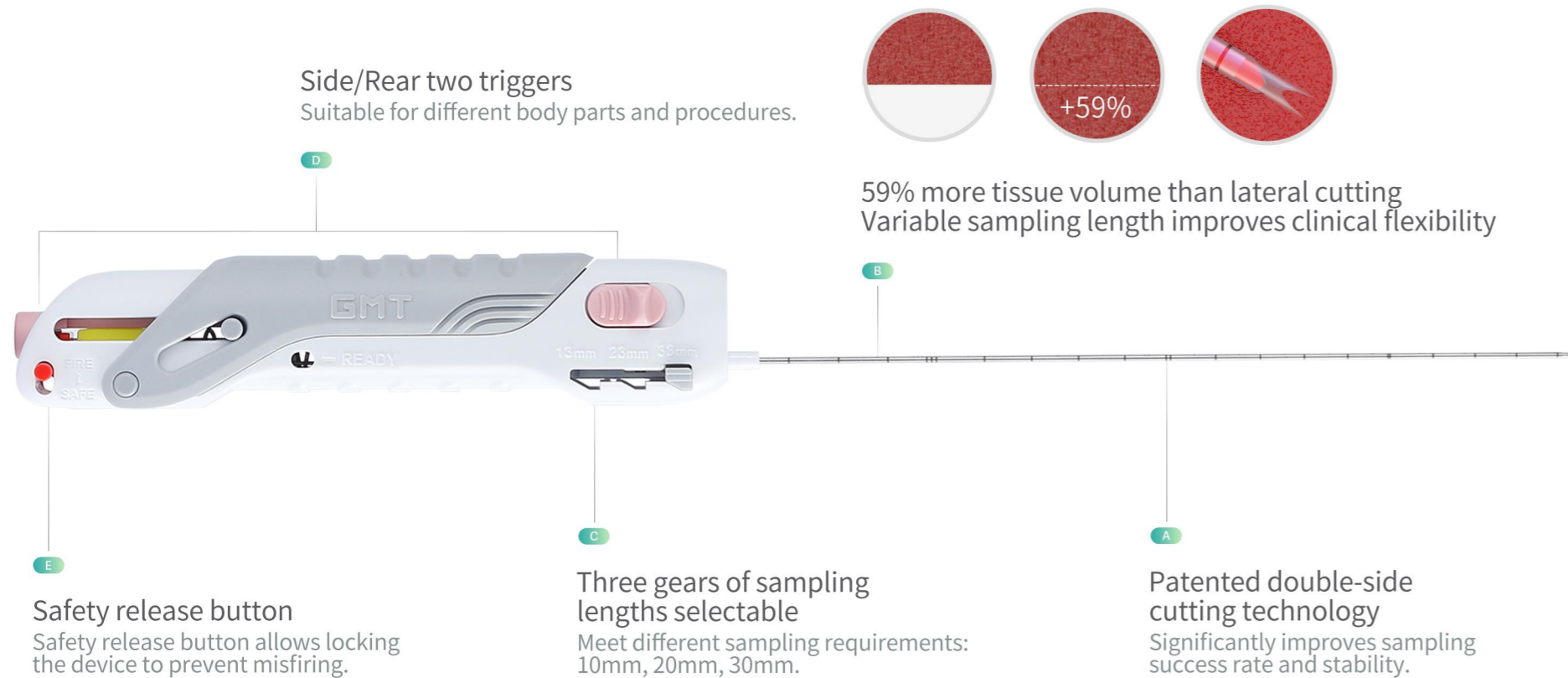

### Operational Methods of fu-Core Disposable Full Core Biopsy Needle

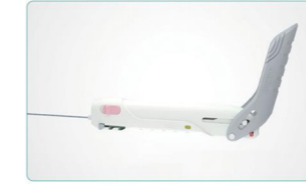

**1. Cock the instrument**  
Pull up the white upper cover until you hear a "click"beep and press.



**2. Choose biopsy length**  
According to the lesion, choose biopsy length, press and move the two sides' green stroke length adjuster together to the suitable gear.



**3. Unlock**  
Penetrate the needle to the lesion area, unlock the safety release button.

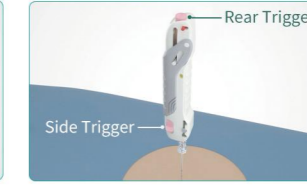

**4. Fire**  
Fire the needle by press rear trigger or side trigger according to requirement.

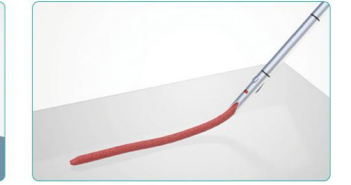

**5. Get samples**  
Pull up the white upper cover, the tissue sample gradually exposes. The needle is ready again to fire.

### Application scope / Specification

Lung biopsy, kidney biopsy, prostate biopsy, liver/pancreas biopsy, superficial lymph nodes biopsy and so on.

Gauge	Specification	Cannula length
16G □	B-F801610	13cm
	B-F801615	18cm
	B-F801620	23cm
18G ■	B-F801810	13cm
	B-F801815	18cm
	B-F801820	23cm

# MegaCore 2

## Reusable Automatic Biopsy Instrument

**Automatic safety device**  
Automatically lock after cocking, avoid misfiring.

**Visible window**  
For viewing the cocking status easily.

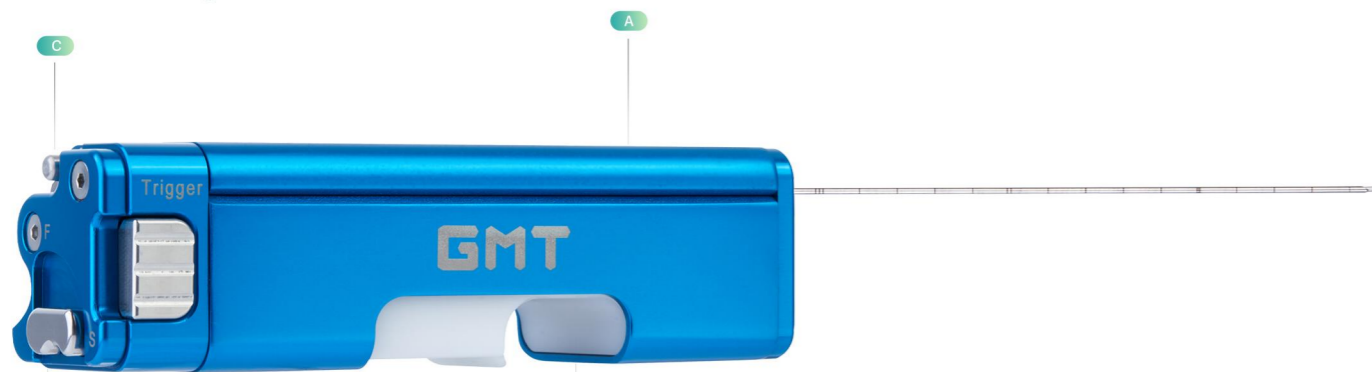

**Adjustable penetration depths**  
Depths of 15mm & 22mm, according to the sample lengths: 12mm & 19mm.

**Trigger-operated cocking keys**  
Lightweight, one-handed cocking.

### MC-MGN Disposable Biopsy Needle for Bard® Magnum® Automatic Biopsy Instrument

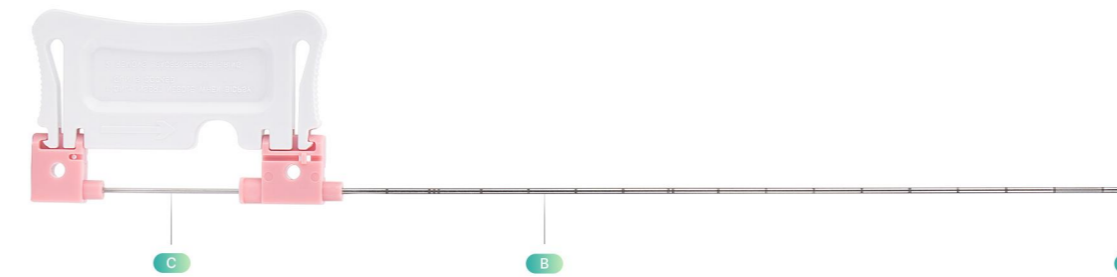

**Loadable handle**  
easy to operate.

**Used with MegaCore 2**  
Extremely fast cutting, complete sampling.

**Multi-cut tip**  
Sharp puncture, minimal trauma.

### Application scope / Specification

Suitable for percutaneous puncture biopsies of the breast, prostate, kidney, lung and liver.

MegaCore 2	Specification
	B-T271522

MC-MGN Needle	Length 10cm	Length 16cm	Length 20cm	Length 25cm
14G ■	B-T101410	B-T101416	B-T101420	--
16G □	B-T101610	B-T101616	B-T101620	--
18G ■	B-T101810	B-T101816	B-T101820	B-T101825
20G ■	B-T102010	B-T102016	B-T102020	--

# Sure Anchor

## Disposable Pre-operative Localization Needle

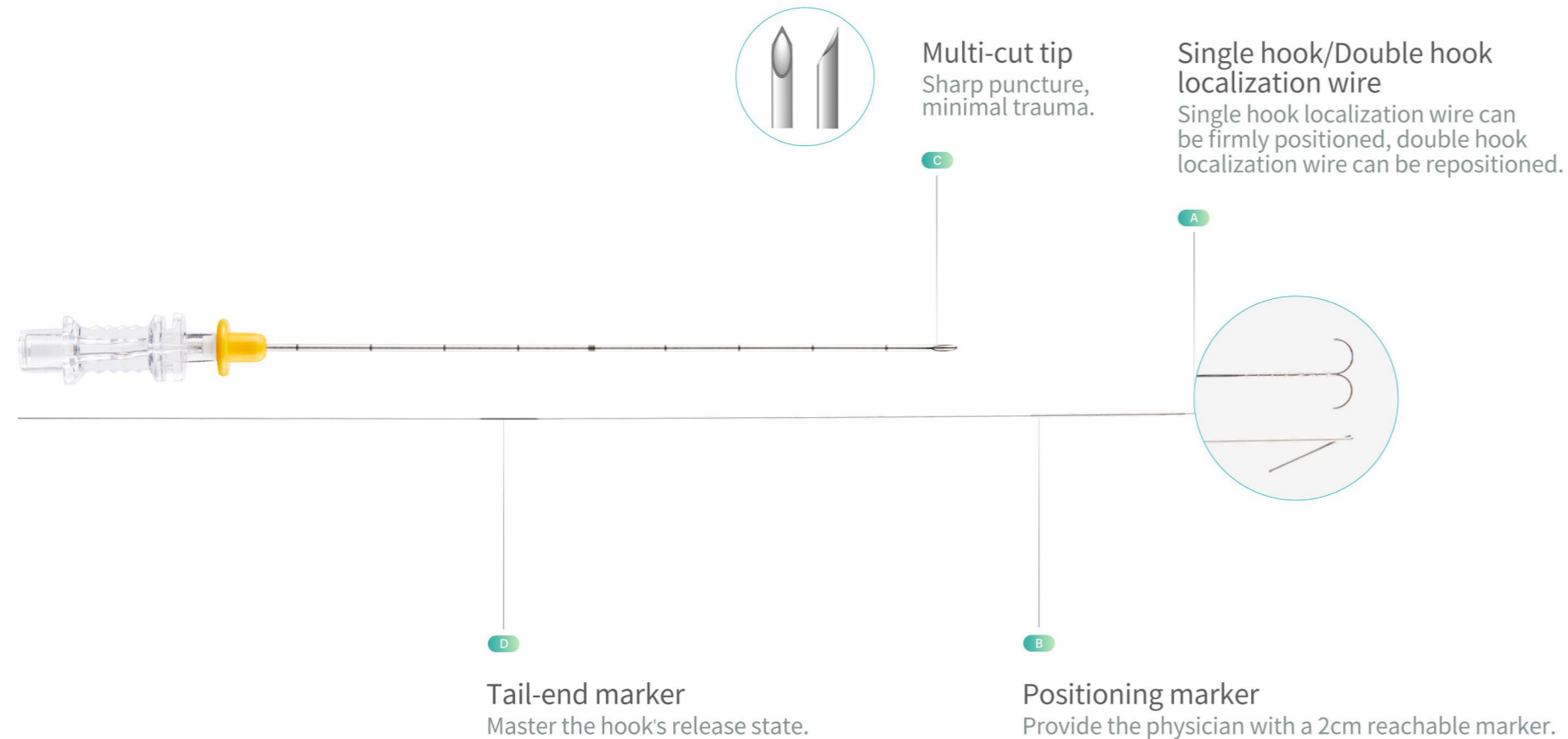

### Operational Methods of Sure Anchor Pre-Operative Localization Needle

#### 1. Puncture

Under imaging guidance, the localization needle is punctured into the lesion area, reaching the central part of the tissue. If the lesion tissue is hard, it is necessary to penetrate the lesion tissue.

#### 2. Localization needle release

One hand fixes the localization wire, while the other hand withdraws the needle handle. When the needle handle is retracted to completely cover the tail-end marker, it indicates that the hook is in the release state.

### Application Scope / Specification

Pre-operative localization for breast biopsy, lung biopsy.

Sure Anchor 1	Specification	Cannula length
18G <span style="color: #c00000;">■</span>	B-L701807	07cm
	B-L701810	10cm
20G <span style="color: #ffcc00;">■</span>	B-L702007	07cm
	B-L702010	10cm
	B-L702015	15cm
21G <span style="color: #008000;">■</span>	B-L702107	07cm

Sure Anchor 2	Specification	Cannula length
18G <span style="color: #c00000;">■</span>	B-L721810	07cm
20G <span style="color: #ffcc00;">■</span>	B-L722007	10cm
	B-L722010	10cm

# GB 70

## Disposable Bone Marrow Aspiration Needle

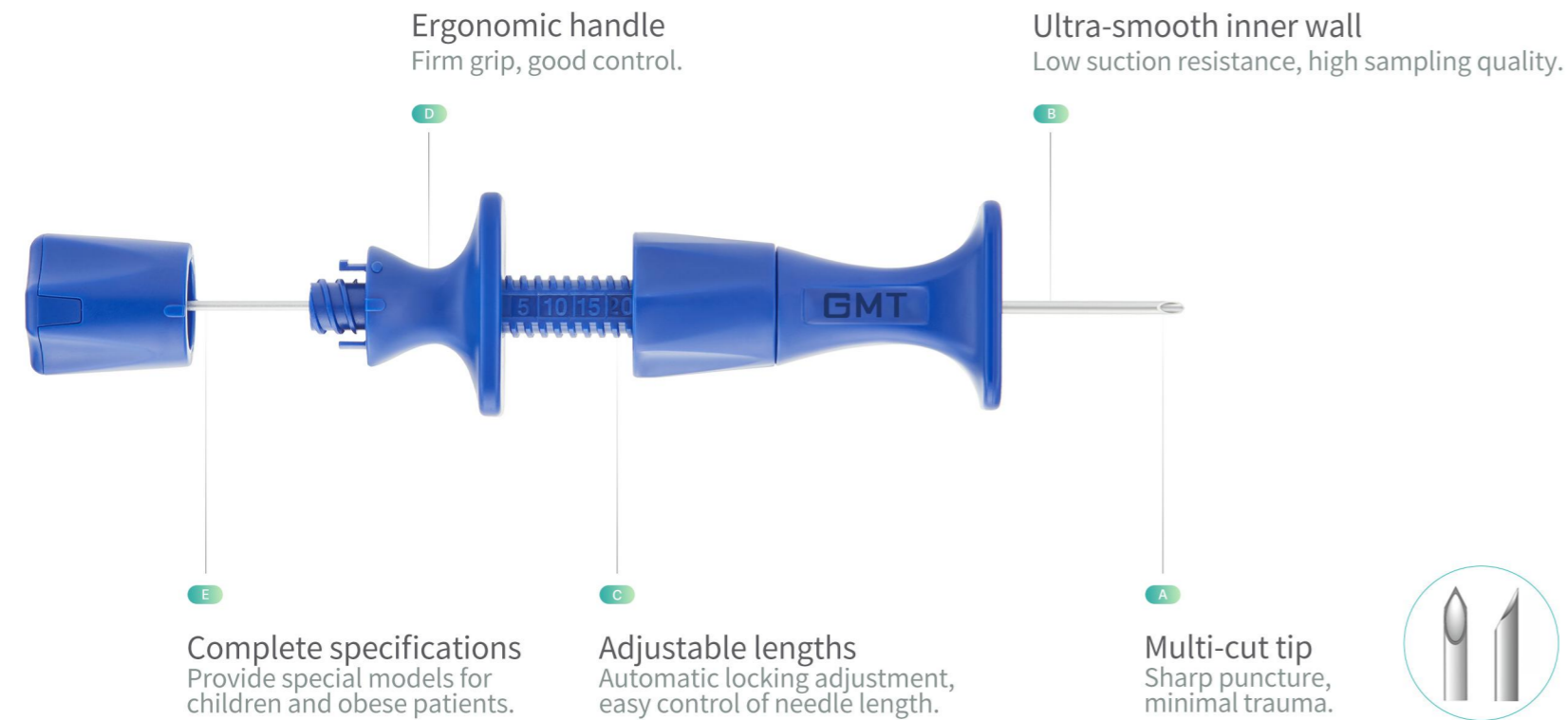

### Operational Methods of GB 70 Disposable Bone Marrow Aspiration Needle

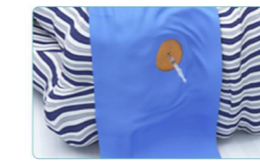

**1. Pre-operative preparation**  
Choose a suitable puncture point and prepare the operation.



**2. Choose the right models**  
Adults AC15/04、 AC16/04, children AC18/03.



**3. Adjust the length of needle**  
Hold the needle body with the left hand, and rotate the spiral counterclockwise with the right hand to adjust the length of the needle.

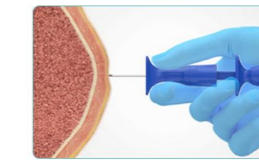

**4. Puncture**  
Use the left hand to fix the puncture point, the right hand to hold the needle, use the needle tip to penetrate into the bone vertically, can rotate left and right.

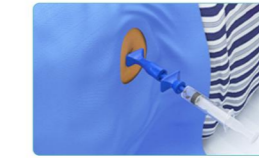

**5. Collect bone marrow fluid**  
When the puncture resistance disappears and the puncture needle is fixed in the bone, pull out the needle stylet and attach a syringe to collect the bone marrow fluid.

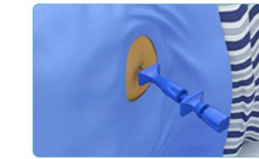

**6. Post-operative dressing**  
Re-insert the needle stylet, and pull out the needle from the body. Press the puncture point and fix it with pressure.

### Application scope / Specification

Bone marrow biopsy (Cytology).

Gauge	Specification	Length Original	Length Minimum	Length Maximum
15G ■	B-B611528	2.8cm	0.8cm	4.5cm
	B-B611543	4.3cm	2.3cm	6.0cm
16G □	B-B611628	2.8cm	0.8cm	4.5cm
	B-B611643	4.3cm	2.3cm	6.0cm
18G ■	B-B611828	2.8cm	0.8cm	4.5cm
	B-B611843	4.3cm	2.3cm	6.0cm

# GB 2

## Disposable Bone Marrow Biopsy Needle

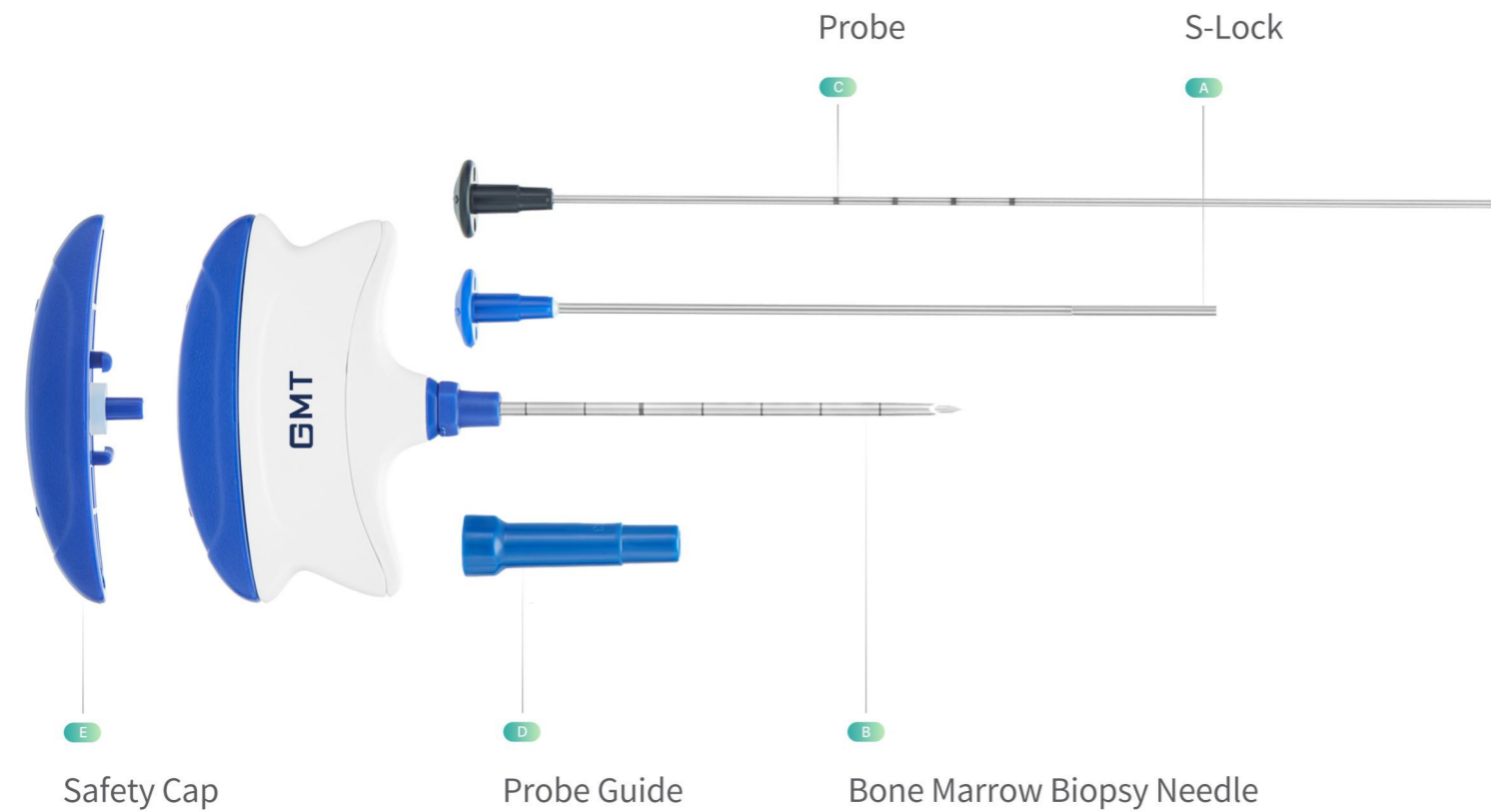

### Operational Methods of GB 2 Disposable Bone Marrow Biopsy Needle

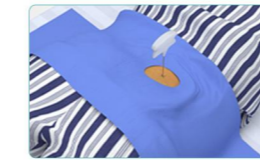

1. Pre-operative preparation  
Choose a suitable puncture point and prepare the operation.



2. Choose the right models  
B-B521307 for children, other models for adults.

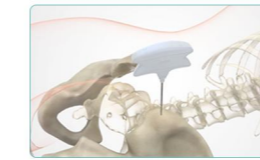

3. Puncture  
Puncture into the bone cortex, and continue down 0.5 cm.  
(Ergonomic handle, firm grip, good control)

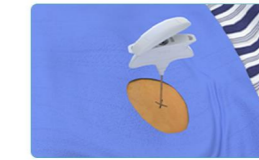

4. Change the safety cap  
Rotate to remove the stylet, cap the safety cap to prevent contamination of the surgical field. Adjust the stopper 2cm from the body surface.

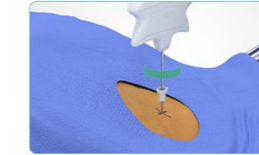

5. Continue to rotate and advance the needle  
Rotate and advance in one direction up to the stopper, and use the probe to measure the sample length.

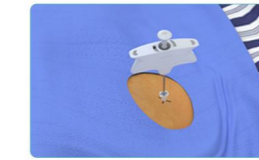

6. Get the sample  
Insert the S-Lock extraction cannula and rotate it together with cannula with 360 degree. Pull out them together, and get the sample.

### Application scope / Specification

Bone marrow biopsy (Histology).

Gauge	Length 7cm	Length 10cm	Length 15cm
7 G <span style="color: yellow;">■</span>	--	B-B520710	B-B520715
8 G <span style="color: green;">■</span>	--	B-B520810	B-B520815
9 G <span style="color: pink;">■</span>	--	B-B520910	B-B520915
11G <span style="color: grey;">■</span>	B-B521107	B-B521110	B-B521115
13G <span style="color: blue;">■</span>	B-B521307	B-B521310	B-B521315

# GB 11

## Disposable Bone Marrow Transplantation Needle

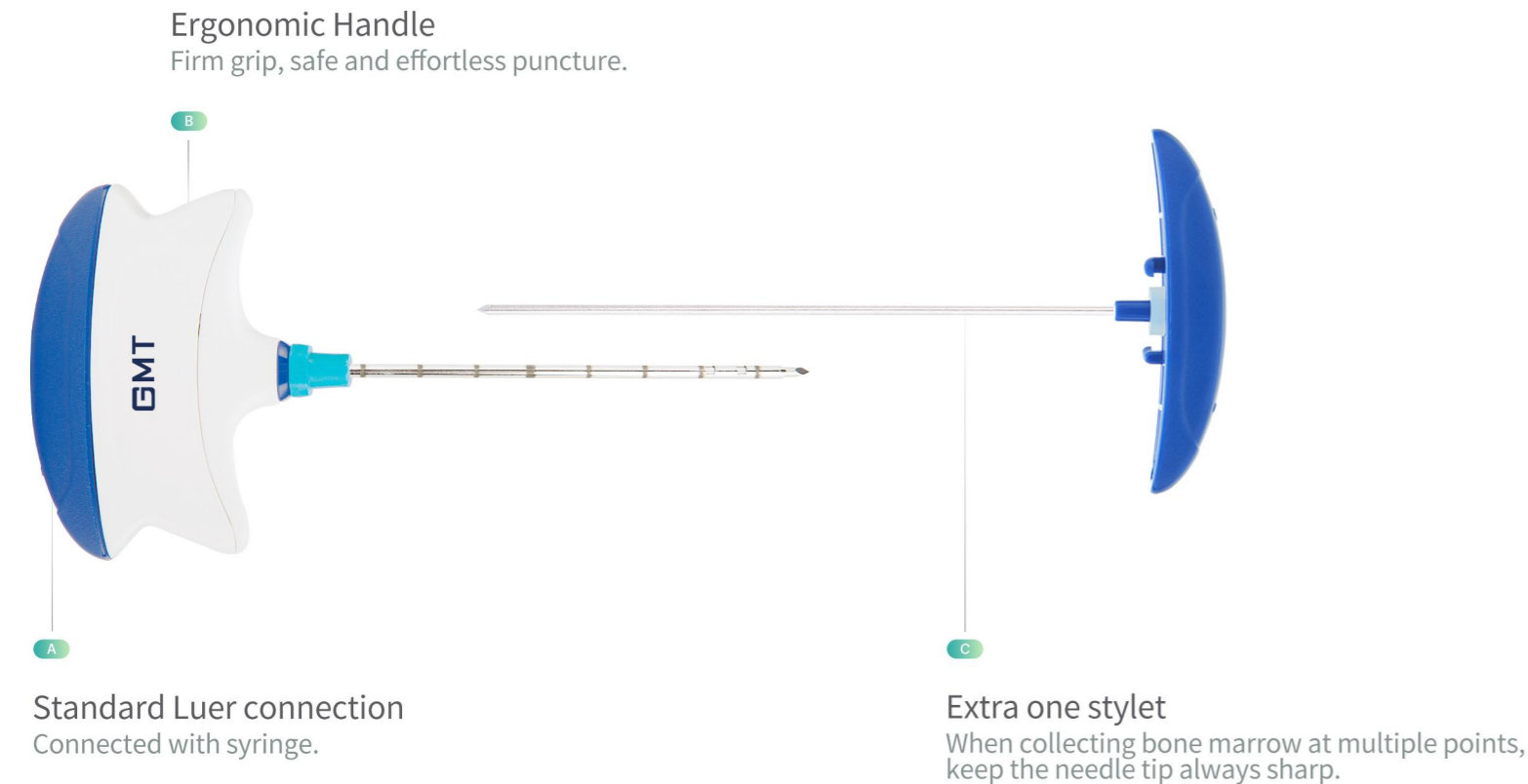

### Technical Advantages of GB 11

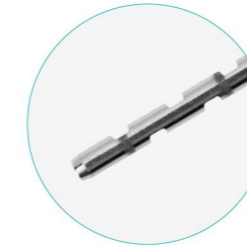

The unique design of 5 side holes for collecting bone marrow (6 holes in total)  
Simultaneous multi-directional, multi-level high-quality marrow extraction.  
Effectively reduces the number of punctures and shortens the time for bone marrow collection.  
Simplifies the clinical operation process and reduces patient pain.

### Application scope / Specification

Bone marrow hematopoietic stem cell transplantation.

Gauge	Specification	Cannula Length
11G □	B-B511109	09cm
	B-B511113	13cm
13G ■	B-B511307	07cm
	B-B511311	11cm
15G ■	B-B511507	07cm
	B-B511511	11cm

# G-Flex

## Drainage Catheter

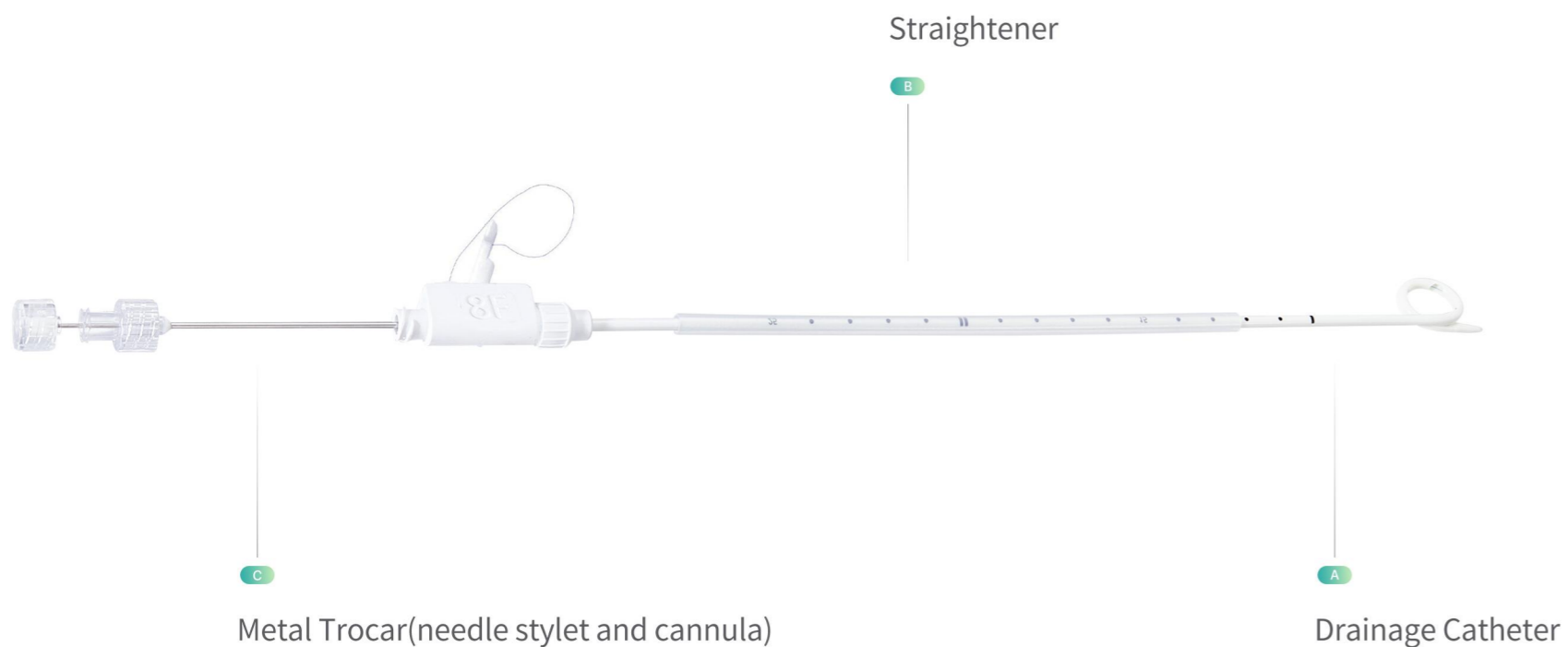

### ✔ Features of Disposable Multifunctional Drainage Catheter

1. Hydrophilic coating with good biocompatibility, effectively reducing insertion resistance.
2. The insertion trocar and the drainage tube have a good fit, making it easy to puncture.
3. Large side hole design ensures remarkable drainage effect and reduces the risk of tube blockage.
4. Tapered head structure minimizes tissue damage and patient suffering.

### ⓘ Application scope / Specification

For percutaneous puncture drainage of fluid collection sites in the chest, bile vessel and kidneys.

French	Specification	Cannula Length
6Fr	D-D00010630	30cm
8Fr	D-D00010830	30cm
10Fr	D-D00011030	30cm
12Fr	D-D00011230	30cm
14Fr	D-D00011430	30cm
16Fr	D-D00011630	30cm

# Flexater

Ureteral Stents ( Double Pigtail )

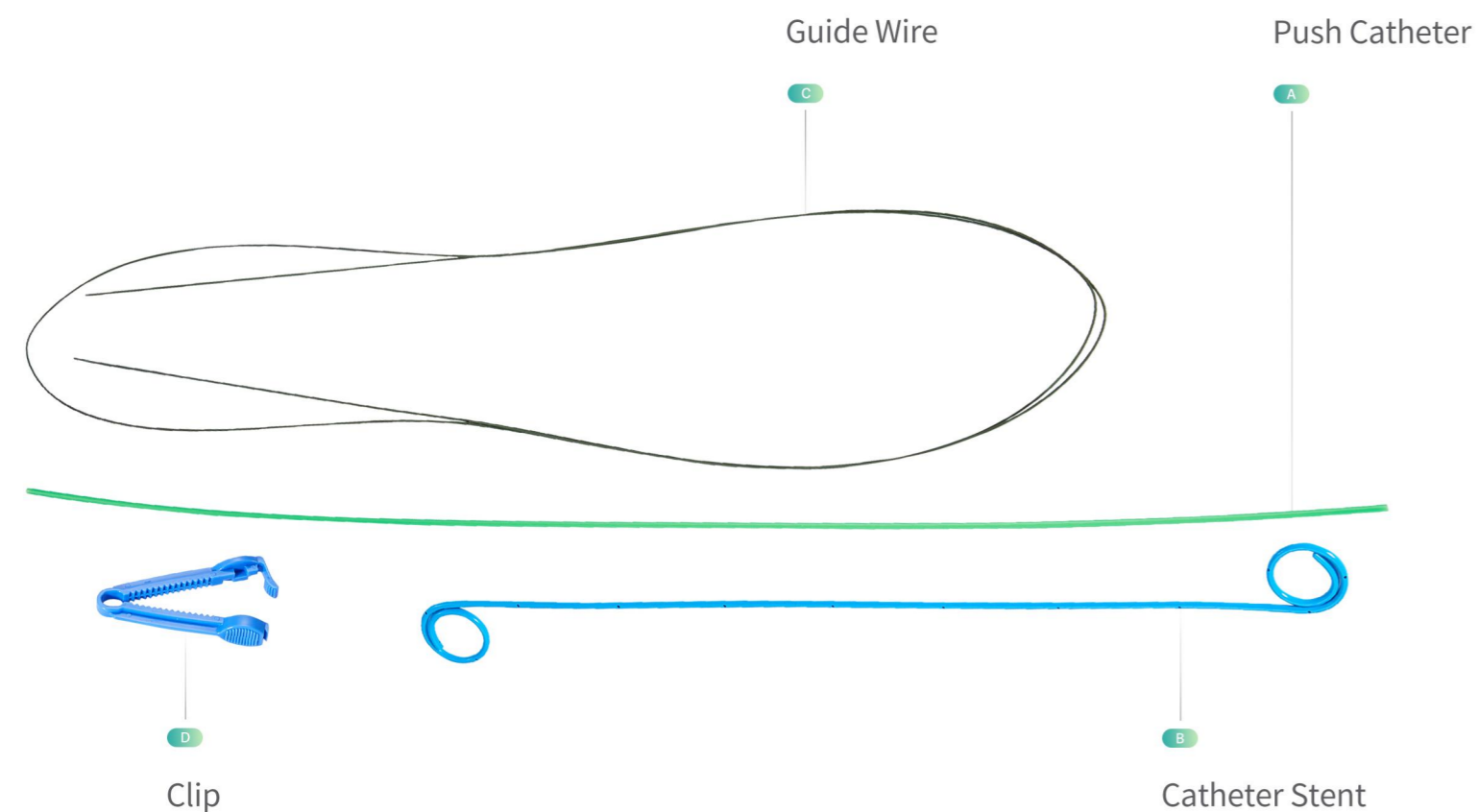

## ✔ Features of Double Pigtail Ureteral Stents

1. Polyurethane material. Good elasticity and bending resistance. Clear development under X-ray.
2. Hydrophilic coating. Reduce insertion resistance. Smooth surface. Reduces skin formation.
3. Proximal ureteral stent tube Tiemann tube head. Easier to insert.
4. One-and-a-half pigtail design. Prevent the ureteral stent from falling off.
5. Distal(bladder end)wire. Easy to reset and remove the bracket.

## ⓘ Application scope / Specification

Ureteral obstruction, hydronephrosis, pus in the kidney caused by tumors, ureteral stenosis, etc.  
 Prevention and treatment of ureteral obstruction due to ureteral oedema, blood clots and lithotripsy after lithotripsy.  
 Ureteral injury and drainage after surgery.  
 Prior to ureteroscopy, a ureteral stent is pre-positioned to dilate the ureter and increase the success rate of access.

French	Specification	Kits	Cannula Length
4.7Fr	U-S020014728	2kits	28cm
4.7Fr	U-S020024728	4kits	28cm
6Fr	U-S020010628	2kits	28cm
6Fr	U-S020020628	4kits	28cm

# MammCare II

## Vacuum-assisted Breast Biopsy Equipment



- A** 15 Inch touch screen  
Chinese interface, embedded with troubleshooting animations
- B** Driver  
Dual motor driver with an ergonomic operating handle. Lightweight and simplified structure, easy to operate.
- C** Vacuum host  
Including vacuum pipeline and vacuum bucket
- D** Foot pedal (not included as standard)

### Needle for Vacuum-assisted Breast Biopsy Equipment

- D** Open organization collection tank
  - Sample visualization
  - Ordered sampling
- A** Flat blade design
  - Sharp puncture, easy to penetrate dense glandular tissue.
  - The small cross-sectional area of the blade reduces tissue trauma and facilitates postoperative healing.
  - Accurate and easy to control cutting direction, reducing needle resistance and accurately reaching the lesion location.
- C** High hardness material tissue cutting knife
  - Efficient rotary cutting to improve surgical efficiency.
  - The length of the cutting groove is 21 mm, ensuring complete sampling.
- B** Bidirectional negative pressure design
  - Beneficial for tissue and blood separation, resulting in pure specimens that aid in pathological analysis.
  - Stable negative pressure effectively reduces the occurrence of hematomas.

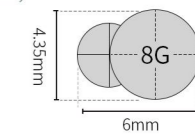
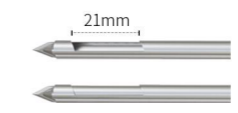

### Application scope / Specification

Diagnosis of breast lesions and treatment of benign lesions.

Gauge	Needle diameter	Needle length
8G	4.35mm	90mm
8G	4.35mm	125mm
8G	4.35mm	150mm