

64620 150 W 15 V

Halogen lamps with reflector MR16



Product family features

- Xenon instead of krypton as the filler gas (XENOPHOT HLX versions)
- Luminous flux up to 10 % higher with same power consumption (XENOPHOT HLX versions)



Product datasheet

Technical data

Product information

Order reference	64620 150W 15V
-----------------	----------------

Electrical data

Nominal voltage	15.0 V
Nominal wattage	150.00 W

Photometrical data

Color temperature	3270 K
-------------------	--------

Light technical data

Focal length	32.0 mm
--------------	---------

Dimensions & weight

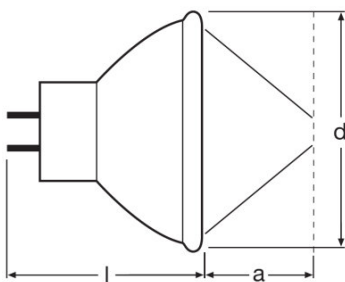

Diameter	51.0 mm
Length	42.0 mm

Lifespan

Lifespan	500 h
----------	-------

Additional product data

Coating	Dichroic
Base (standard designation)	GZ6.35

Capabilities

Burning position	p90/p15
Application	Other

Certificates & standards

EEI – Energy Label	B
--------------------	---

Country specific categorizations

ANSI code	EFR-5
Order reference	64620 150W 15V

Product datasheet

Logistical Data

Product code	Product description	Packaging unit (Pieces/Unit)	Dimensions (length x width x height)	Volume	Gross weight
4050300797397	64620 150 W 15 V	Folding carton box 1	56 mm x 45 mm x 48 mm	0.12 dm ³	35.50 g
4050300797403	64620 150 W 15 V	Shipping carton box 20	175 mm x 123 mm x 175 mm	3.77 dm ³	756.00 g

The mentioned product code describes the smallest quantity unit which can be ordered. One shipping unit can contain one or more single products. When placing an order, for the quantity please enter single or multiples of a shipping unit.

References / Links

For further technical information please refer to the following OSRAM brochure:

“Technology and applications, Low-voltage tungsten-halogen lamps”

“Halogen lamps, low and medium voltage for entertainment, technical and medical applications” cross reference list

Disclaimer

Subject to change without notice. Errors and omission excepted. Always make sure to use the most recent release.