



SIMAT CO.LTD.

Address : Fevzi Çakmak District
Ay Yıldız Av. No:85/A Karatay-
KONYA/TURKEY



INOX PARK brand is a Simat Ltd.
Subsidiary.

TECHNICAL DESCRIPTION (LOT 1, 2)

1. Play complex - maze for various activities (balance games, orienteering, motor development) , components:

Tower - 6 units (tower without a roof)

Made of wood with machined surfaces, without chips, cracks or other defects that could cause harm to children, being protected and colored by impregnation with preventive protection products, respectively by coating with paint. The wooden poles (4 units) will have a square section of at least 90 x 90 mm, and on the upper part will be provided HDPE covers against atmospheric factors. Between the pillars, as the case may be, parapets will be provided made of metal fence structure protected against corrosion and fixed to the post by embedding, as well as wooden plates with the size of 100x5x4 cm

Equipment dimensions: length 120 cm, width 120 cm, height 340 cm. The fixing of the equipment will be done by 4 metal supports that prevent the direct contact of the wood with the ground, in B150 concrete foundation, at a depth of 75 cm.



Tower with roof - 5 units

Made of wood with machined surfaces, without splinters, cracks or other defects that could cause harm to children, being protected and colored by impregnation with preventive protection products, respectively by coating with paint.

The wooden poles (4 pcs) will have a square section of at least 90 x 90 mm. A PAFS roof will be provided on the upper parts of the pillars, with a size of 120 x 120 cm and a height of 50-60 cm. Between the pillars, as the case may be, there will be parapets made of metal fence structure protected against corrosion and fixed to the pillar by embedding, as well as wooden plates with the size of 100x5x4 cm Equipment dimensions: length 105 cm, width 105 cm, height 250 cm . The fixing of the equipment will be done through 4 metal supports that prevent the direct contact of the wood with the ground, in B150 concrete foundation, at a depth of 75 cm.

**Ladder - 1 unit**

Equipped with steps made of wood with dimensions of 90 x 20 x 4 cm, as well as with railings made of inclined metal fences that will contain wooden plates. The joining elements will be screw-nut assembly buried in the wooden structure and protected with plastic covers.



Climbing net - 1 unit

Ladder attached to the tower consisting of rope elements, provided at the ends with eye sleeves for fixing, both on the tower and on the foundation.

Connection tube - 5 units

Made of PAFS, fixed on the metal fence structure with screw-nut fasteners. Dimensions: diameter - 800 mm; length - 150 cm.

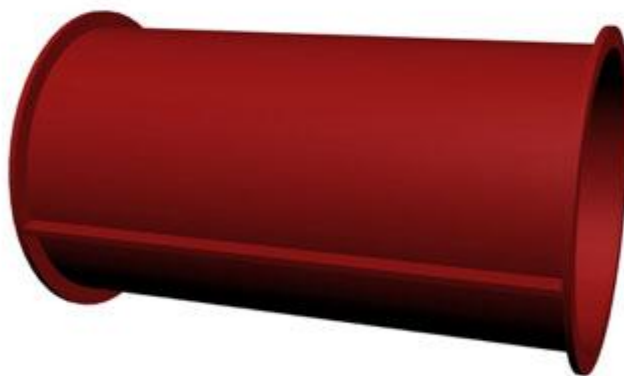

Connection bridge - 4 units

Made of wood and twisted cable. It will contain wooden sleepers with machined surfaces, without splinters, cracks or other defects that could cause damage to children, supported by horizontal ropes. On the sides will be provided protections made of mesh, made of twisted cable, supported by horizontal sleepers, which will make the connection between the pillars of the towers.

Dimensions: length - 200 cm, width - 108 cm.

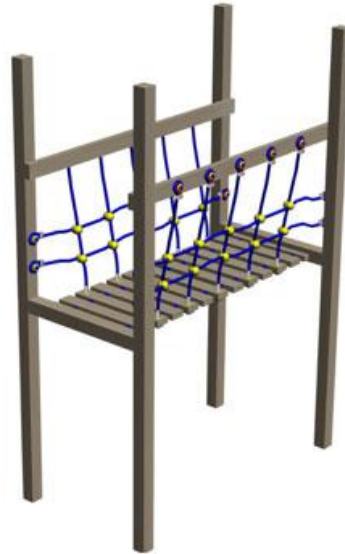

Network connection bridge - 3 units

Made of twisted cable, wood and ropes. It will be provided with 2 horizontal wooden sleepers, which will connect the tower pillars.

Dimensions: length - 250 cm, width - 105 cm, height of fall - 150 cm.

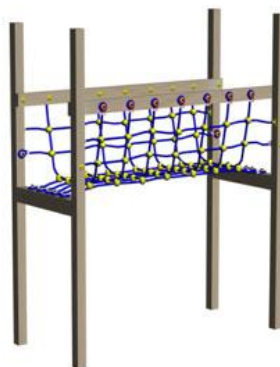

Straight slide - 1 unit

Made of HDPE and will hook the tower. It will be provided with side protections with a height of 20 cm in the middle and lower part and 50 cm in the upper part. Dimensions: length - 250 cm, width - 40 cm, height of fall - 150 cm.

**Double straight slide - 1 unit**

Made of fiberglass and will hook the tower. It will be provided with side protections with a height of 20 cm in the middle and lower part and 50 cm in the upper part. Dimensions: length - 250 cm, width - 40 cm, height of fall - 150 cm.



Helical slide - 1 unit

Made of fiberglass and will hook the tower. It will be provided with lateral protections with a height of 25 cm on the lower part, 30 cm on the middle part and 50 cm on the upper part.
Dimensions: length - 300 cm, width - 50 cm, height of fall - 150 cm.

**Slide tube - 1 unit**

Made of fiberglass and will hook the tower.
Dimensions: length - 250 cm, diameter – 800 mm, drop height - 150 cm.

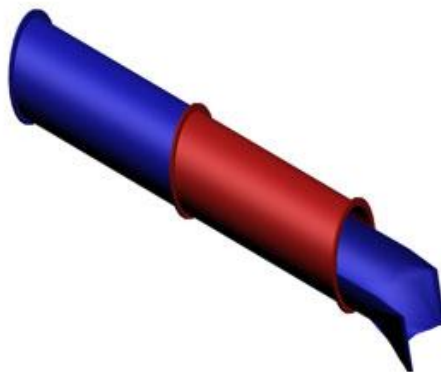

Cross member - 1 unit

Equipped with rings and twine, made of two dry and shaped wooden pillars that will be fixed in a concrete foundation and provided at the top with a crossbeam, on which the climbing rope and rings will be mounted. They will be located equidistantly. Dimensions: length - 220 cm, height - 210 cm.

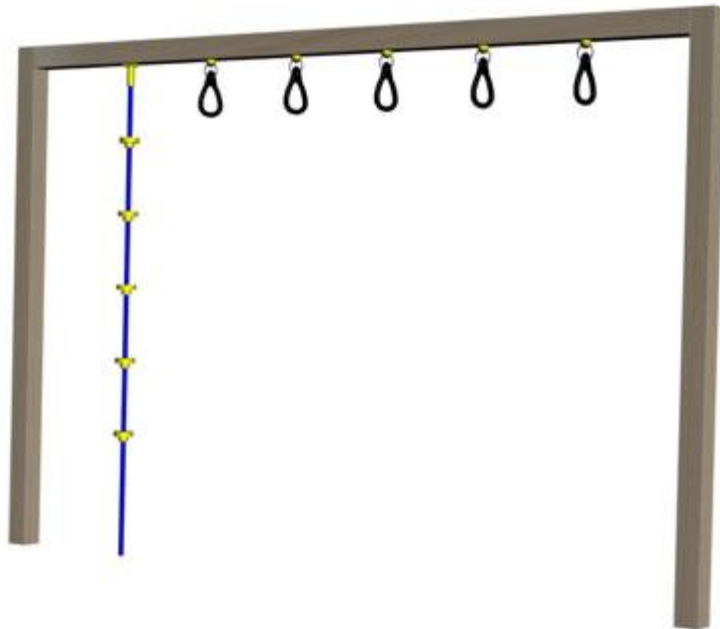

Climbing net - 1 unit

Composed of two dry and shaped wooden poles that will be fixed in a concrete foundation and provided at the top with a crossbar, on which will be mounted horizontal and vertical ropes, arranged equidistantly. Dimensions: length - 220 cm, height - 210 cm

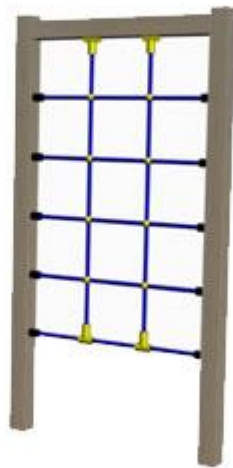
**Steep climbing net - 1 unit**

Composed of two dry and shaped wooden poles that will be fixed in the concrete foundation and connected to the upper part by a crossbar, on which will be mounted two rope elements, provided with flange ends, for fastening on the crossbar of the equipment. The rope elements will be arranged vertically, at a height of 210-220 cm. Dimensions: length - 115 cm, height-210 cm.

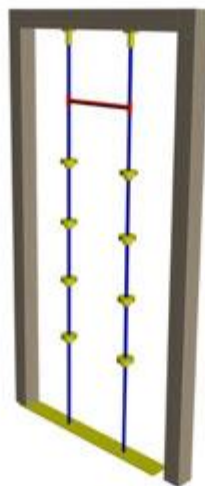

Panel with interactive games - 4 units

Provided with the game "X O". It will be made of HDPE and will be fixed to the bottom of the towers, to be used by children at ground level. Dimensions: 90x10x85 cm



2. Double swing (for children 2-15 years)

Made of mass impregnated wood structure. The height of the seat relative to the contact surface will be 45-50 cm, and the height of fall will be a of 130 cm. The pillars will be made of mass impregnated wood, square section, with rounded edges, with a size of 100 x 100 mm. On the upper part, the wooden poles treated by autoclaving will be fixed with 2 sheet metal supports with a thickness of at least 3 mm, painted in electrostatic field. The seats will be made of rubber reinforced with aluminum inserts, with a high resistance to breakage. Seat dimensions: length - 40 cm; width: 15 cm, height: 25 cm, thickness: 4 cm. The chains will be made of stainless steel, with a length of 150-160 cm, $\varnothing 5-6$ mm eyes and will be wrapped in polypropylene sheath for hand protection. In the lower part, for fixing in the concrete foundations, the swing will be provided with 4 metal legs painted in electrostatic field, made of U profile with dimensions 40 x 20 x 1.5 mm and length of 45 cm. Dimensions of the swing: length: 295 cm; width: 170 cm; height: 235 cm



3. Double swing (for children 1-3 years)

Made of mass impregnated wood structure. The height of the seat relative to the contact surface will be 45-50 cm, and the height of fall will be a of 130 cm. The pillars will be made of mass impregnated wood, square section, with rounded edges, with a size of 100 x 100 mm. On the upper part, the wooden poles treated by autoclaving will be fixed with 2 sheet metal supports with a thickness of at least 3 mm, painted in electrostatic field. The basket seats will be made of rubber reinforced with inserts, with a high resistance to breakage. Seat dimensions: length - 40 cm; width: 20 cm, height: 25 cm, thickness: 3 cm. The chains will be made of stainless steel, with a length of 150-160 cm, $\varnothing 5-6$ mm eyes and will be wrapped in polypropylene sheath for hand protection. In the lower part, for fixing in the concrete foundations, the swing will be provided with 4 metal legs painted in electrostatic field, made of U profile with dimensions 40 x 20 x 1.5 mm and length of 45 cm. Dimensions of the swing: length: 295 cm; width: 170 cm; height: 235 cm.



4. Swing for children with disabilities

Made of 4 galvanized steel poles, protected against corrosion by electrostatic painting. Component: **upper frame**, made of curved galvanized steel, in which the 4 pillars will be fixed and which will contain the system for holding the swing basket and a horizontal cross member on which the safety chains will be fixed; the rocking basket will provide easy access to the wheelchair, by moving it on a tilted mobile platform, will ensure control of the rocking speed.

The inner platform of the swing basket (on which the wheelchair will be placed) will have the following dimensions: length - 110 cm, width - 90 cm.

The safety chains will be made of stainless steel rings, covered by a polypropylene sheath, in order to protect the hands.

Dimensions of the swing: length: 280 cm; width: 180 cm; height: 260 cm, drop height 130 cm.

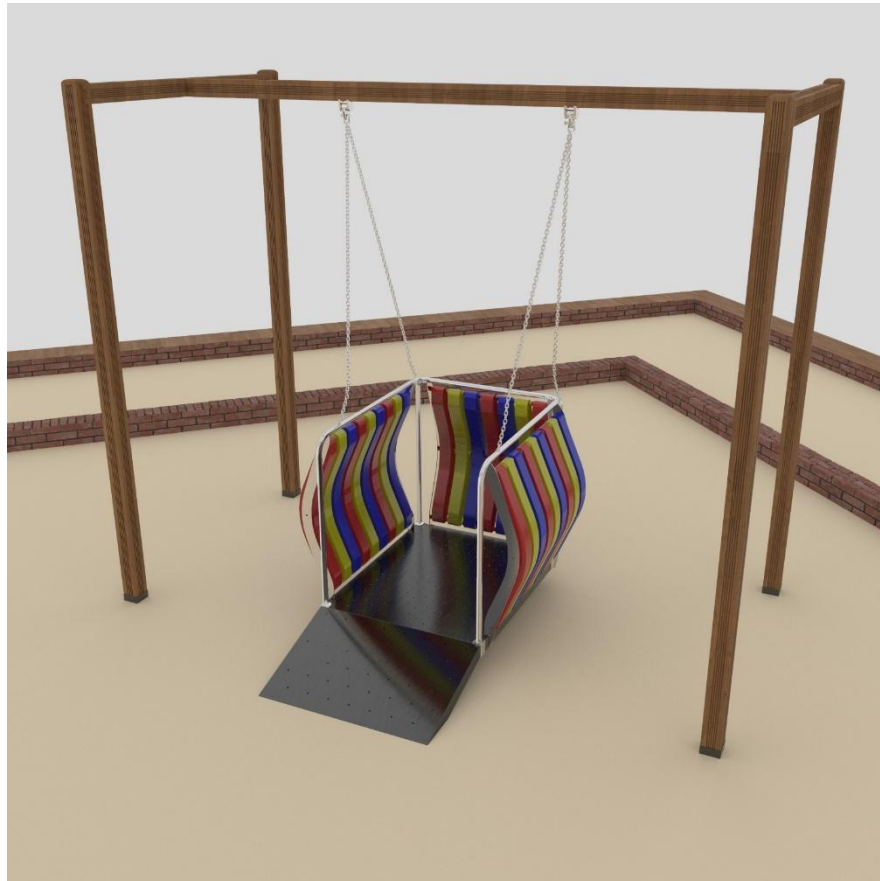

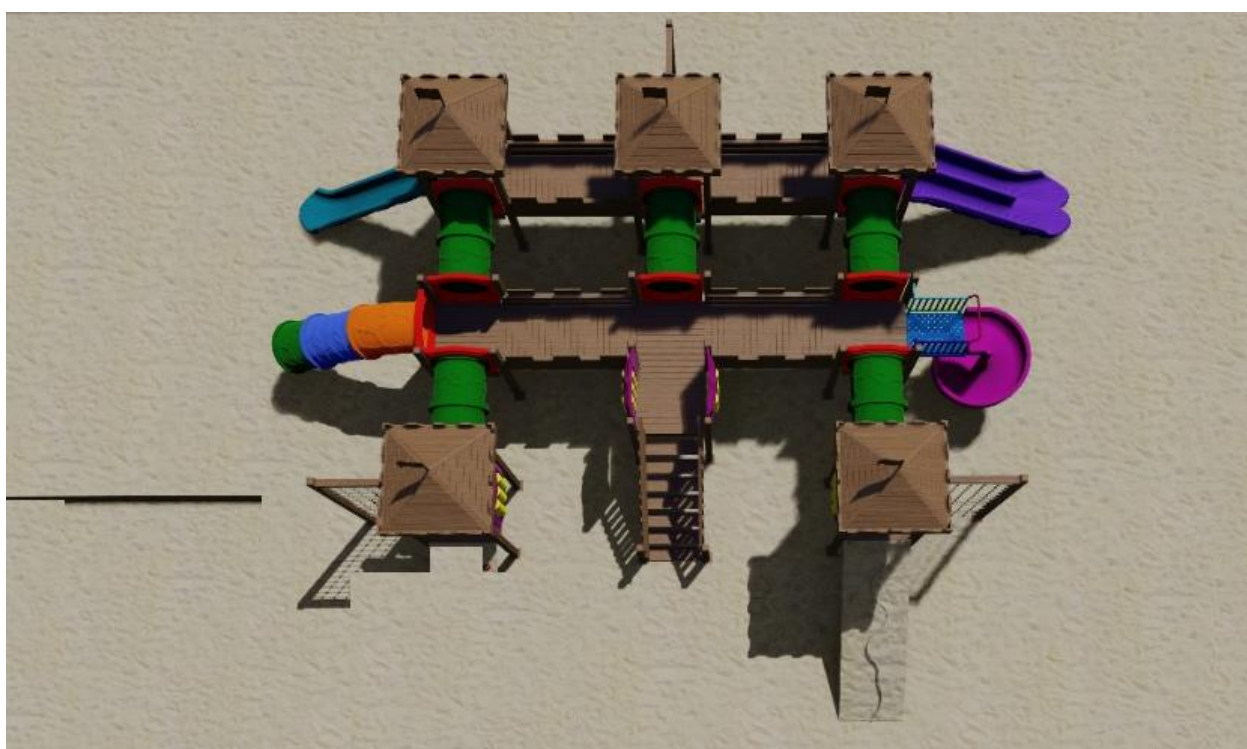

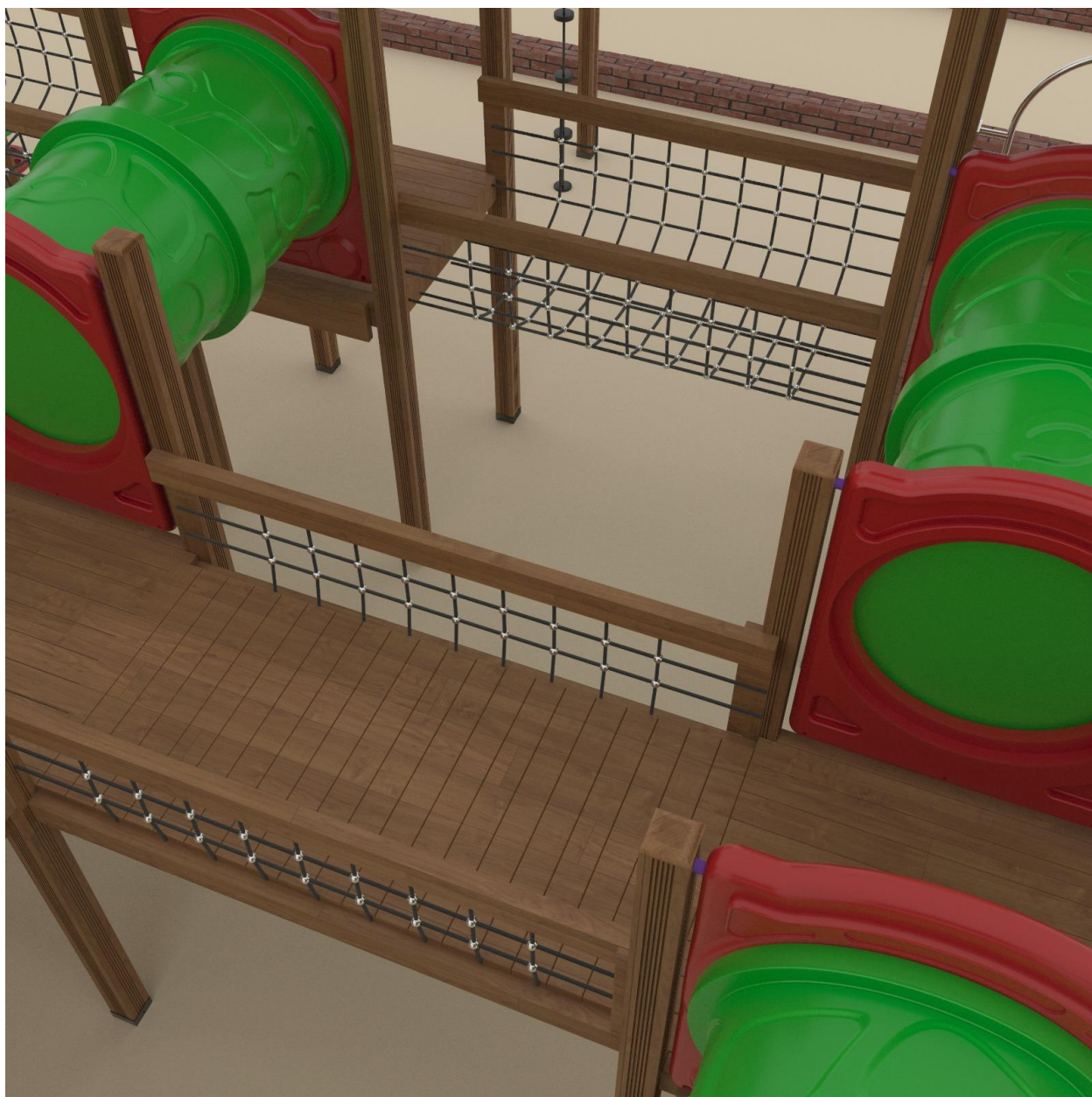



SİMAT OFİS EĞİTİM MALZ. PAZ. GİD. DIŞ TİC. VE SAN. LTD.ŞTİ.

Sincerely,

Kazım TAVUKÇUOĞLU

simat Simat Ofis Eğitim Malzemeleri
Paz. Gıda Tic. ve San. Ltd. Şti.
Fevzi Çakmak Mah. Aydınlık Cad. No: 10 / Konya
Tel: 0332 347 2000 - Faks: 0332 347 2001
Selçuk Voc. Dairesi : 770 044 2427