

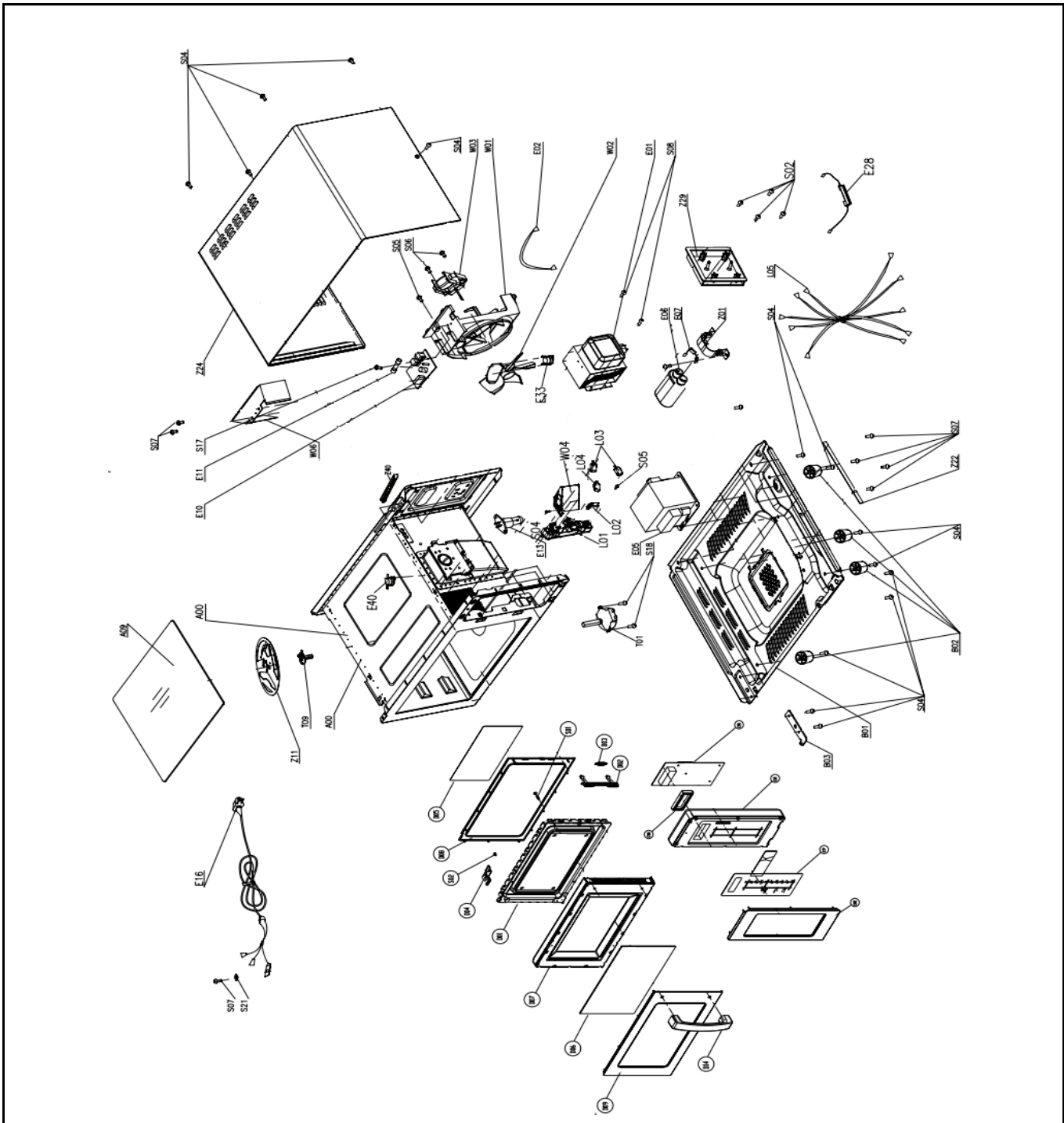

# Drawing

 <p><b>Hendi B.V.</b> Steenoven 21 3911 TX Rhenen The Netherlands</p>	<b>Batch #</b>	<b>Appliance part#</b>
	HK170599 and up	<b>281444</b>
	<b>Description</b>	
	Microwave programmable 1000W	

<b>Date</b>	12-03-2018	<b>Revision #</b>	Revision version
<b>Revision</b>	First bill of materials (BOM)		



### Bill of materials (BOM)

 <b>HENDI</b> FOOD SERVICE EQUIPMENT  <b>Hendi B.V.</b> Steenoven 21 3911 TX Rhenen The Netherlands	<b>Batch #</b>	<b>Appliance part#</b>
	HK170599 and up	<b>281444</b>
	<b>Description</b>	
<b>Microwave programmable 1000W</b>		

<b>Date</b>	12-03-2018	<b>Revision #</b>	Revision version
<b>Revision</b>	First bill of materials (BOM)		

Item	Description	Part#	Quantity	Remark	Picture
C00	Control Panel Assembly	943779	1	Item C01;C02;17;C18;C11;C50	
C01	Control Panel Housing	nss	1		
C02	Control Panel Housing Cover	nss	1		
C17	Membrane Switch	nss	1		
C18	Control Panel PCB	nss	1		
C50	Rubber Cover for Control PCB	nss	1		
D00	Complete Door Assembly	943786	1	Incl. Items D01~D14	
D01	Door Frame	nss	1		
D02	Door Latch	nss	1		
D03	Door Latch Spring	nss	1		
D04	Upper Hinge	nss	1		
D05	Door Film	nss	1		
D06	Door Screen	nss	1		
D07	Door Panel	nss	1		
D08	Door Gasket	nss	1		
D09	Door Panel Cover	nss	1		
D14	Door Handle Assembly	nss	1		
A00	Housing assembly	n/a	1	Incl. items A00;T01;T09;Z11;A09	
B01	Bottom Plate	n/a	1		
B02	Foot	943793	4		
B03	Lower Hinge	n/a	1		
E01	Beamer	943809	1		
E05	High Voltage Transformer	943816	1		
E06	High Voltage Capacitor	943823	1		
E07	High Voltage Diode	943830	1		
E10	EMC Filter	943847	1		
E11	Main Fuse (10 Amp)	n/a	1	Obtain Locally	
E13	Lamp	943861	1		
E16	Powercord	943878	1		
E28	High voltage fuse	943885	1		
E35	Clixon 160°C	943892	1		
E40	Clixon 110°C	943908	1		
L00	Door switch complete assembly	943854	1	Incl item L01;L02;L03 and 2x L04	
L01	Door Safety Base	nss	1		
L02	Door Safety Lever	nss	1		
L03	Microswitch "A"	nss	2		
L04	Microswitch "B"	nss	1		
L05	Wire Harness	n/a	1		
W01	Fan Mounting Bracket	n/a	1		
W02	Fan Blade	n/a	1		
W03	Fan Motor	943915	1		
W04	Lamp cover	n/a	1		
W06	Wind Guide Beamer (Back Side)	n/a	1		
Z01	High Voltage Capacitor Bracket	n/a	1		
Z24	Housing Cover	n/a	1		
Z29	Cover	n/a	1		
Z40	Housing cover	n/a	1		

n/a -> not available

nss -> not sold separately

### Circuit diagram

 <p><b>Hendi B.V.</b> Steenoven 21 3911 TX Rhenen The Netherlands</p>	<b>Batch #</b>	<b>Appliance part#</b>
	HK170599 and up	<b>281444</b>
	<b>Description</b>	
	Microwave programmable 1000W	

<b>Date</b>	12-03-2018	<b>Revision #</b>	Revision version
<b>Revision</b>	First bill of materials (BOM)		

