

Fatada 1-5

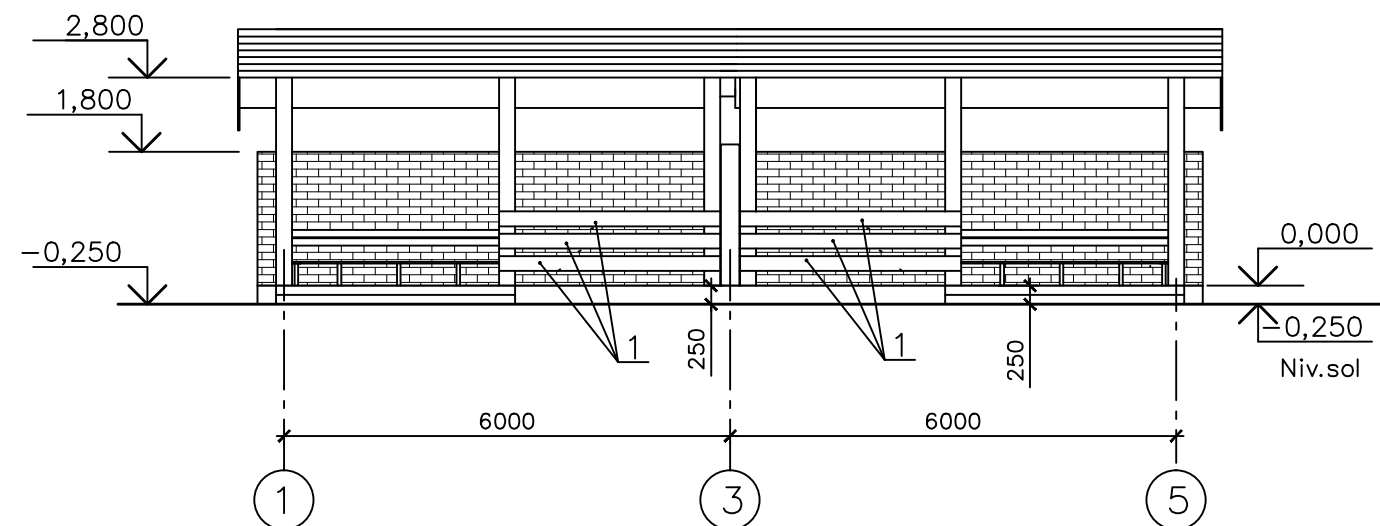

① f.2 si 4

③ S=poz.3,4 -3,20 m²

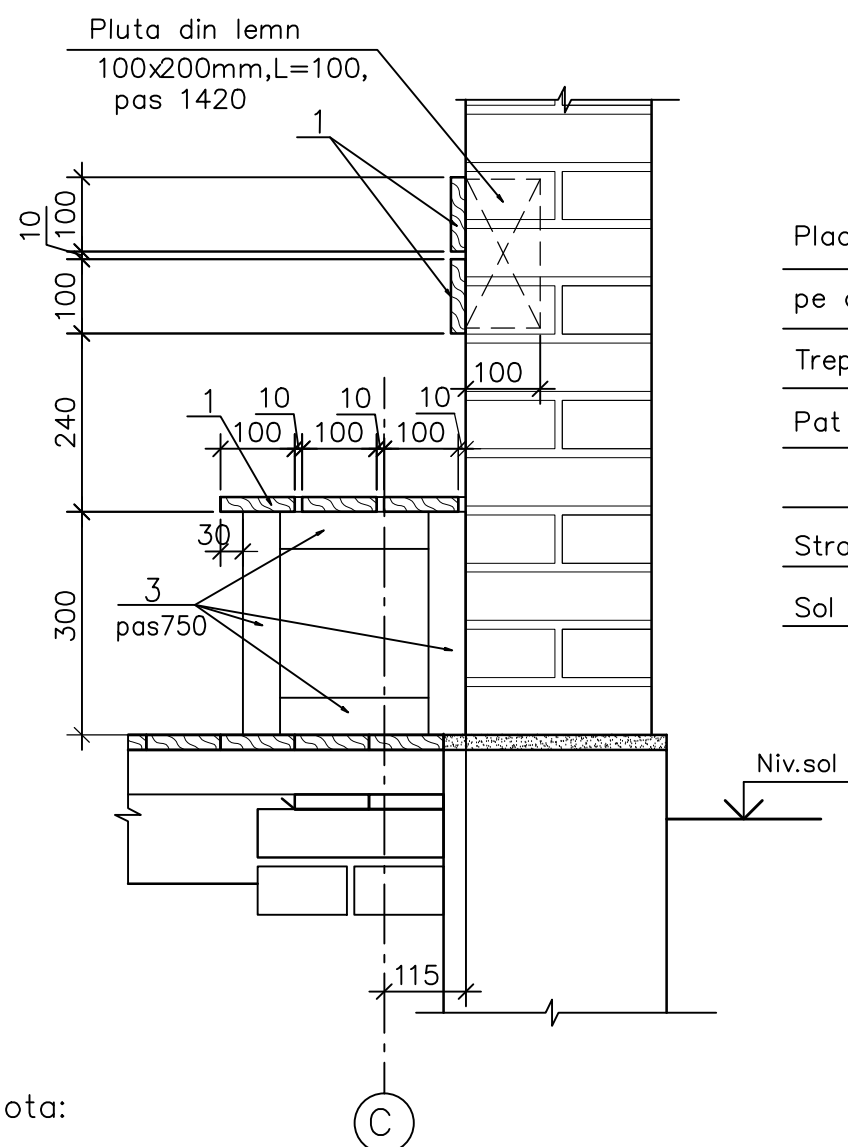

Placa de ceramica (striat)	
pe compositie adeziva	- 5mm
Trepte de beton clasa C12,5	
Pat de beton clasa B12,5 ,armat ø4Br I	
pas 150x150mm	- 80mm
Strat de petris batatorit	- 40mm
Sol tasat	

Nota:

1. Foaia data se studiaza impreuna cu f.4.

Fatada C-A

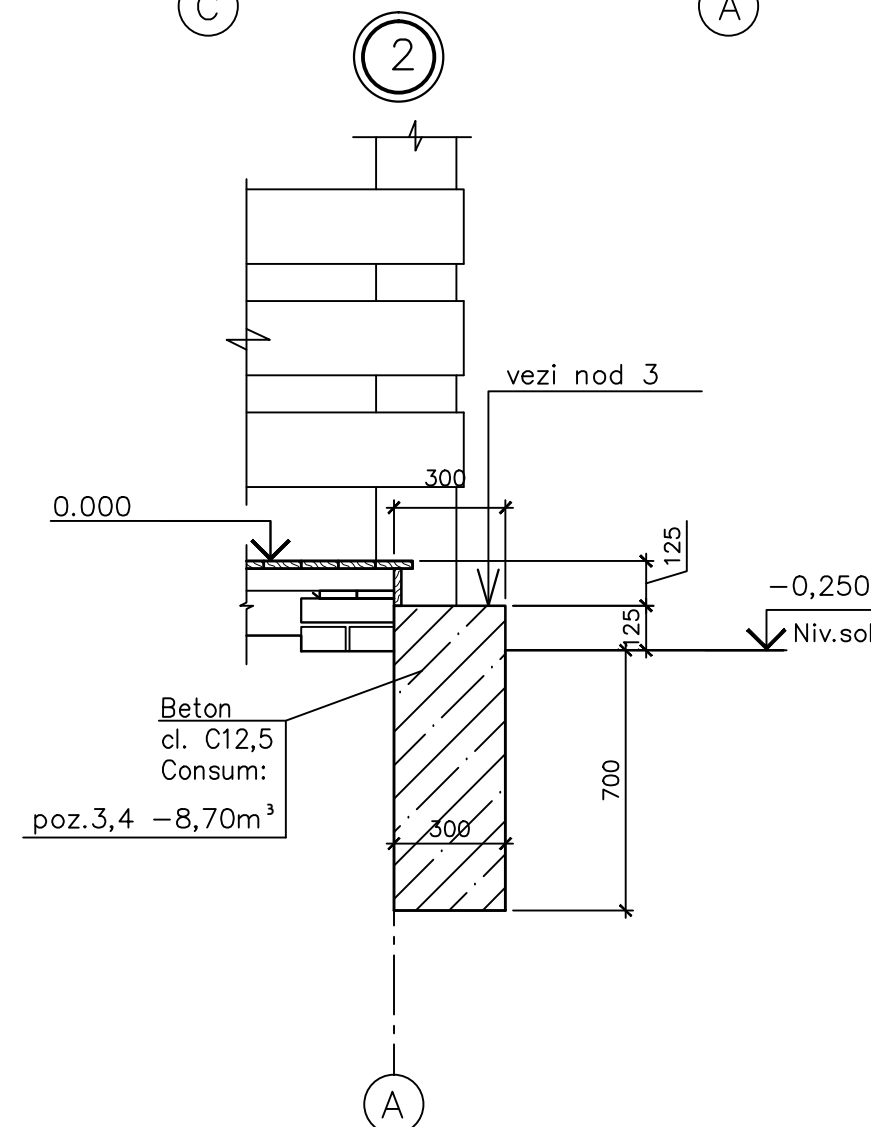
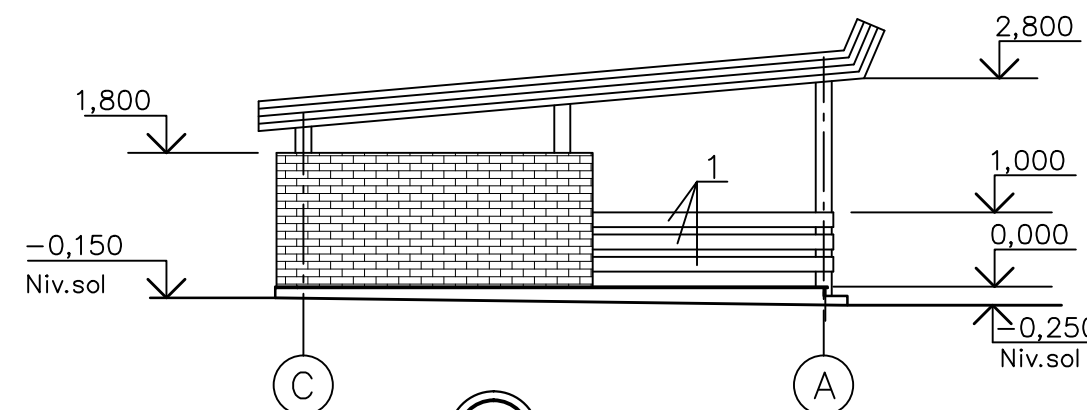

						0510/2021			
						Pavilion pentru copii la gradinite subordonate DETS sectorului Buiucani mun.Chisinau			
Sch.	Cant.	Foaia	N doc.	Semn.	Data	Sopron parasolar-tip-2	Etapă	Foaia	Foi
AŞP		Sava I.			10.21		S.P.	3	
Sp.princ.		Svet I			"	Fatada 1-5 si C-A. Nod 1 si 2.	SRL"PROI-DEVI" mun.Chisinau		