

FIŞĂ TEHNICĂ

a corpului de iluminat

9 septembrie 2020

MODEL: Street Spectra 30W-50W, 4500K, PJ1502,L330*W150*H65mm

Imagini, date tehnice:

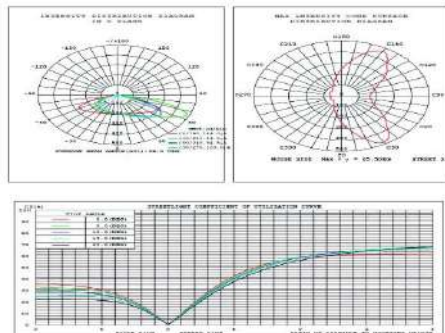

Domeniul de utilizare: este destinat iluminatului stradal și a altor spații deschise: alei, trotuare, parcuri, zone pietonale, drumuri rurale, principale și secundare, gări, parcuri și alte suprafețe asemănătoare.

Sursă de lumină: LED 3030 CREE, Ra=92, durata de viață -1000000 ore.

Flux : 2700 - 6000K , 30W , 125lum/W

Descrierea produsului:

Carcasa totodată radiator pasiv din aluminiu

Sistem de montare pe stilp în consola, pe teava orizontală (Ø 40-60mm)

Dispensur : Lentila din policarbonat cu asimetrie și unghi de propagare la 150°.

Driver pentru alimentarea sursei TRIDONIC, cu PF>0,9.

Marimi : :330*150*65mm

Masa : 1,8 kg

Culoare : GRI

Caracteristici tehnice:

Frecvența-50Hz

Tensiunea de alimentare 160-260 V.

Temperatura ambientală: -30 - + 40 °C

Grad de protecție : IP-65

Rezistența de izolație și rigiditate electrică : clasa I

Corespunde standardelor pentru iluminat și sînt conforme cu cerințele obligatorii stabilite în:

HG Nr. 255 din 05.03.2008 pentru aprobarea Reglementării tehnice

“Securitatea echipamentelor electrice de joasă tensiune”

SM SR EN 60598-2-3:2010 (cap.3.4-3.11, 3.14)

Verificat și aprobat

director, Danu Vadim



Иллюстрации

Альтернатива 2



Альтернатива 2

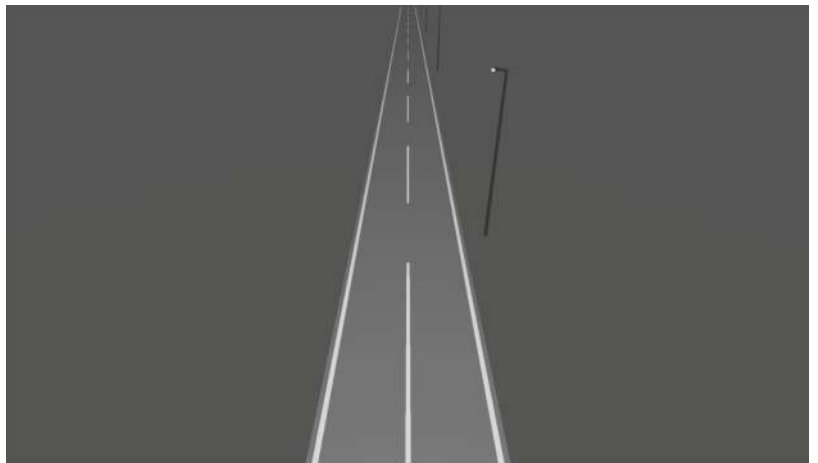

Проект 0



Иллюстрации

Проект 0



Проект 0



Техпаспорт изделия

LED MARKET SRL 30W 6000K

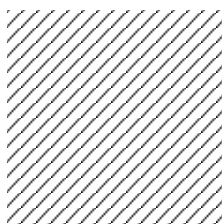

Р	30.0 W
Ф _{Лампа}	4600 lm
Ф _{Светильник}	4587 lm
η	99.71 %
Светоотдача	152.9 lm/W
ССТ	3000 K
CRI	100

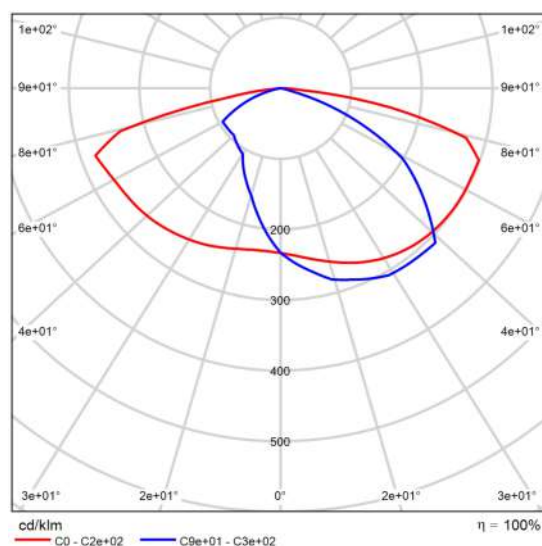

Полярные LDC



Nicolae Milescu Spataru 30w Spectra

Описание

Nicolae Milescu Spataru 30w Spectra

Резюме (по EN 13201:2015)

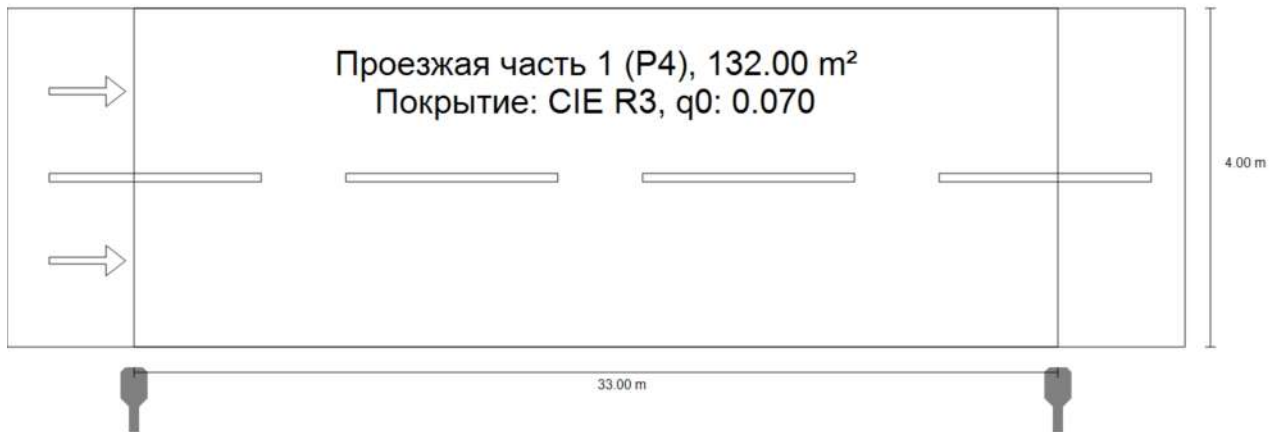

Nicolae Milescu Spataru 30w Spectra
Резюме (по EN 13201:2015)

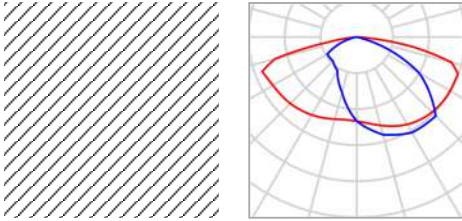

Производитель	LED MARKET SRL	P	30.0 W
Название артикула	30W 6000K	Φ _{Лампа}	4600 lm
Комплектация	1x Street Light SPECTRA TYPE 3M	Φ _{Светильник}	4587 lm
		η	99.71 %

30W 6000K (односторонне внизу)

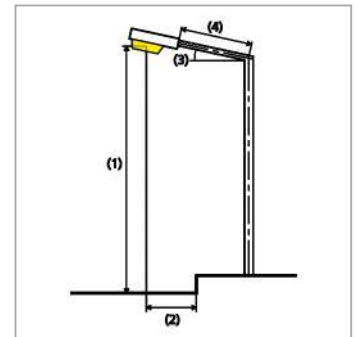

Расстояние между мачтами	33.000 m
(1) Высота светового центра	7.000 m
(2) Вылет светового центра	-0.500 m
(3) Наклон консоли	15.0°
(4) Длина консоли	0.491 m
Годовые рабочие часы	4000 h: 100.0 %, 30.0 W
Потребление	900.0 W/km
ULR / ULOR	0.00 / 0.00
Макс. силы света В во всех направлениях, которые образуют указанный угол с нижней вертикалью в инсталлированных и готовых к работе светильниках.	≥ 70°: 335 cd/klm ≥ 80°: 307 cd/klm ≥ 90°: 80.9 cd/klm
Класс интенсивности света Значения интенсивности света в [свечи/килолюмены] для расчета класса интенсивности света относятся в соответствии с EN 13201:2015 к световому потоку.	-
Класс индекса ослепления	D.0



Nicolae Milescu Spataru 30w Spectra

Резюме (по EN 13201:2015)

Результаты для полей оценки

	Размер	Рассчитано	Заданное	Проверить
Проезжая часть 1 (P4)	E_{cp}	6.07 lx	[5.00 - 7.50] lx	
	E_{min}	2.01 lx	≥ 1.00 lx	

Инсталляция выполнена в предположении фактора стабильности 0.67.

Результаты для показателей энергоэффективности

	Размер	Рассчитано	Потребление
Nicolae Milescu Spataru 30w Spectra	D_p	0.037 W/lx*m ²	-
30W 6000K (односторонне внизу)	D_e	0.9 кВт-ч/м ² год,	120.0 кВт-ч/год

Nicolae Milescu Spataru 30w Spectra

Проезжая часть 1 (P4)

Результаты для полей оценки

	Размер	Рассчитано	Заданное	Проверить
Проезжая часть 1 (P4)	E_{cp}	6.07 lx	[5.00 - 7.50] lx	✓
	E_{min}	2.01 lx	≥ 1.00 lx	✓

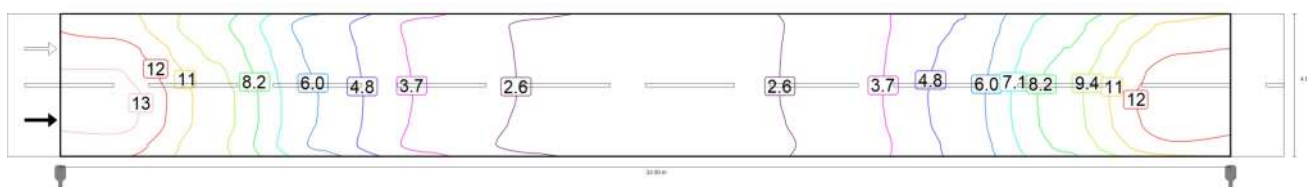

Необходимая горизонтальная освещенность [lx] (изолинии)

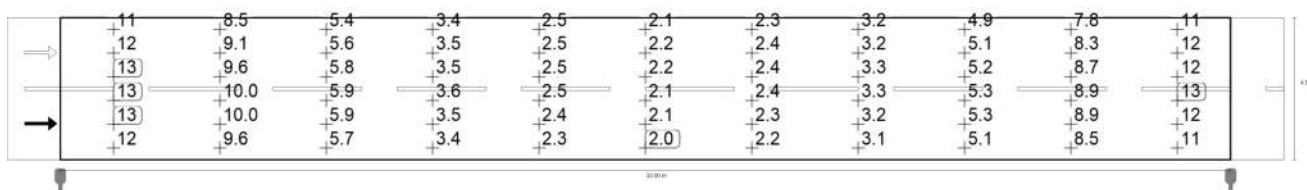

Необходимая горизонтальная освещенность [lx] (Растр параметров)

m	1.500	4.500	7.500	10.500	13.500	16.500	19.500	22.500	25.500	28.500	31.500
3.667	11.24	8.53	5.41	3.42	2.46	2.15	2.34	3.16	4.89	7.80	10.76
3.000	12.16	9.13	5.64	3.50	2.49	2.16	2.37	3.22	5.08	8.29	11.59
2.333	12.90	9.62	5.81	3.55	2.50	2.16	2.37	3.25	5.22	8.68	12.20
1.667	13.35	9.96	5.93	3.57	2.50	2.15	2.37	3.27	5.31	8.93	12.56
1.000	13.19	9.97	5.90	3.51	2.45	2.10	2.31	3.20	5.25	8.87	12.33
0.333	12.29	9.64	5.73	3.38	2.34	2.01	2.21	3.06	5.06	8.51	11.49

Необходимая горизонтальная освещенность [lx] (График значений)

	E_{cp}	E_{min}	E_{max}	g_1	g_2
Необходимая горизонтальная освещенность	6.07 lx	2.01 lx	13.3 lx	0.330	0.150

TEST REPORT

Reference No. : WTZ82Y24175428R
Applicant..... : ZHONGSHAN WOSEN LIGHTING TECHNOLOGY CO., LTD.
Address..... : Address: No.526, Dong'an North Road,Haizhou, Guzhen Town,
Zhongshan City, Guangdong,China
Manufacturer..... : LED market SRL
Address..... : sos. Muncesti 801, mun. Chisinau, R. Moldova
Product Name..... : Lighting
Model No...... : Spectra
Ratings..... : --
Standards..... : IEC 60529:1989+A1:1999+A2:2013
IEC 62262:2002
Customer commission
Date of Receipt sample : 2020-07-03
Date of Test..... : 2020-07-08 to 2020-07-09
Date of Issue..... : 2020-07-17
Test Report Form No. : WST-60529-50B
Test Result..... : Pass

Remarks:

The results shown in this test report refer only to the sample(s) tested, this test report cannot be reproduced, except in full, without prior written permission of the company. The report would be invalid without specific stamp of test institute and the signatures of compiler and approver.

Prepared By:

Waltek Services (Foshan) Co., Ltd.

Address: No.13-19, 2/F., 2nd Building, Sunlink International Machinery City,
Chencun, Shunde District, Foshan, Guangdong, China

Tel:+86-757-23811398 Fax:+86-757-23811381 E-mail:info@waltek.com.cn

Compiled by:

Approved by:

Can Guo/Project Engineer

Jerry Mu/Manager

WTZ82Y24175428R List of test

No. items:	Test Items	Requirement + Test	Result
1	IP65 Test	IEC 60529:1989+A1:1999+A2:2013	Pass
2	IK09	IEC 62262:2002	Pass
3	High temperature test	Customer commission	Pass
<p>Subcontract Whether parts of tests for the product have been subcontracted to other labs: <input type="checkbox"/> Yes <input checked="" type="checkbox"/> No If Yes, list the related test items and lab information: Test items: --- Lab information: --</p>			
<p>Remarks: Full tests were carried out on the two models</p>			

Test Item :

Tests for protection against dust-proof: IP6X

Test Method: The test should be carried out under the standard atmospheric condition.

The atmospheric conditions during tests are as follows:

Temperature range: 15 °C to 35 °C. Relative humidity: 25% to 75%.

The test is made using a dust chamber incorporating the basic principles shown in figure 2 where by the powder circulation pump may be replaced by other means suitable to maintain the talcum powder in suspension in a closed test chamber. The talcum powder used shall be able to pass through a square-meshed sieve the nominal wire diameter of which is 50µm and the nominal width of gap between wires 75 µm. The amount of talcum powder to be used is 2 kg per cubic meter of the test chamber volume. It shall not have been used for more than 20 tests.

Enclosures are of necessity in one of two categories:

Category 1: Enclosures where the normal working cycle of the equipment causes reductions in air pressure within the enclosure below that of the surrounding air, for example, due to thermal cycling effects.

The enclosure under test is supported inside the test chamber and the pressure inside the enclosure is maintained below the surrounding atmospheric pressure by a vacuum pump. In no event shall the depression exceed 2 KPa(20mbar) on the manometer shown in figure 2. If an extraction rate of 40 to 60 volumes per hour is obtained the duration of the test is 2h. The extraction rate is less than 40 volumes per hour, the test is continued until 80 volumes have been drawn through, or a period of 8h has elapsed.

Category 2: Enclosures where no pressure difference relative to the surrounding air is present.

The enclosure under test is supported in its normal operating position inside the test chamber, but is not connected to a vacuum pump. Any drain-hole normally open shall be left open for the duration of the test. The test shall be continued for a period of 8h.

The enclosure shall be deemed category 1, whether reductions in pressure below the atmospheric pressure are present or not.

The test wire of 1.0 mmφ insert into any openings of the enclosure with a force of $1N \pm 10\%$.

Acceptance Conditions:

The protection is satisfactory if no deposit of dust is observable inside the enclosure at the end of the test.

The protection is satisfactory if adequate clearance is kept between the access probe and hazardous parts.

The protection is satisfactory if the access probe 1.0 mm diameter shall not pass through the any opening.

Test Result:

Pass Fail

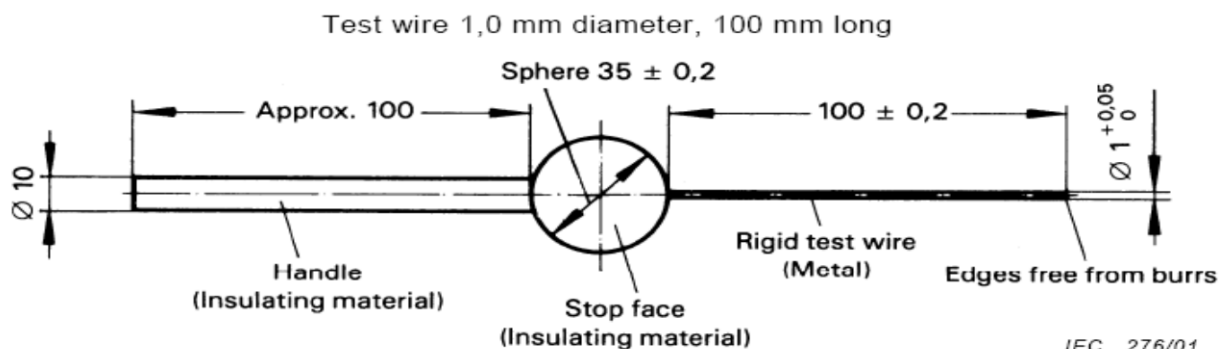

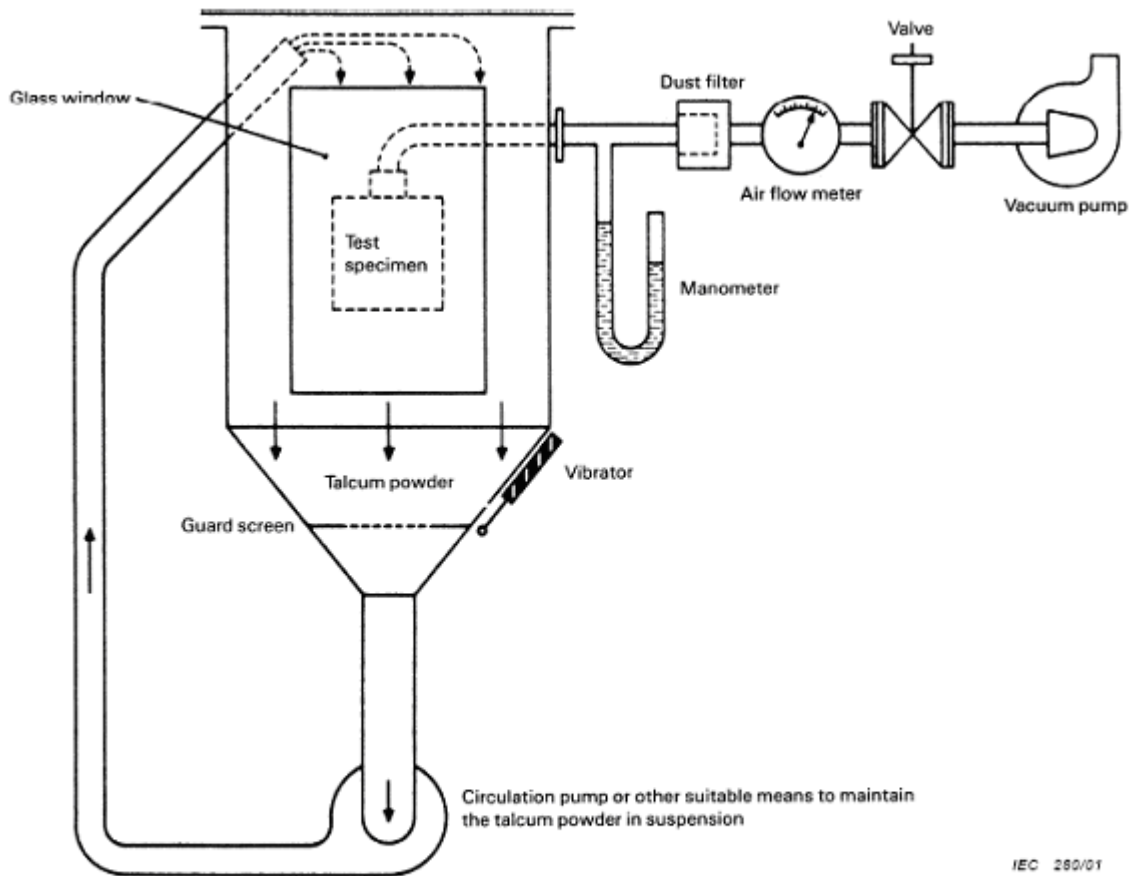

IEC 280/01

NOTE See IEC 60068-2-68, figure 2 valid for La2 only.

Figure 2 – Test device to verify protection against dust (dust chamber)

WTZ82Y24175428R Test Item :

Tests for protection against ingress moisture: IPX5

Test Method:

The tests should be carried out under the standard atmospheric condition. The atmospheric conditions during tests are as follows:

Temperature range: 15 °C to 35 °C; Relative humidity: 25% to 75%.

The tests are conducted with fresh water. The water temperature should not differ by more than 5 K from the temperature of the specimen under test. If the water temperature is more than 5 K below the temperature of the specimen a pressure balance shall be provided for the enclosure.

The test is made by spraying the enclosure from all practicable directions with a stream of water from a standard test nozzle as shown in figure 6.

The conditions to be observed are as follows:

- internal diameter of the nozzle: 6,3mm;
- delivery rate: 12,5 l/min $\pm 5\%$;
- water pressure: to be adjusted to achieve the specified delivery rate;
- core of the substantial stream: circle of approximately 40 mm diameter at 2,5 m distance from nozzle;
- test duration per square meter of enclosure surface area likely to be sprayed: 1 min;
- minimum test duration: 3 min;
- distance from nozzle to enclosure surface: between 2,5 m and 3m.

Acceptance Conditions:

After testing in accordance with the appropriate requirements, the enclosure shall be inspected for ingress of water.

It is the responsibility of the relevant Technical Committee to specify the amount of water which may be allowed to enter the enclosure and the details of a dielectric strength test, if any.

In general, if any water has entered, it shall not:

- be sufficient to interfere with the correct operation of the equipment or impair safety;
- deposit on insulation parts where it could lead to tracking along the creepage distances;
- reach live parts or windings not designed to operate when wet;
- accumulate near the cable end or enter the cable if any.

If the enclosure is provided with drain-holes, it should be proved by inspection that any water which enters does not accumulate and that it drains away without doing any harm to the equipment.

For enclosures without drain-holes, the relevant product standard shall specify the acceptance conditions if water can accumulate to reach live parts.

Test Result:

Pass Fail

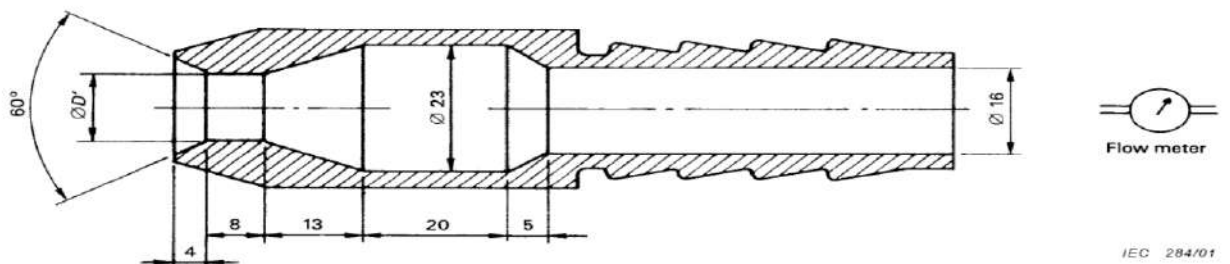

Dimensions in millimetres

$D' = 6,3$ for the test of 14.2.5 (second characteristic numeral 5)

$D' = 12,5$ for the test of 14.2.6 (second characteristic numeral 6)

Figure 6 – Test device to verify protection against water jets (hose nozzle)

Test Item :
IK09 test

Test Method:

1. Unless otherwise specified in the relevant product standard, the test shall be carried out under the standard atmospheric conditions for tests described in IEC 60068-1:
 - temperature range: 15°C to 35 °C.
 - air pressure: 86 Kpa to 106 Kpa (860 mbar to 1060 mbar)
2. Each enclosure under test shall be in a clean and new condition, complete with all its parts in place unless otherwise specified in the relevant product standard.
3. In order to verify the protection against mechanical impacts, blows shall be applied to the enclosure to be tested. The test shall be done by using one of the test apparatus described in IEC 60068-2-75. The device to be used for this test is pendulum hammer.
4. During the test the enclosure shall be mounted on a rigid support, according to the manufacturer's instructions for use.
5. The number of impacts shall be five on each exposed face unless otherwise specified in the relevant product standard. The impacts shall be evenly distributed on the faces of the enclosure(s) under test. In no case shall more than three impacts be applied in the surroundings of the same point of the enclosure. The relevant product standard shall specify the points of application of impacts.
6. The impact energy is 5 J.

Verification procedure

1. Visually check the product and notice any "outside visible modifications". (examples: plastic broken, plastic deformation, rubber shifting, display broken, display shifting, key touch shifting...)
2. Functionally check the product and notice any "malfunctions". (Malfunctions can be functions don't working anymore or product security activation or also difficulty to swipe or insert the smart card)
 - Powered the product
 - Check security activation
 - Check each functions with final control application
3. Disassemble the product and check "inside visible modifications". (examples: plastic broken, PCB components unsoldered, FPC deformation...)

Acceptance Conditions:

1. After completion of the tests, there was no broken for the sample.
2. The mechanical structure, function, performance of the sample complied with the requirements.
3. IK09 test is passed if no "outside visible modifications" or "malfunctions" occurred at the end of test on the two samples. If no "outside visible modifications" and no "malfunction" are noticed, "inside visible modifications" are admissible damages.

Test Result:

Pass Fail

Test Item :
High temperature test

Test Method:

Operating at 25 ° C for 24 hours, Samples should not be damaged after the test.

Test Result:

Pass Fail



Photo 4 -- During the test of IPX5



Photo 5 -- After the test of IP65



Photo 6 -- After the test of IP65

WTZ82Y24175428R Equipment

UEseqduipdmureinngt Test:	Model/Type
Temperature & Humidity Datalogger	THG312
Dustproof chamber	HY-FCX
Power Meter	QINZHI 8775A
Dielectric & Insulation Resistance Tester	CHROMA 9012
Probe	HANYANG FZ-1107-A
Force Gauge	ALGOL NK-300
Protection against water test device	HAIYU HY-IPX1-6
The temperature and humidity of atmospheric pressure gauge	Testo 622
Swing Hammer Impact-Test Apparatus	HANYANG FZ-7812
Tape Measure	Assist 3m
Environmental Chamber	KSON THS-D4C-100

===== End of Report =====

STREETLIGHT PHOTOMETRIC TEST REPORT

Test:U:221.8V I:0.1270A P:27.50W PF:0.9720 Lamp Flux:3992.12x1 lm		
NAME: Street Light SPECTRA	TYPE:30W	WEIGHT:1.2
DIM.:	SPEC.:6000K	SERIAL No.:
MFR.: LED MARKET SRL	SUR.:	PROTECTION ANGLE:

DATA OF LAMP		PHOTOMETRIC DATA Eff: 137.75 lm/W			
MODEL	Street Light AMPERA	Imax(cd)	1650	h street_up(%)	0.0
NOMINAL POWER(W)	30	LOR(%)	94.9	h street_down(%)	40.2
RATED VOLTAGE(V)	222	TOTAL FLUX(lm)	3788	h house_up(%)	0.0
NOMINAL FLUX(lm)	3992.12	MAXIMUM @(C,g)	335,32.5	h house_down(%)	54.6
LAMPS INSIDE	1	h up(%)	0.0	76 FLASHAREA(m2)	
TEST VOLTAGE(V)	221.8	h down(%)	94.9	SLI	

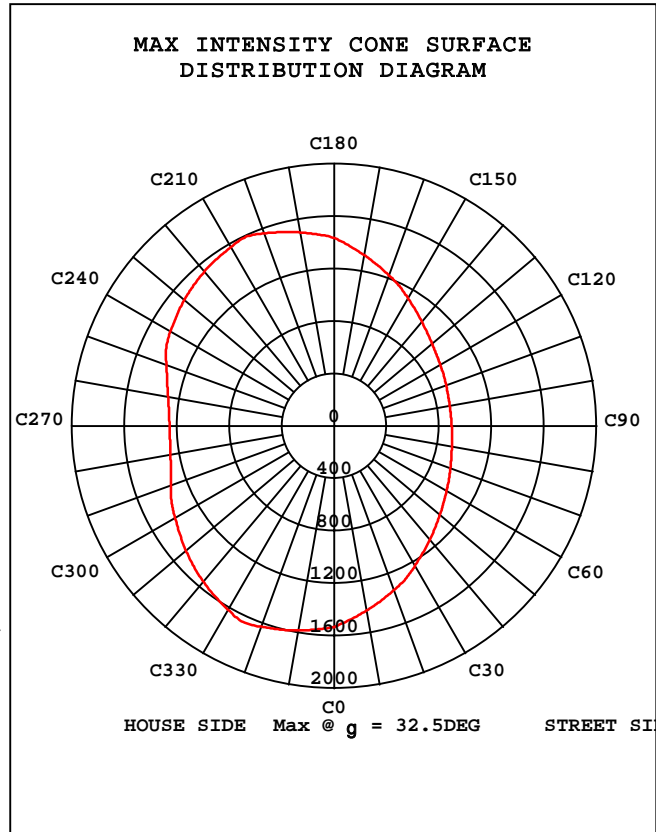
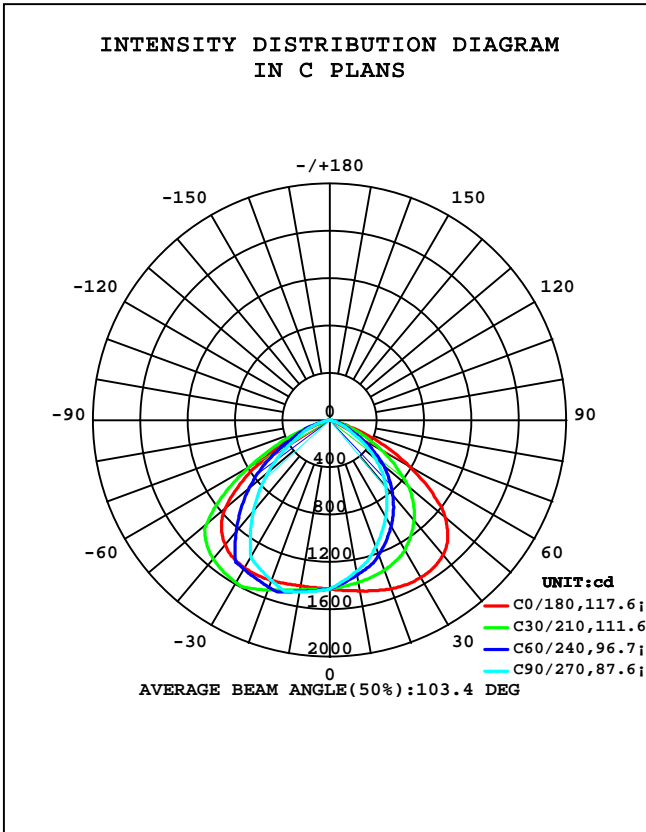

C Range: 0 - 360DEG
 C Interval: 5.0DEG
 Test Speed: HIGH
 Temperature:29DEG
 Operators:DANU VADIM
 Test Date:2020-12-15

g Range: 0 - 90DEG
 g Interval: 0.5DEG
 Test System:EVERFINE GO-2000A_V1 SYSTEM V2.0.269
 Humidity:65.0%
 Test Distance:8.300m [K=1.0000]
 Remarks:

Note: SLI:Specific Luminaire Index
 C:\Users\LAB\Desktop\LED\STREET\Ultra\SPECTRA 30W 6000K.GOS

STREETLIGHT ISOCANDELA DIAGRAM

Test:U:221.8V I:0.1270A P:27.50W PF:0.9720 Lamp Flux:3992.12x1 lm		
	TYPE:30W	WEIGHT:1.2
DIM.:	SPEC.:6000K	SERIAL No.:
MFR.: LED MARKET SRL	SUR.:	PROTECTION ANGLE:

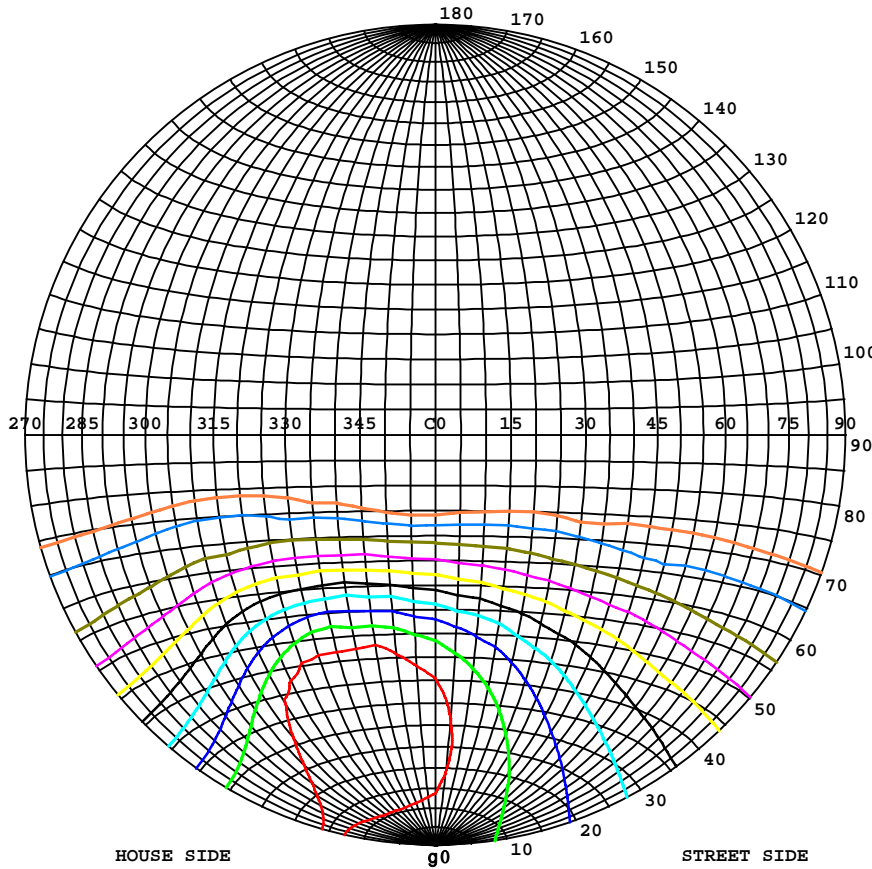

Classification:

IES:Type V - Very Short
 CIE:Narrow - Short
 IES:Cut-off
 CIE:Full cut-off
 Max.At80:13.40cd/klm
 Max.At90:0.2451cd/klm
 Max.80-90:13.40cd/klm
 NRB 5101:Limited[2.5%]

ISOCANDELA DIAGRAM	
UNIT	cd
I _{max} =100%	1650
90%	1485
80%	1320
70%	1155
60%	990
50%	825
40%	660
30%	495
20%	330
10%	165
5%	82

C Range: 0 - 360DEG
 C Interval: 5.0DEG
 Test Speed: HIGH
 Temperature:29DEG
 Operators:DANU VADIM
 Test Date:2020-12-15

g Range: 0 - 90DEG
 g Interval: 0.5DEG
 Test System:EVERFINE GO-2000A_V1 SYSTEM V2.0.269
 Humidity:65.0%
 Test Distance:8.300m [K=1.0000]
 Remarks:

COEFFICIENT OF UTILIZATION CURVE AND ISOLUX DIAGRAM

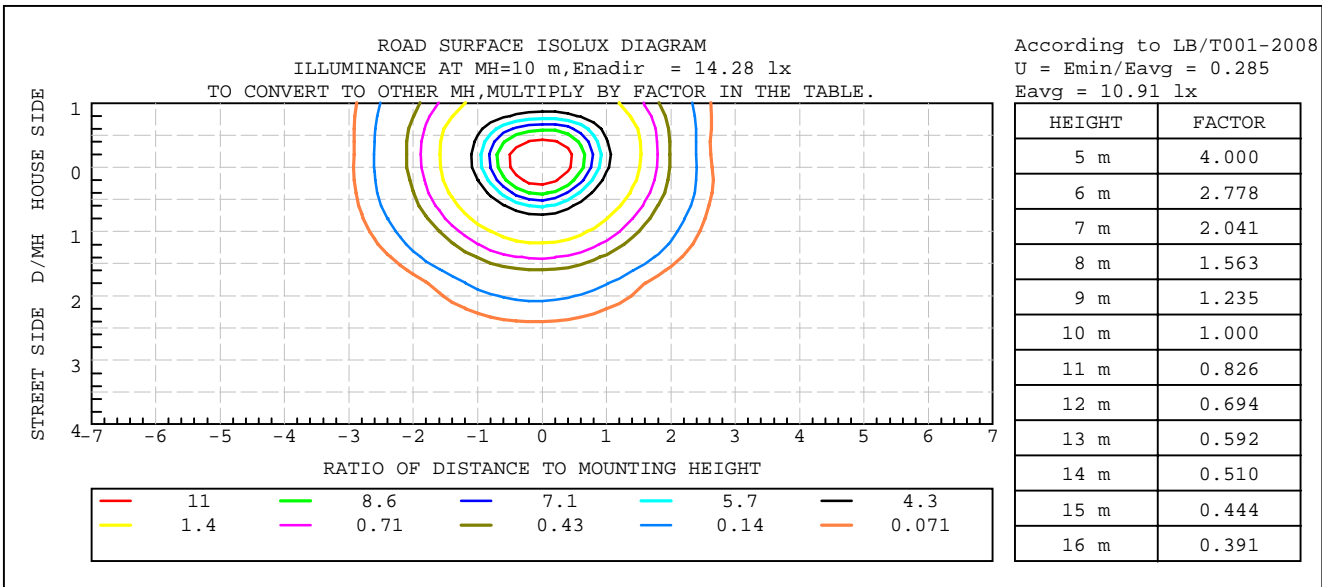
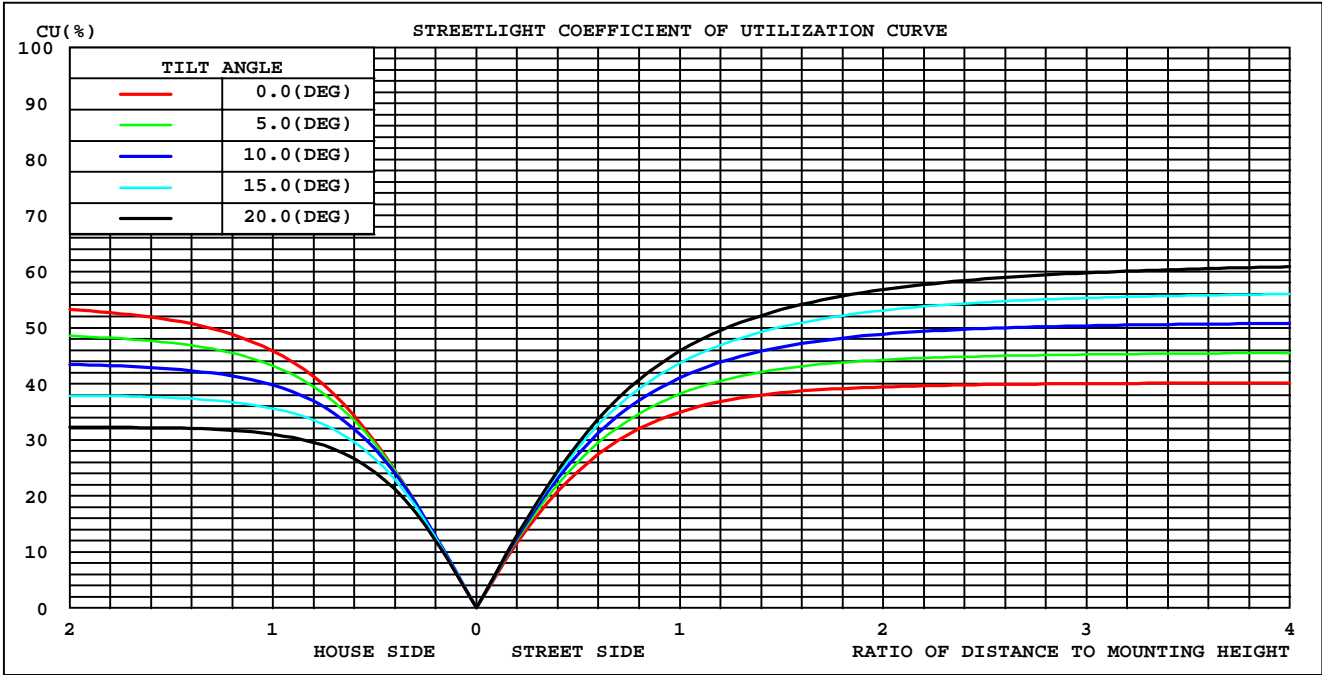

C Range: 0 - 360DEG
 C Interval: 5.0DEG
 Test Speed: HIGH
 Temperature: 29DEG
 Operators: DANU VADIM
 Test Date: 2020-12-15

g Range: 0 - 90DEG
 g Interval: 0.5DEG
 Test System: EVERFINE GO-2000A_V1 SYSTEM V2.0.269
 Humidity: 65.0%
 Test Distance: 8.300m [K=1.0000]
 Remarks:

ZONAL FLUX DIAGRAM

Test:U:221.8V I:0.1270A P:27.50W PF:0.9720 Lamp Flux:3992.12x1 lm		
	TYPE:30W	WEIGHT:1.2
DIM.:	SPEC.:6000K	SERIAL No.:
MFR.: LED MARKET SRL	SUR.:	PROTECTION ANGLE:

g	C0	C45	C90	C135	C180	C225	C270	C315	g	F zone	F total	\$lum,lamp
5	1445	1393	1363	1376	1421	1440	1450	1453	0- 5	33.96	33.96	0.90,0.85
10	1466	1359	1299	1325	1423	1465	1473	1482	5- 10	101.1	135.0	3.56,3.38
15	1492	1323	1235	1274	1431	1500	1495	1517	10- 15	167.0	302.1	7.97,7.57
20	1517	1282	1140	1219	1442	1546	1443	1561	15- 20	230.4	532.4	14.1,13.3
25	1534	1214	1045	1141	1448	1542	1392	1552	20- 25	287.7	820.1	21.6,20.5
30	1536	1134	949.7	1053	1442	1528	1340	1529	25- 30	337.8	1158	30.6,29
35	1526	1048	844.9	957.9	1423	1509	1174	1503	30- 35	377.7	1536	40.5,38.5
40	1489	949.8	740.2	854.5	1378	1469	1009	1457	35- 40	401.8	1937	51.1,48.5
45	1414	831.9	635.4	742.0	1295	1311	842.9	1298	40- 45	408.2	2346	51.9,58.8
50	1277	702.2	500.2	620.6	1154	1133	679.5	1115	45- 50	393.3	2739	72.3,68.6
55	1043	558.7	365.1	491.5	902.8	937.4	516.2	910.7	50- 55	351.8	3091	81.6,77.4
60	771.4	396.5	229.9	347.3	629.7	694.7	352.8	694.7	55- 60	283.8	3374	89.1,84.5
65	507.0	236.9	159.0	200.9	372.9	433.1	256.5	462.9	60- 65	202.8	3577	94.4,89.6
70	260.4	122.1	88.19	95.56	122.7	235.6	160.1	275.6	65- 70	126.4	3704	97.8,92.8
75	61.29	60.53	17.33	46.95	22.76	120.9	63.80	161.7	70- 75	62.05	3766	99.4,94.3
80	9.814	8.632	0	6.715	4.334	22.30	0	52.24	75- 80	19.84	3786	99.9,94.8
85	2.233	0	0	0	2.140	0	0	0	80- 85	2.413	3788	100,94.9
90	0.6735	0	0	0	0.9786	0	0	0	85- 90	0.1864	3788	100,94.9
95									90- 95			
100									95-100			
105									100-105			
110									105-110			
115									110-115			
120									115-120			
125									120-125			
130									125-130			
135									130-135			
140									135-140			
145									140-145			
150									145-150			
155									150-155			
160									155-160			
165									160-165			
170									165-170			
175									170-175			
180									175-180			
DEG	LUMINOUS INTENSITY:cd									UNIT:lm		

C Range: 0 - 360DEG
 C Interval: 5.0DEG
 Test Speed: HIGH
 Temperature:29DEG
 Operators:DANU VADIM
 Test Date:2020-12-15

g Range: 0 - 90DEG
 g Interval: 0.5DEG
 Test System:EVERFINE GO-2000A_V1 SYSTEM V2.0.269
 Humidity:65.0%
 Test Distance:8.300m [K=1.0000]
 Remarks:

ISOCANDELA DIAGRAM

Test:U:221.8V I:0.1270A P:27.50W PF:0.9720 Lamp Flux:3992.12x1 lm		
	TYPE:30W	WEIGHT:1.2
DIM.:	SPEC.:6000K	SERIAL No.:
MFR.: LED MARKET SRL	SUR.:	PROTECTION ANGLE:

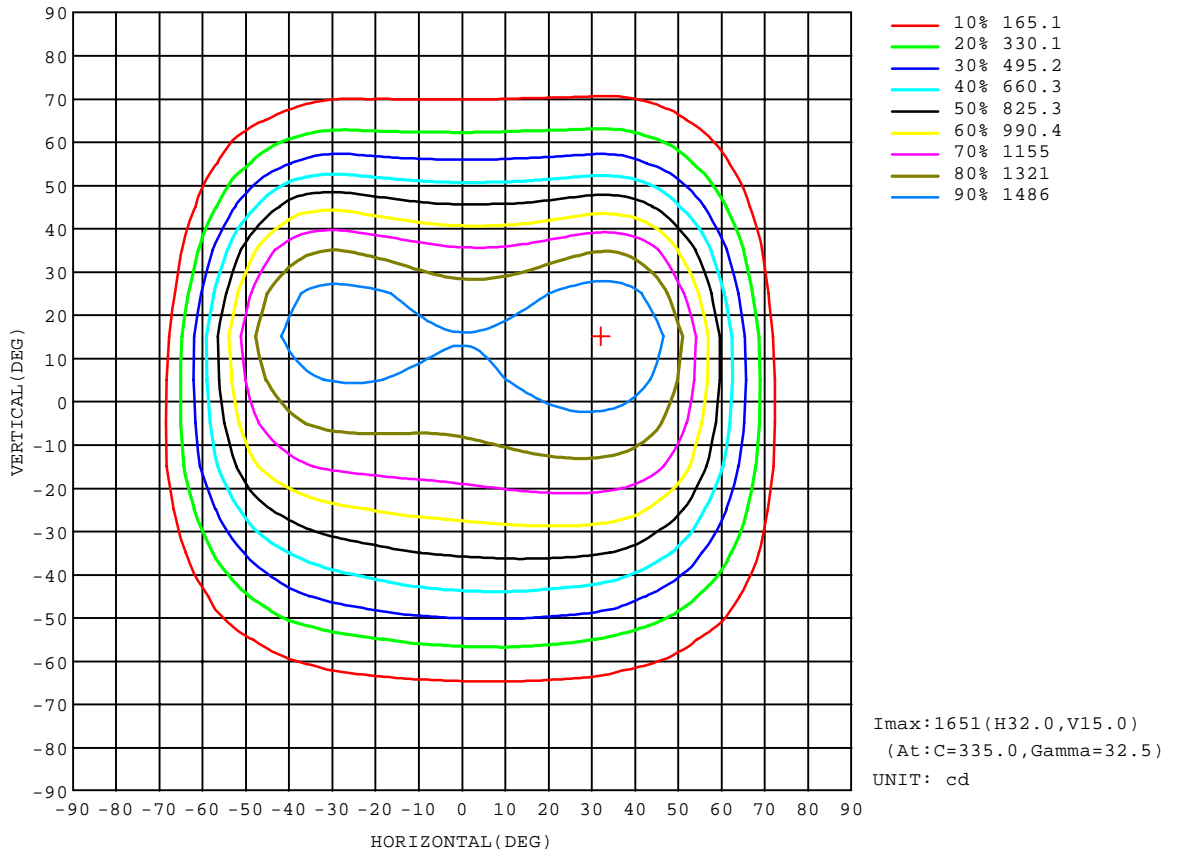

C Range: 0 - 360DEG
 C Interval: 5.0DEG
 Test Speed: HIGH
 Temperature:29DEG
 Operators:DANU VADIM
 Test Date:2020-12-15

g Range: 0 - 90DEG
 g Interval: 0.5DEG
 Test System:EVERFINE GO-2000A_V1 SYSTEM V2.0.269
 Humidity:65.0%
 Test Distance:8.300m [K=1.0000]
 Remarks:

Planar Illuminance Curve

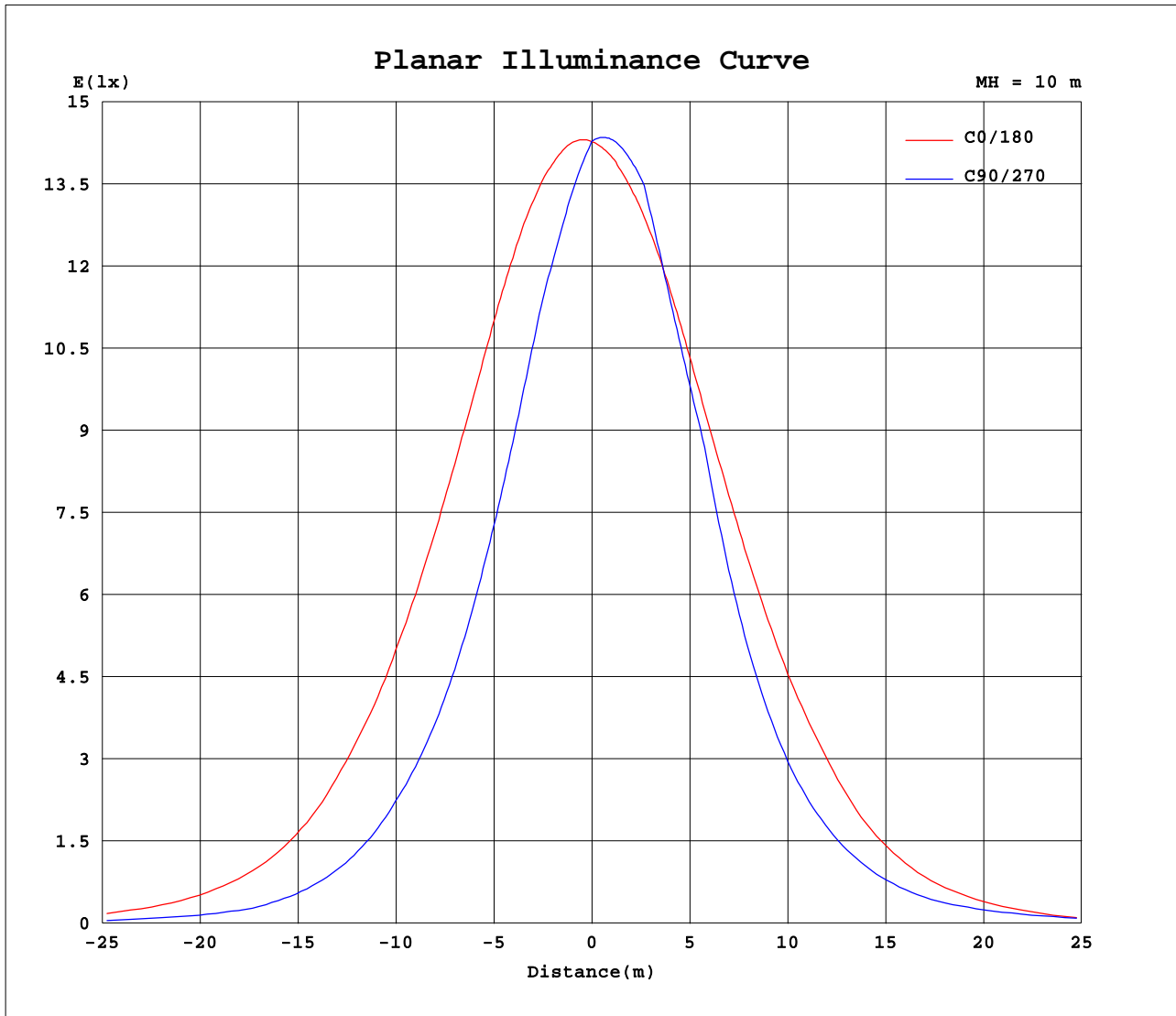

C Range: 0 - 360DEG
 C Interval: 5.0DEG
 Test Speed: HIGH
 Temperature: 29DEG
 Operators: DANU VADIM
 Test Date: 2020-12-15

g Range: 0 - 90DEG
 g Interval: 0.5DEG
 Test System: EVERFINE GO-2000A_V1 SYSTEM V2.0.269
 Humidity: 65.0%
 Test Distance: 8.300m [K=1.0000]
 Remarks:

LUMINOUS DISTRIBUTION INTENSITY DATA

Test:U:221.8V I:0.1270A P:27.50W PF:0.9720 Lamp Flux:3992.12x1 lm		
	TYPE:30W	WEIGHT:1.2
DIM.:	SPEC.:6000K	SERIAL No.:
MFR.: LED MARKET SRL	SUR.:	PROTECTION ANGLE:

Table--1

UNIT: cd

C(DEG) g (DEG)	0	5	10	15	20	25	30	35	40	45	50	55	60	65	70	75	80	85	90
0	1428	1428	1428	1428	1428	1428	1428	1428	1428	1428	1428	1428	1428	1428	1428	1428	1428	1428	1428
5	1445	1439	1433	1427	1421	1415	1409	1404	1398	1393	1388	1384	1379	1376	1372	1369	1367	1365	1363
10	1466	1454	1441	1429	1416	1404	1392	1381	1370	1359	1349	1340	1331	1324	1317	1311	1306	1302	1299
15	1492	1473	1453	1433	1413	1393	1374	1356	1339	1323	1308	1294	1282	1270	1260	1252	1245	1239	1235
20	1517	1489	1460	1432	1404	1377	1350	1326	1304	1282	1259	1234	1213	1194	1177	1164	1153	1145	1140
25	1534	1496	1458	1421	1385	1350	1317	1286	1248	1214	1182	1153	1128	1106	1087	1071	1059	1050	1045
30	1536	1489	1443	1397	1354	1313	1268	1219	1175	1134	1098	1066	1038	1014	994	977	964	955	950
35	1526	1468	1413	1360	1310	1255	1196	1141	1092	1048	1008	973	941	914	892	874	860	850	845
40	1489	1422	1360	1303	1244	1173	1109	1050	998	950	904	865	832	806	785	768	755	745	740
45	1414	1341	1277	1218	1139	1067	1003	944	885	832	787	748	717	692	675	660	648	640	635
50	1277	1201	1140	1071	990	918	864	805	751	702	661	625	593	566	545	529	515	505	500
55	1043	975	932	874	810	752	686	639	593	559	519	484	452	426	407	392	379	370	365
60	771	721	689	637	590	555	508	462	429	397	367	337	309	286	267	254	243	234	230
65	507	474	452	426	399	359	331	302	270	237	207	190	187	180	174	170	167	161	159
70	260	252	247	238	217	203	176	148	123	122	118	119	115	109	102	97.9	94.2	90.1	88.2
75	61.3	72.1	78.3	81.3	81.2	65.9	56.5	63.1	64.6	60.5	55.3	50.3	44.0	36.8	30.7	25.9	21.8	18.6	17.3
80	9.81	8.79	8.95	13.1	9.03	15.6	18.4	16.3	10.4	8.63	7.84	6.38	4.98	3.51	2.29	1.30	0.56	0.13	0.00
85	2.23	2.31	2.56	2.74	2.46	1.06	0.00	0.00	0.00	0.00	0.00	0.00	0.00	0.00	0.00	0.00	0.00	0.00	0.00
90	0.67	0.00	0.00	0.00	0.00	0.00	0.00	0.00	0.00	0.00	0.00	0.00	0.00	0.00	0.00	0.00	0.00	0.00	0.00

C Range: 0 - 360DEG
 C Interval: 5.0DEG
 Test Speed: HIGH
 Temperature:29DEG
 Operators:DANU VADIM
 Test Date:2020-12-15

g Range: 0 - 90DEG
 g Interval: 0.5DEG
 Test System:EVERFINE GO-2000A_V1 SYSTEM V2.0.269
 Humidity:65.0%
 Test Distance:8.300m [K=1.0000]
 Remarks:

LUMINOUS DISTRIBUTION INTENSITY DATA

Test:U:221.8V I:0.1270A P:27.50W PF:0.9720 Lamp Flux:3992.12x1 lm		
	TYPE:30W	WEIGHT:1.2
DIM.:	SPEC.:6000K	SERIAL No.:
MFR.: LED MARKET SRL	SUR.:	PROTECTION ANGLE:

Table--2

UNIT: cd

C(DEG) g (DEG)	95	100	105	110	115	120	125	130	135	140	145	150	155	160	165	170	175	180	185
0	1428	1428	1428	1428	1428	1428	1428	1428	1428	1428	1428	1428	1428	1428	1428	1428	1428	1428	1428
5	1363	1362	1363	1364	1365	1367	1369	1372	1376	1380	1384	1389	1394	1399	1404	1410	1415	1421	1424
10	1297	1297	1297	1299	1302	1306	1311	1318	1325	1333	1343	1353	1363	1375	1387	1399	1411	1423	1429
15	1232	1231	1231	1234	1238	1244	1252	1262	1274	1287	1302	1317	1335	1353	1372	1391	1411	1431	1442
20	1137	1137	1140	1146	1155	1168	1183	1201	1219	1236	1256	1278	1302	1327	1355	1383	1413	1442	1459
25	1042	1043	1046	1053	1064	1079	1096	1116	1141	1168	1200	1229	1260	1294	1330	1369	1408	1448	1471
30	947	948	952	960	971	985	1003	1025	1053	1086	1124	1166	1209	1250	1295	1343	1392	1442	1471
35	843	844	849	858	870	884	904	928	958	995	1037	1086	1142	1196	1248	1303	1361	1423	1459
40	738	739	743	752	762	776	796	822	855	893	938	991	1051	1118	1178	1240	1306	1378	1421
45	633	634	637	644	652	665	684	710	742	779	821	872	933	1004	1082	1145	1215	1295	1343
50	499	501	508	517	530	547	568	593	621	655	692	735	797	866	943	1008	1073	1154	1201
55	363	366	373	381	394	412	435	462	492	523	553	592	636	685	740	795	838	903	947
60	228	231	237	246	259	276	298	319	347	378	396	427	458	495	532	574	594	630	656
65	157	157	157	158	160	162	163	174	201	226	247	269	283	307	326	349	362	373	383
70	87.1	88.0	89.8	92.4	95.4	99.1	101	97.9	95.6	90.3	111	130	140	138	143	143	141	123	118
75	17.6	19.3	22.5	26.8	32.0	37.5	41.6	44.7	47.0	46.3	41.0	33.6	39.5	42.1	33.8	31.5	26.5	22.8	23.0
80	0.13	0.49	1.10	1.94	3.01	4.16	5.16	6.04	6.72	8.09	10.8	11.3	9.80	6.66	6.25	4.80	4.42	4.33	5.13
85	0.00	0.00	0.00	0.00	0.00	0.00	0.00	0.00	0.00	0.00	0.00	0.00	1.03	2.63	2.48	2.61	2.51	2.14	3.30
90	0.00	0.00	0.00	0.00	0.00	0.00	0.00	0.00	0.00	0.00	0.00	0.00	0.00	0.00	0.00	0.00	0.00	0.98	0.00

C Range: 0 - 360DEG
 C Interval: 5.0DEG
 Test Speed: HIGH
 Temperature:29DEG
 Operators:DANU VADIM
 Test Date:2020-12-15

g Range: 0 - 90DEG
 g Interval: 0.5DEG
 Test System:EVERFINE GO-2000A_V1 SYSTEM V2.0.269
 Humidity:65.0%
 Test Distance:8.300m [K=1.0000]
 Remarks:

LUMINOUS DISTRIBUTION INTENSITY DATA

Test:U:221.8V I:0.1270A P:27.50W PF:0.9720 Lamp Flux:3992.12x1 lm		
	TYPE:30W	WEIGHT:1.2
DIM.:	SPEC.:6000K	SERIAL No.:
MFR.: LED MARKET SRL	SUR.:	PROTECTION ANGLE:

Table--3

UNIT: cd

C(DEG) g (DEG)	190	195	200	205	210	215	220	225	230	235	240	245	250	255	260	265	270	275	280
0	1428	1428	1428	1428	1428	1428	1428	1428	1428	1428	1428	1428	1428	1428	1428	1428	1428	1428	1428
5	1426	1428	1431	1433	1435	1437	1439	1440	1442	1443	1444	1446	1447	1448	1449	1450	1450	1451	1451
10	1435	1441	1446	1451	1455	1458	1462	1465	1466	1468	1469	1470	1470	1470	1471	1472	1473	1473	1474
15	1453	1462	1472	1480	1486	1492	1496	1500	1502	1503	1502	1501	1499	1497	1495	1495	1495	1495	1497
20	1475	1490	1504	1517	1527	1535	1541	1546	1537	1520	1504	1488	1474	1461	1452	1446	1443	1444	1448
25	1493	1514	1534	1553	1569	1582	1563	1542	1522	1500	1478	1457	1438	1420	1406	1396	1392	1391	1395
30	1500	1529	1557	1582	1588	1569	1549	1528	1505	1481	1455	1428	1404	1381	1361	1347	1340	1338	1342
35	1497	1535	1571	1581	1566	1550	1531	1509	1486	1459	1397	1335	1281	1238	1204	1183	1174	1176	1188
40	1468	1518	1551	1542	1533	1523	1509	1469	1384	1306	1234	1171	1114	1069	1036	1017	1009	1011	1024
45	1401	1465	1468	1471	1475	1477	1395	1311	1224	1141	1065	999	943	897	866	849	843	847	860
50	1271	1320	1331	1354	1360	1286	1211	1133	1054	971	890	822	770	729	701	685	680	684	697
55	1023	1052	1091	1132	1093	1044	1004	937	858	779	703	640	593	558	535	520	516	520	534
60	709	734	778	791	776	768	741	695	632	568	505	450	410	383	367	356	353	357	370
65	403	435	460	471	488	488	471	433	388	350	330	304	285	272	265	258	256	259	267
70	131	165	195	228	247	239	227	236	236	234	219	199	185	174	167	162	160	162	169
75	26.2	34.4	52.6	65.0	77.1	105	119	121	120	115	106	93.0	84.6	75.6	69.0	65.6	63.8	65.3	69.8
80	6.36	8.63	10.0	15.3	24.8	28.0	21.3	22.3	24.9	22.8	18.4	12.9	8.40	4.56	1.96	0.48	0.00	0.48	1.98
85	4.24	4.39	4.37	2.09	0.00	0.00	0.00	0.00	0.00	0.00	0.00	0.00	0.00	0.00	0.00	0.00	0.00	0.00	0.00
90	0.00	0.00	0.00	0.00	0.00	0.00	0.00	0.00	0.00	0.00	0.00	0.00	0.00	0.00	0.00	0.00	0.00	0.00	0.00

C Range: 0 - 360DEG
 C Interval: 5.0DEG
 Test Speed: HIGH
 Temperature:29DEG
 Operators:DANU VADIM
 Test Date:2020-12-15

g Range: 0 - 90DEG
 g Interval: 0.5DEG
 Test System:EVERFINE GO-2000A_V1 SYSTEM V2.0.269
 Humidity:65.0%
 Test Distance:8.300m [K=1.0000]
 Remarks:

LUMINOUS DISTRIBUTION INTENSITY DATA

Test:U:221.8V I:0.1270A P:27.50W PF:0.9720 Lamp Flux:3992.12x1 lm		
	TYPE:30W	WEIGHT:1.2
DIM.:	SPEC.:6000K	SERIAL No.:
MFR.: LED MARKET SRL	SUR.:	PROTECTION ANGLE:

Table--4

UNIT: cd

C(DEG) g (DEG)	285	290	295	300	305	310	315	320	325	330	335	340	345	350	355				
0	1428	1428	1428	1428	1428	1428	1428	1428	1428	1428	1428	1428	1428	1428	1428				
5	1452	1453	1453	1453	1453	1453	1453	1453	1452	1452	1451	1450	1449	1448	1446				
10	1476	1477	1478	1479	1480	1481	1482	1482	1482	1481	1479	1478	1476	1473	1469				
15	1498	1501	1505	1508	1511	1514	1517	1518	1519	1518	1517	1514	1510	1505	1499				
20	1456	1468	1483	1501	1522	1546	1561	1564	1565	1564	1561	1555	1547	1538	1528				
25	1405	1420	1439	1463	1490	1520	1552	1583	1614	1610	1603	1592	1580	1565	1550				
30	1353	1371	1394	1423	1457	1493	1529	1564	1598	1630	1637	1620	1601	1580	1558				
35	1211	1246	1293	1353	1422	1463	1503	1541	1576	1607	1636	1638	1610	1582	1553				
40	1048	1083	1133	1198	1275	1361	1457	1514	1546	1573	1597	1622	1600	1560	1523				
45	881	915	966	1032	1110	1199	1298	1399	1500	1514	1525	1540	1554	1500	1453				
50	718	750	797	858	933	1022	1115	1210	1302	1391	1401	1395	1402	1367	1311				
55	555	586	628	684	753	833	911	991	1063	1129	1173	1160	1152	1144	1076				
60	391	417	452	500	563	628	695	752	799	830	862	891	855	836	790				
65	280	293	312	335	365	414	463	508	543	556	572	568	572	544	516				
70	179	191	207	228	252	273	276	277	306	322	319	309	298	280	262				
75	76.9	88.5	102	119	139	155	162	165	156	135	131	126	100.0	73.8	58.8				
80	4.63	8.89	14.7	23.0	34.1	44.7	52.2	51.6	53.5	49.9	40.4	29.4	21.8	15.7	12.2				
85	0.00	0.00	0.00	0.00	0.00	0.00	0.00	0.00	0.00	0.00	2.95	5.36	6.41	5.23	4.03				
90	0.00	0.00	0.00	0.00	0.00	0.00	0.00	0.00	0.00	0.00	0.00	0.00	0.00	0.00	0.00				

C Range: 0 - 360DEG
 C Interval: 5.0DEG
 Test Speed: HIGH
 Temperature:29DEG
 Operators:DANU VADIM
 Test Date:2020-12-15

g Range: 0 - 90DEG
 g Interval: 0.5DEG
 Test System:EVERFINE GO-2000A_V1 SYSTEM V2.0.269
 Humidity:65.0%
 Test Distance:8.300m [K=1.0000]
 Remarks:

QuayAudit

REGISTRATION CERTIFICATE

This certificate confirms that the management systems of

"LED MARKET" SRL

MD-2029, șos. Muncești, nr. 801, mun. Chișinău, Republica Moldova

have been audited and approved by
Quay Audit UK Ltd to the following management standard:

BS EN ISO 45001:2018

The approved management systems apply to the following scope:

Production and Marketing of LED Lighting Products

This certificate is restricted to those scopes of business activity described
in the internationally recognised NACE Codes listed below:

2740 & 4759

Original Approval **12 July 2019**

Current Certificate **12 July 2019**

Certificate Expiry **12 July 2022**

Registration Number **4156714**



On behalf of **Quay Audit UK Limited**



www.ascb.com



www.global-accreditation.org



www.irqao.com

This is an accredited certificate authorised for issue by Accreditation Service for Certifying Bodies (Europe) Limited who have assessed Quay Audit UK Limited against defined criteria and in cognisance of ISO 17021:2011 'Conformity Assessment - Requirements for bodies providing audit and certification of management systems'. This certificate is only valid when confirmed by the register listed in the International Register of Quality Assessed Organisations: www.irqao.com

Grove House 8 St Julian's Friars Shrewsbury Shropshire SY1 1XL | (44)1743 351677 | post@quayaudit.co.uk | www.quayaudit.co.uk

QuayAudit

CERTIFICAT DE INREGISTRARE

Acest certificat confirma faptul că sistemul de management al

"LED MARKET" SRL

MD-2029, șos. Muncești, nr. 801, mun. Chișinău, Republica Moldova

a fost auditat și aprobat de către
Quay Audit UK Ltd pentru următorul standard de management :

BS EN ISO 45001:2018

Sistemul de management aprobat se aplică pentru următoarele domenii de activitate:

Producerea și comercializarea produselor de iluminat de tip LED

Acest certificat se aplica pentru acele domenii de activitate descrise
în Codurile NACE(GAEN) enumerate mai jos, recunoscute internațional:

2740 & 4759

Aprobat initial la **12 Iulie 2019**
Certificare initiala la **12 Iulie 2019**
Certificatul expira la **12 Iulie 2022**
Numarul certificatului **4156714**



În numele **Quay Audit UK Limited**



www.ascb.com



www.global-accreditation.org



www.irqao.com

Acesta este un certificat acreditat și autorizat pentru emitere de către Accreditation Service for Certifying Bodies (Europe) Limited, evaluat de către Quay Audit UK Limited în conformitate cu ISO 17021:2006 "Evaluarea conformității. Cerințe pentru organisme care efectuează audit și certificare de sisteme de management". Acest certificat este valabil numai atunci când este înscris în registrul International Register of Quality Assessed Organisations: www.irqao.com

Grove House 8 St. Julian's Friars Shrewsbury Shropshire SY1 1XL | (44)1743 351677 | post@quayaudit.co.uk | www.quayaudit.co.uk

QuayAudit

CERTIFICAT DE INREGISTRARE

Acest certificat confirma faptul că sistemul de management al

"LED MARKET" SRL

MD-2029, șos. Muncești, nr. 801, mun. Chișinău,
Republica Moldova

a fost auditat și aprobat de către
Quay Audit UK Ltd pentru următorul standard de management :

BS EN ISO 14001:2015

Sistemul de management aprobat se aplică pentru următoarele domenii de activitate:

Producerea și comercializarea produselor de iluminat de tip LED

Acest certificat se aplica pentru acele domenii de activitate descrise
în Codurile NACE(CAEN) enumerate mai jos, recunoscute internațional:

2740 & 4759

Aprobat initial la **25 Aprilie 2019**
Certificare initiala la **25 Aprilie 2019**
Certificatul expira la **25 Aprilie 2022**
Numarul certificatului **4156667**



În numele **Quay Audit UK Limited**



www.ascb.com



www.global-accreditation.org



www.irqao.com

Acesta este un certificate acreditat și autorizat pentru emitere de către Accreditation Service for Certifying Bodies (Europe) Limited, evaluat de către Quay Audit UK Limited în conformitate cu ISO 17021:2006 "Evaluarea conformității. Cerințe pentru organisme care efectuează audit și certificare de sisteme de management". Acest certificat este valabil numai atunci când este înscris în registrul International Register of Quality Assessed Organisations: www.irqao.com

Grove House 8 St. Julian's Friars Shrewsbury Shropshire SY1 1XL | (44)1743 351677 | post@quayaudit.co.uk | www.quayaudit.co.uk

CERTIFICAT DE INREGISTRARE

Acest certificat confirma faptul că sistemul de management al

"LED MARKET" SRL

MD-2029, șos. Muncești, nr. 801, mun. Chișinău,
Republica Moldova

a fost auditat și aprobat de către
Quay Audit UK Ltd pentru următorul standard de management :

BS EN ISO 9001:2015

Sistemul de management aprobat se aplică pentru următoarele domenii de activitate:

Producerea și comercializarea produselor de iluminat de tip LED

Acest certificat se aplica pentru acele domenii de activitate descrise
în Codurile NACE(CAEN) enumerate mai jos, recunoscute internațional:

2740 & 4759

Aprobat initial la **25 Aprilie 2019**
Certificare initiala la **25 Aprilie 2019**
Certificatul expira la **25 Aprilie 2022**
Numarul certificatului **4156666**



În numele **Quay Audit UK Limited**



www.ascb.com



www.global-accreditation.org



www.irqao.com

Acesta este un certificate acreditat și autorizat pentru emitere de către Accreditation Service for Certifying Bodies (Europe) Limited, evaluat de către Quay Audit UK Limited în conformitate cu ISO 17021:2006 "Evaluarea conformității - Cerințe pentru organisme care efectuează audit și certificare de sisteme de management". Acest certificat este valabil numai atunci când este înscris în registrul International Register of Quality Assessed Organisations. www.irqao.com

Grove House 8 St. Julian's Friars Shrewsbury Shropshire SY1 1XL | (44)1743 351677 | post@quayaudit.co.uk | www.quayaudit.co.uk

CERTIFICAT DE CONFORMITATE

Nr. de înregistrare **OCP_{GSP} MD 015 13C 47954-21**

Data emiterii 03 februarie 2021 Valabil pînă la 03 februarie 2022

ORGANISMUL DE CERTIFICARE A PRODUSELOR CU GRAD SPORIT DE PERICOL
din cadrul SRL "Centrul Tehnic pentru Securitate Industrială și Certificare",
MD-2004, mun. Chișinău, str. S.Lazo, 48; sediul central: mun. Chișinău, str. Melestiu 22/A,
tel.: 022208186, 022208156

PRIN PREZENTUL DOCUMENT SE CONFIRMĂ FAPTUL, CĂ PRODUSELE IDENTIFICATE ASTFEL:

DENUMIREA / DESCRIEREA

Cabluri și conductoare electrice în sortiment,
marca comercială "ЮЖКАБЕЛЬ";
tipul produselor, articolele, conform anexei - (3 poziții);
livrarea conform contractului nr.12/247 din 01.07.2013;
păstrarea: depozitul firmei (RM, mun.Chișinău, str.Petricani, 21)

Codul NC MD
8544

SUNT CONFORME CU CERINȚELE OBLIGATORII STABILITE ÎN

SM IEC 60227-4+A1:2016 (cap. 2.1, 2.2, 2.3, pct.2.3.1, 2.3.2, 2.3.5, cap.2.4),
GOST 839-80 (cap.1, pct.1.1, 1.2, cap.2, pct.2.2, 2.8, cap.5, pct.5.2, 5.3)

PRODUCĂTOR

ПАО "ЗАВОД ЮЖКАБЕЛЬ", or. Harikov, Ucraina

Codul țării
UA

CLIENT

CEGOLTAR SRL,
RM, mun.Chișinău, str.Nuferilor, 25, tel. (022) 273-582

Codul IDNO
1003600017268

CERTIFICATUL ESTE ELIBERAT ÎN BAZA

Raportului de identificare a produselor nr.10/0029 din 26.01.2021.
Rapoartelor de încercări nr.524/02/21, 525/02/21 din 28.01.2021,
eliberate de LÎ "INSPECT TEST", certificat de acreditare nr.LÎ-129.
Raportului de evaluare nr.10b/026-ev din 02.02.2021.

INFORMAȚIE SUPLIMENTARĂ

Schema de tip 2.
Este stabilită 1 supraveghere cu identificarea de către OC PGSP a fiecărui lot de produse importate.
Produsele date se comercializează numai în prezența informației în limba de stat.
Certificatul este valabil numai în prezența anexei la certificatul dat.

Seria C nr. **005039**



Conducătorul
organismului de certificare  Nicolai Manolov

**În atenția antreprenorilor și organelor de control!
Copiile certificatului de conformitate se legalizează în modul stabilit de
Organismul de Certificare a Produselor cu Grad Sporit de Pericol**

CENTRUL TEHNIC PENTRU SECURITATE
INDUSTRIALĂ ȘI CERTIFICARE SRL

Anexă

Fila 1 File 1 la certificatul de conformitate

Nr. OCP_{GSP} MD 015 13C 47954-21 din 03.02.2021

Lista produselor concrete
asupra cărora se extinde acțiunea certificatului de conformitate

Nr.	Tipul produselor	Articole
1	Cabluri electrice	АВВГ
		АПвБ6Шв
		АПвБ6Шп
		АПвПг
		ВВГнг
		ВВГ-п
		ВВГнг -LS
		ВВГнг FR-LS
		N2XH-J
		NYM-J
		NA2XS(F)2Y
		NA2XS(FL)2Y
		АПвЭрПг
		АПвЭрП
		ААБл
		ААШв
2	Conductoare electrice	КВВГ
		КВВГнг
		АС
		СИП-2
		СИП-5
		СИП-3
		АПВ
		АПВВ
		ПВС
		ШВВП
		ВПП
		ПВ 1
		ПВ 3
ПСДКТ-Л		
ПЭЭИДХ2		
3	Conductoare electrice cu fibre optice	ОАрП
		ОЦТе
		ОПТ
		ОЦБгП
		ОбгПо

Seria C nr. 002457



Conducatorul
Organismului de certificare

Nicolai Manolov

Anexa nu este valabilă în lipsa certificatului de conformitate



СИП-5 2x25 ТУ У 31.3-00214534-014-2002

Провода самонесущие с изоляцией из светостабилизированного сшитого полиэтилена

Применяются для прокладки:

- воздушных линий электропередачи (ВЛ) на напряжение до 0,6/1 кВ
- ответвлений к вводам в жилые дома и хозяйственные пристройки

ТЕХНИЧЕСКИЕ ХАРАКТЕРИСТИКИ:

Номинальное напряжение	кВ	0.6 / 1
Число и номинальное сечение фазных токопроводящих жил	мм ²	2 x 25
Толщина фазной изоляции	мм	1.3
Допустимые токовые нагрузки *		
• длительно	А	130
• при коротком замыкании (не более 1 с)	кА	2.3
Максимально допустимая температура жилы		
• длительно	°С	+90
• при коротком замыкании (не более 5 с)	°С	+250
Диапазон рабочих температур	°С	-60 ... +50
Допустимая температура прокладки (монтажа), не менее	°С	-20
Минимальный радиус изгиба при прокладке	мм	169
Расчетный наружный диаметр (справочно) **	мм	16.9
Масса (ориентировочно)	кг/км	200
Расчетная строительная длина и масса брутто при поставке на барабанах	м, т	No 16а: 3500 • 1.0 No 18: 4000 • 1.3 No 20: 6400 • 1.9

Примечания:

При заказе строительную длину изделия необходимо согласовывать с изготовителем

* Длительно допустимые токовые нагрузки рассчитаны для следующих условий: температура окружающей среды плюс 25 °С, скорость ветра 0.6 м/с, интенсивность солнечного излучения 1000 Вт/м²

** Наружный диаметр может превышать расчетный на величину до 10 %



СИП-5 2x25 ТУ У 31.3-00214534-014-2002

Провода самонесущие с изоляцией из светостабилизированного сшитого полиэтилена

КОНСТРУКЦИЯ:

1. Алюминиевая многопроволочная уплотненная токопроводящая жила

2. Изоляция из светостабилизированного сшитого полиэтилена

Примечание: общая скрутка проводов на рисунке не показана

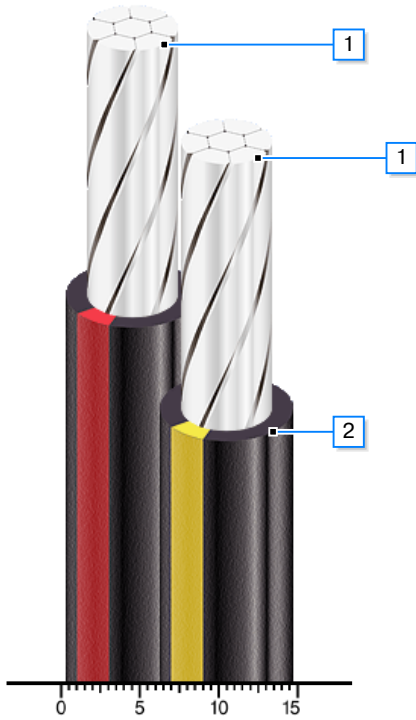

Denumire caracteristici tehnici fata de corpul de iluminat	Caracteristici tehnici impusi	Caracteristici tehnice propuse
Denumire producator		
Puterea nominal acorpului de iluminat cu LED solicitata	Pînă la 30W (+/- 10 %)	30W
Tip corp de iluminat	LED SMD, stradal	LED SMD, stradal
Densitatea consumului de energie kWh/m ² an	0,5	0,5
Tensiunea nominala	220-240V	220-240V
Frecventa	50-60Hz	50-60Hz
Flux luminous lampa	Minim 3300 Lm	3750 Lm
Efeciencia luminoasa a corpului de iluminat	Minim 110 Lm/W	125 Lm/W
Temperatura de culoare K	4000k - 6000k	2700k - 6000k
Indeele de redare a culorii CRI	> 70	> 70
Randamentul corpului de iluminat	≥ 75%	≥ 75%
Capac optic	Sticla plata/material transparent rezistent la razele UV	Policarbonat transparent rezistent la razele UV
Unghiul de dispersare pe longitudinal	130- 150 grade	130- 150 grade
Unghiul de dispersare pe transversal	75- 90 grade	75- 90 grade
Gradul de protectie a componentii optice	Min IP 65	IP 65
Gradul de protectie a corpului de iluminat	Min IP 65	IP 65
Material carcasa	Aluminiu turnat	Aluminiu turnat
Rezistenta la socuri mecanice a difuzorului (protective la vandalism)	Min IK 08	IK09
Rezistenta la socuri mecanice a corpului de iluminat	Min IK 08	IK09
Factorul de putere	≥ 0,9	≥ 0,9
Protectie impotriva electrocutarii	Clasa I sau II	Clasa I
Protectie la descarcari atmosferice	Minim 4 kV	4 kV
Functionare la temperaturi intre	-20 si +40 grade Celsius	-30 si +40 grade Celsius
Tip conectare borne	Cablu 3 poli	Cablu 3 poli
Greutatea aparatului	Max.3,5 kg	1,8 kg
Durata de viata cu asigurarea a minim 70% din fluxul luminos initial	Minim 50 000h	100 000 h
Garantie producator	Minim 5 ani	5 ani