

Nod I

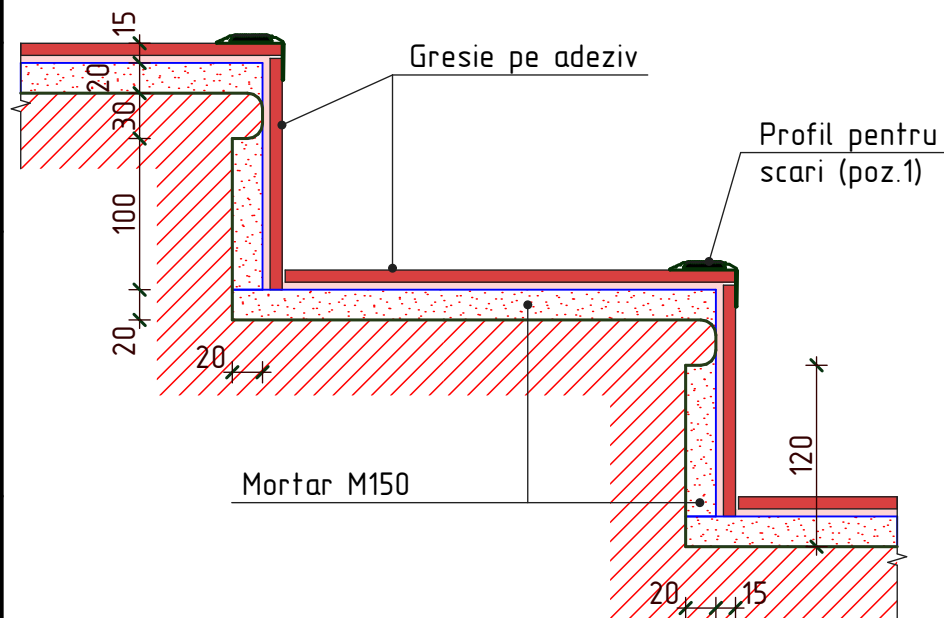

Executarea plintei  
din gresie

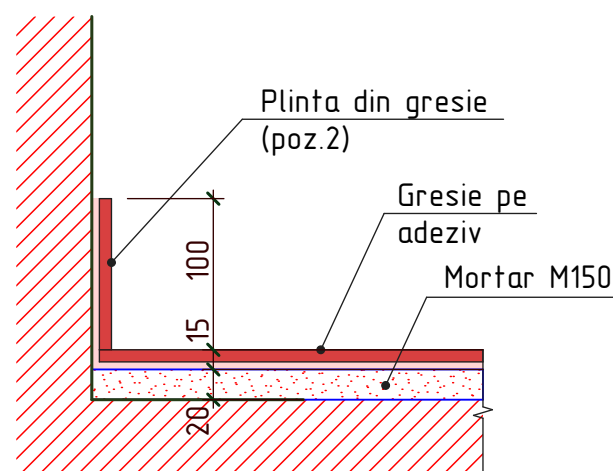

Specificatia podelelor

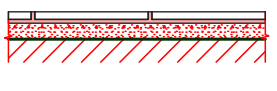
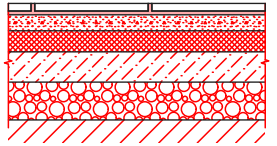
POZITIA PE PLAN	SECTIUNEA PODELEI SAU NUMARUL NODULUI DUPA SERIE	ELEMENTELE PODELEI SI GROSIMEA LOR	SUP. PODELEI, m <sup>2</sup>
1		1. Gresie pe adeziv -15 2. Strat de nivelare din mortar M150 -20 3. Betonogrunt 4. Podele existente din beton mozaic h = 35mm	127,0
2		1. Gresie pe adeziv -15 2. Strat de nivelare din mortar M150 -20 3. Polistirolbeton M200 -50 4. Strad din beton C20 -80 5. Pietris M300 compactat insol -100 h=265mm	100,8