

Nr.inve.a.orig. Data si semnatura Nr.inve.schim.

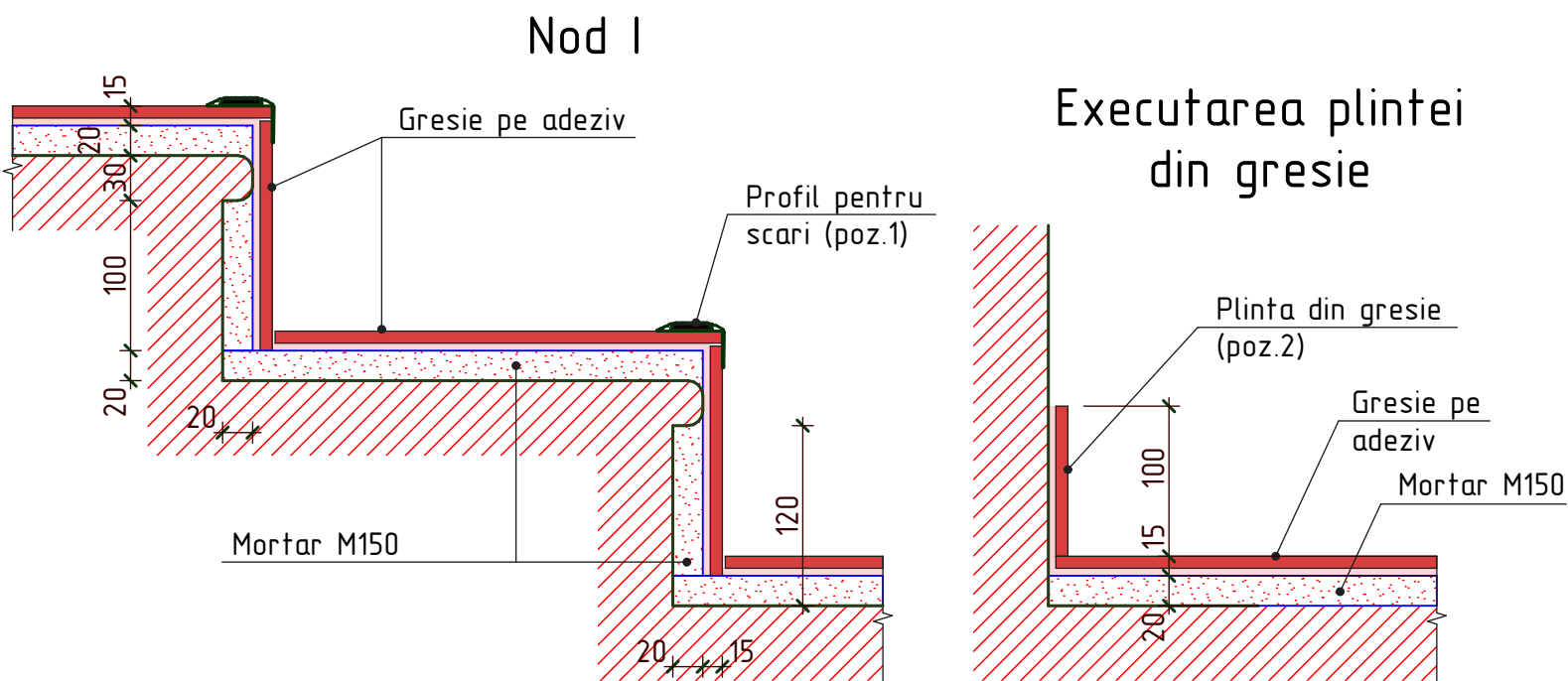

Sina ovala (poz. 2)

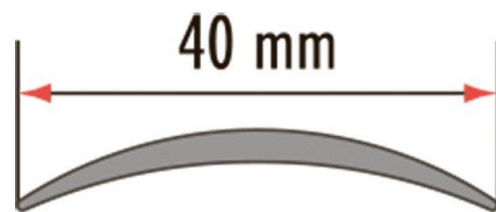

Profil pentru scari (poz. 1)

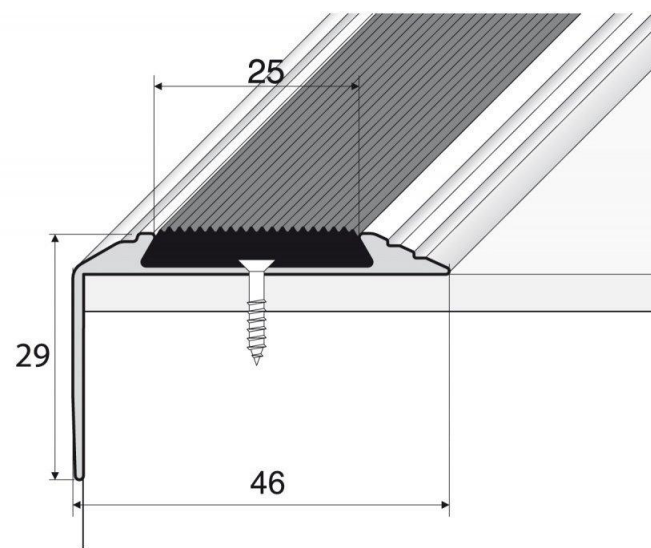

## Specificatia podelelor

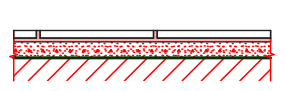
| POZITIA PE PLAN | SECTIUNEA PODELEI SAU NUMARUL NODULUI DUPA SERIE                                    | ELEMENTELE PODELEI SI GROSIMEA LOR   | SUP. PODELEI, m <sup>2</sup> |
|-----------------|---|--|------------------------------|
| Coridor         |  | 1. Gresie pe adeziv -15<br>2. Strat de nivelare din mortar M150 -20<br>3. Betonogrunť<br>4. Podele din beton | 50,7                         |

## Specificatia materialelor de finisare

| Nr.    | DENUMIREA                                       | UNITATE DE MASURA | CANTITATEA                 |
|--------|---|-------------------|----------------------------|
| Podele |   |                   |                            |
| 1      | Profil pentru scari cu cauciuc argintiu 46x29mm | m                 | 28,2                       |
| 2      | Sina ovala lata de protectie argintiu 30mm      | m                 | 7,0                        |
| 3      | Plinta din gresie pe adeziv h=100mm             | m                 | 42,6 (4,26m <sup>2</sup> ) |
| Rampa  |   |                   |                            |
| 4      | Beton C20                                       | m <sup>3</sup>    | 4,4                        |
| 5      | Plasa Ø6 A-I pas150x150mm (2 rinduri)           | kg                | 131,2                      |
| 6      | Piatra sparta M400 (10-20)                      | m <sup>3</sup>    | 3,0                        |
| 7      | Balustrada din inox h=900 l=3000mm              | buc.              | 1                          |
| 8      | Balustrada din inox h=900 l=6000mm              | buc.              | 1                          |

### Nota:

1. Plansa data se citeste cu pl. 6, 7.

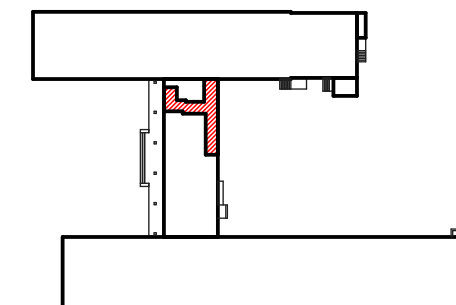

|          |            |       |       |         |      |  |      |                                  |        |
|----------|------------|-------|-------|---------|------|--|------|----------------------------------|--------|
|          |            |       |       |         |      | OBIECTIV NR. - 14.05-D/21-1-SAC  |      |                                  |        |
|          |            |       |       |         |      | Amenajarea teritoriului si reparatia capitala a incaperilor separate Liceul Teoretic "L.Blaga" din str. Alexandr Puskin nr. 69, mun. Balti |      |                                  |        |
| Mod.     | Can.       | Foaia | Nr.d. | Semnata | Data | Reparatie capitala   | faza | planşa                           | planse |
| ASP      | Mihaila V. |       |       | 05.21   |      |  | PE   | 8                                |        |
| ISP      | Hihlat E.  |       |       | 05.21   |      |  |      |                                  |        |
| Elaborat | Ciobanu V. |       |       | 05.21   |      | Nod I, Executarea plintei din gresie; Specificatia podelelor; Specificatia materialelor de finisare  |      | SRL "Geo-Cad-Proiect" mun. Balti |        |