

# Installation and Maintenance Instructions

## Inset light 8"

## Preface

- Please read carefully and understand the contents of this manual.
- Failure to read the manual may result in serious injury, or serious damage to equipment.
- Make sure these instructions are always accessible for all users and ensure that you have read and understood the contents.

## Document Information

Name : **05\_LED\_AGL\_Installation\_instruction\_8-inch\_inset\_lights\_03-71083**

Version	Date	Description
V2.3	27-11-2023	Original
V2.4	09-07-2024	Added instructions to perform leakage test after opening and closing fixture
V2.5	20-05-2025	Updated leakage test instructions
V2.6	26-02-2026	Added FAA models, spare parts list, VA ratings, wiring diagrams and IP test conditions

The English version of this document is the original version; this language version is verified by the manufacturer. All other language versions are translations of the original English language version. For the latest version of this document see <https://www.tkh-airportsolutions.com/airfield-products/> or scan:



## Copyright © TKH Airport Solutions 2026

All rights reserved for TKH Airport Solutions. No part of this publication may be reproduced, modified, stored in a retrieval system, or transmitted, by any means or in any form without the written permission of the copyright owner.

The content of this document is property of TKH Airport Solutions. Proprietary rights of TKH Airport Solutions B.V. or USE System Engineering Holding B.V. or their affiliated companies include the following: The specified (product) information herein and all related data and information are proprietary and confidential to TKH Airport Solutions B.V. or USE System Engineering Holding B.V. and are the subject of trade secrets and copy licensed from TKH Airport Solutions B.V. or USE System Engineering Holding B.V. The related data and information are provided in confidence, and all use, disclosure, copying, transfer and storage, except as authorized in the written License Agreement from TKH Airport Solutions B.V or USE System Engineering Holding B.V. to the user, is strictly prohibited.

# Contents

1. About this manual .....	4
1.1 Symbols used .....	4
1.2 Storing the manual .....	5
1.3 Limitations of the Document .....	5
1.4 Terms and Abbreviations.....	6
1.5 Liability and Warranty .....	6
1.6 Manufacturer Details .....	6
2. Safety .....	7
2.1 Safety.....	7
2.2 Qualified Personnel .....	7
2.3 Intended use .....	8
2.4 Installation.....	8
2.5 Operation .....	9
2.6 Action in the event of a system or component malfunction.....	9
3. General Recommendations .....	10
3.1 Receiving, Storage and Unpacking .....	10
3.2 Electrical Connection .....	10
3.3 Base Earthing .....	10
4. About the Inset light 8" .....	11
4.1 Inset light 8" description.....	11
4.2 General specifications .....	12
4.3 Operation Information .....	13
4.4 Accessories .....	14
4.5 Dimensions .....	14
4.6 Wiring Diagrams .....	16
5. Maintenance Recommendations .....	18
5.1 Warranty Limitation.....	18
5.2 Maintenance in the Field .....	18
5.3 Preventive Maintenance .....	18
6. Installation and maintenance instructions.....	19
6.1 Tools Required .....	19
6.2 Installation.....	20
6.3 Replacing the O-ring of the inset light 8" .....	21
6.4 Replacing the prism.....	23
6.5 Replacing the housing group.....	26
6.6 Replacing the external cable .....	29
6.7 Replacing the module holder group .....	33
6.8 Leakage test .....	36
7. Spare Parts list for Inset Lights 8" .....	37

# 1. About this manual

This manual contains information about the installation and maintenance of the LED Inset light 8”.

## 1.1 Symbols used

The following marking conventions are used in this manual to draw attention to specific topics or actions:



**DANGER!** - This sign indicates a hazardous situation that, if not avoided, will result in death or serious injury.



**WARNING** - This sign indicates a hazardous situation that, if not avoided, could result in death or serious injury.











**CAUTION** - This sign indicates a hazardous situation that, if not avoided, could result in minor or moderate injury.



**NOTICE** - is used in this manual to indicate a situation that could result in damage to property or equipment.

The following symbols are used in pictures for explanation or an action:

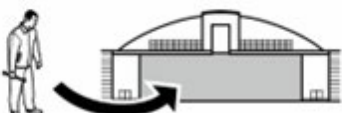
<p>Correct / Incorrect</p> 	<p>Look / See</p> 	<p>Location / position</p> 	<p>Movement</p> 
<p>Connect / Disconnect</p> 	<p>Photobiological safety</p> 	<p>ESD warning</p> 	
<p>Work carried out on runway</p> 		<p>Work carried out in workshop</p> 	

The following symbols are used on equipment and in this manual to warn of potential hazards:



**DANGER of electrical shock or arc flash.** Failure to observe this warning will result in serious injury or death.



**WARNING or CAUTION:** where this symbol is used on the equipment, it is mandatory to consult the manual to find out the nature of potential hazards and any actions which have to be taken to avoid them.

---

## 1.2 Storing the manual

---

- This manual is a part of your product. Store the manual in a location that can be easily accessed by personnel working on the product.
- It is the responsibility of the company operating this equipment to ensure that its personnel is provided with a copy of this manual.

---

## 1.3 Limitations of the Document

---

TKH Airport Solutions reserves the right to revise this document without notification.

The data provided in this document is based on the most recent information at the time of publication. TKH Airport Solutions is continually seeking to ensure that its products are developed to the latest technological standards. As a result, it is possible that there may be some differences between the product and the information in this manual.

For further information regarding adjustment, maintenance or repair which is not described in this document, please contact the Customer Service department of TKH Airport Solutions.

The information in this document concentrates solely on use of the products as intended by the manufacturer.

---

## 1.4 Terms and Abbreviations

---

This document may include the terms and abbreviations as listed below.

AGL	Airfield Ground Lighting
EASA	European Aviation Safety Agency
FAA	Federal Aviation Administration
ICAO	International Civil Aviation Organization
IEC	International Electrotechnical Committee
LED	Light Emitting Diode

---

## 1.5 Liability and Warranty

---

TKH Airport Solutions cannot be held responsible for injuries or damage resulting from non-standard, unintended use, faulty or improper installation of its equipment, or failure to follow the instructions and safety guidelines in this manual. The safety of any system incorporating the LED Inset light 8" is the responsibility of any site installation, commissioning, maintenance, and operational personnel using the system.

### NOTICE

Disregarding the safety instructions in this manual will result in the loss of warranty in case of damage.

Refer to the general TKH Airport Solutions Terms and Conditions document supplied with your sales order contract for a complete liability and warranty description.

---

## 1.6 Manufacturer Details

---

### TKH Airport Solutions

Elektrostraat 17  
7483 PG Haaksbergen  
The Netherlands

- Tel.: +31 (0)53 5741456
- Email: [info@tkh-airportsolutions.com](mailto:info@tkh-airportsolutions.com)
- Internet: [www.tkh-airportsolutions.com](http://www.tkh-airportsolutions.com)

For service requests, please contact the TKH Airport Solutions Customer Service department:

- Email: [service@tkh-airportsolutions.com](mailto:service@tkh-airportsolutions.com)

---

## 2. Safety

---

### 2.1 Safety

---



This section contains general safety instructions for using your TKH Airport Solutions equipment. Some safety instructions may not apply to the equipment in this manual. Note all warnings and follow all instructions carefully. Failure to do so may result in personal injury, death, or property damage.

To use this equipment safely,

- Refer to the International Standard IEC 61820, Electrical installation for lighting and beaconing of aerodromes - Constant current series circuits for aeronautical ground lighting - System design and installation requirements, and to the International Standard IEC 61821, Electrical installations for lighting and beaconing of aerodromes - Maintenance of aeronautical ground lighting constant current series circuits for instructions on safety precautions.
- Observe all safety regulations. To avoid injuries, always remove power prior to making any wire connections and touching any live part. Refer to the International Standards IEC 61820 & IEC 61821.
- Read and become familiar with the general safety instructions provided in this section of the manual before installing, operating, maintaining, or repairing this equipment.
- Read and carefully follow the instructions given throughout this manual for performing specific tasks and working with specific equipment.
- Store this manual within easy reach of personnel installing, operating, maintaining, or repairing this equipment.
- Follow all applicable safety procedures required by your company, industry standards, and government or other regulatory agencies.

---

### 2.2 Qualified Personnel

---

The term "qualified personnel" is defined here as a person who thoroughly understands the equipment and its safe installation, operation, maintenance, and repair. Qualified personnel are physically capable of performing the required tasks, familiar with all relevant safety rules and regulations, and have been trained to safely install, operate, maintain, and repair the equipment. It is the responsibility of the company installing, operating or maintaining this equipment to ensure that its personnel meet these requirements.

## 2.3 Intended use



Use of this equipment in ways other than described in the datasheet and this manual may result in personal injury, death, or property damage. TKH Airport Solutions cannot be held responsible for injuries or damage resulting from non-standard, unintended application of its equipment. This equipment is designed and intended only for the purpose described in this manual. Uses not described in this manual are considered to be unintended use. Unintended use may result from taking the following actions:

- making changes to equipment that have not been recommended or described in this manual or using parts that are not genuine TKH Airport Solutions replacement parts or accessories
- using materials or auxiliary equipment that are inappropriate or incompatible with your TKH Airport Solutions equipment
- allowing unqualified personnel to perform any task

## 2.4 Installation



A thorough understanding of system components and their requirements will help you install the system safely and efficiently. Failure to follow these safety procedures can result in personal injury or death.



Read the safety and installation sections of all system component manuals before installing your equipment.

- Allow only qualified personnel to install TKH Airport Solutions equipment and auxiliary equipment. Use only approved equipment. Using unapproved equipment in an approved system may void agency approvals and will void the warranty.
- Make sure all equipment is rated and approved for the environment in which you are using it.
- Follow all instructions for installing components and accessories.
- Do not hold or carry the light assemblies by the cables.
- Install all electrical connections according to local codes and regulations, provided they are not in contradiction with the general rules.
- Use only electrical wire of sufficient gauge and insulation to handle the rated current and voltage demand. All wiring must meet local codes.
- Route electrical wiring along a protected path. Make sure the wires will not be damaged by moving equipment and animals (e.g. rodents).
- Protect components from damage, wear, and harsh environmental conditions.
- Allow sufficient room for maintenance, panel accessibility (power products), and cover removal (power products).
- Protect equipment with safety devices as specified by applicable safety regulations.
- If safety devices must be removed for maintenance, re-install them immediately after the work is completed and check them for proper functioning.

## 2.5 Operation



Only qualified personnel (see section Qualified Personnel) should operate this equipment. Read all system component manuals before operating this equipment. A thorough understanding of system components and their operation will help you operate the system safely and efficiently.

- Before starting this equipment, check all safety interlocks, fire-detection systems, and protective devices such as panels and covers. Make sure all devices are fully functional. Do not operate the system if these devices are not working properly. Do not deactivate or bypass automatic safety interlocks or locked-out electrical disconnects or pneumatic valves.
- Never operate equipment with a known malfunction.
- Do not attempt to operate or service electrical equipment if standing water is present.
- Use this equipment only in the environments for which it is rated. Do not operate this equipment in humid, flammable, or explosive environments unless it has been rated for safe operation in these environments.
- Never touch exposed electrical connections on equipment while the power is ON.
- Never look directly in the light source while the power is ON.
- For fixtures/spare parts marked with the photobiological safety symbol avoid prolonged staring in the switched ON fixture.

## 2.6 Action in the event of a system or component malfunction



Do not operate a system that contains malfunctioning components. If a component malfunctions, turn the system OFF immediately.

- Disconnect and lock out electrical power.
- Allow only qualified personnel to make repairs. Repair or replace the malfunctioning component according to instructions provided in its manual. Allow only qualified personnel to perform maintenance, troubleshooting, and repair tasks. Only persons who are properly trained and familiar with TKH Airport Solutions equipment are permitted to service this equipment.
- Follow the recommended maintenance procedures in your equipment manuals.
- Connect all disconnected equipment ground cables and wires after servicing equipment. Ground all conductive equipment.
- Use only approved TKH Airport Solutions replacement parts. Using unapproved parts or making unapproved modifications to equipment may void agency approvals, impair specified performance and create safety hazards.
- Check interlock systems periodically to ensure their effectiveness.
- Do not attempt to service electrical equipment if standing water is present. Use caution when servicing electrical equipment in a high-humidity environment.
- Use tools with insulated handles when working with electrical equipment.
- Make sure to perform a leakage test, as explained in chapter 6.9, everytime a fixture is opened and closed

---

## 3. General Recommendations

---

---

### 3.1 Receiving, Storage and Unpacking

---

- 1 Upon receipt of goods at the site store, check all packaging for visible damage. Every damaged box should be opened and its contents inspected for damage. If equipment is damaged, a claim form shall be filled with the carrier immediately. It may then be necessary for the carrier to inspect the equipment.
- 2 Store the light assembly preferably in its original packaging in a protected area. When stored unpacked, please take care not to damage the cable insulation.
- 3 Unpack the light assembly at the installation site to avoid damage during transportation and handling.

---

### 3.2 Electrical Connection

---

The light assemblies covered by this manual are designed for connection to 6.6-A series circuits via one or two L-830 or L-831 series transformers. The current to the light should not exceed 6.6 A + 5%. The series transformers are to be ordered separately.

---

### 3.3 Base Earthing

---

Whatever the chosen installation method, it is strongly recommended to earth the base, especially in locations presenting a risk of lightning strikes. Failure to earth the base correctly will void the warranty for all damages occurring as a result of voltage surges.

## 4. About the Inset light 8”

TKH Airport Solutions Inset lights 8” are constructed mainly by using standard components from TKH Airport Solutions standard program of inset lights. There are many variants available for runway and taxiway use.

### 4.1 Inset light 8” description

TKH Airport Solutions inset lights are efficient and high-performing LED lights, providing at least 50,000 hours of service life at full 6.6A operation. The LED light fixtures have a simplified modular construction, consisting of four main components:

- Aluminum forging cover plate, with mechanical load capabilities exceeding FAA requirements
- Interchangeable LED light module
- Borosilicate glass prism with optional sapphire glass
- Electronic housing group, including driver board and secondary cable in accordance with FAA or ICAO requirements

		Component
1.	<b>Cover</b>	Cover (drop forged AL, anodised)
2.	<b>LED Module</b>	High power LED module 1
3.		High power LED module 2
4.	<b>Prism</b>	Prism (borosilicate glass)
5.		Sealing aperture (Fluor silicate)
6.	<b>Electronic Housing Group</b>	Sealing - housing ((Fluor silicate)
7.		Electronics
8.		Housing (Aluminium, die-cast)
9.		FAA L-823 plug

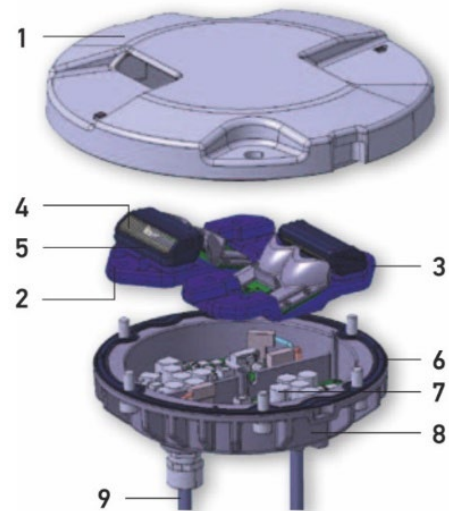

A detailed spare parts list can be found in Chapter 7.

## 4.2 General specifications

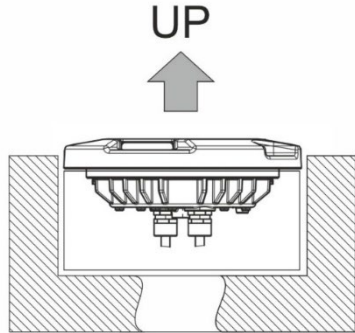
Nominal AC frequency:	40-70 Hz
Operation on constant current source	max. 6.6 A
Ambient temperature:	-40°C (40°F) / +75°C (+167°F)
Weight: approx.	2.5 kg
Dust and water tightness:	<p>IP68, IP69</p> <p>IP6X (Dust test) passed</p> <p><i>Test dust:</i> Arizona dust A2  <i>Flow direction:</i> Vertical  <i>Test duration:</i> 5 hours</p> <p>IPX8 (continuous submersion) test passed</p> <p><i>Water level:</i> 1,00 m  <i>Exposure time:</i> 30 minutes  <i>Water temperature:</i> (23 ±5)°C</p> <p>IPX9 (high pressure cleaning) test passed</p> <p><i>Water flow:</i> (15 ± 1) l/min  ↔ <i>nozzle-specimen:</i> (175 ± 25) mm  <i>Water temperature:</i> (80 ±5)°C</p>
Operation position must be according the drawing (note: drawing is indicative only):	<p style="text-align: center;">UP</p> 

## 4.3 Operation Information

The Inset lights 8" are intended for outdoor use only for dedicated airfield installation. The power consumption and rated voltage are different for each function of the Inset lights 8". Optionally, the inset lights can be supplied with heating. Refer to the tables below.

### 4.3.1 ICAO/EASA functions

Per side of uni-/bidirectional inset lights 8 inch <sup>1</sup>								
Light	Function	Colour	Max. power consumption fixture (W)		Apparent power fixture (VA)		Max. rated voltage fixture (VAC)	
			standard	with heating	standard	with heating	standard	with heating
RCL	Runway Center Line	White	19	32	20	34	3	5
		Red	11	24	12	25	2	4
TDZ	Touchdown Zone	White	19	32	20	34	3	5
REL	Runway Entrance	Red	11	24	12	25	2	4
THL	Take-Off and Hold	Red	14	27	15	28	3	5
RWE	Runway End	Red	38	52	40	55	6	8
RETIL	Rapid Exit Taxiway Indicator	Yellow	17	31	18	33	3	5
RETL800 RETL800	Rapid Exit Taxiway 800 cd Straight/Curved	Yellow	21	35	22	37	4	6
		Green	22	36	23	38	4	6
TCL	Taxiway Center Line	Green	10	23	11	24	2	4
		Yellow	10	23	11	24	2	4
TCC	Taxiway Center Line curved	Green	9	22	9	23	2	4
		Yellow	9	22	9	23	2	4
IHP	Intermediate Holding Position	Yellow	11	24	12	25	2	4
RWG	Runway Guard	Yellow	25	39	26	41	4	6
STB	Stop Bar (ICAO)	Red	11	24	12	25	2	4
Omnidirectional Inset Lights 8 inch <sup>1</sup>								
REO	Runway Edge Omni	White	10	23	11	24	2	4
SMGL60	Stand Manoeuvring Guidance 60cd	Yellow	11	24	12	25	2	4
TXE	Taxiway Edge	Blue	8	21	8	22	2	4
TXO	Omnidirectional	Yellow	10	23	11	24	2	4
		Green	11	24	12	25	2	4
HELI	Heliport	Green	10	23	11	24	2	4
		White	10	23	11	24	2	4

<sup>1</sup> = Power consumption is for the fixture only, per side/color. Cable losses, transformer efficiency etc. are not included.

## 4.3.2 FAA functions

Per side of uni-/bidirectional inset lights 8 inch <sup>1</sup>						
Light	Function	Colour	Max. power consumption fixture (W)	Apparent Power fixture (VA)	Max. power consumption primary (W) Primary side of transformer	Apparent Power primary (VA) Primary side of transformer
L-850A	Runway Center Line, LAHSO	White	19	20	27	30
		Red	12	13	17	19
L-850B	Runway Touchdown Zone	White	19	20	27	30
L-852A	Taxiway Centerline Straight; Clearance Bar	Green	8	8	12	13
		Yellow	9	9	13	14
L-852B	Taxiway Centerline Curved	Green	8	8	12	13
		Yellow	9	9	13	14
L-852C	Taxiway Centerline Straight; Clearance Bar	Green	8	8	12	13
		Yellow	9	9	13	14
L-852D	Taxiway Centerline Curved	Green	10	11	14	16
		Yellow	12	13	17	19
L-852G	Runway Guard	Yellow	25	26	35	39
L-852J	Taxiway Centerline Curved	Green	8	8	12	13
		Yellow	8	8	12	13
L-852K	Taxiway Centerline Curved	Green	10	11	14	16
		Yellow	10	11	14	16
L-852S	Stop Bar, RWSL Runway Entrance Light (REL)	Red	15	16	22	24
Omnidirectional Inset Lights 8 inch <sup>1</sup>						
L-852E	Taxiway Intersections	Yellow	11	12	15	17
L-852T	Taxiway Edge, Apron Edge	Blue	8	8	12	13

<sup>1</sup> = Power consumption is for the fixture only, per side/color. Cable losses, transformer efficiency etc. are not included.

## 4.4 Accessories

Optional accessory:

- Transformer
- Shallow base

## 4.5 Dimensions

Uni/bi-directional inset lights 8”

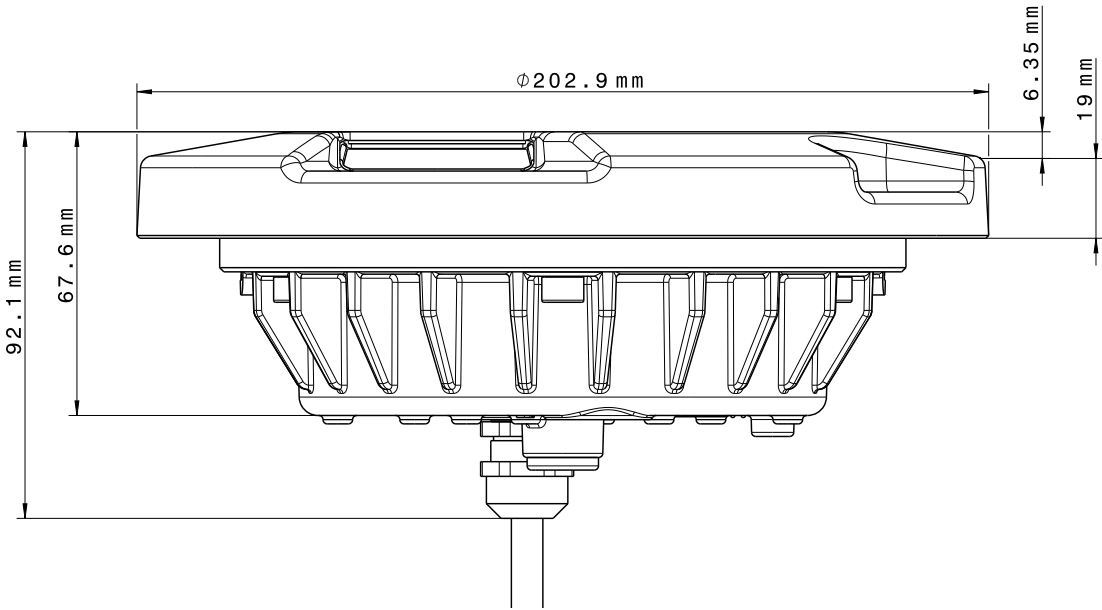

Omni directional inset lights 8”:

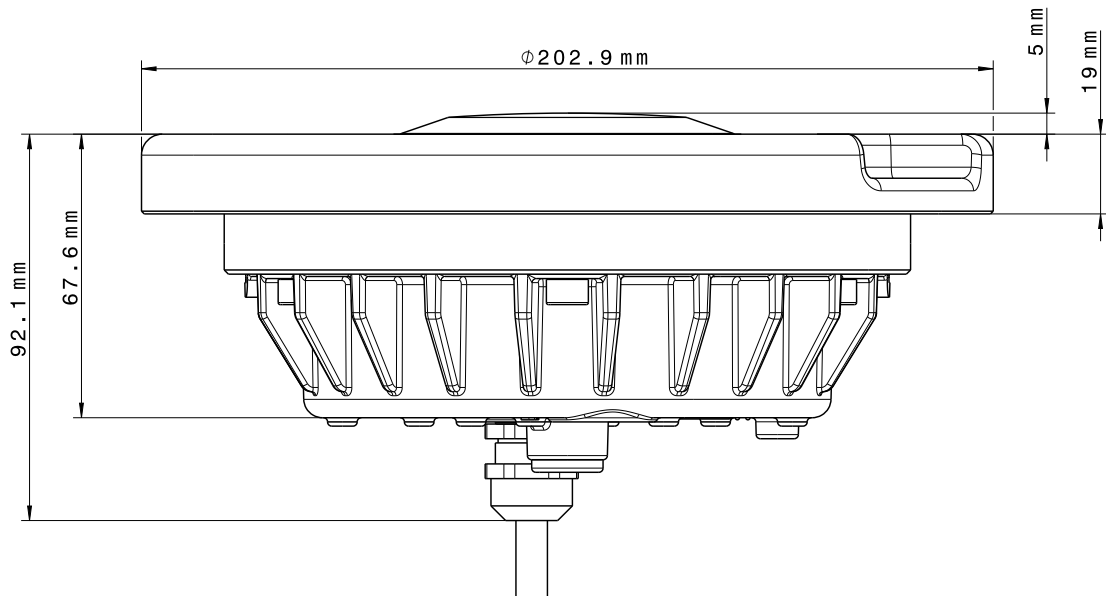

**NOTICE**

Drawings above are indicative only.

#### 4.6 Wiring Diagrams FAA Models

L-850A, L-852A/B/C/D/J/K

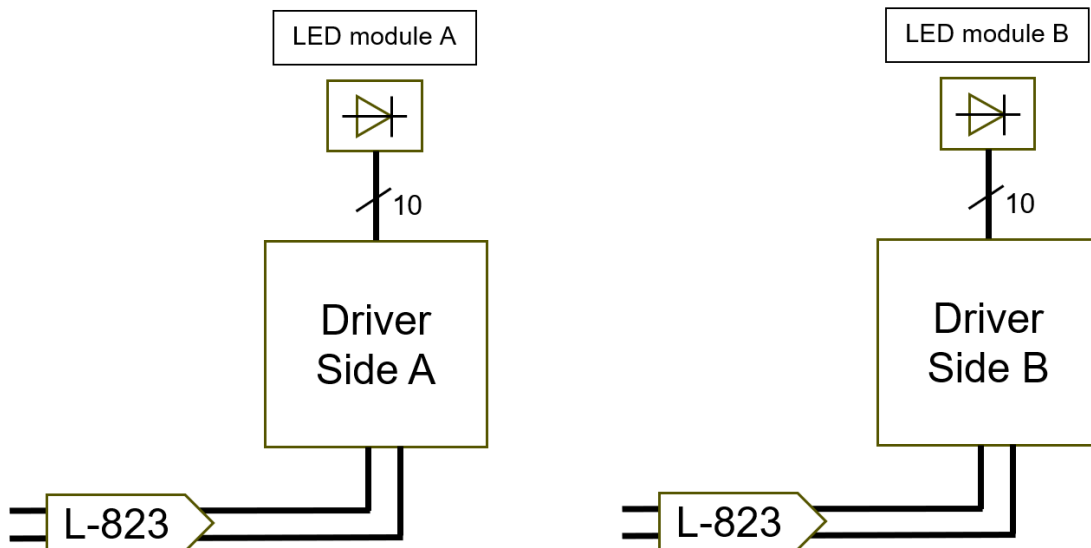

L-850B, L-852E/S/T

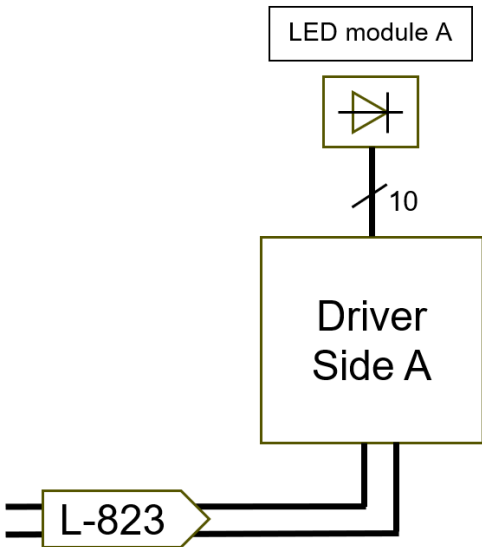

L-852G

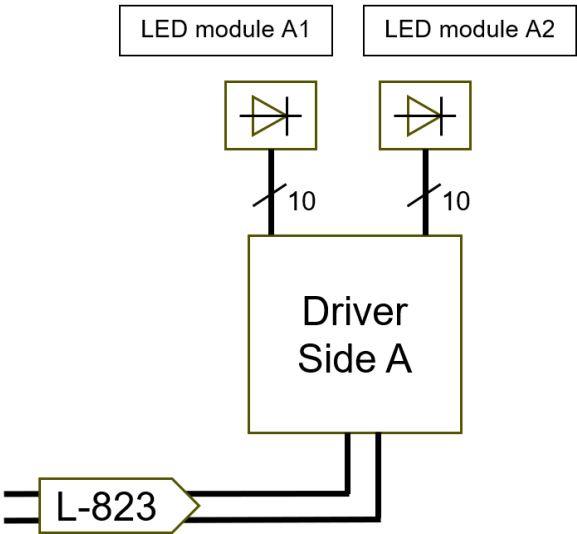

---

## **5. Maintenance Recommendations**

---

---

### **5.1 Warranty Limitation**

---

The light assemblies are delivered fully tested and sealed. In case of malfunctioning during the warranty period, the defective light shall be shipped back to TKH Airport Solutions without opening it. Any attempt to open the light during the warranty period will void the warranty.

The prisms are not included in the warranty.

---

### **5.2 Maintenance in the Field**

---

Field maintenance is limited to cleaning the surface of the front glass when necessary.

It is recommended to replace the light assembly if it malfunctions in the field or at end-of-life (after about 50000 operating hours).

---

### **5.3 Preventive Maintenance**

---

Besides cleaning the surface of the lens, no preventive maintenance is required.

## 6. Installation and maintenance instructions

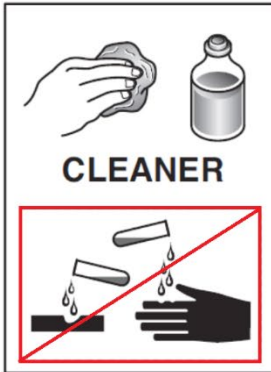

### 6.1 Tools Required

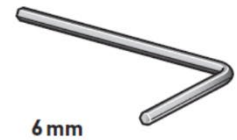
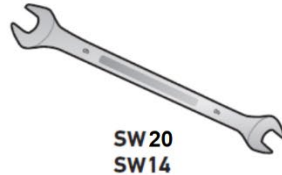

Non-caustic cleaning agent

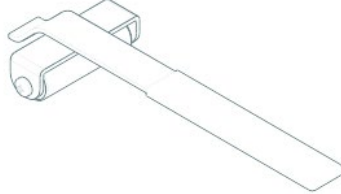

#### 6.1.1 Optional tools available to order

 <p>Torque wrench 20 - 40 Nm (302.331)</p>	 <p>Lifting tool (302.321) to extract inset lights from the shallow base</p>
	<p>Tool set (302.311) for repair and maintenance of inset lights containing:</p> <ul style="list-style-type: none"> <li>• Torque wrench 0-10 Nm</li> <li>• 13 adapters for torque wrench, covering sizes 4 mm - 14 mm</li> <li>• 6 Allen adapters for torque wrench, H3-H8</li> <li>• 7 TORX adapters for torque wrench, T10-T40</li> <li>• length adapters for torque wrench</li> <li>• 1 manual wrench 14 mm</li> <li>• 1 manual wrench 20 mm</li> </ul>

## 6.2 Installation

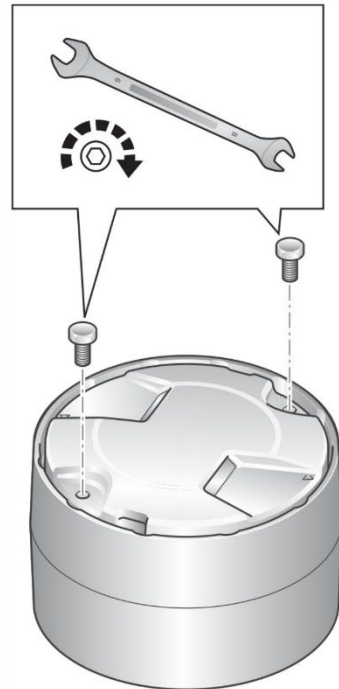
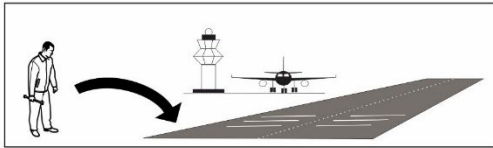

### NOTICE

Tighten the nuts with a torque wrench. See specification of the shallow base manufacturer.

### 6.3 Replacing the O-ring of the inset light 8"

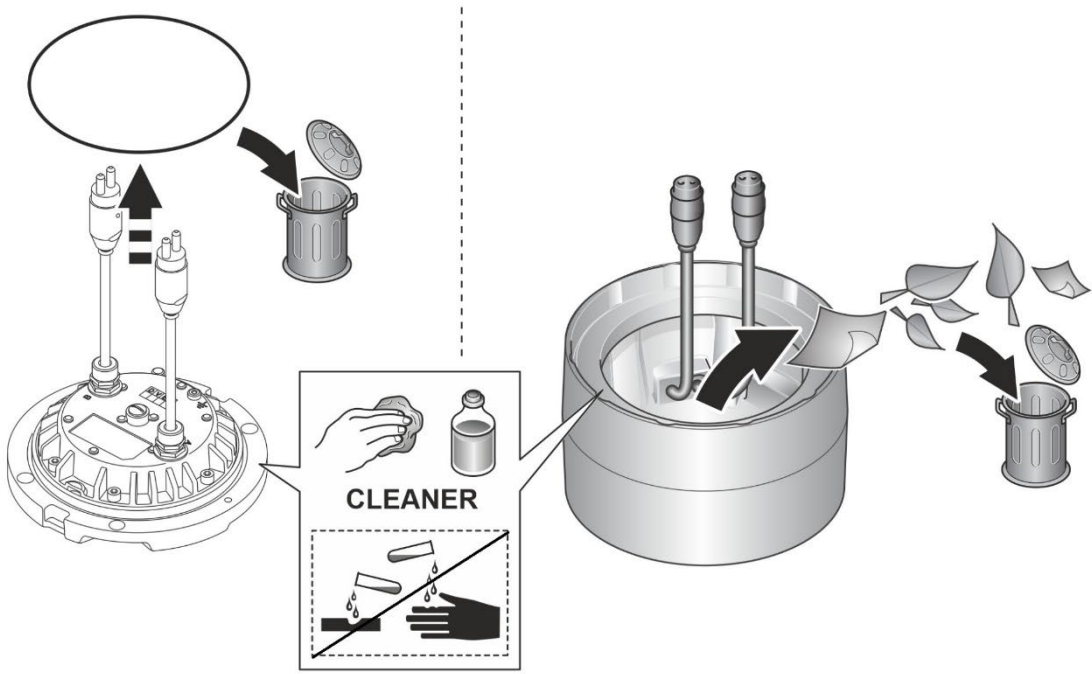
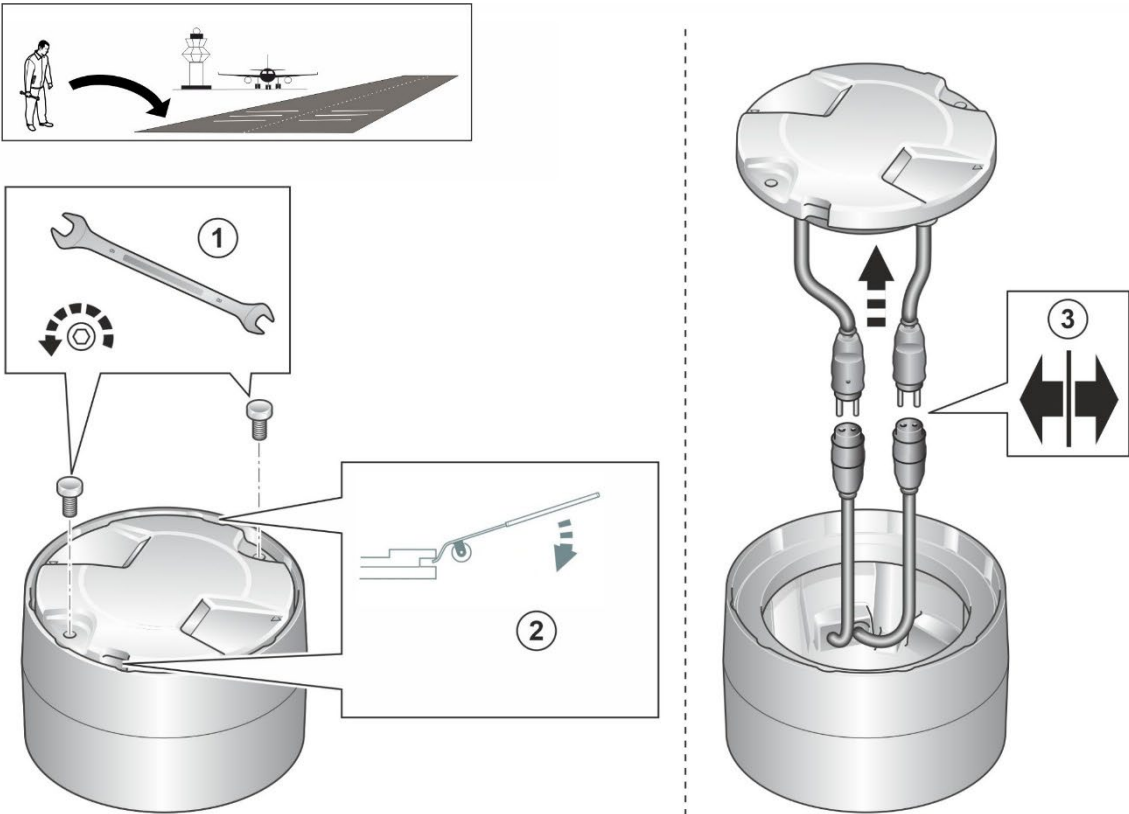

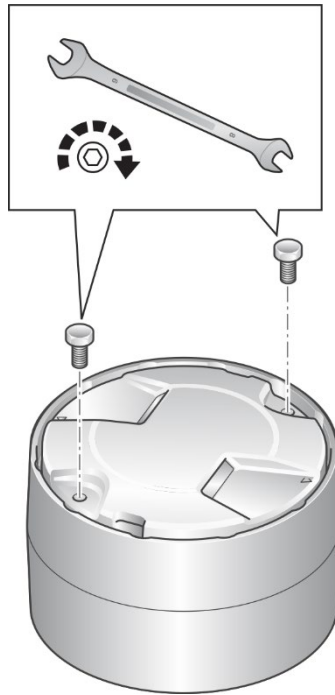
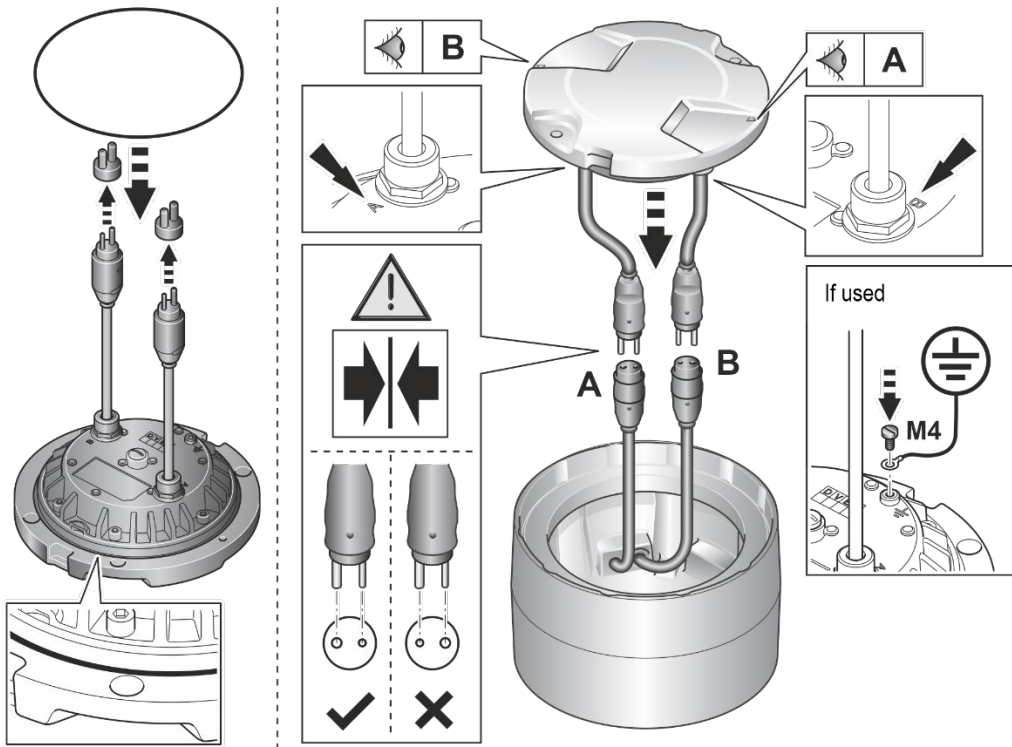

**NOTICE**

Tighten the nuts with a torque wrench. See specification of the shallow base manufacturer.

### 6.4 Replacing the prism

**NOTICE**

Follow the instructions carefully and only disconnect the cables as shown in these pictures. Do not disconnect any other cables!

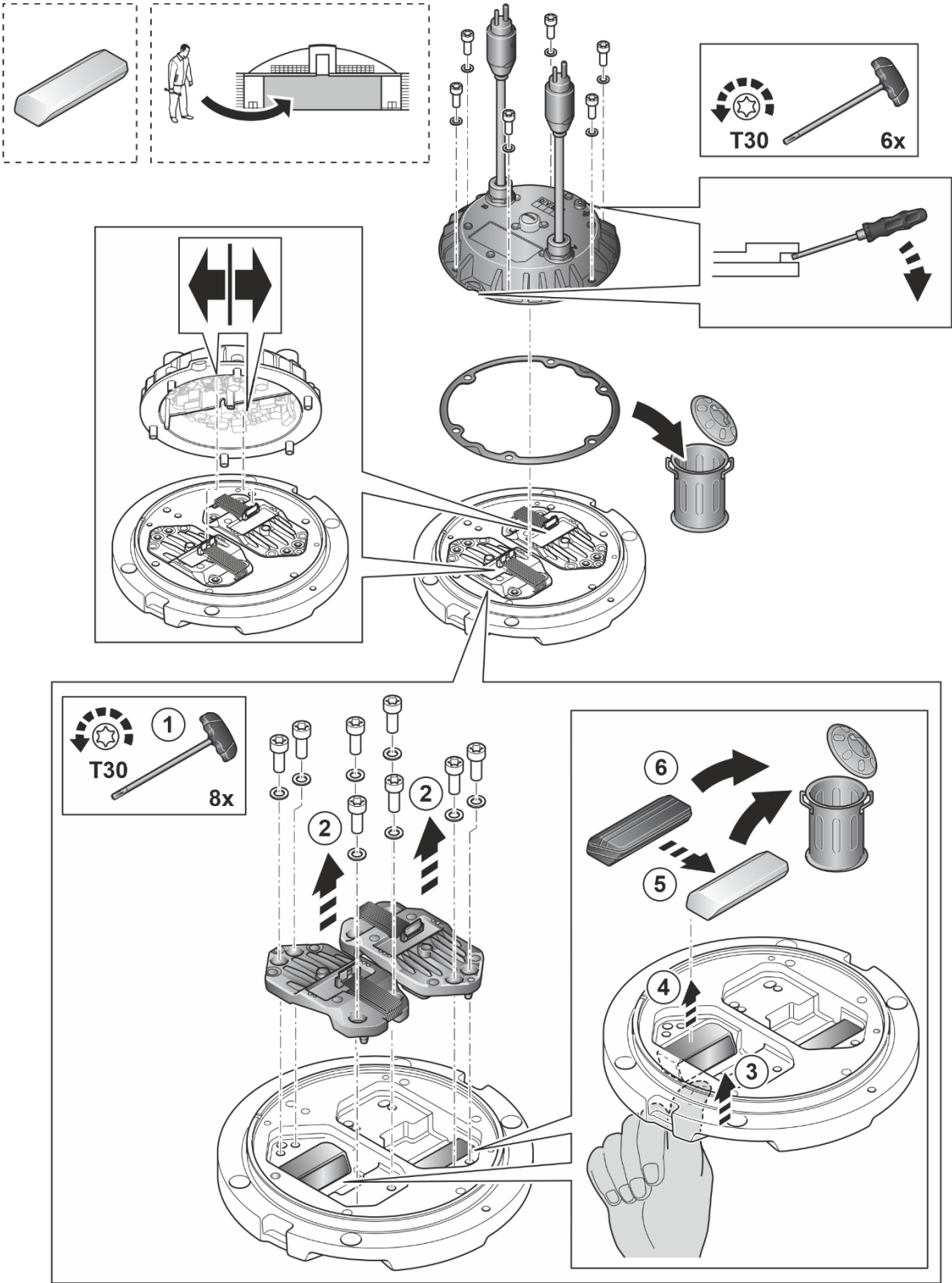

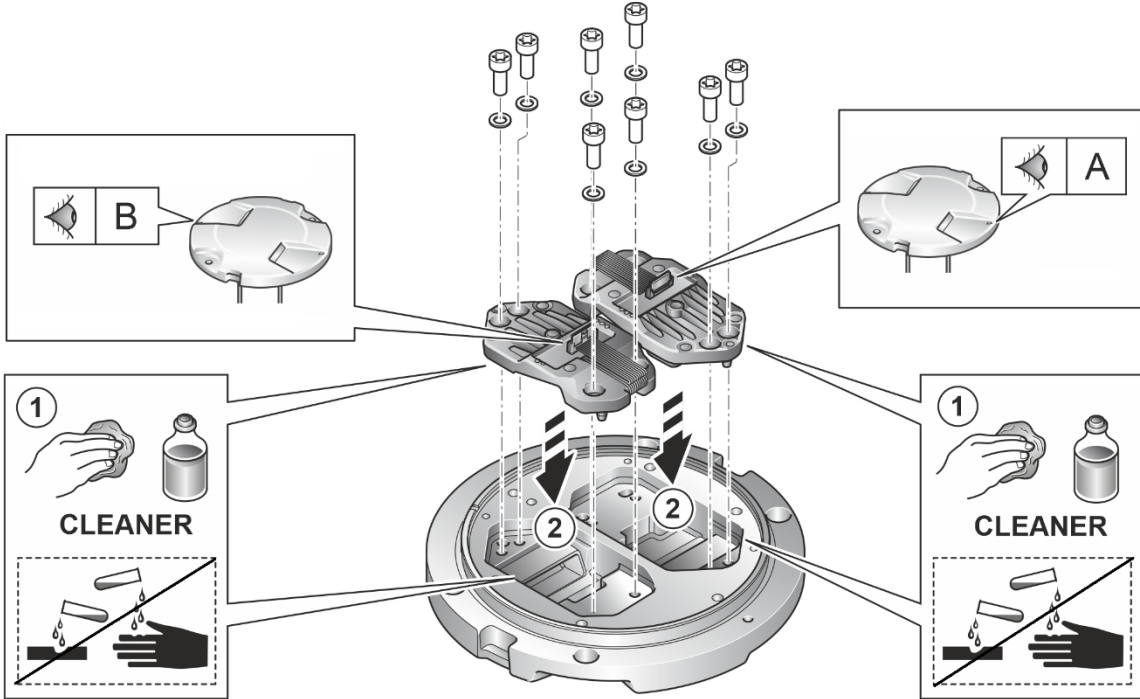
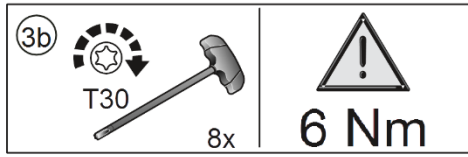
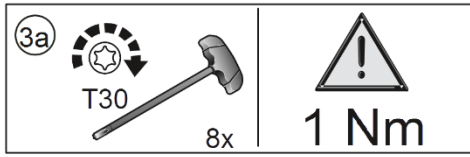

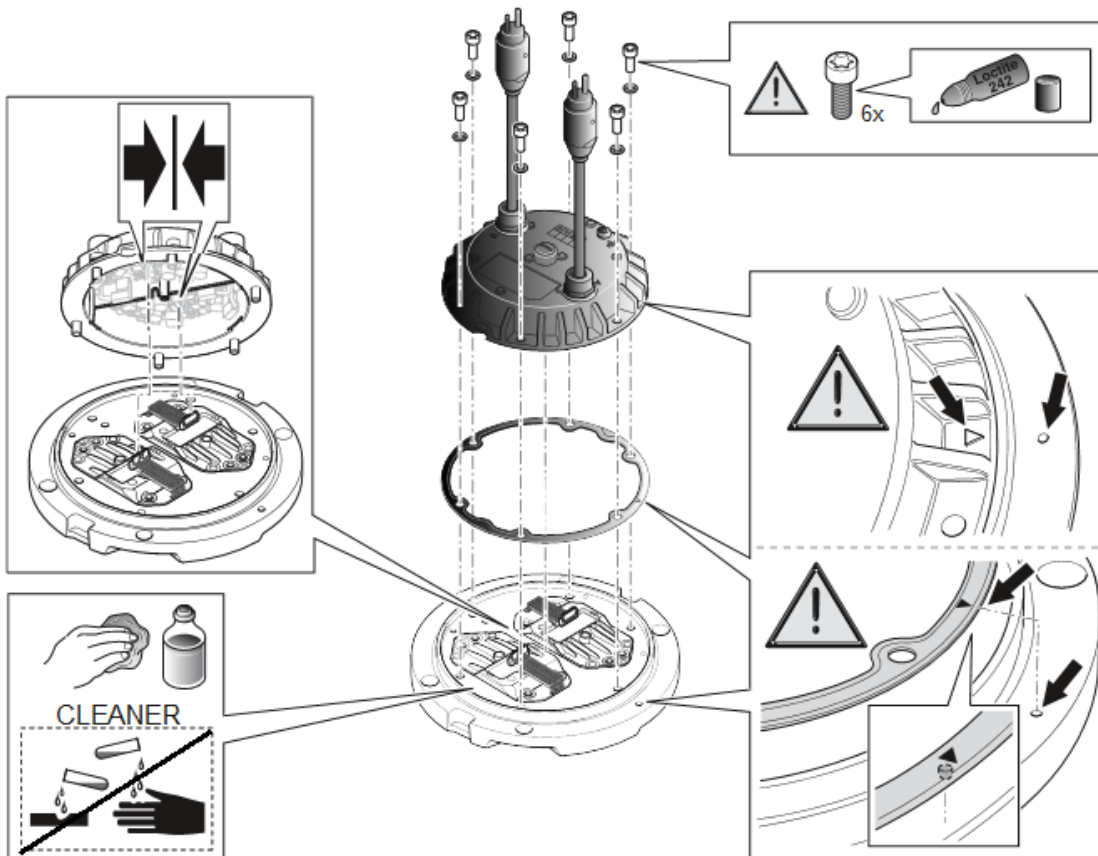
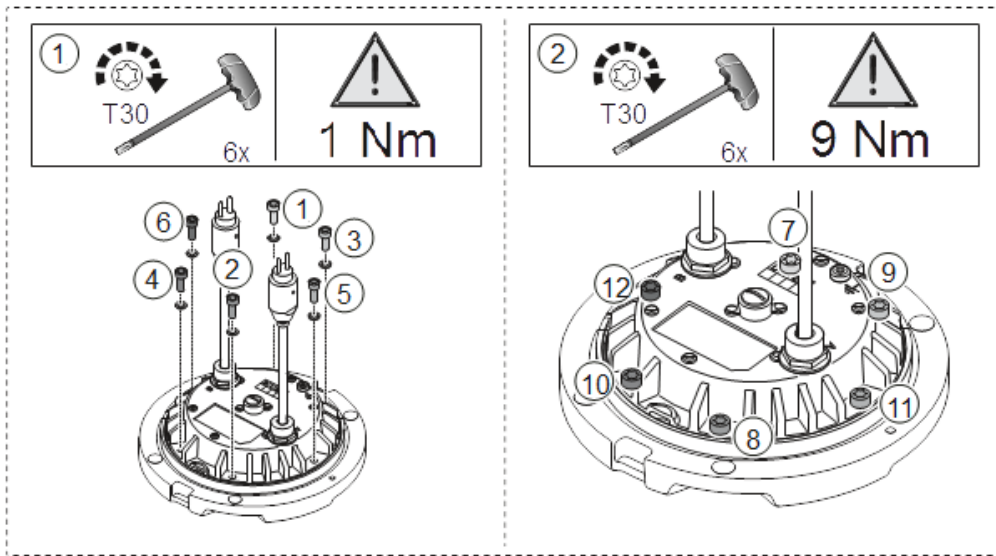

**NOTICE**

Make sure to perform a leakage test, as explained in chapter 6.8, everytime a fixture is opened and closed.

## 6.5 Replacing the housing group

**NOTICE**

Follow the instructions carefully and only disconnect the cables as shown in these pictures. Do not disconnect any other cables!

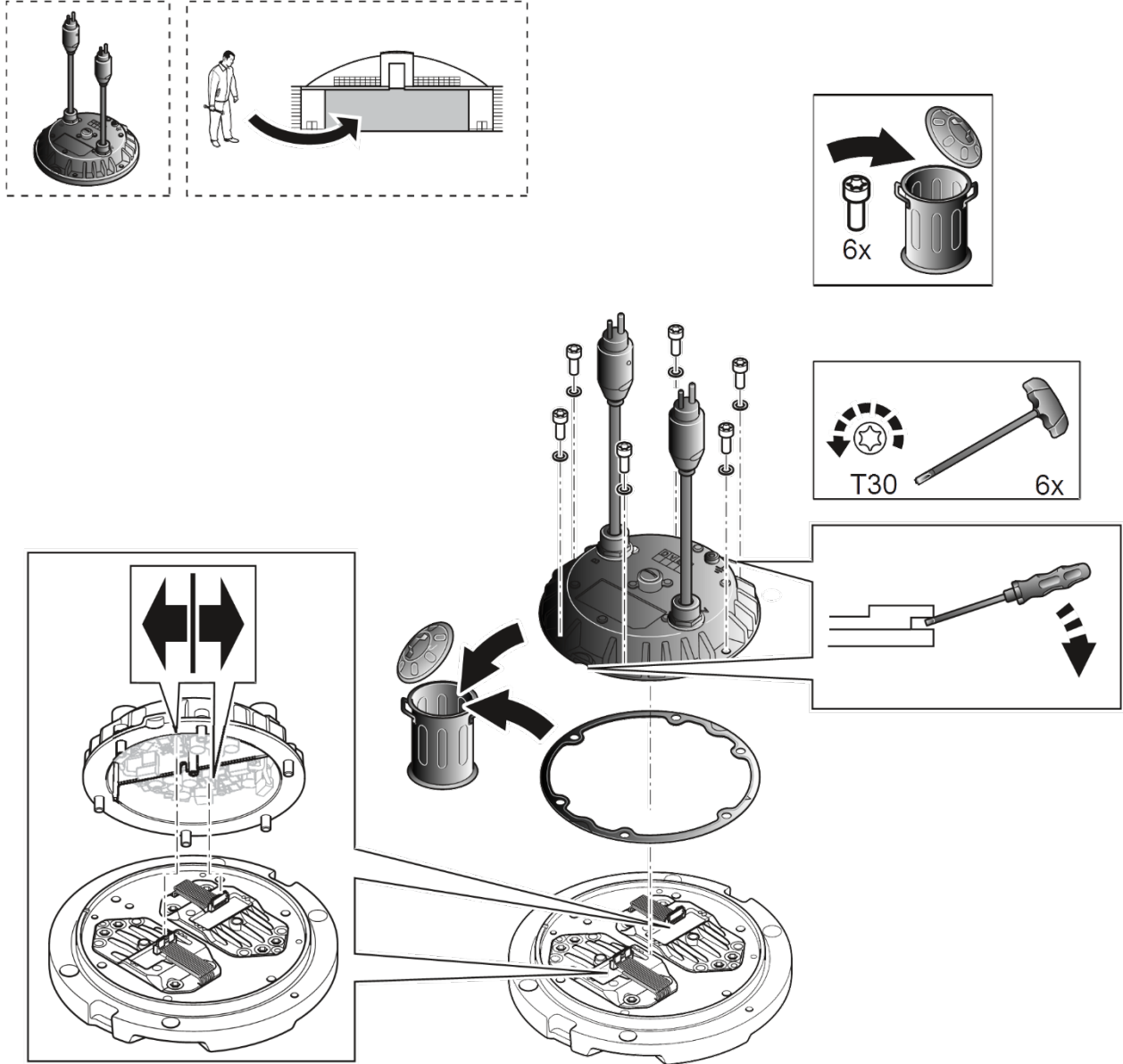

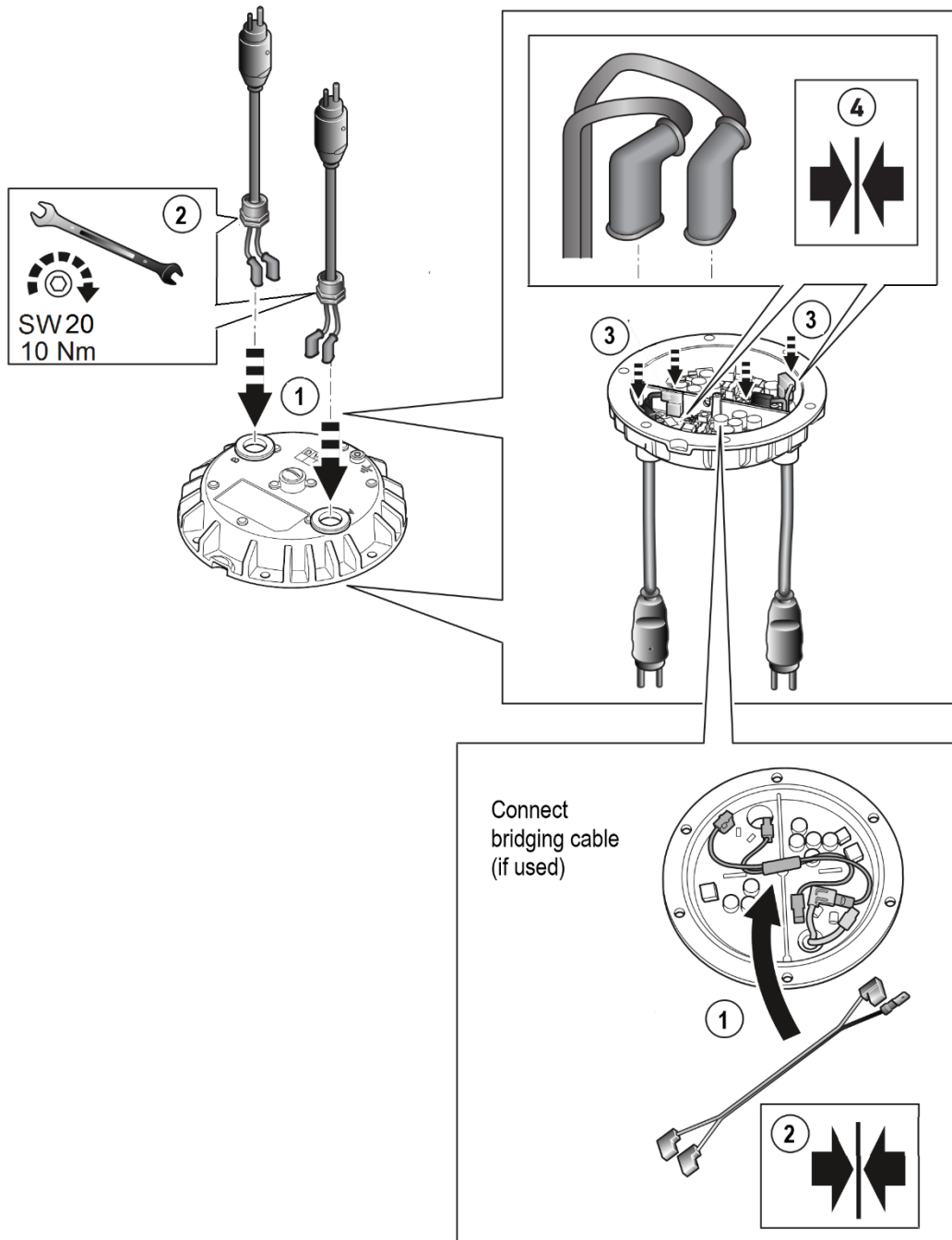

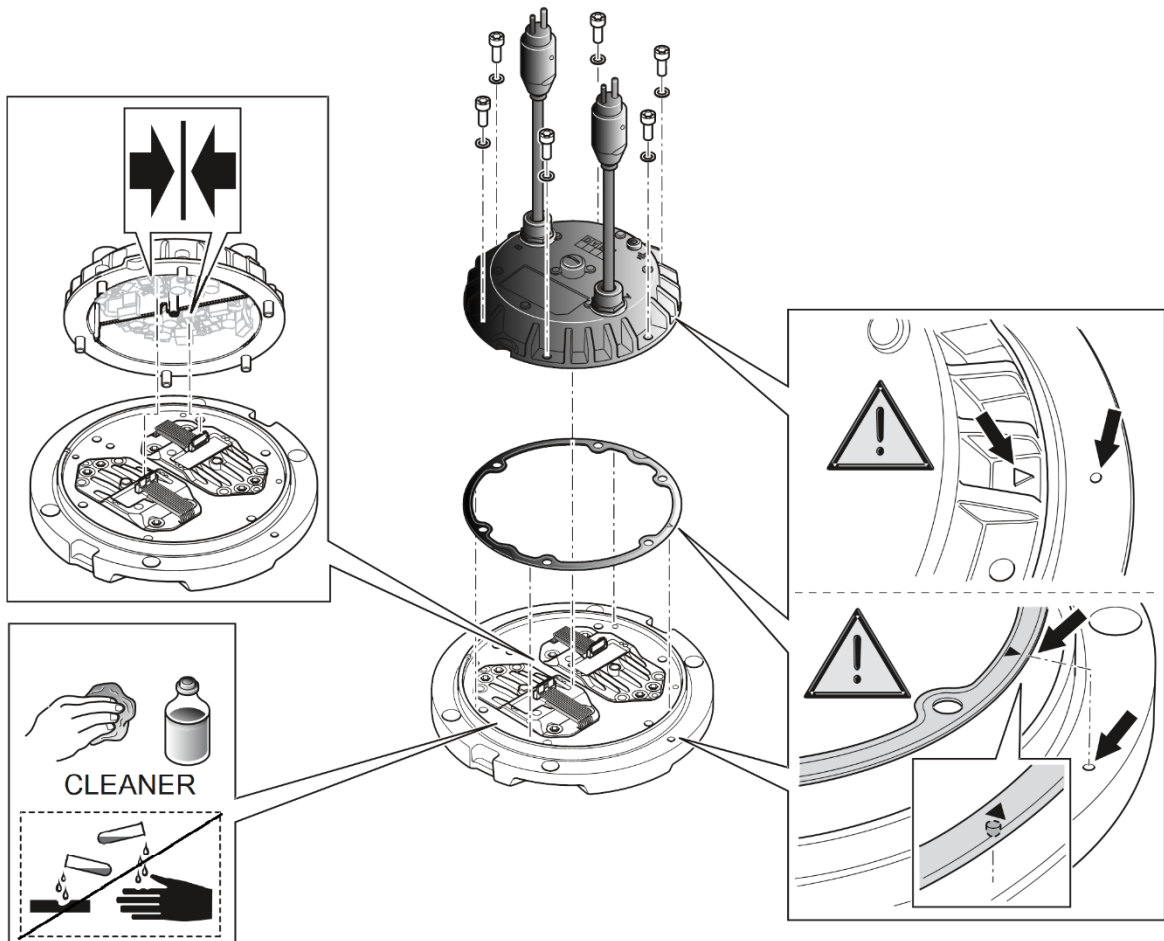
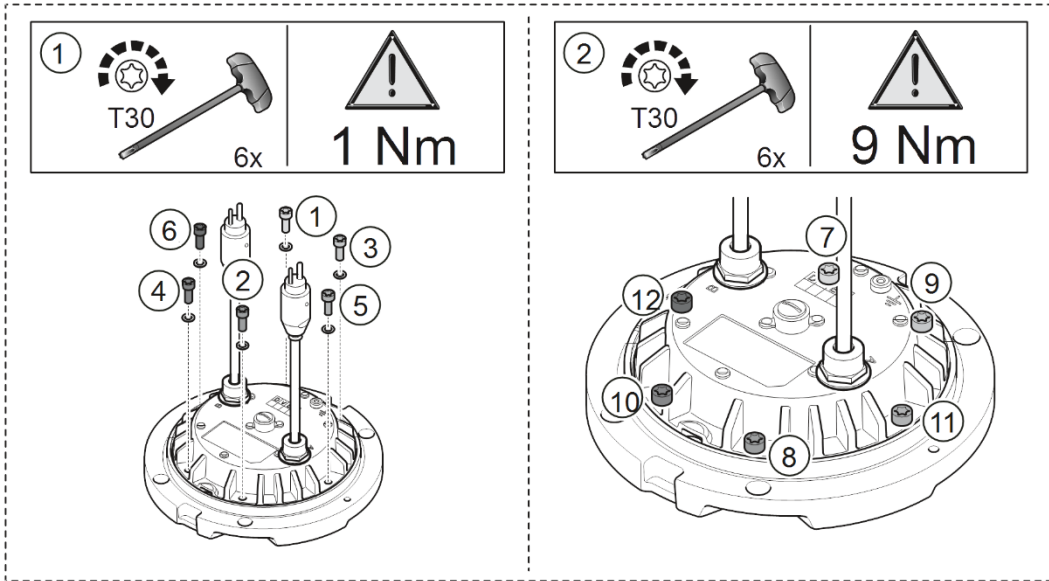

**NOTICE**

Make sure to perform a leakage test, as explained in chapter 6.8, everytime a fixture is opened and closed.

### 6.6 Replacing the external cable

**NOTICE**

Follow the instructions carefully and only disconnect the cables as shown in these pictures. Do not disconnect any other cables!

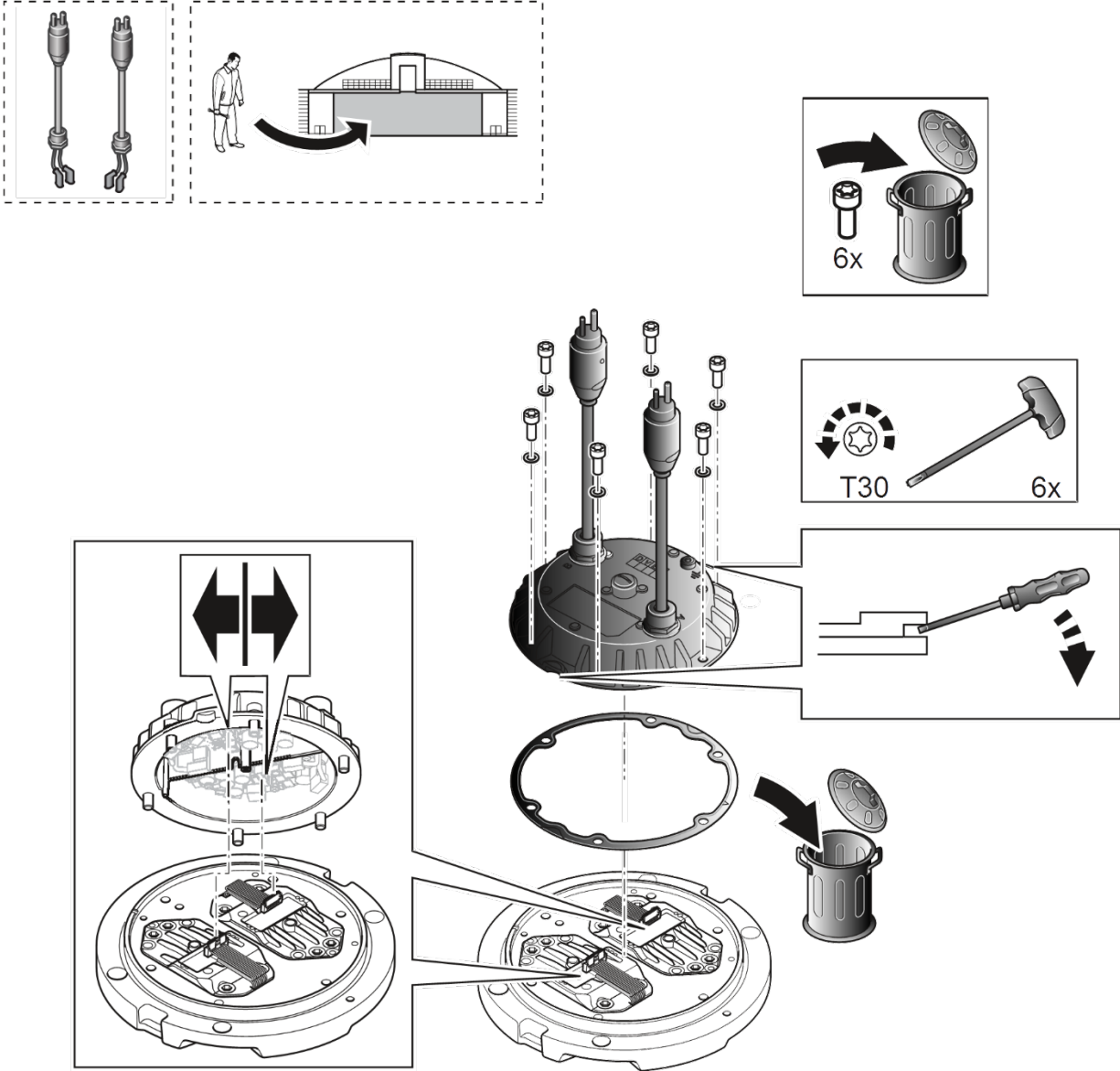

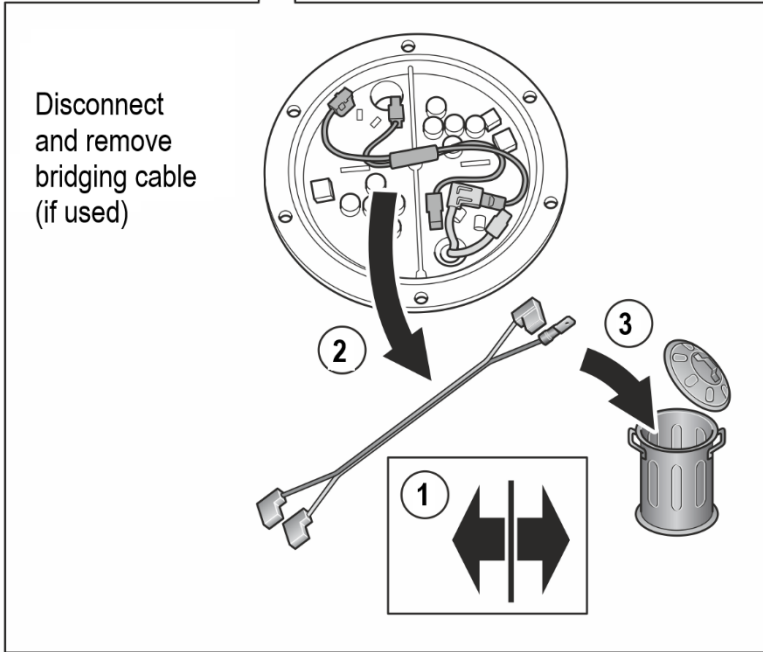
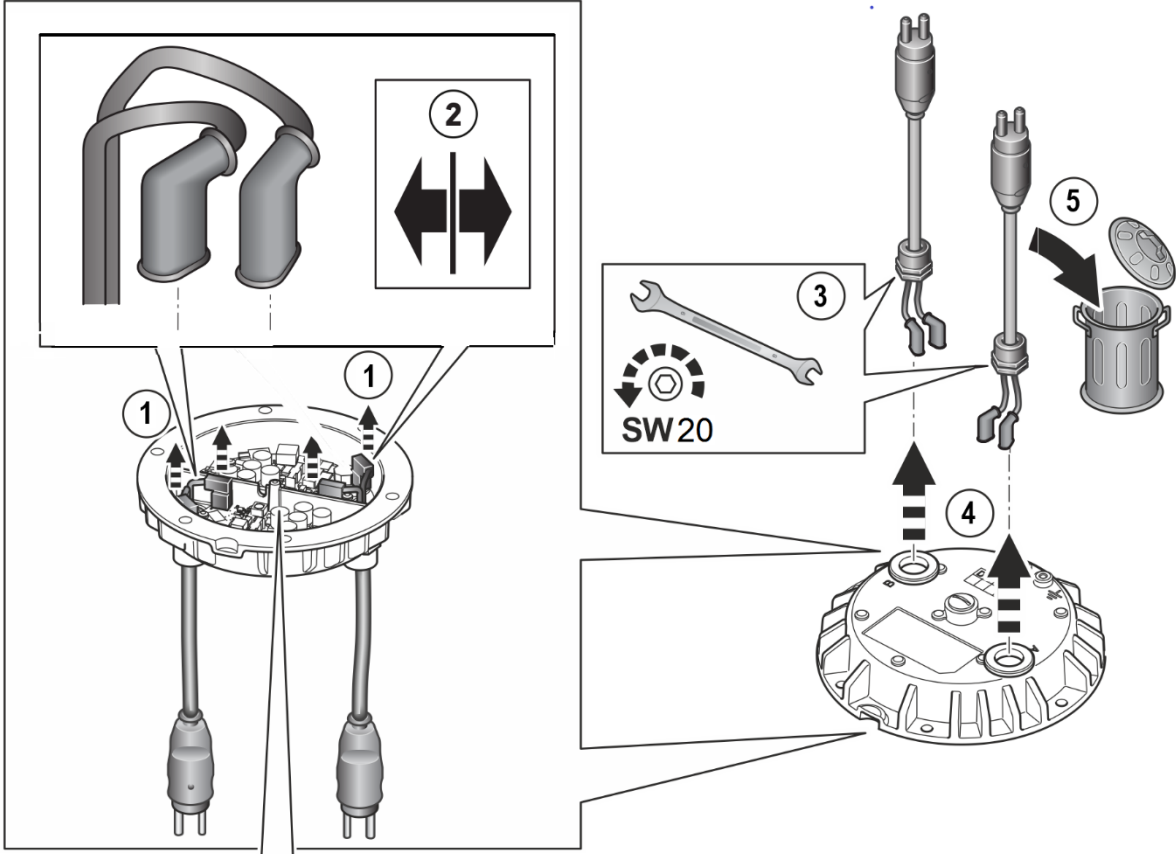

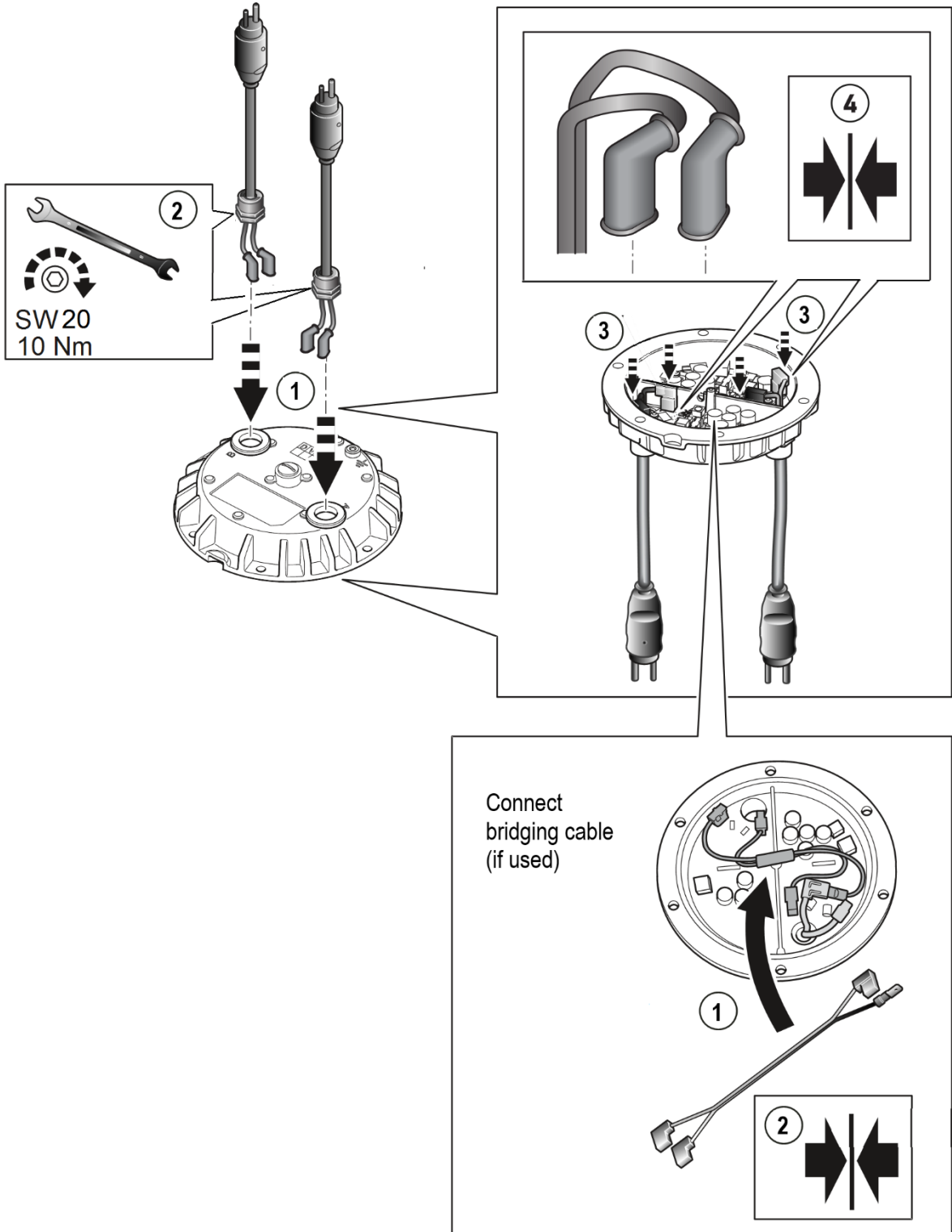

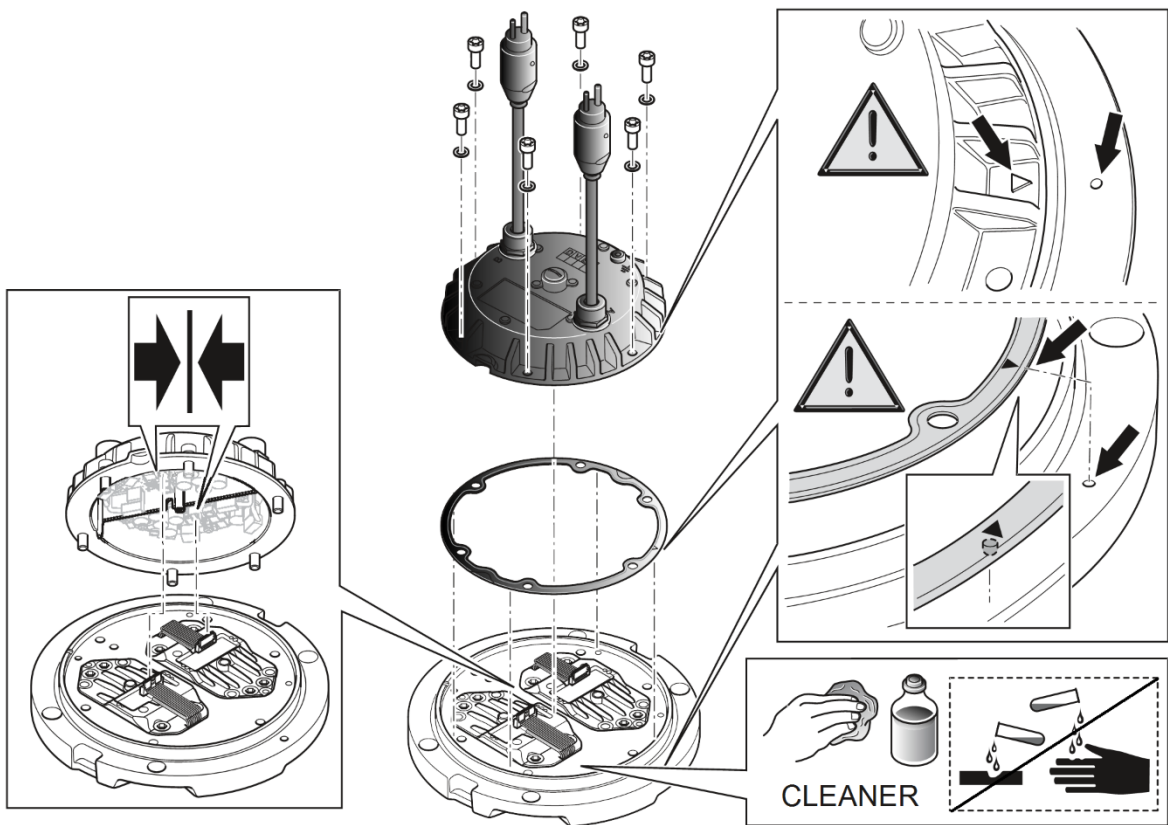
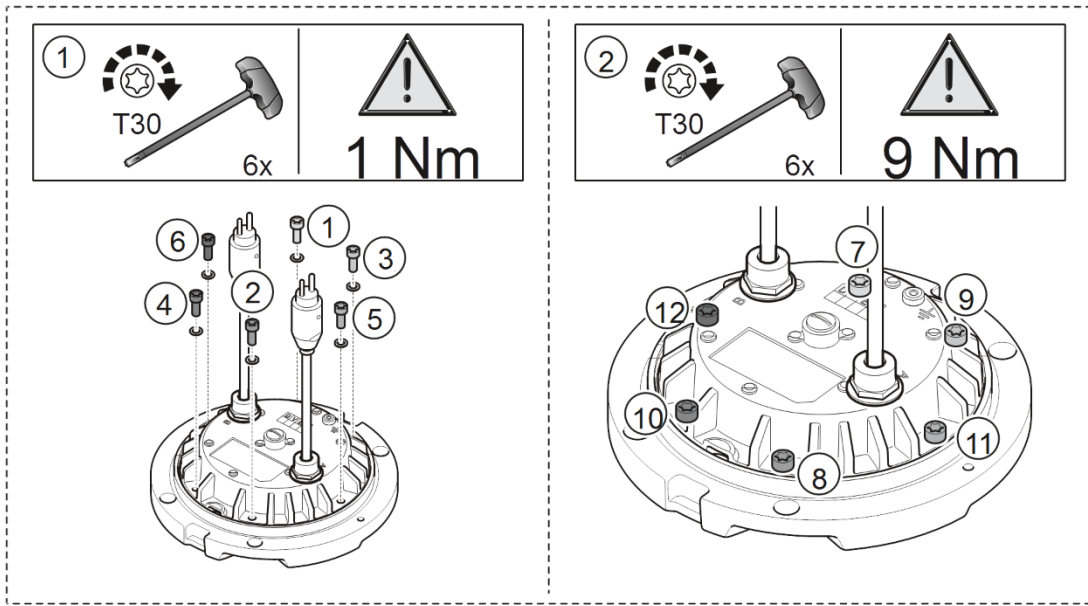

**NOTICE**

Make sure to perform a leakage test, as explained in chapter 6.8, everytime a fixture is opened and closed.

### 6.7 Replacing the module holder group

**NOTICE**

Follow the instructions carefully and only disconnect the cables as shown in these pictures. Do not disconnect any other cables!

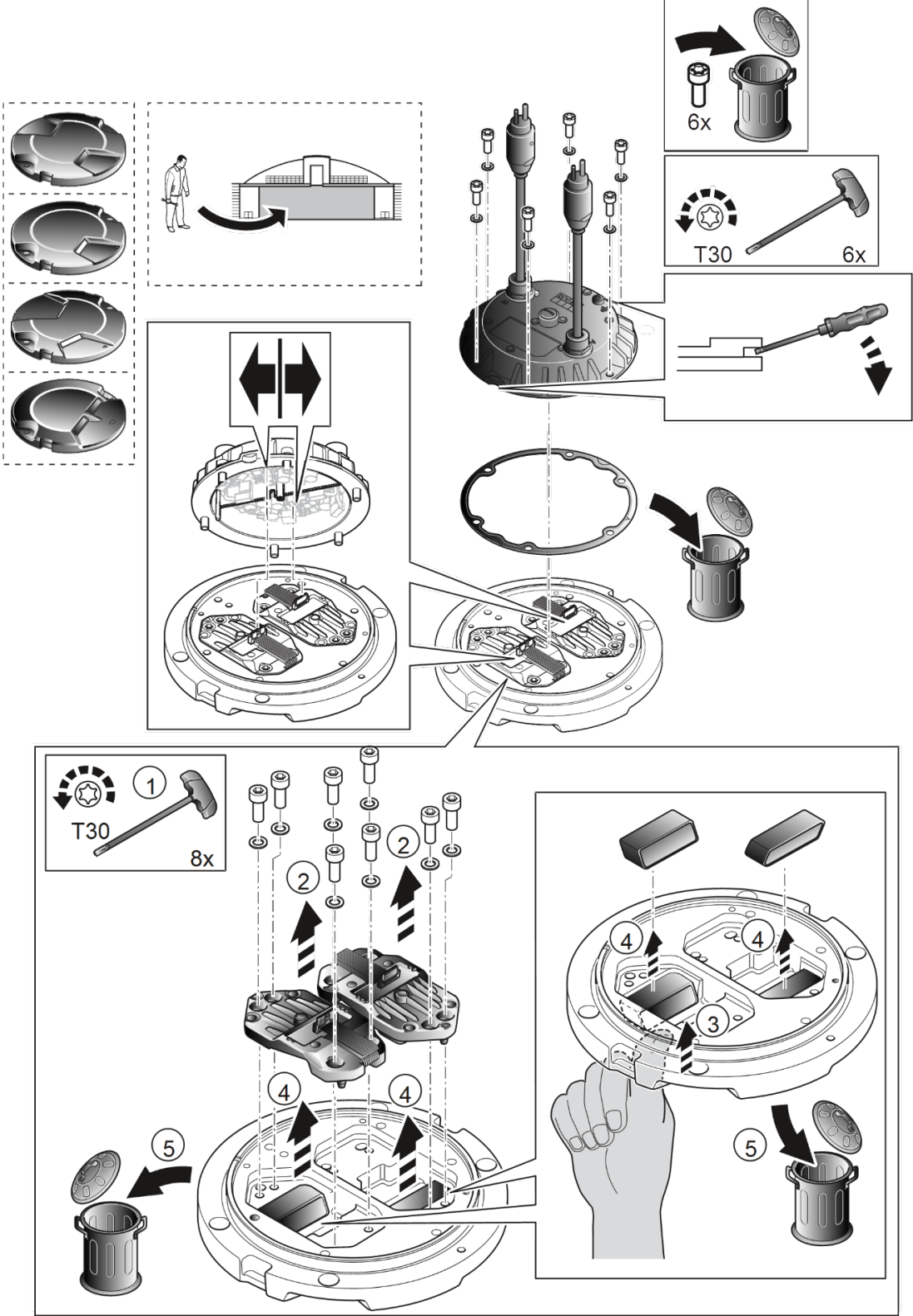

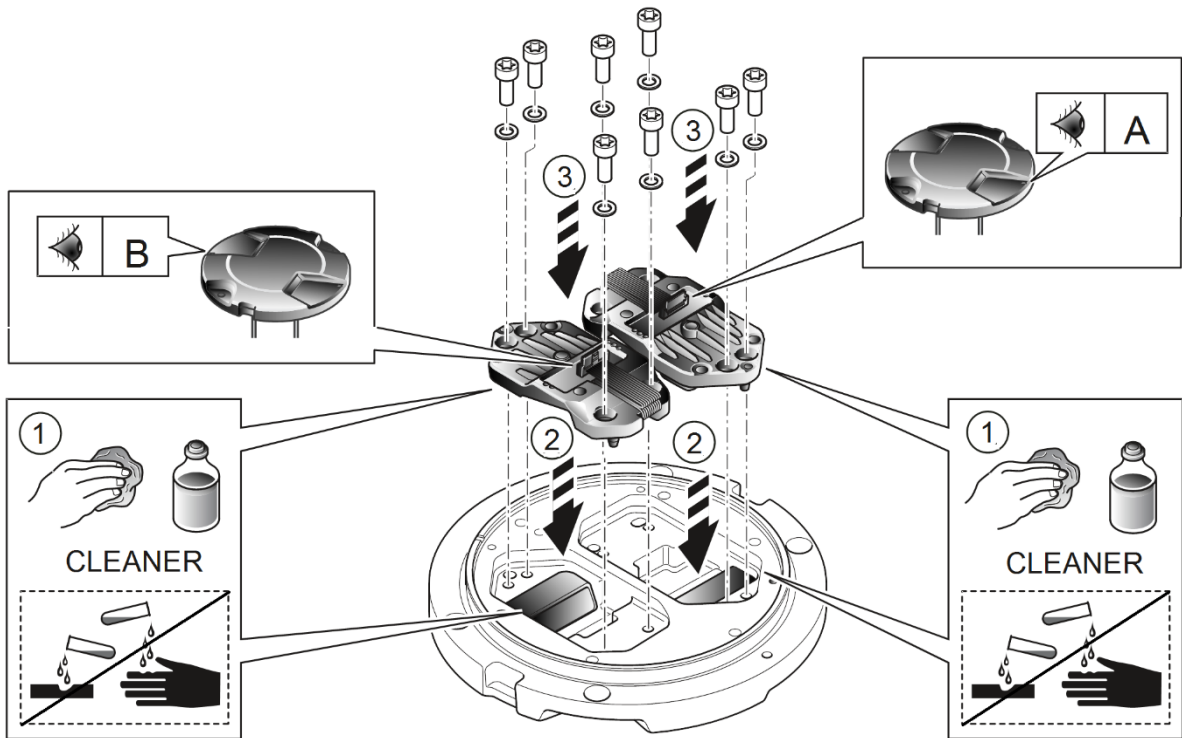
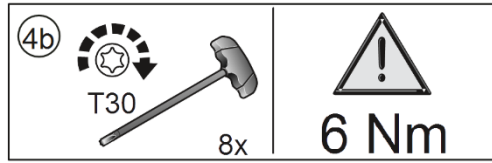
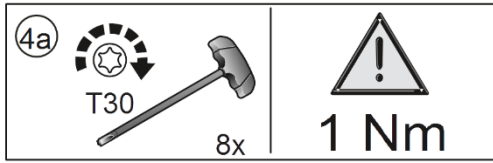

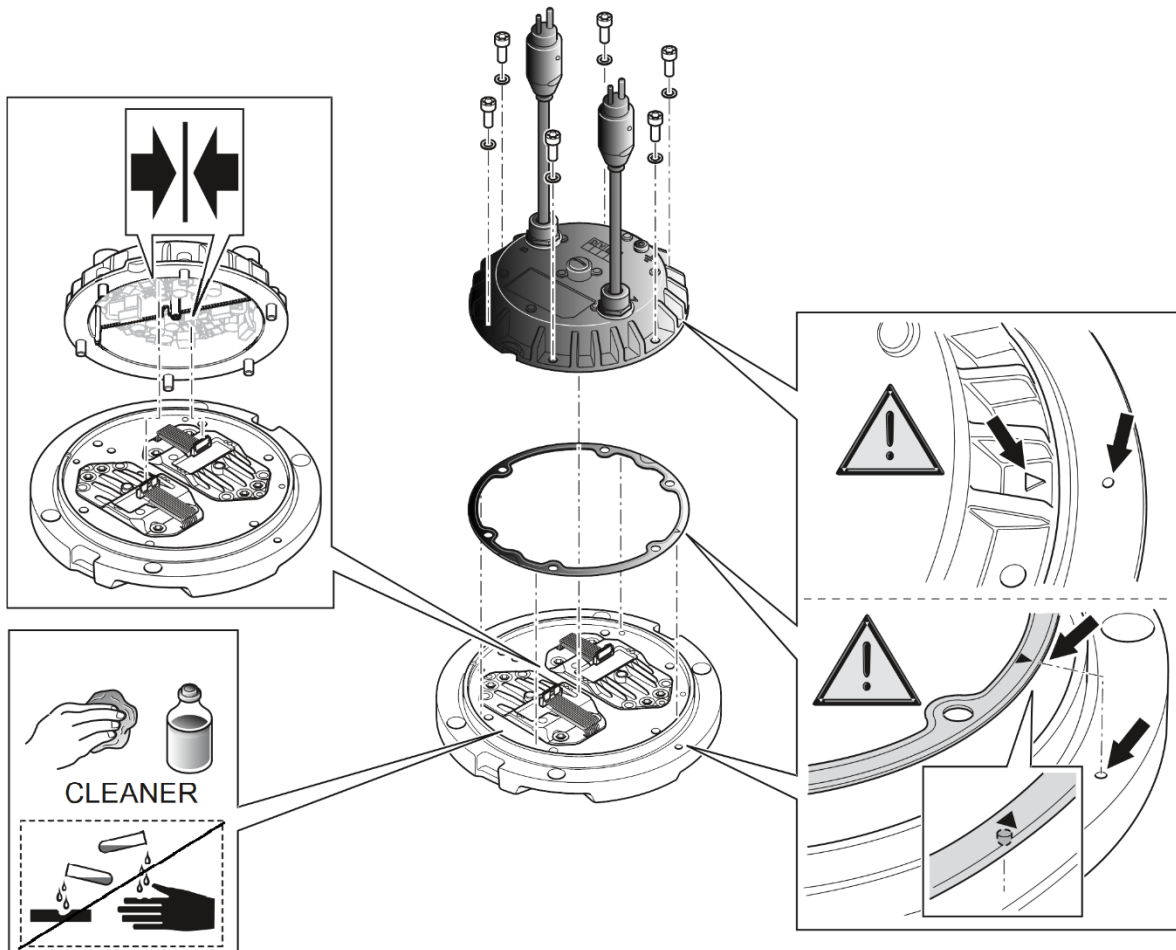
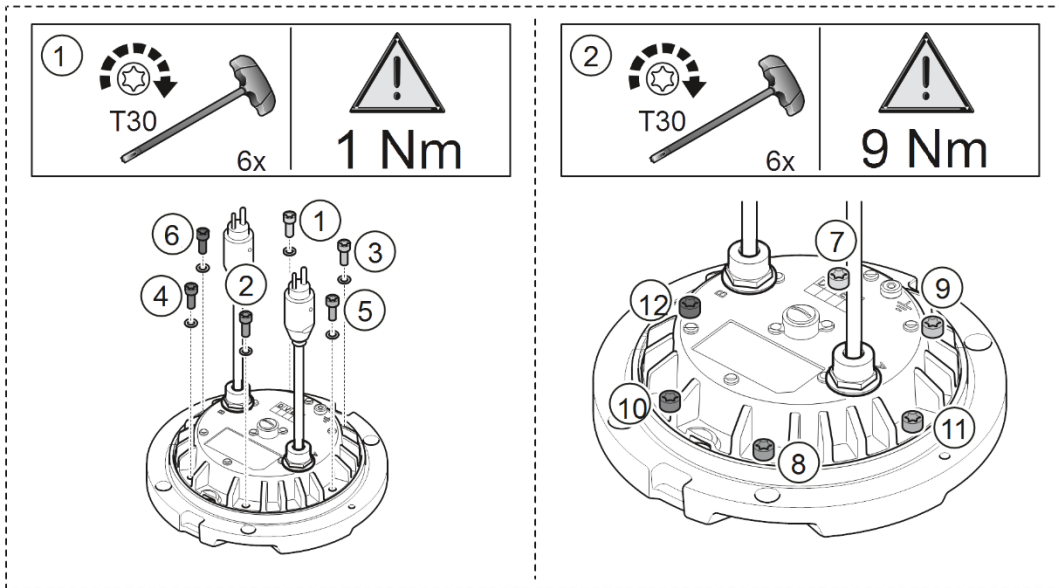

**NOTICE**

Make sure to perform a leakage test, as explained in chapter 6.8, everytime a fixture is opened and closed.

## 6.8 Leakage test

To perform the leakage test, a screw valve M12 is required. This can be purchased at TKH Airport Solutions under part number 178.255-00.

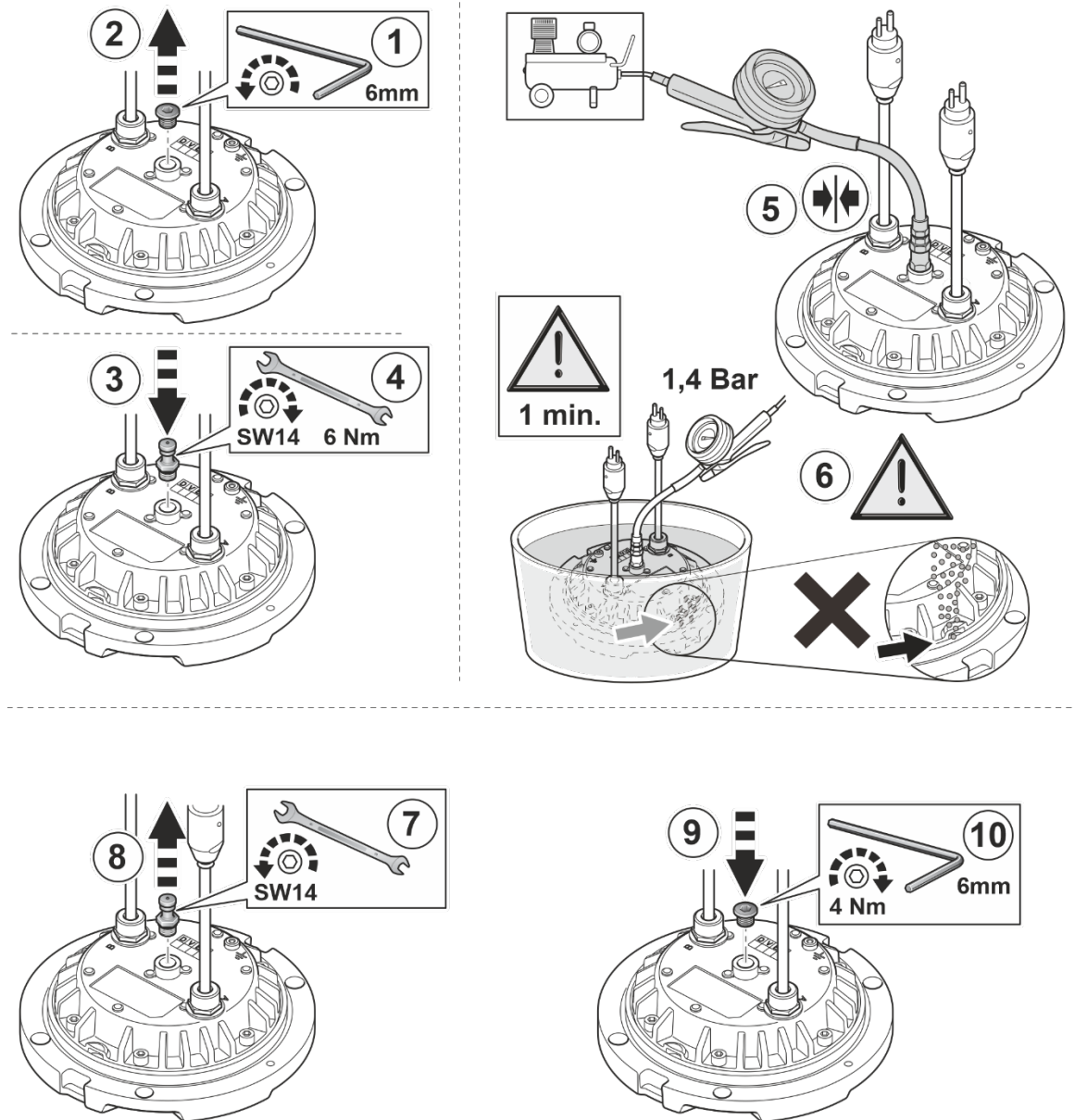

## 7. Spare Parts list for Inset Lights 8"

Part No.	Order Code / Name	Description
<b>Runway Centreline / L-850A</b>		
180.912-05	Cover 8" uni straight	Cover for 8" inset fixture   unidirectional   straight
180.912-02	Cover 8" bi straight	Cover for 8" inset fixture   bidirectional   straight
190.774-107	EHG-20W-0-1x250mm-P1-8-0	Electronic Housing Group   20 W   1 cable 250 mm   standard FAA plug   8 inch   No fail-open
190.774-607	EHG-20W-0-1x250mm-P1-8-FO	Electronic Housing Group   20 W   1 cable 250 mm   standard FAA plug   8 inch   With fail-open (relay)
190.774-087	EHG-20W-20W-1x250mm-P1-8-0	Electronic Housing Group   20 W / 20 W   1 cable 250 mm   standard FAA plug   8 inch   No fail-open
190.774-587	EHG-20W-20W-1x250mm-P1-8-FO	Electronic Housing Group   20 W / 20 W   1 cable 250 mm   standard FAA plug   8 inch   With fail-open (relay)
190.774-067	EHG-20W-20W-2x250mm-P1-8-0	Electronic Housing Group   20 W / 20 W   2 cables 250 mm   standard FAA plug   8 inch   No fail-open
190.774-567	EHG-20W-20W-2x250mm-P1-8-FO	Electronic Housing Group   20 W / 20 W   2 cables 250 mm   standard FAA plug   8 inch   With fail-open (relay)
190.777-467	MHG-RCL-8-1xW-CAT3-00-0	LED module   Runway Centerline / Touch Down Zone   8 inch   White   CAT III   No heating   No special options   No fail-open   6.6 A
213.641-437	MHG-RCL-8-1xW-CAT3-10-0-0	LED module   Runway Centerline / Touch Down Zone   8 inch   White   CAT III   With heating   No special options   No fail-open   6.6 A
213.641-447	MHG-RCL-8-1xW-CAT3-00-FO-0	LED module   Runway Centerline / Touch Down Zone   8 inch   White   CAT III   No heating   No special options   With fail-open   6.6 A
203.547-017	MHG-RCL-8-1xW-CAT3-01-FO-0	LED module   Runway Centerline / Touch Down Zone   8 inch   White   CAT III   No heating   With overheat protection   With fail-open   6.6 A
213.641-897	MHG-RCL-8-1xW-CAT3-10-FO-0	LED module   Runway Centerline / Touch Down Zone   8 inch   White   CAT III   With heating   No special options   With fail-open   6.6 A
190.777-017	MHG-RCL-8-1xR-CAT3-00-0	LED module   Runway Centerline   8 inch   Red   CAT III   No heating   No special options   No fail-open   6.6 A
213.641-817	MHG-RCL-8-1xR-CAT3-10-0-0	LED module   Runway Centerline   8 inch   Red   CAT III   With heating   No special options   No fail-open   6.6 A
213.641-307	MHG-RCL-8-1xR-CAT3-00-FO-0	LED module   Runway Centerline   8 inch   Red   CAT III   No heating   No special options   With fail-open   6.6 A
203.547-007	MHG-RCL-8-1xR-CAT3-01-FO-0	LED module   Runway Centerline   8 inch   Red   CAT III   No heating   With overheat protection   With fail-open   6.6 A
213.641-907	MHG-RCL-8-1xR-CAT3-10-FO-0	LED module   Runway Centerline   8 inch   Red   CAT III   With heating   No special options   With fail-open   6.6 A
216.100-007	MHG-L850A-8-1xW-CAT3-00-0-0	LED module   L-850A   8 inch   White   CAT III   No heating   No special options   No fail-open   6.6 A
216.100-017	MHG-L850A-8-1xR-CAT3-00-0-0	LED module   L-850A   8 inch   Red   CAT III   No heating   No special options   No fail-open   6.6 A
190.775-007	Prism incl gasket	Borosilicate prism incl gasket   for uni-/bi-directional inset lights
190.775-017	Sapphire prism incl gasket	Sapphire prism incl gasket   for uni-/bi-directional inset lights

<b>Touch Down Zone / L-850B</b>		
180.912-05	Cover 8" uni straight	Cover for 8" inset fixture   unidirectional   straight
180.912-16	Cover TDZ 8" uni right	Cover for 8" inset fixture   Touch Down Zone / L-850B   unidirectional   right
180.912-17	Cover TDZ 8" uni left	Cover for 8" inset fixture   Touch Down Zone / L-850B   unidirectional   left
190.774-107	EHG-20W-0-1x250mm-P1-8-0	Electronic Housing Group   20 W   1 cable 250 mm   standard FAA plug   8 inch   No fail-open
190.774-607	EHG-20W-0-1x250mm-P1-8-FO	Electronic Housing Group   20 W   1 cable 250 mm   standard FAA plug   8 inch   With fail-open (relay)
190.777-467	MHG-RCL-8-1xW-CAT3-00-0	LED module   Runway Centerline / Touch Down Zone   8 inch   White   CAT III   No heating   No special options   No fail-open   6.6 A
213.641-437	MHG-RCL-8-1xW-CAT3-10-0-0	LED module   Runway Centerline / Touch Down Zone   8 inch   White   CAT III   With heating   No special options   No fail-open   6.6 A
213.641-447	MHG-RCL-8-1xW-CAT3-00-FO-0	LED module   Runway Centerline / Touch Down Zone   8 inch   White   CAT III   No heating   No special options   With fail-open   6.6 A
203.547-017	MHG-RCL-8-1xW-CAT3-01-FO-0	LED module   Runway Centerline / Touch Down Zone   8 inch   White   CAT III   No heating   With overheat protection   With fail-open   6.6 A
213.641-897	MHG-RCL-8-1xW-CAT3-10-FO-0	LED module   Runway Centerline / Touch Down Zone   8 inch   White   CAT III   With heating   No special options   With fail-open   6.6 A
216.100-027	MHG-L850B-8-1xW-CAT3-00-0-0	LED module   L-850B   8 inch   White   CAT III   No heating   No special options   No fail-open   6.6 A
190.775-007	Prism incl gasket	Borosilicate prism incl gasket   for uni-/bi-directional inset lights
190.775-017	Sapphire prism incl gasket	Sapphire prism incl gasket   for uni-/bi-directional inset lights

<b>Runway Guard / L-852G</b>		
181.051-02	Cover RWG/L-852G/RETIL/RETL800 8" uni	Cover for 8" fixture   Runway Guard / L-852G / Rapid Exit Taxiway Indicator / Rapid Exit Taxiway 800cd   unidirectional   straight
190.774-267	EHG-40W-0-1x250mm-P1-8-0	Electronic Housing Group   40 W   1 cable 250 mm   standard FAA plug   8 inch   No fail-open
190.774-767	EHG-40W-0-1x250mm-P1-8-FO	Electronic Housing Group   40 W   1 cable 250 mm   standard FAA plug   8 inch   With fail-open (relay)
190.777-477	MHG-RWGs-8-1xY-CAT3-00-0	LED module   Runway Guard   8 inch   Yellow   CAT III   No heating   No special options   No fail-open   6.6 A
	MHG-RWGs-8-1xY-CAT3-00-FO-0	LED module   Runway Guard   8 inch   Yellow   CAT III   No heating   No special options   With fail-open   6.6 A
203.547-047	MHG-RWGs-8-1xY-CAT3-01-FO-0	LED module   Runway Guard   8 inch   Yellow   CAT III   No heating   With overheat protection   With fail-open   6.6 A
216.160-007	MHG-L852G-8-1xY-CAT3-00-0	LED module   L-852G   8 inch   Yellow   CAT III   No heating   No special options   No fail-open   6.6 A
190.775-007	Prism incl gasket	Borosilicate prism incl gasket   for uni-/bi-directional inset lights
190.775-017	Sapphire prism incl gasket	Sapphire prism incl gasket   for uni-/bi-directional inset lights

<b>Rapid Exit Taxiway Indicator</b>		
181.051-02	Cover RWG/RETIL/RETL800 8" uni	Cover for 8" fixture   Runway Guard / Rapid Exit Taxiway Indicator / Rapid Exit Taxiway 800cd   unidirectional   straight
190.774-267	EHG-40W-0-1x250mm-P1-8-0	Electronic Housing Group   40 W   1 cable 250 mm   standard FAA plug   8 inch   No fail-open
190.774-767	EHG-40W-0-1x250mm-P1-8-FO	Electronic Housing Group   40 W   1 cable 250 mm   standard FAA plug   8 inch   With fail-open (relay)
190.777-037	MHG-RETIL-8-1xY-CAT3-00-0	LED module   Rapid Taxiway Indicator   8 inch   Yellow   CAT III   No heating   No special options   No fail-open   6.6 A

213.641-807	MHG-RETIL-8-1xY-CAT3-00-FO-0	LED module   Rapid Taxiway Indicator   8 inch   Yellow   CAT III   No heating   No special options   With fail-open   6.6 A
203.547-027	MHG-RETIL-8-1xY-CAT3-01-FO-0	LED module   Rapid Taxiway Indicator   8 inch   Yellow   CAT III   No heating   With overheat protection   With fail-open   6.6 A
190.775-007	Prism incl gasket	Borosilicate prism incl gasket   for uni-/bi-directional inset lights
190.775-017	Sapphire prism incl gasket	Sapphire prism incl gasket   for uni-/bi-directional inset lights

#### Rapid Exit Taxiway 800 cd

181.051-02	Cover RWG/RETIL/RETL800 8" uni	Cover for 8" fixture   Runway Guard / Rapid Exit Taxiway Indicator / Rapid Exit Taxiway 800cd   unidirectional   straight
230.145-01	Cover RETLC800 8" uni left	Cover for 8" fixture   Rapid Exit Taxiway Centerline 800 cd   unidirectional   left
230.145-02	Cover RETLC800 8" uni right	Cover for 8" fixture   Rapid Exit Taxiway Centerline 800 cd   unidirectional   right
190.774-267	EHG-40W-0-1x250mm-P1-8-0	Electronic Housing Group   40 W   1 cable 250 mm   standard FAA plug   8 inch   No fail-open
190.774-767	EHG-40W-0-1x250mm-P1-8-FO	Electronic Housing Group   40 W   1 cable 250 mm   standard FAA plug   8 inch   With fail-open (relay)
213.641-747	MHG-RETL800-8-1xY-CAT3-00-FO-0	LED module   Rapid Exit Taxiway Centerline 800 cd   8 inch   Yellow   CAT III   No heating   No special options   With fail-open   6.6 A
213.641-757	MHG-RETL800-8-1xG-CAT3-00-FO-0	LED module   Rapid Exit Taxiway Centerline 800 cd   8 inch   Green   CAT III   No heating   No special options   With fail-open   6.6 A
213.641-727	MHG-RETL800-8-1xY-CAT3-00-FO-0	LED module   Rapid Exit Taxiway Centerline Curved 800 cd   8 inch   Yellow   CAT III   No heating   No special options   With fail-open   6.6 A
213.641-737	MHG-RETL800-8-1xG-CAT3-00-FO-0	LED module   Rapid Exit Taxiway Centerline Curved 800 cd   8 inch   Green   CAT III   No heating   No special options   With fail-open   6.6 A
190.775-007	Prism incl gasket	Borosilicate prism incl gasket   for uni-/bi-directional inset lights
190.775-017	Sapphire prism incl gasket	Sapphire prism incl gasket   for uni-/bi-directional inset lights

#### Taxiway Centreline / L-852A / L-852B / L-852C / L-852D / L-852J / L-852K

180.912-05	Cover 8" uni straight	Cover for 8" inset fixture   unidirectional   straight
180.912-13	Cover 8" uni straight flat	Cover for 8" inset fixture   unidirectional   straight   flat cover
180.912-02	Cover 8" bi straight	Cover for 8" inset fixture   bidirectional   straight
180.912-08	Cover 8" bi straight flat	Cover for 8" inset fixture   bidirectional   straight   flat cover
186.136-22	Cover TCC/L-852J/K 8" uni left	Cover for 8" inset fixture   Taxiway Centerline Curved / L-852J / L-852K   unidirectional   left
186.136-32	Cover TCC/L-852J/K 8" uni right	Cover for 8" inset fixture   Taxiway Centerline Curved / L-852J / L-852K   unidirectional   right
186.136-02	Cover TCC/L-852J/K 8" bi left	Cover for 8" inset fixture   Taxiway Centerline Curved / L-852J / L-852K   bidirectional   left
186.136-12	Cover TCC/L-852J/K 8" bi right	Cover for 8" inset fixture   Taxiway Centerline Curved / L-852J / L-852K   bidirectional   right
190.774-107	EHG-20W-0-1x250mm-P1-8-0	Electronic Housing Group   20 W   1 cable 250 mm   standard FAA plug   8 inch   No fail-open
190.774-607	EHG-20W-0-1x250mm-P1-8-FO	Electronic Housing Group   20 W   1 cable 250 mm   standard FAA plug   8 inch   With fail-open (relay)
190.774-087	EHG-20W-20W-1x250mm-P1-8-0	Electronic Housing Group   20 W / 20 W   1 cable 250 mm   standard FAA plug   8 inch   No fail-open
190.774-587	EHG-20W-20W-1x250mm-P1-8-FO	Electronic Housing Group   20 W / 20 W   1 cable 250 mm   standard FAA plug   8 inch   With fail-open (relay)

190.774-067	EHG-20W-20W-2x250mm-P1-8-0	Electronic Housing Group   20 W / 20 W   2 cables 250 mm   standard FAA plug   8 inch   No fail-open
190.774-567	EHG-20W-20W-2x250mm-P1-8-FO	Electronic Housing Group   20 W / 20 W   2 cables 250 mm   standard FAA plug   8 inch   With fail-open (relay)
190.777-067	MHG-TCL-8-1xG-CAT3-00-0	LED module   Taxiway Centerline   8 inch   Green   CAT III   No heating   No special options   No fail-open   6.6 A
213.641-857	MHG-TCL-8-1xG-CAT3-00-FO-0	LED module   Taxiway Centerline   8 inch   Green   CAT III   No heating   No special options   With fail-open   6.6 A
203.547-137	MHG-TCL-8-1xG-CAT3-01-FO-0	LED module   Taxiway Centerline   8 inch   Green   CAT III   No heating   With overheat protection   With fail-open   6.6 A
190.777-587	MHG-TCL-8-1xG-CAT3-10-0-0	LED module   Taxiway Centerline   8 inch   Green   CAT III   With heating   No special options   No fail-open   6.6 A
213.641-517	MHG-TCL-8-1xG-CAT3-10-FO-0	LED module   Taxiway Centerline   8 inch   Green   CAT III   With heating   No special options   With fail-open   6.6 A
190.777-427	MHG-TCL-8-1xY-CAT3-00-0	LED module   Taxiway Centerline / Intermediate Holding Position   8 inch   Yellow   CAT III   No heating   No special options   No fail-open   6.6 A
213.641-867	MHG-TCL-8-1xY-CAT3-00-FO-0	LED module   Taxiway Centerline / Intermediate Holding Position   8 inch   Yellow   CAT III   No heating   No special options   With fail-open   6.6 A
	MHG-TCL-8-1xY-CAT3-01-FO-0	LED module   Taxiway Centerline / Intermediate Holding Position   8 inch   Yellow   CAT III   No heating   With overheat protection   With fail-open   6.6 A
190.777-107	MHG-TCL-8-1xB-CAT3-00-0	LED module   Taxiway Centerline   8 inch   Blue   CAT III   No heating   No special options   No fail-open   6.6 A
213.641-497	MHG-TCL-8-1xB-CAT3-00-FO-0	LED module   Taxiway Centerline   8 inch   Blue   CAT III   No heating   No special options   With fail-open   6.6 A
213.641-507	MHG-TCL-8-1xB-CAT3-10-FO-0	LED module   Taxiway Centerline   8 inch   Blue   CAT III   With heating   No special options   With fail-open   6.6 A
190.777-147	MHG-TCC-8-1xG-CAT3-00-0	LED module   Taxiway Centerline Curved   8 inch   Green   CAT III   No heating   No special options   No fail-open   6.6 A
213.641-847	MHG-TCC-8-1xG-CAT3-00-FO-0	LED module   Taxiway Centerline Curved   8 inch   Green   CAT III   No heating   No special options   With fail-open   6.6 A
203.547-147	MHG-TCC-8-1xG-CAT3-01-FO-0	LED module   Taxiway Centerline Curved   8 inch   Green   CAT III   No heating   With overheat protection   With fail-open   6.6 A
213.641-417	MHG-TCC-8-1xG-CAT3-10-FO-0	LED module   Taxiway Centerline Curved   8 inch   Green   CAT III   With heating   No special options   With fail-open   6.6 A
190.777-447	MHG-TCC-8-1xY-CAT3-00-0	LED module   Taxiway Centerline Curved   8 inch   Yellow   CAT III   No heating   No special options   No fail-open   6.6 A
213.641-007	MHG-TCC-8-1xY-CAT3-00-FO-0	LED module   Taxiway Centerline Curved   8 inch   Yellow   CAT III   No heating   No special options   With fail-open   6.6 A
213.641-397	MHG-TCC-8-1xY-CAT3-10-0-0	LED module   Taxiway Centerline Curved   8 inch   Yellow   CAT III   With heating   No special options   No fail-open   6.6 A
213.641-537	MHG-TCC-8-1xY-CAT3-10-FO-0	LED module   Taxiway Centerline Curved   8 inch   Yellow   CAT III   With heating   No special options   With fail-open   6.6 A
190.777-167	MHG-TCC-8-1xR-CAT3-00-0	LED module   Taxiway Centerline Curved   8 inch   Red   CAT III   No heating   No special options   No fail-open   6.6 A
190.777-727	MHG-TCC-8-1xR-CAT3-10-0-0	LED module   Taxiway Centerline Curved   8 inch   Red   CAT III   With heating   No special options   No fail-open   6.6 A
190.777-187	MHG-TCC-8-1xB-CAT3-00-0	LED module   Taxiway Centerline Curved   8 inch   Blue   CAT III   No heating   No special options   No fail-open   6.6 A
213.641-467	MHG-TCC-8-1xB-CAT3-00-FO-0	LED module   Taxiway Centerline Curved   8 inch   Blue   CAT III   No heating   No special options   With fail-open   6.6 A
213.641-527	MHG-TCC-8-1xB-CAT3-10-FO-0	LED module   Taxiway Centerline Curved   8 inch   Blue   CAT III   With heating   No special options   With fail-open   6.6 A
216.150-007	MHG-L852A-8-1xG-CAT3-00-0-0	LED module   L-852A   8 inch   Green   CAT III   No heating   No special options   No fail-open   6.6 A
216.150-017	MHG-L852A-8-1xY-CAT3-00-0-0	LED module   L-852A   8 inch   Yellow   CAT III   No heating   No special options   No fail-open   6.6 A
216.151-007	MHG-L852B-8-1xG-CAT3-00-0-0	LED module   L-852B   8 inch   Green   CAT III   No heating   No special options   No fail-open   6.6 A

216.151-017	MHG-L852B-8-1xY-CAT3-00-0-0	LED module   L-852B   8 inch   Yellow   CAT III   No heating   No special options   No fail-open   6.6 A
216.152-007	MHG-L852C-8-1xG-CAT3-00-0-0	LED module   L-852C   8 inch   Green   CAT III   No heating   No special options   No fail-open   6.6 A
216.152-017	MHG-L852C-8-1xY-CAT3-00-0-0	LED module   L-852C   8 inch   Yellow   CAT III   No heating   No special options   No fail-open   6.6 A
216.153-007	MHG-L852D-8-1xG-CAT3-00-0-0	LED module   L-852D   8 inch   Green   CAT III   No heating   No special options   No fail-open   6.6 A
216.153-017	MHG-L852D-8-1xY-CAT3-00-0-0	LED module   L-852D   8 inch   Yellow   CAT III   No heating   No special options   No fail-open   6.6 A
216.154-007	MHG-L852J-8-1xG-CAT3-00-0-0	LED module   L-852J   8 inch   Green   CAT III   No heating   No special options   No fail-open   6.6 A
216.154-017	MHG-L852J-8-1xY-CAT3-00-0-0	LED module   L-852J   8 inch   Yellow   CAT III   No heating   No special options   No fail-open   6.6 A
216.155-007	MHG-L852K-8-1xG-CAT3-00-0-0	LED module   L-852K   8 inch   Green   CAT III   No heating   No special options   No fail-open   6.6 A
216.155-017	MHG-L852K-8-1xY-CAT3-00-0-0	LED module   L-852K   8 inch   Yellow   CAT III   No heating   No special options   No fail-open   6.6 A
190.775-007	Prism incl gasket	Borosilicate prism incl gasket   for uni-/bi-directional inset lights
190.775-017	Sapphire prism incl gasket	Sapphire prism incl gasket   for uni-/bi-directional inset lights

#### Intermediate Holding Position

180.912-05	Cover 8" uni straight	Cover for 8" inset fixture   unidirectional   straight
180.912-02	Cover 8" bi straight	Cover for 8" inset fixture   bidirectional   straight
190.774-107	EHG-20W-0-1x250mm-P1-8-0	Electronic Housing Group   20 W   1 cable 250 mm   standard FAA plug   8 inch   No fail-open
190.774-607	EHG-20W-0-1x250mm-P1-8-FO	Electronic Housing Group   20 W   1 cable 250 mm   standard FAA plug   8 inch   With fail-open (relay)
190.777-427	MHG-TCL-8-1xY-CAT3-00-0	LED module   Taxiway Centerline / Intermediate Holding Position   8 inch   Yellow   CAT III   No heating   No special options   No fail-open   6.6 A
213.641-867	MHG-TCL-8-1xY-CAT3-00-FO-0	LED module   Taxiway Centerline / Intermediate Holding Position   8 inch   Yellow   CAT III   No heating   No special options   With fail-open   6.6 A
	MHG-TCL-8-1xY-CAT3-01-FO-0	LED module   Taxiway Centerline / Intermediate Holding Position   8 inch   Yellow   CAT III   No heating   With overheat protection   With fail-open   6.6 A
190.775-007	Prism incl gasket	Borosilicate prism incl gasket   for uni-/bi-directional inset lights
190.775-017	Sapphire prism incl gasket	Sapphire prism incl gasket   for uni-/bi-directional inset lights

#### Stop Bar / L-852S

180.912-05	Cover 8" uni straight	Cover for 8" inset fixture   unidirectional   straight
180.912-02	Cover 8" bi straight	Cover for 8" inset fixture   bidirectional   straight
190.774-107	EHG-20W-0-1x250mm-P1-8-0	Electronic Housing Group   20 W   1 cable 250 mm   standard FAA plug   8 inch   No fail-open
190.774-607	EHG-20W-0-1x250mm-P1-8-FO	Electronic Housing Group   20 W   1 cable 250 mm   standard FAA plug   8 inch   With fail-open (relay)
190.774-087	EHG-20W-20W-1x250mm-P1-8-0	Electronic Housing Group   20 W / 20 W   1 cable 250 mm   standard FAA plug   8 inch   No fail-open
190.774-587	EHG-20W-20W-1x250mm-P1-8-FO	Electronic Housing Group   20 W / 20 W   1 cable 250 mm   standard FAA plug   8 inch   With fail-open (relay)
190.774-067	EHG-20W-20W-2x250mm-P1-8-0	Electronic Housing Group   20 W / 20 W   2 cables 250 mm   standard FAA plug   8 inch   No fail-open

190.774-567	EHG-20W-20W-2x250mm-P1-8-FO	Electronic Housing Group   20 W / 20 W   2 cables 250 mm   standard FAA plug   8 inch   With fail-open (relay)
190.777-087	MHG-TCL-8-1xR-CAT3-00-0	LED module   Stop Bar   8 inch   Red   CAT III   No heating   No special options   No fail-open   6.6 A
213.641-887	MHG-STB-8-1xR-CAT3-00-FO-0	LED module   Stop Bar   8 inch   Red   CAT III   No heating   No special options   With fail-open   6.6 A
203.547-127	MHG-STB-8-1xR-CAT3-01-FO-0-V2	LED module   Stop Bar   8 inch   Red   CAT III   No heating   With overheat protection   With fail-open   6.6 A   New version
213.641-407	MHG-STB-8-1xR-CAT3-10-FO-0	LED module   Stop Bar   8 inch   Red   CAT III   With heating   No special options   With fail-open   6.6 A
216.170-007	MHG-L852S-8-1xR-CAT3-00-0	LED module   L-852S   8 inch   Red   CAT III   No heating   No special options   No fail-open   6.6 A
190.775-007	Prism incl gasket	Borosilicate prism incl gasket   for uni-/bi-directional inset lights
190.775-017	Sapphire prism incl gasket	Sapphire prism incl gasket   for uni-/bi-directional inset lights

#### Take-off and Hold

180.912-05	Cover 8" uni straight	Cover for 8" inset fixture   unidirectional   straight
190.774-107	EHG-20W-0-1x250mm-P1-8-0	Electronic Housing Group   20 W   1 cable 250 mm   standard FAA plug   8 inch   No fail-open
190.774-607	EHG-20W-0-1x250mm-P1-8-FO	Electronic Housing Group   20 W   1 cable 250 mm   standard FAA plug   8 inch   With fail-open (relay)
213.641-767	MHG-THL-8-1xR-CAT3-00-FO-0	LED module   Take-off and Hold   8 inch   Red   CAT III   No heating   No special options   With fail-open   6.6 A
190.775-007	Prism incl gasket	Borosilicate prism incl gasket   for uni-/bi-directional inset lights
190.775-017	Sapphire prism incl gasket	Sapphire prism incl gasket   for uni-/bi-directional inset lights

#### Runway Entrance

180.912-05	Cover 8" uni straight	Cover for 8" inset fixture   unidirectional   straight
190.774-107	EHG-20W-0-1x250mm-P1-8-0	Electronic Housing Group   20 W   1 cable 250 mm   standard FAA plug   8 inch   No fail-open
190.774-607	EHG-20W-0-1x250mm-P1-8-FO	Electronic Housing Group   20 W   1 cable 250 mm   standard FAA plug   8 inch   With fail-open (relay)
213.641-777	MHG-REL-8-1xR-CAT3-00-FO-0	LED module   Runway Entrance   8 inch   Red   CAT III   No heating   No special options   With fail-open   6.6 A
190.775-007	Prism incl gasket	Borosilicate prism incl gasket   for uni-/bi-directional inset lights
190.775-017	Sapphire prism incl gasket	Sapphire prism incl gasket   for uni-/bi-directional inset lights

#### Omnidirectional / L-852E / L-852T

204.784-01	Cover 8" omni	Cover for 8" inset fixture   omnidirectional
190.774-107	EHG-20W-0-1x250mm-P1-8-0	Electronic Housing Group   20 W   1 cable 250 mm   standard FAA plug   8 inch   No fail-open
190.774-607	EHG-20W-0-1x250mm-P1-8-FO	Electronic Housing Group   20 W   1 cable 250 mm   standard FAA plug   8 inch   With fail-open (relay)
211.060-007	MHG-TXE-8-1xB-CAT3-00-0	LED module   Taxiway Edge Omnidirectional   8 inch   Blue   CAT III   No heating   No special options   No fail-open   6.6 A
211.060-017	MHG-TXE-8-1xB-CAT3-00-FO-0	LED module   Taxiway Edge Omnidirectional   8 inch   Blue   CAT III   No heating   No special options   With fail-open   6.6 A

211.060-037	MHG-TXO-8-1xY-CAT3-00-0	LED module   Taxiway Omnidirectional   8 inch   Yellow   CAT III   No heating   No special options   No fail-open   6.6 A
211.060-167	MHG-SMGL60-8-1xY-CAT3-00-FO-0	LED module   Stand Manoeuvring Guidance 60 cd omnidirectional   8 inch   Yellow   CAT III   No heating   No special options   With fail-open   6.6 A
	MHG-SMGL60-8-1xY-CAT3-01-FO-0	LED module   Stand Manoeuvring Guidance 60 cd omnidirectional   8 inch   Yellow   CAT III   No heating   With overheat protection   With fail-open   6.6 A
216.140-017	MHG-L852E-8-1xY-CAT3-00-0	LED module   L-852E   8 inch   Yellow   CAT III   No heating   No special options   No fail-open   6.6 A
216.140-007	MHG-L852T-8-1xB-CAT3-00-0-0	LED module   L-852T   8 inch   Blue   CAT III   No heating   No special options   No fail-open   6.6 A
211.061-007	Omni prism incl gasket	Prism incl gasket   for omnidirectional inset lights



**More information:**

**TKH Airport Solutions**  
sales@tkh-airportsolutions.com  
www.tkh-airportsolutions.com  
+31 (0)53 57 414 56

**Visiting address**

**TKH Airport Solutions**  
Elektrostraat 17  
7483 PG Haaksbergen  
The Netherlands

---

 A TKH TECHNOLOGY COMPANY <