



# Thunder Sky Winston

公司地址：福建省漳州市长泰经济开发区兴泰工业园区  
 (长泰) TEL: 0596-8186789 Fax: 0596-8186678  
 (深圳) TEL: 0755-86026789 Fax: 0755-86026678  
 技术服务部 :Service Email:service@winston-battery.com  
 http://www.thundersky-winston.com  
 Email: winston@winston-battery.com

## 雷天温斯顿储能类“水性锂钪动力电池”性能说明

THUNDER SKY WINSTON ENERGY STORAGE TYPE "WATER-BASED LITHIUM YTTRIUM POWER BATTERY" PERFORMANCE SPECIFICATION

### 单体电池尺寸 DIMENSIONS



型号 (MODEL) : TSWB-LYP100AHA-B

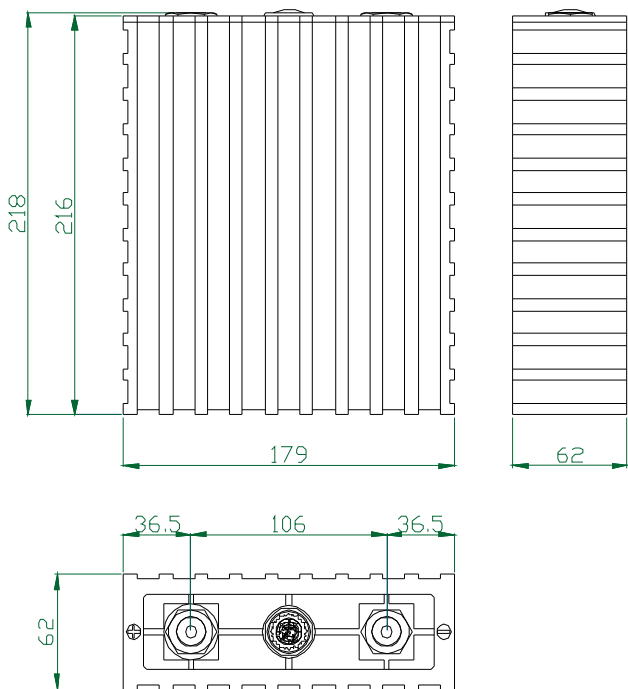

### 技术参数 SPECIFICATIONS

型号 (MODEL)	TSWB-LYP100AHA-B	
标称容量 Nominal Capacity	100AH	
规格 SPEC	长 L	179mm
	宽 W	62mm
	高 H	218mm
工作电压 Operation Voltage	充电 Charge	4.0(V)
	放电 Discharge	2.8(V)
内阻 Internal resistance	≤0.45(mΩ)	
最大放电电流 Max Discharge Current	恒电流 Constant Current	≤3CA
	脉冲试 Impulse Current	≤10CA
标准充放电电流 Standard Charge/Discharge Current	50A(0.5CA)	
循环寿命 Cycle Life	(80%DOD)	≥5000Times
	(70%DOD)	≥7000Times
壳体耐温性 Temperature Durability Of Case	≤200°C	
适应环境 Operating Temperature	充电 Charge	-45°C~85°C
	放电 Discharge	
	存储湿度 Storage Humidity	≤75%RH
自放电率 (月) Self-discharge Rate	≤1% (月/Monthly)	
单体电池重量 Weight	3.6kg±100g	

# TSWB-LYP100AHA-B型电池的充放电特性

## TSWB-LYP100AHA-B CHARGE&DISCHARGE CHART

### 不同环境温度下LYP类电池的放电特性曲线

Discharge characteristic curve of LYP type battery under different ambient temperature

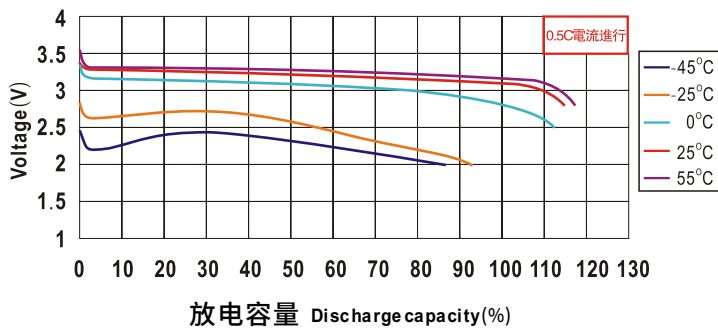

### 常温下LYP类电池的放电特性曲线

Discharge characteristic curve of LYP type battery under normal temperature

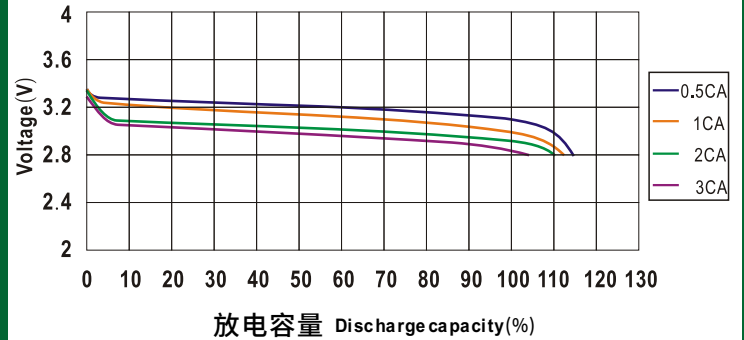

### 常温下LYP类电池的充电特性曲线

Charge characteristic curve of LYP type battery under normal temperature

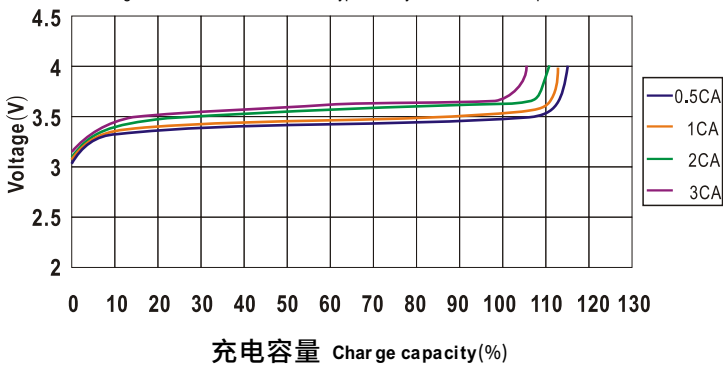

### 在常温下LYP类电池的存储特性曲线

Storage characteristic curve of LYP type battery under normal temperature

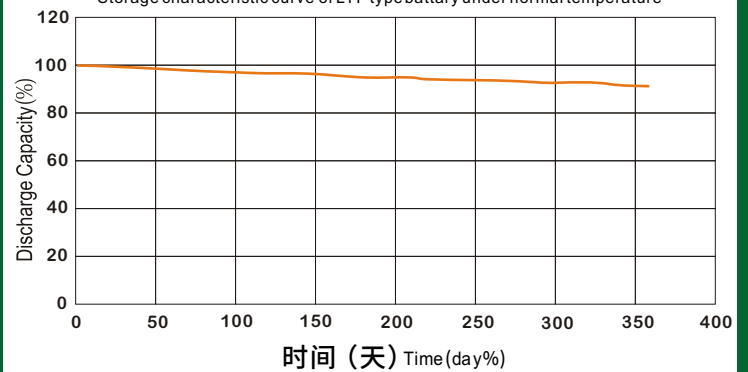



# Winston Battery

Address: Winston Industrial Park, Third Industrial Zone, Lisonglang Village,  
Gongming Town, Shenzhen, Guangdong, P.R.C  
Tel: +86-755-8602 6789 Fax: +86-755-8602 6678  
Http: //www.winston-battery.com E-mail: winston@winston-battery.com

## 温斯顿牌稀土锂钇动力电池性能说明 SPECIFICATION FOR WINSTON RARE EARTH LITHIUM YTTRIUM POWER BATTERY

### 單體電池尺寸 DIMENSIONS

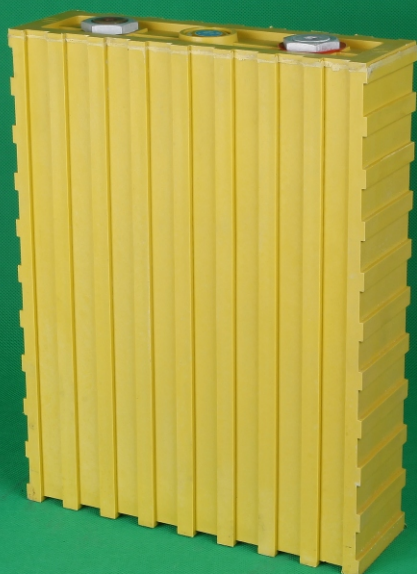

型号(MODEL): WB-LYP160AHA

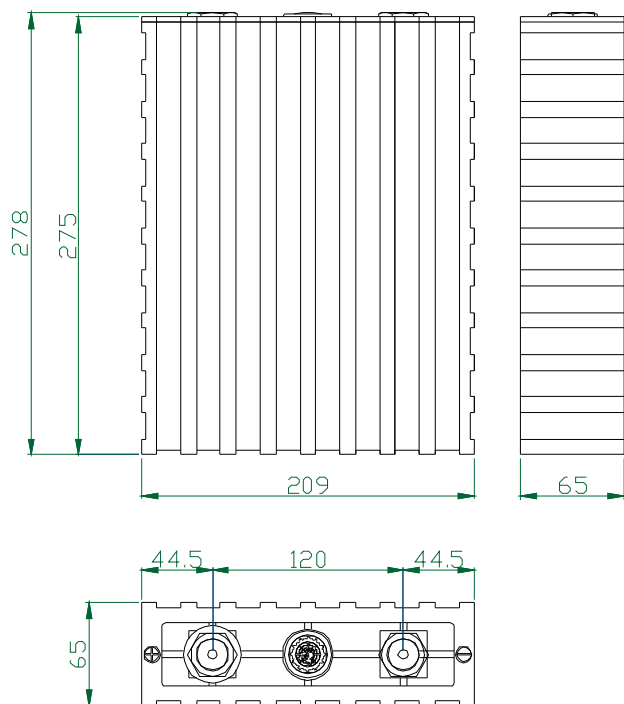

### 技術參數 SPECIFICATIONS

型號(MODEL)	WB-LYP160AHA(B)	
標稱容量 Nominal Capacity	160AH	
規格 SPEC	長 L	209mm
	寬 W	65mm
	高 H	278mm
工作電壓 Operation Voltage	充電 Charge	4.0(V)
	放電 Discharge	2.8(V)
內阻 Internal resistance	≤0.4(mΩ)	
最大放電電流 Max Discharge Current	恒電流 Constant Current	≤3CA
	脈衝試 Impulse Current	≤10CA
最大充電電流 Max Charge Current	480A(3CA)	
標準充放電電流 Standard Charge/ Discharge Current	80A(0.5CA)	
循環壽命 Cycle Life	(80%DOD)	≥5000Times
	(70%DOD)	≥7000Times
殼體耐溫性 Temperature Durability Of Case	≤200°C	
適應環境 Operationg Temperature	充電 Charge	-45°C ~ 85°C
	放電 Discharge	
	存儲濕度 Storage Humidity	≤75%RH
自放電率(月) Self-discharge Rate	≤3% (月/Monthly)	
單體電池重量 Weight	5.7kg ± 150g	

# WB-LYP160AHA型電池的充放電特性

## WB-LYP160AHA CHARGE & DISCHARGE CHART

常溫下LYP類電池的放電特性曲線  
LYP battery's discharge curve under normal temperature

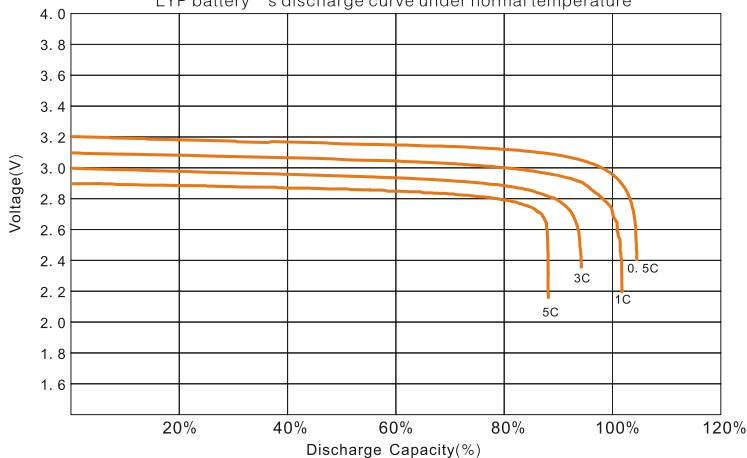

常溫下LYP類電池的循環充放電特性曲線  
LYP battery's circulation charging and discharging curve under normal temperature

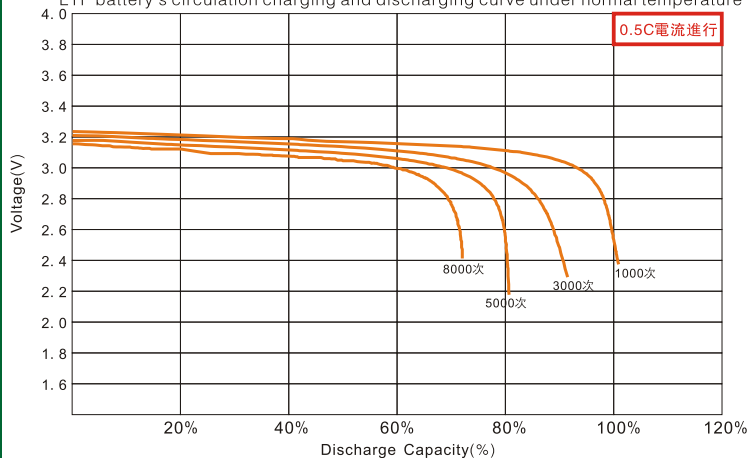

不同環境溫度下LYP類電池的放電特性曲線  
LYP battery's discharge curve under different temperatures

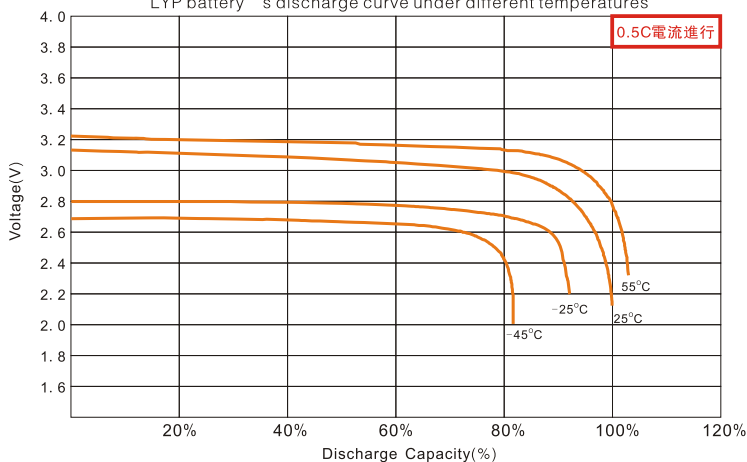

在常溫環境下LYP類電池的存儲特性曲線  
LYP battery's storage characteristic curve in normal temperature

