



GMK REVISION

PRODUCT CATALOGUE

Last Update: May 23, 2022

The devices described in this catalogue are not available in all the Countries in which Medacta operates. Please verify approval of the devices with your local Medacta representative.
All information embedded in this document is strictly confidential and should not be disclosed to third parties.

GMK[®] REVISION

GLOBAL MEDACTA KNEE



FEMORAL COMPONENT

REVISION PS FEMORAL COMPONENT

MATERIAL: Co-Cr-Mo (ISO 5832-4)

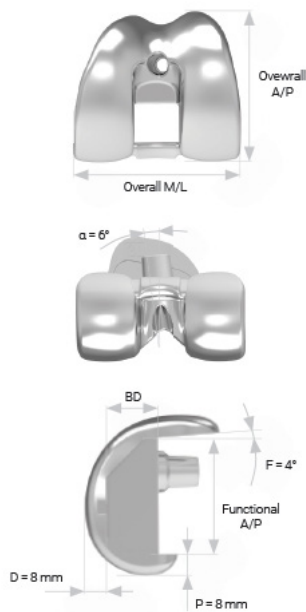

Size	Ref. L	Ref. R	Overall A/P (mm)	Functional A/P (mm)	Overall M/L (mm)	BD (mm)
1	02.07.2401L	02.07.2401R	54	38	60	18
2	02.07.2402L	02.07.2402R	58	41.5	64	18
3	02.07.2403L	02.07.2403R	62	45	68	20
4	02.07.2404L	02.07.2404R	66	48.5	72	20
5	02.07.2405L	02.07.2405R	70	52	76	22
6	02.07.2406L	02.07.2406R	74	55	80	22

FEMORAL COMPONENT REVISION PS - SensiTiN COATED

MATERIAL: Co-Cr-Mo (ISO 5832-4) + TiNbN coating

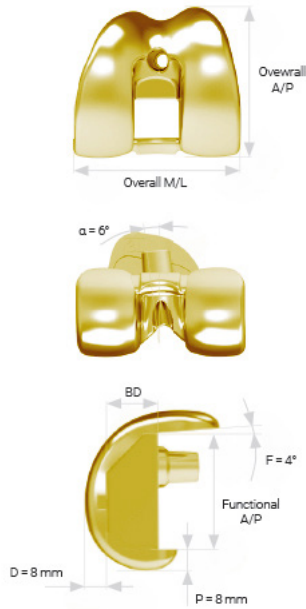

Size	Ref. L	Ref. R	Overall A/P (mm)	Functional A/P (mm)	Overall M/L (mm)	BD (mm)
1	02.07.4401L*	02.07.4401R*	54	38	60	18
2	02.07.4402L	02.07.4402R	58	41.5	64	18
3	02.07.4403L	02.07.4403R	62	45	68	20
4	02.07.4404L	02.07.4404R	66	48.5	72	20
5	02.07.4405L	02.07.4405R	70	52	76	22
6	02.07.4406L*	02.07.4406R*	74	55	80	22

*Not available yet

TIBIAL BASEPLATE

REVISION TIBIAL COMPONENT

MATERIAL: Co-Cr-Mo (ISO 5832-4)

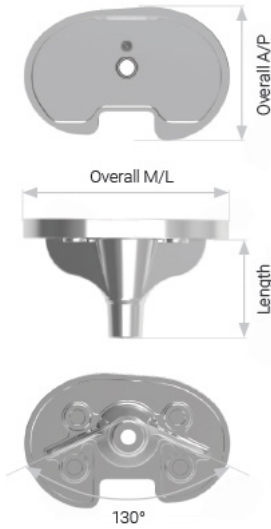

Size	Ref. L	Ref. R	Overall M/L (mm)	Overall A/P (mm)	Overall M/L (mm)
1	02.07.0681L	02.07.0681R	60	40	34
2	02.07.0682L	02.07.0682R	65	43	34
3	02.07.0683L	02.07.0683R	70	46	34
4	02.07.0684L	02.07.0684R	75	50	34
5	02.07.0685L	02.07.0685R	80	53	34
6	02.07.0686L	02.07.0686R	87	58	34

TIBIAL TRAY REVISION - SensiTIN COATED

MATERIAL: Co-Cr-Mo (ISO 5832-4) + TiNbN coating

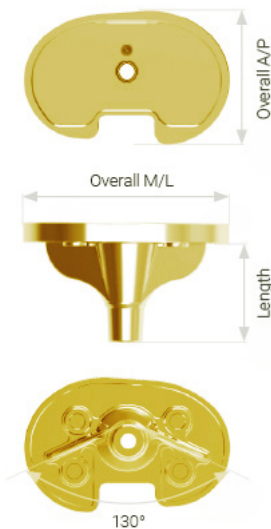

Size	Ref. L	Ref. R	Overall M/L (mm)	Overall A/P (mm)	Overall M/L (mm)
1	02.07.4681L*	02.07.4681R*	60	40	34
2	02.07.4682L	02.07.4682R	65	43	34
3	02.07.4683L	02.07.4683R	70	46	34
4	02.07.4684L	02.07.4684R	75	50	34
5	02.07.4685L	02.07.4685R	80	53	34
6	02.07.4686L*	02.07.4686R*	87	58	34

*Not available yet

INSERT

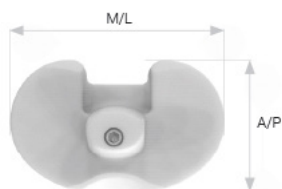
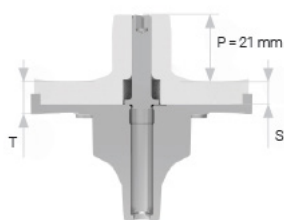

MATERIALS:

Insert: UHMWPE (ISO 5834-2 Type 1)

Semi-constrained Peg: Co-Cr-Mo (ISO 5832-12)

SIZE 1				
Reference SC	S (mm)	T (mm)	M/L (mm)	A/P (mm)
02.07.0110SCF	7	10	59	34
02.07.0112SCF	9	12	59	34
02.07.0114SCF	11	14	59	34
02.07.0117SCF	14	17	59	34
02.07.0120SCF	17	20	59	34
02.07.0123SCF	20	23	59	34
02.07.0126SCF	23	26	59	34

SIZE 2				
Reference	S (mm)	T (mm)	M/L (mm)	A/P (mm)
02.07.0210SCF	7	10	64	38
02.07.0212SCF	9	12	64	38
02.07.0214SCF	11	14	64	38
02.07.0217SCF	14	17	64	38
02.07.0220SCF	17	20	64	38
02.07.0223SCF	20	23	64	38
02.07.0226SCF	23	26	64	38

SIZE 3				
Reference	S (mm)	T (mm)	M/L (mm)	A/P (mm)
02.07.0310SCF	7	10	68	41
02.07.0312SCF	9	12	68	41
02.07.0314SCF	11	14	68	41
02.07.0317SCF	14	17	68	41
02.07.0320SCF	17	20	68	41
02.07.0323SCF	20	23	68	41
02.07.0326SCF	23	26	68	41

SIZE 4				
Reference	S (mm)	T (mm)	M/L (mm)	A/P (mm)
02.07.0410SCF	7	10	72	45
02.07.0412SCF	9	12	72	45
02.07.0414SCF	11	14	72	45
02.07.0417SCF	14	17	72	45
02.07.0420SCF	17	20	72	45
02.07.0423SCF	20	23	72	45
02.07.0426SCF	23	26	72	45

SIZE 5				
Reference	S (mm)	T (mm)	M/L (mm)	A/P (mm)
02.07.0510SCF	7	10	76	47
02.07.0512SCF	9	12	76	47
02.07.0514SCF	11	14	76	47
02.07.0517SCF	14	17	76	47
02.07.0520SCF	17	20	76	47
02.07.0523SCF	20	23	76	47
02.07.0526SCF	23	26	76	47

SIZE 6				
Reference	S (mm)	T (mm)	M/L (mm)	A/P (mm)
02.07.0610SCF	7	10	80	51
02.07.0612SCF	9	12	80	51
02.07.0614SCF	11	14	80	51
02.07.0617SCF	14	17	80	51
02.07.0620SCF	17	20	80	51
02.07.0623SCF	20	23	80	51
02.07.0626SCF	23	26	80	51

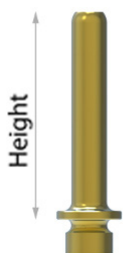

GMK REVISION SEMI-CONSTRAINED PEG - SensiTiN COATED*

MATERIALS: Co-Cr-Mo (ISO 5832-12) + TiNbn coating

Ref.	Size (insert thickness)	Height (mm)
02.07.SCP10	10	28
02.07.SCP12	12	30
02.07.SCP14	14	32
02.07.SCP17	17	35
02.07.SCP20	20	38
02.07.SCP23	23	41
02.07.SCP26	26	44

*By default, the GMK Revision semi constrained polyethylene tibial insert is supplied with a semi constrained peg in cobalt-chromium alloy. The GMK Revision semi-constrained peg with SensiTiN coating is supplied separately. For cases which require SensiTiN-coated implants, ensure that the GMK Revision semi constrained peg with SensiTiN coating is available as well. Make sure to discard the GMK Revision semi constrained peg contained within the polyethylene tibial insert and use the GMK Revision semi-constrained peg with SensiTiN coating supplied in a separated package.

EXTENSION STEMS

Tibial / Femoral



MATERIAL: Ti6Al4V (ISO 5832-3)

FIXATION: Cemented/Cementless

L (mm) = 65		
Reference		D (mm)
Cementless	Cemented	
02.07.FCL10065		10
02.07.FCL11065	02.07.FSC11065	11
02.07.FCL12065		12
02.07.FCL13065	02.07.FSC13065	13
02.07.FCL14065		14
02.07.FCL15065		15
02.07.FCL16065	02.07.FSC16065	16
02.07.FCL18065		18
02.07.FCL20065		20
02.07.FCL22065		22

L (mm) = 105		
Reference		D (mm)
Cementless	Cemented	
02.07.FCL10105		10
02.07.FCL11105	02.07.FSC11105	11
02.07.FCL12105		12
02.07.FCL13105	02.07.FSC13105	13
02.07.FCL14105		14
02.07.FCL15105		15
02.07.FCL16105	02.07.FSC16105	16
02.07.FCL18105		18
02.07.FCL20105		20
02.07.FCL22105		22

L (mm) = 150		
Reference		D (mm)
Cementless	Cemented	
02.07.FCL10150		10
02.07.FCL11150	02.07.FSC11150	11
02.07.FCL12150		12
02.07.FCL13150	02.07.FSC13150	13
02.07.FCL14150		14
02.07.FCL15150		15
02.07.FCL16150	02.07.FSC16150	16
02.07.FCL18150		18
02.07.FCL20150		20
02.07.FCL22150		22

OFFSET

Tibial / Femoral

MATERIAL: Ti6Al4V (ISO 5832-3)

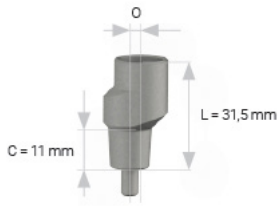

Size	Ref.	O (mm)
3	02.07.0003	3
5	02.07.0005*	5

* Only for the tibia

FEMORAL AUGMENTS

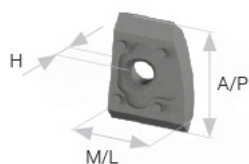

Distal Augments

MATERIAL: High Nitrogen Stainless Steel (ISO 5832-9)

FIXATION: with screw

Must not be coupled with SensiTiN-coated femoral component

SIZE 1			
Ref.	H (mm)	M/L (mm)	A/P (mm)
02.07.104FDW	4	17	27.5
02.05.01DW	8	17	27.5
02.07.112FDA	12	17	27.5
02.07.116FDA	16	17	27.5
02.07.120FDA	20	17	27.5

SIZE 2			
Ref.	H (mm)	M/L (mm)	A/P (mm)
02.07.204FDW	4	19	29
02.05.02DW	8	19	29
02.07.212FDA	12	19	29
02.07.216FDA	16	19	29
02.07.220FDA	20	19	29

SIZE 3			
Ref.	H (mm)	M/L (mm)	A/P (mm)
02.07.304FDW	4	21	30.5
02.05.03DW	8	21	30.5
02.07.312FDA	12	21	30.5
02.07.316FDA	16	21	30.5
02.07.320FDA	20	21	30.5

SIZE 4			
Ref.	H (mm)	M/L (mm)	A/P (mm)
02.07.404FDW	4	23	32
02.05.04DW	8	23	32
02.07.412FDA	12	23	32
02.07.416FDA	16	23	32
02.07.420FDA	20	23	32

SIZE 5			
Ref.	H (mm)	M/L (mm)	A/P (mm)
02.07.504FDW	4	25	33.5
02.05.05DW	8	25	33.5
02.07.512FDA	12	25	33.5
02.07.516FDA	16	25	33.5
02.07.520FDA	20	25	33.5

SIZE 6			
Ref.	H (mm)	M/L (mm)	A/P (mm)
02.07.604FDW	4	26	35
02.05.06DW	8	26	35
02.07.612FDA	12	26	35
02.07.616FDA	16	26	35
02.07.620FDA	20	26	35

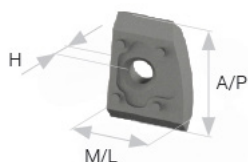

Distal Augments

MATERIAL: Ti6Al4V (ISO 5832-3)

FIXATION: with screw

SIZE 1*			
Ref.	H (mm)	M/L (mm)	A/P (mm)
02.07.7104FDW	4	17	27.5
02.07.7108FDW	8	17	27.5
02.07.7112FDA	12	17	27.5

SIZE 2			
Ref.	H (mm)	M/L (mm)	A/P (mm)
02.07.7204FDW	4	19	29
02.07.7208FDW	8	19	29
02.07.7212FDA	12	19	29

SIZE 3			
Ref.	H (mm)	M/L (mm)	A/P (mm)
02.07.7304FDW	4	21	30.5
02.07.7308FDW	8	21	30.5
02.07.7312FDA	12	21	30.5

SIZE 4			
Ref.	H (mm)	M/L (mm)	A/P (mm)
02.07.7404FDW	4	23	32
02.07.7408FDW	8	23	32
02.07.7412FDA	12	23	32

SIZE 5			
Ref.	H (mm)	M/L (mm)	A/P (mm)
02.07.7504FDW	4	25	33.5
02.07.7508FDW	8	25	33.5
02.07.7512FDA	12	25	33.5

SIZE 6*			
Ref.	H (mm)	M/L (mm)	A/P (mm)
02.07.7604FDW	4	26	35
02.07.7608FDW	8	26	35
02.07.7612FDA	12	26	35

*Not available yet

Posterior Augments

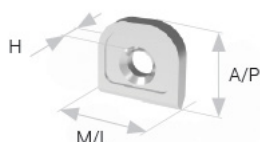

MATERIAL: High Nitrogen Stainless Steel (ISO 5832-9)

FIXATION: with screw

Must not be coupled with SensiTiN-coated femoral component

SIZE 1			
Ref.	H (mm)	M/L (mm)	A/P (mm)
02.05.01PW	5	16.5	17
02.07.110PW	10	16.5	17

SIZE 2			
Ref.	H (mm)	M/L (mm)	A/P (mm)
02.05.02PW	5	19	18.5
02.07.210PW	10	19	18.5

SIZE 3			
Ref.	H (mm)	M/L (mm)	A/P (mm)
02.05.03PW	5	21	20
02.07.310PW	10	21	20

SIZE 4			
Ref.	H (mm)	M/L (mm)	A/P (mm)
02.05.04PW	5	23	21.5
02.07.410PW	10	23	21.5

SIZE 5			
Ref.	H (mm)	M/L (mm)	A/P (mm)
02.05.05PW	5	24.5	23.5
02.07.510PW	10	24.5	23.5

SIZE 6			
Ref.	H (mm)	M/L (mm)	A/P (mm)
02.05.06PW	5	26	25.5
02.07.610PW	10	26	25.5

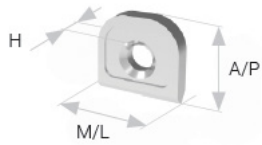

Posterior Augments

MATERIAL: Ti6Al4V (ISO 5832-3)

FIXATION: with screw

SIZE 1*			
Ref.	H (mm)	M/L (mm)	A/P (mm)
02.07.7105FPW	5	16.5	17
02.07.7110FPW	10	16.5	17

SIZE 2			
Ref.	H (mm)	M/L (mm)	A/P (mm)
02.07.7205FPW	5	19	18.5
02.07.7210FPW	10	19	18.5

SIZE 3			
Ref.	H (mm)	M/L (mm)	A/P (mm)
02.07.7305FPW	5	21	20
02.07.7310FPW	10	21	20

SIZE 4			
Ref.	H (mm)	M/L (mm)	A/P (mm)
02.07.7405FPW	5	23	21.5
02.07.7410FPW	10	23	21.5

SIZE 5			
Ref.	H (mm)	M/L (mm)	A/P (mm)
02.07.7505FPW	5	24.5	23.5
02.07.7510FPW	10	24.5	23.5

SIZE 6*			
Ref.	H (mm)	M/L (mm)	A/P (mm)
02.07.7605FPW	5	26	25.5
02.07.7610FPW	10	26	25.5

*Not available yet

TIBIAL AUGMENTS



MATERIAL: High Nitrogen Stainless Steel (ISO 5832-9)

FIXATION: with screw

Must not be coupled with SensiTiN-coated tibial baseplate

SIZE 0			
Ref.	H1 (mm)	A/P (mm)	M/L (mm)
02.09.TA005	5	33	26.5
02.09.TA010	10	33	26.5

SIZE 1			
Ref.	H1 (mm)	A/P (mm)	M/L (mm)
02.09.TA105	5	36	29
02.09.TA110	10	36	29

SIZE 2			
Ref.	H1 (mm)	A/P (mm)	M/L (mm)
02.09.TA205	5	39	31.5
02.09.TA210	10	39	31.5

SIZE 3			
Ref.	H1 (mm)	A/P (mm)	M/L (mm)
02.09.TA305	5	42	34
02.09.TA310	10	42	34

SIZE 4			
Ref.	H1 (mm)	A/P (mm)	M/L (mm)
02.09.TA405	5	45	36.5
02.09.TA410	10	45	36.5

SIZE 5			
Ref.	H1 (mm)	A/P (mm)	M/L (mm)
02.09.TA505	5	48	39
02.09.TA510	10	48	39

SIZE 6			
Ref.	H1 (mm)	A/P (mm)	M/L (mm)
02.09.TA605	5	52	42.8
02.09.TA610	10	52	42.8



MATERIAL: Ti6Al4V (ISO 5832-3)

FIXATION: with screw

SIZE 0*			
Ref.	H1 (mm)	A/P (mm)	M/L (mm)
02.09.8TA005	5	33	26.5
02.09.8TA010	10	33	26.5

SIZE 1*			
Ref.	H1 (mm)	A/P (mm)	M/L (mm)
02.09.8TA105	5	36	29
02.09.8TA110	10	36	29

SIZE 2			
Ref.	H1 (mm)	A/P (mm)	M/L (mm)
02.09.8TA205	5	39	31.5
02.09.8TA210	10	39	31.5

SIZE 3			
Ref.	H1 (mm)	A/P (mm)	M/L (mm)
02.09.8TA305	5	42	34
02.09.8TA310	10	42	34

SIZE 4			
Ref.	H1 (mm)	A/P (mm)	M/L (mm)
02.09.8TA405	5	45	36.5
02.09.8TA410	10	45	36.5

SIZE 5			
Ref.	H1 (mm)	A/P (mm)	M/L (mm)
02.09.8TA505	5	48	39
02.09.8TA510	10	48	39

SIZE 6*			
Ref.	H1 (mm)	A/P (mm)	M/L (mm)
02.09.8TA605	5	52	42.8
02.09.8TA610	10	52	42.8

*Not available yet



MATERIAL: High Nitrogen Stainless Steel (ISO 5832-9)

FIXATION: with screw

Must not be coupled with SensiTiN-coated tibial baseplate

SIZE 1				
Reference		H2 (mm)	A/P (mm)	M/L (mm)
LMRL	RMLL			
02.09.TA115LMRL	02.09.TA115RMLL	15	36	29
02.09.TA120LMRL	02.09.TA120 RMLL	20	36	29

SIZE 2				
Reference		H2 (mm)	A/P (mm)	M/L (mm)
LMRL	RMLL			
02.09.TA215LMRL	02.09.TA215RMLL	15	39	31.5
02.09.TA220LMRL	02.09.TA220 RMLL	20	39	31.5

SIZE 3				
Reference		H2 (mm)	A/P (mm)	M/L (mm)
LMRL	RMLL			
02.09.TA315LMRL	02.09.TA315RMLL	15	42	34
02.09.TA320LMRL	02.09.TA320 RMLL	20	42	34

SIZE 4				
Reference		H2 (mm)	A/P (mm)	M/L (mm)
LMRL	RMLL			
02.09.TA415LMRL	02.09.TA415RMLL	15	45	36.5
02.09.TA420LMRL	02.09.TA420 RMLL	20	45	36.5

SIZE 5				
Reference		H2 (mm)	A/P (mm)	M/L (mm)
LMRL	RMLL			
02.09.TA515LMRL	02.09.TA515RMLL	15	48	39
02.09.TA520LMRL	02.09.TA520 RMLL	20	48	39

SIZE 6				
Reference		H2 (mm)	A/P (mm)	M/L (mm)
LMRL	RMLL			
02.09.TA615LMRL	02.09.TA615RMLL	15	52	42.8
02.09.TA620LMRL	02.09.TA620 RMLL	20	52	42.8



MATERIAL: Ti6Al4V (ISO 5832-3)*

FIXATION: with screw

SIZE 1				
Reference		H2 (mm)	A/P (mm)	M/L (mm)
LMRL	RMLL			
02.09.8TA115LMRL	02.09.8TA115RMLL	15	36	29
02.09.8TA120LMRL	02.09.8TA120RMLL	20	36	29

SIZE 2				
Reference		H2 (mm)	A/P (mm)	M/L (mm)
LMRL	RMLL			
02.09.8TA215LMRL	02.09.8TA215RMLL	15	39	31.5
02.09.8TA220LMRL	02.09.8TA220RMLL	20	39	31.5

SIZE 3				
Reference		H2 (mm)	A/P (mm)	M/L (mm)
LMRL	RMLL			
02.09.8TA315LMRL	02.09.8TA315RMLL	15	42	34
02.09.8TA320LMRL	02.09.8TA320RMLL	20	42	34

SIZE 4				
Reference		H2 (mm)	A/P (mm)	M/L (mm)
LMRL	RMLL			
02.09.8TA415LMRL	02.09.8TA415RMLL	15	45	36.5
02.09.8TA420LMRL	02.09.8TA420RMLL	20	45	36.5

SIZE 5				
Reference		H2 (mm)	A/P (mm)	M/L (mm)
LMRL	RMLL			
02.09.8TA515LMRL	02.09.8TA515RMLL	15	48	39
02.09.8TA520LMRL	02.09.8TA520RMLL	20	48	39

SIZE 6				
Reference		H2 (mm)	A/P (mm)	M/L (mm)
LMRL	RMLL			
02.09.8TA615LMRL	02.09.8TA615RMLL	15	52	42.8
02.09.8TA620LMRL	02.09.8TA620RMLL	20	52	42.8

*Not available yet

©Medacta International 2017-2020. All Rights Reserved.
 All trademarks are property of their respective owners
 and are registered at least in Switzerland