

wAP ac

The wAP ac is a small weatherproof wireless access point for your mobile devices, perfect for installation outside your house, in the garden, on your porch or anywhere else where you need wireless access from your phone or computer.

The device has one Gigabit Ethernet port, it supports 802.11ac technology and can work at both the 2.4GHz and 5GHz frequencies simultaneously. It looks unobtrusive and sleek, available in two colours - black (RBwAPG-5HacT2HnD-BE) and white (RBwAPG-5HacT2HnD).

The wAP ac is weatherproof and can be fixed to any external wall from the inside of the case - so that it is securely attached to it's mounting location. The bottom door can also be secured with a special screw, which can only be opened by the owner.

It is also possible to run the Ethernet cable directly behind the unit, to inside the wall, as there is a special opening on the back of the case. This way, the unit doesn't attract attention and blends into any environment.



Included



24V 0.8A
Power adapter



Screw kit



Gigabit PoE
injector



2x plastic straps



Ceiling mount
base

Specifications

Product code	RBwAPG-5HacT2HnD (white, international) RBwAPG-5HacT2HnD-BE (black, international) RBwAPG-5HacT2HnD-US (white, USA) RBwAPG-5HacT2HnD-BE-US (black, USA)			
CPU nominal frequency	720 MHz			
Size of RAM	64 MB			
Storage type	Flash			
Flash size	16 MB			
10/100/1000 Ethernet ports	1			
Wireless	5 GHz		2.4 GHz	
Operating frequency	International	5150 - 5875 MHz	International	2412 - 2484 MHz
	USA	5170 - 5250 MHz 5725 - 5835 MHz	USA	2412 - 2462 MHz
Protocols	802.11a/n/ac		802.11b/g/n	
Chains	Triple-chain		Dual-chain	
Wireless chip model	QCA9880		QCA9556	
Antenna gain	2 dBi		2 dBi	
Antenna beam width	360°			
PoE in	Yes			
Supported input voltage	11 V - 57 V (802.3af/at with shielding not connected to GND pins, passive PoE)			
Dimensions	185 x 85 x 30 mm			
License level	4			
Operating System	RouterOS			
Max Power consumption	12 W			

Wireless specifications

2.4 GHz	Tx (dBm)	Rx (dBm)
1MBit/s	25	-95
11MBit/s	25	-90
6MBit/s	25	-95
54MBit/s	23	-80
MCS0	25	-95
MCS7	22	-74

5GHz	Tx (dBm)	Rx (dBm)
6MBit/s	25	-96
54MBit/s	25	-81
MCS0	25	-96
MCS7	24	-77
MCS9	23	-72



Use it on the ceiling!

The wAP comes bundled with all the necessary things to be mounted on a ceiling. Cable breakout provides ability to run the cable through the ceiling.



Use it on the wall!

Wall mounting is easy thanks to the provided drill template and mounting screws. Everything included.

WALL

1. Use template to mark drilling holes.
2. Plug plastic anchors in drilled holes.
- 3.-4. Fix steel bracket.
5. Pull through ETH cable.
6. Mount the product to steel bracket.
7. Lock enclosure.
8. Close cover.

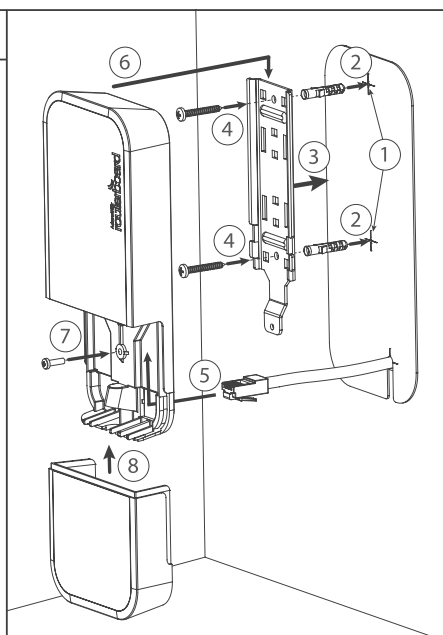

CEILING

1. Use template to mark drilling holes.
2. Place both brackets in appropriate place.
3. Fix steel brackets to dropdown ceiling panel.

Proceed to step 5 in WALL instruction.

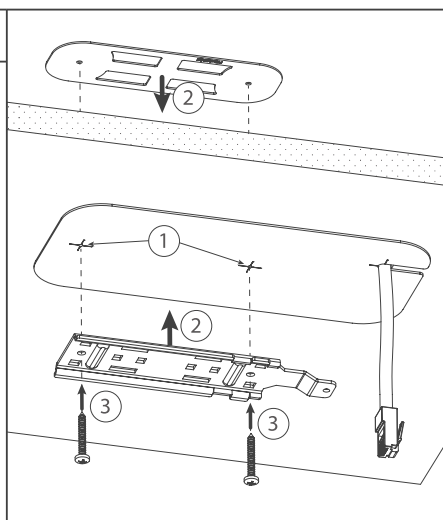

MAST/POLE

1. Mount plastic tie straps to steel bracket (holes B).
2. Fix steel bracket to enclosure.
3. Lock enclosure.
4. Fix product to mast/pole.
5. Plug in ETH connector.
6. Close cover.

* Use electrical tape to avoid from product slipping.

