

hawle

# HAWLE-**E1**

Flanged valve

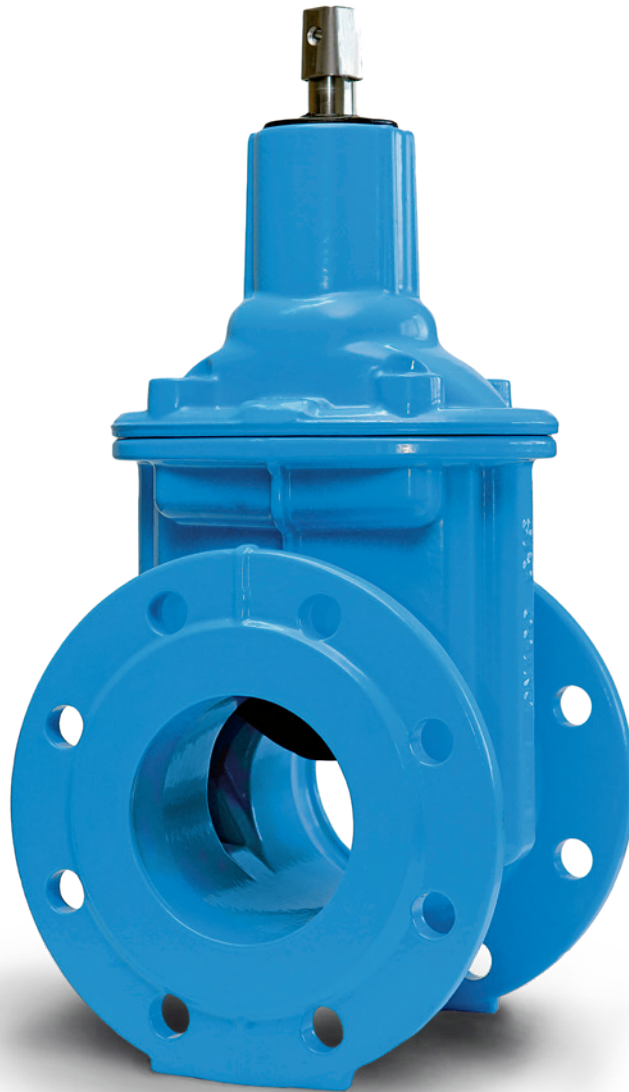

HAWLE. **MADE FOR GENERATIONS.**



# HAWLE-E1

## Flanged valve

The HAWLE-**E1** Gate Valve is the result of our consequent improvement of the well proven ELYPSO Valve. The O-ring bush is fixed in the all side epoxy powder coated bonnet by a bayonet connection. Wedge guides made of POM guarantee lowest wear and lowest closing torques.

- DN 50 - DN 300
- PN 10 | PN 16
- Application: potable water
- According to EN 1074-1 und -2
- Short and long face-to-face dimension

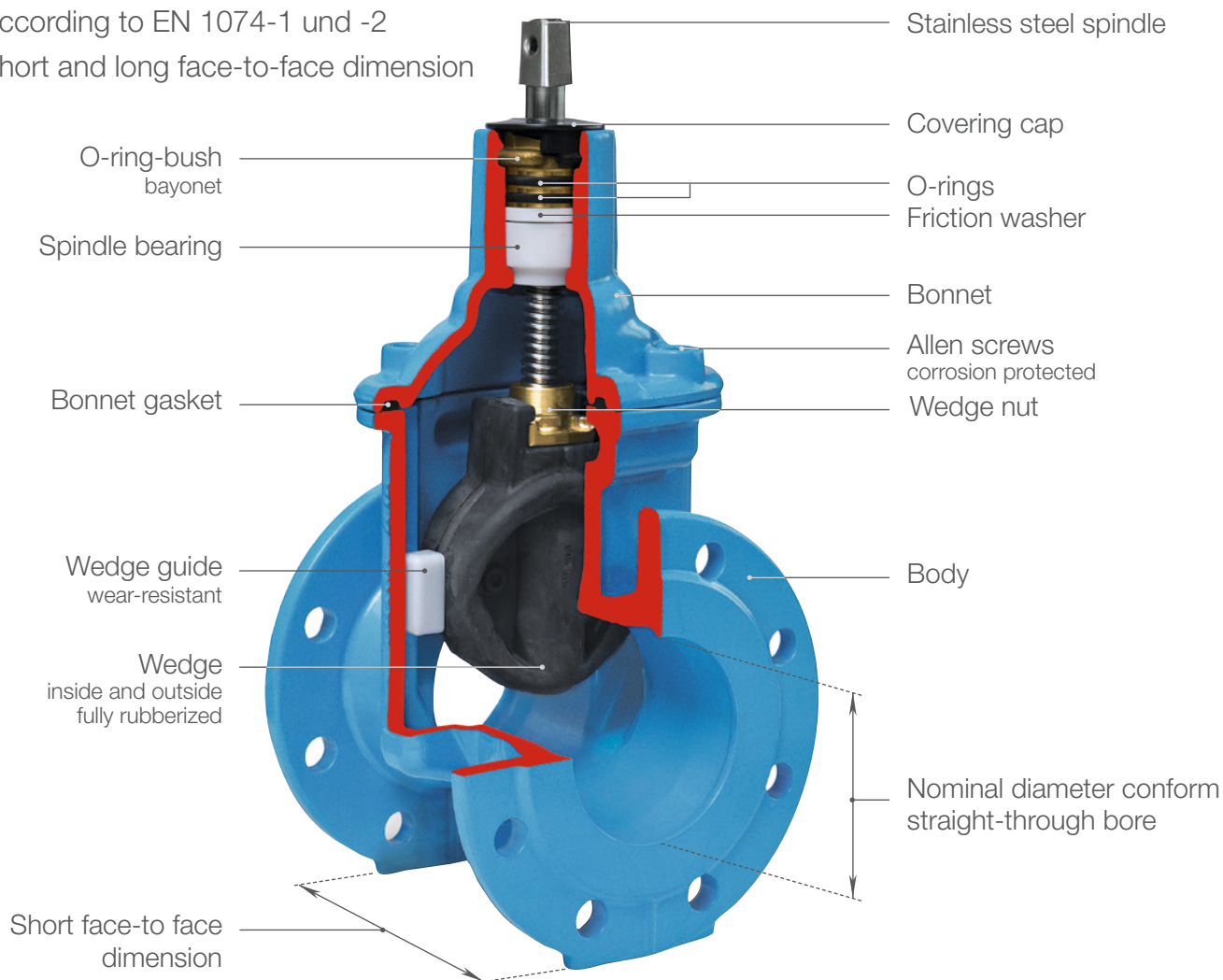

HAWLE-  
**QUALITY WARRANTY**



# RANGE OF PRODUCTS

## SPECIFICATIONS

No. 4000E1

No. 4700E1

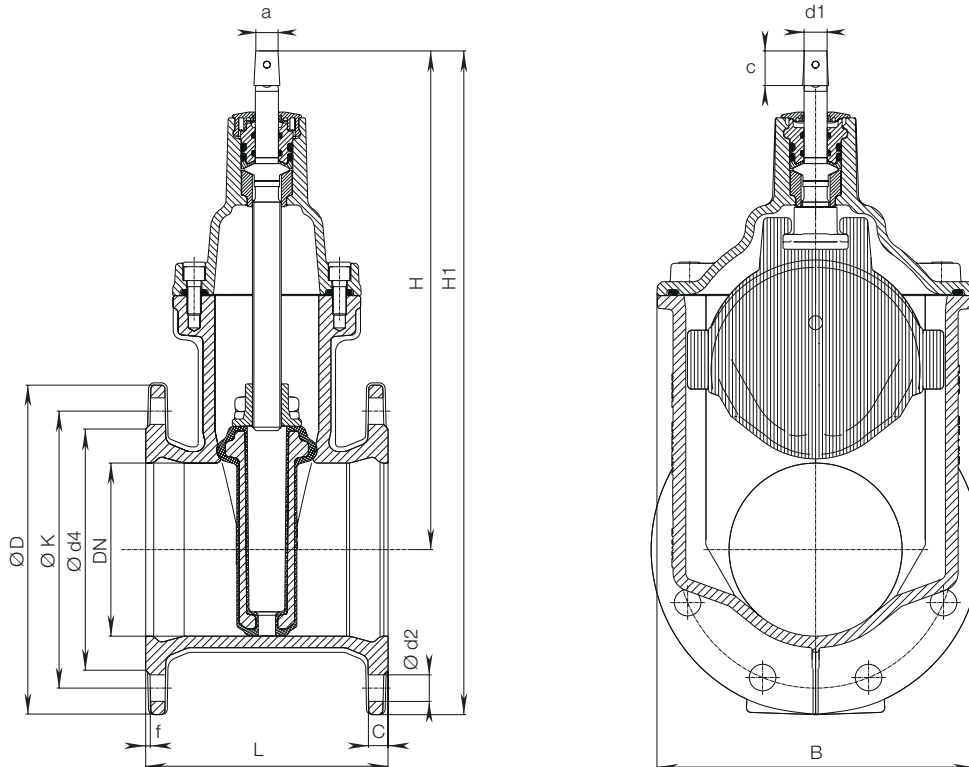

DN	MOP (PN)	Flange					Bolts			Spindle			Valve				Weight		
		ØD	C	ØK	Ød4	f	Qty	Thread	Ød2	a	c	Ød1	H	H1	L short	L long	B	short	long
50	10 16	165	18	125	98	5	4	M 16	19	14,8	30	18	230	313	150	250	135	8,8	10,7
65	10 16	185	18	145	118	5	4	M 16	19	17,3	30	20	298	390	170	270	172	13,5	16,9
80	10 16	200	18	160	133	5	8	M 16	19	17,3	30	20	305	405	180	280	172	14,5	19,0
100	10 16	220	18	180	153	5	8	M 16	19	19,3	30	20	339	449	190	300	203	18,5	25,2
125	10 16	250	17	210	183	4	8	M 16	19	19,3	30	20	420	545	200	325	275	30,5	36,7
150	10 16	285	17	240	209	4	8	M 20	23	19,3	30	20	432	575	210	350	275	34,0	42,9
200	10 16	340	19,5	295	264	4,5	8	M 20	23	24,3	38	25	534	704	230	400	345	54,6	68,0
							12											53,0	
250	10 16	400	21,5	350	318	4,5	12	M 20	23	27,3	38	32	626	826	250	-	422	80,5	-
							12	M 24	28									82,0	
300	10 16	455	24	400	371	5,5	12	M 20	23	27,3	38	32	709	937	270	-	506	125,0	-
							12	M 24	28									142,4	

### BENEFITS HAWLE-E1 VALVE

- O-ring bush with bayonet connection
- Wear less wedge guides
- 100% corrosion protection
- Inside and outside fully rubberized wedge
- Suitable for cleaning with a badger

## ACCESSORIES AND SPARE PARTS



**Handwheel**  
No. 7800



**Operating cap**  
No. 2156, No. 2157  
No. 2158



**Extension spindles**  
No. 9000A, No. 9500A  
No. 9000, No. 9500



**Surface boxes**  
No. 1750, No. 2050  
No. 2051K

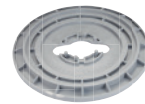

**Base plate**  
No. 3481K



**Spindle extensions**  
No. 7820, No. 7825

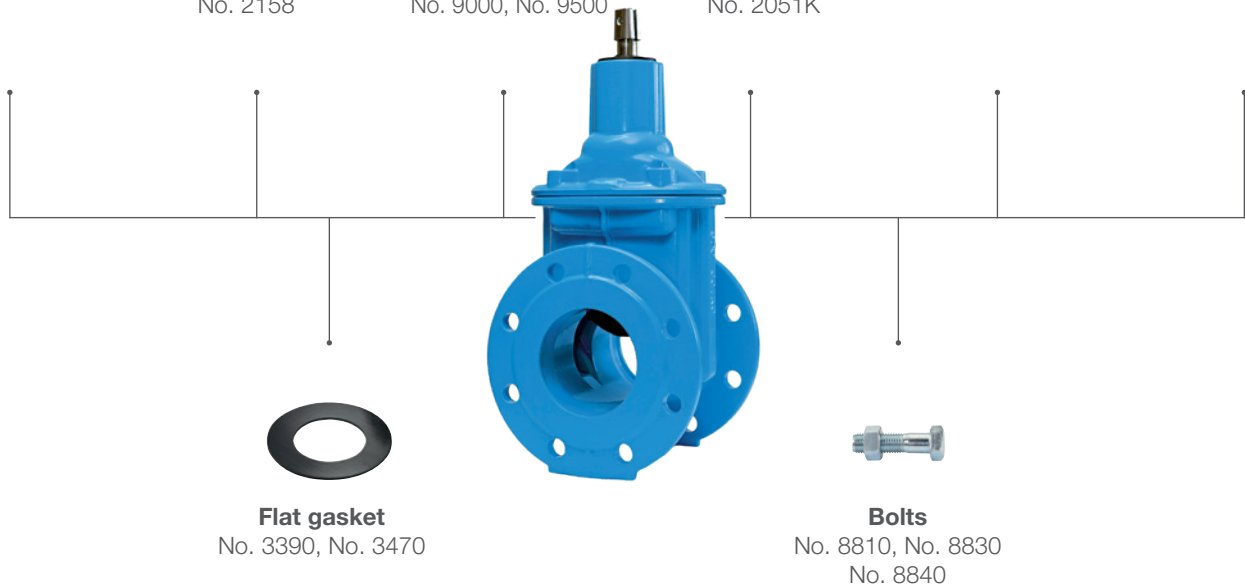

**Flat gasket**  
No. 3390, No. 3470



**Bolts**  
No. 8810, No. 8830  
No. 8840

Your distributor:



Landesgesellschaft  
Österreich

# CERTIFICATE

The Certification Body  
of TÜV SÜD Landesgesellschaft Österreich GmbH  
certifies that



## E. Hawle Armaturenwerke GmbH

Wagrainer Straße 13  
A-4840 Vöcklabruck

Hawle Straße 1  
A-4890 Frankenmarkt

has established and applies  
a Management System for

**Development, production and sales of valves and fittings**

An audit was performed and proof has been furnished that the requirements  
according to

**ISO 9001 : 2015**

are fulfilled. The certificate is valid until **2024-03-31**

Certificate Registration No. **Q1531395**

  
Vienna, 2021-04-06





Landesgesellschaft  
Österreich

# CERTIFICATE

The Certification Body  
of TÜV SÜD Landesgesellschaft Österreich GmbH  
certifies that



## E. Hawle Armaturenwerke GmbH

Wagrainer Straße 13  
A-4840 Vöcklabruck

Hawle Straße 1  
A-4890 Frankenmarkt

has established and applies  
a Management System for

**Development, production and sales of valves and fittings**

An audit was performed and proof has been furnished that the requirements  
according to

**ISO 14001 : 2015**

are fulfilled. The certificate is valid until **2024-03-31**

Certificate Registration No. **U1531395**

  
Vienna, 2021-04-06





Landesgesellschaft  
Österreich

# CERTIFICATE

The Certification Body  
of TÜV SÜD Landesgesellschaft Österreich GmbH  
certifies that



**E. Hawle Armaturenwerke GmbH**

Wagrainer Straße 13  
A-4840 Vöcklabruck

Hawle Straße 1  
A-4890 Frankenmarkt

has established and applies  
a Management System for

**Development, production and sales of valves and fittings**

An audit was performed and proof has been furnished that the requirements  
according to

**ISO 50001 : 2018**

are fulfilled. The certificate is valid until **2024-03-31**

Certificate Registration No. **EM1531395**

  
Vienna, 2021-04-06

