

## Safety

Keep it out of reach of Children and pet.

Only use dison specified charger and adaptor.

Don't throw battery into fire; dispose the used battery according to local regulation.

Do not place the battery or cooler next to heating devices:radiators, microwave ovens,cooking ovens, open fires or hot surfaces. Over heating of batteries can cause a hazard.

Handling of batteries. Do not puncture or place high pressure to Battery case.

This can cause short circuit or overheating of battery pack.

Keep the cold tray/ battery/charger dry, fluid will cause bad damage of circuit board.

## Features

### ◆ Portable and Delicate:

Delicate and fashionable, big capacity. Ideal for long time traveling with enough medication.

### ◆ Long battery working time:

7.4V 16000mah battery ensure 8 hours before recharging. Also support AC110-240V, DC12-24V, cooling anywhere, anytime.

### ◆ Environment friendly:

Use thermoelectric refrigeration, no Freon and liquid, long working life.

### ◆ Simple operation:

LED temperature display, easy button operation.

### ◆ 2-8℃ refrigeration:

Keep 2-8℃ under ambient 32℃, while ambient temp is lower than 2℃, could heat to 2℃ automatically.

## Parts Instruction

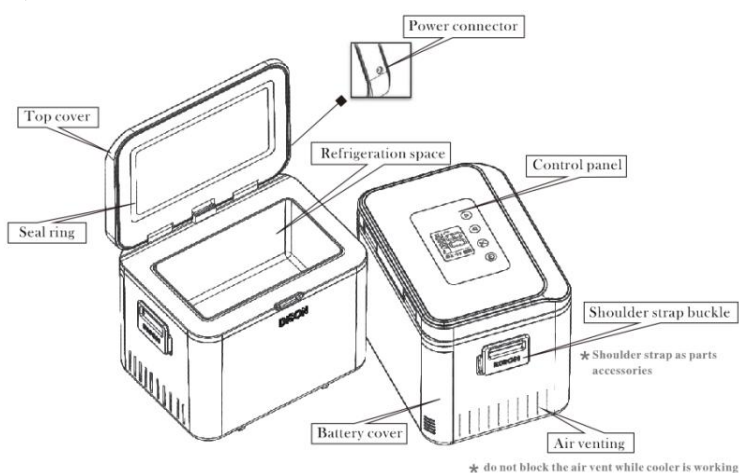

# ◆ DISON

### DISON i-cold series BC-1500A

#### BC-1500A User manual

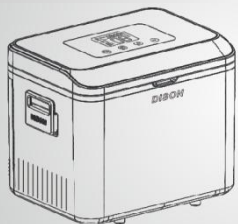

Zhengzhou Dison Electric Co.,Ltd

#### Before using

Safety  
Parts instruction  
Accessories, specifications and features  
Maintaining and Notice

#### Operation Instruction

Battery installation  
Battery charging  
Control panel  
Operation

#### When necessary

Malfunction and solution  
Goods warranty

Thanks for using dison product, please read the manual before using for right operation and safety. Keep it properly for use it in necessary time.

## Specification

NO.	Item	Parameter
1	Refrigeration space(L*W*H)	180mm*100mm*80mm
2	Dimensions(L*W*H)	240mm*170mm*195mm
3	Refrigeration temperature	2-8℃ (under ambient 32℃)
4	Input/output voltage(AC charger)	AC100V-240V/DC9.0V
5	Output current (AC charger)	4A
6	Input/output voltage(battery charger)	AC100V-240V/DC9.0V
7	Output current (battery charger)	2A
8	Input/output voltage (car power)	DC12V-24V/ DC9.0V
9	Current (vehicle power )	4A
10	Voltage ( lithium battery)	DC7.4V
11	Capacity ( lithium battery)	16000MAH
12	Power rating	18W/ DC9.0V; 13W/DC7.4V

## Packing list

No.	Accessories	Quantity
1	Instruction manual	1pc
2	Adaptor(AC charger)	1pc
3	Adaptor(battery charger)	1pc
4	Vehicle adaptor	1pc
5	Battery(16000MAH)	1pc
6	Shoulder strap	1pc
7	Accessories bag	1pc

### 1.Attention for using

- (1)Do not immerse to water or place in wet environmer
- (2)keep the refrigeration space dry, could put some tissue while using it.
- (3)place it in good air ventilation and dry environme nt, wet air will corrode the cooler parts.

- 2.Please use its own charger and adaptor that attached with this product, if others, please do make sure all the specifications same with the original charger and adaptor. Or will cause malfunction.

- 3.If you do not use the cooler for a long time, please use the battery one time and full charging it each two n
- 4.Clean the air vent at regulate time, prevent blocking it.

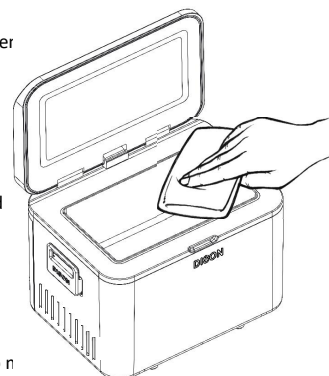

Dear Customer

Thanks for your support; we will offer timely, understanding, professional customer service.

Our promise as below:

1. The replacement warranty period of battery is six months. Any mechanical damage to the case or the input output leads. Any failures that is due to incorrect use. Are not covered by the warranty.
  2. The warranty from Dison will cover any defect of 1 year against, any electrical or mechanical failure, due to a manufacturing defect. From the date of purchase.
- For non China main land customer's. Please contacts your local supplier for warranty terms.

Certification  
of quality

Inspector:

Zhengzhou Dison Electric Co.,Ltd

## Control Panel

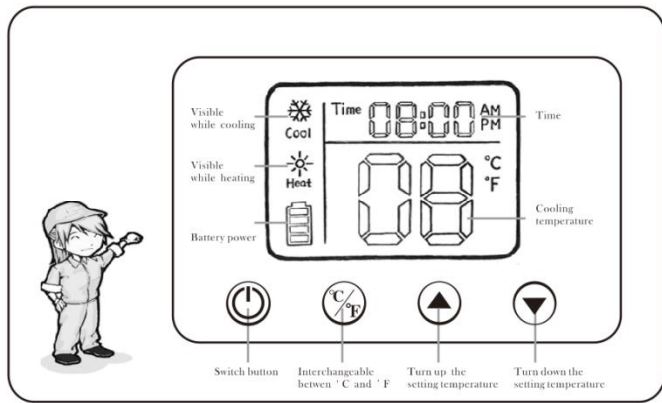

## Temperature setting

▲▼ key: Setting temperature, press

▲▼ key to increase or decrease

the temperature, press ⏻ to save

setting temperature, setting range is

2-12 Celsius.(picture 3,picture 4)



picture3



picture4

## Operation direction

⏻ key: Connect cooler box charger or car adapter with electrical socket or install the battery, press ⏻ button

for 5 Seconds, LCD display screen light is on. Display screen show the cold tray temperature, time, functional mode and battery capacity. 30 seconds later the light goes out. And press ⏻ key

again if want to shut down.(picture 1)

⌚ key: Press it, LCD screen light up, show the Celsius temperature, press again, show the Fahrenheit degree.(picture 2)

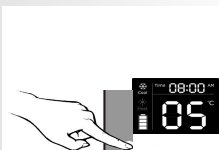

picture 1



picture 2

## Time setting

While the screen is light, press ⏻ button

the hours digit flashing (picture 5), press

▲▼ adjust hours, the carry time is

12, while the number have one carry time, AM and PM will have one exchange.

Press ⏻ again, the minute digit flashing

(picture 6), press ▲▼ for minute

adjust, press ⏻ for saving and exit.

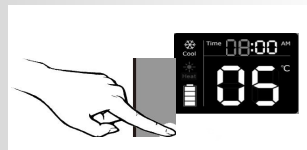

picture5



picture 6

## Install internal battery

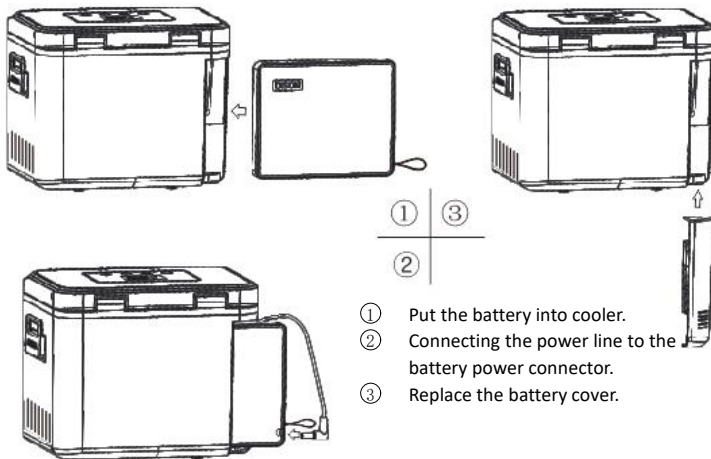

- ① Put the battery into cooler.
- ② Connecting the power line to the battery power connector.
- ③ Replace the battery cover.

## Charging battery

**Charging battery while it's power the cooler:**

connecting the charger with the cooler power connector

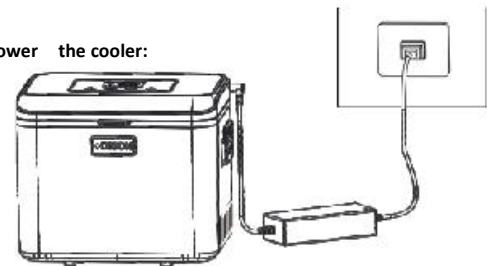

**Charging the battery separately:**

connect the charger with battery's power connector

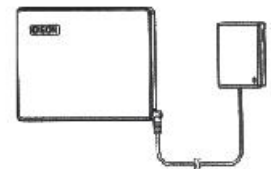

## Warranty card

Name		Phone	
Add			
Model		Purchase date	
Shop			
Maintenance Point			

Maintenance record:

Date	Description	Replacement parts	Maintenance man	Customer signature

## Trouble shooting

The cooler cannot cool or heat	Check whether the plug is plugged in firmly or the battery is run out.
Poor cooling effect	Please confirm whether the setting temperature is right, air ventilation and fan function is normal. Don't open the cooler frequently.
Have a big noise	Check whether the fan is blocked.
Can't turn on	Please confirm: whether press switch button time is more than 3 seconds, or battery power is used up, charger plug is fixed well, or charger indicator light is normal.
Battery working time is short	Confirm whether battery charging time is enough.