

	PART DESCRIPTION	MATERIAL
①	ENGRAVED HOUSING	ALUMINUM
②	ACHROMATIC WAVEPLATE ASSEMBLY	CRYSTAL QUARTZ/SS/MgF2
③	O-RING	NITRILE
④	SM1RR	ALUMINUM

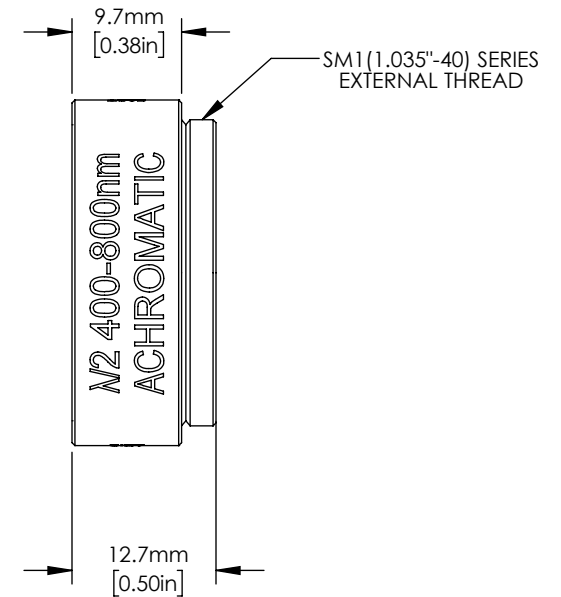
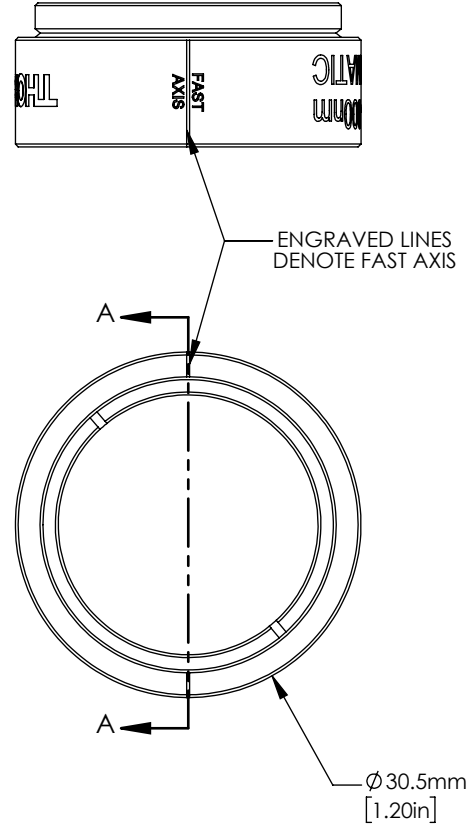
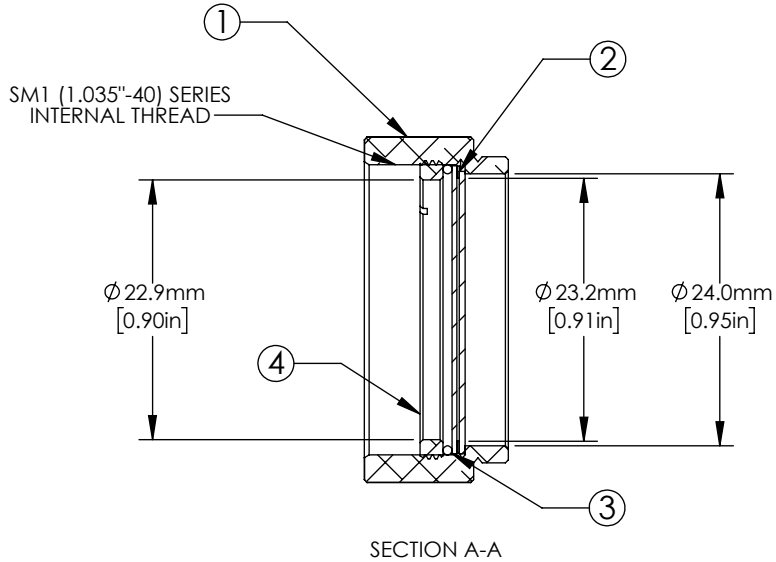

NOTES/SPECIFICATIONS:

1. UNMOUNDED DIAMETER: 1.00"  $\pm 0.008$  (25.4mm  $\pm 0.2$ )
2. BEAM DEVIATION:  $< 10$  arcsec
3. RETARDANCE ACCURACY:  $< \lambda/300$
4. TRANSMITTED WAVEFRONT ERROR:  $< \lambda/4$  (rms) AT 633nm
5. SURFACE QUALITY: 40-20 SCRATCH-DIG
6. CLEAR APERTURE:  $\phi 0.89$ " ( $\phi 22.6\text{mm}$ )
7. COATING: BBAR 400-800nm, Ravg  $< 0.5\%$ ,  $0^\circ$  AOI/PER SURFACE (4 TOTAL SURFACES)

FOR INFORMATION ONLY  
NOT FOR MANUFACTURING PURPOSES

DRAWING PROJECTION			 <a href="http://www.thorlabs.com">www.thorlabs.com</a> <b>1" <math>\lambda/2</math> ACHROMATIC WAVEPLATE 400-800nm</b>	
NAME	DATE			
DRAWN	MG	16/FEB/12	MATERIAL <b>SEE TABLE</b>	
APPROVAL	DS	06/MAR/23		
COPYRIGHT © 2023 BY THORLABS VALUES IN PARENTHESIS ARE CALCULATED AND MAY CONTAIN ROUND OFF ERRORS			ITEM # <b>AHWP10M-600</b>	APPROX WEIGHT <b>9 g</b>